

# CN70

## HEAVY DUTY COIL NAILER

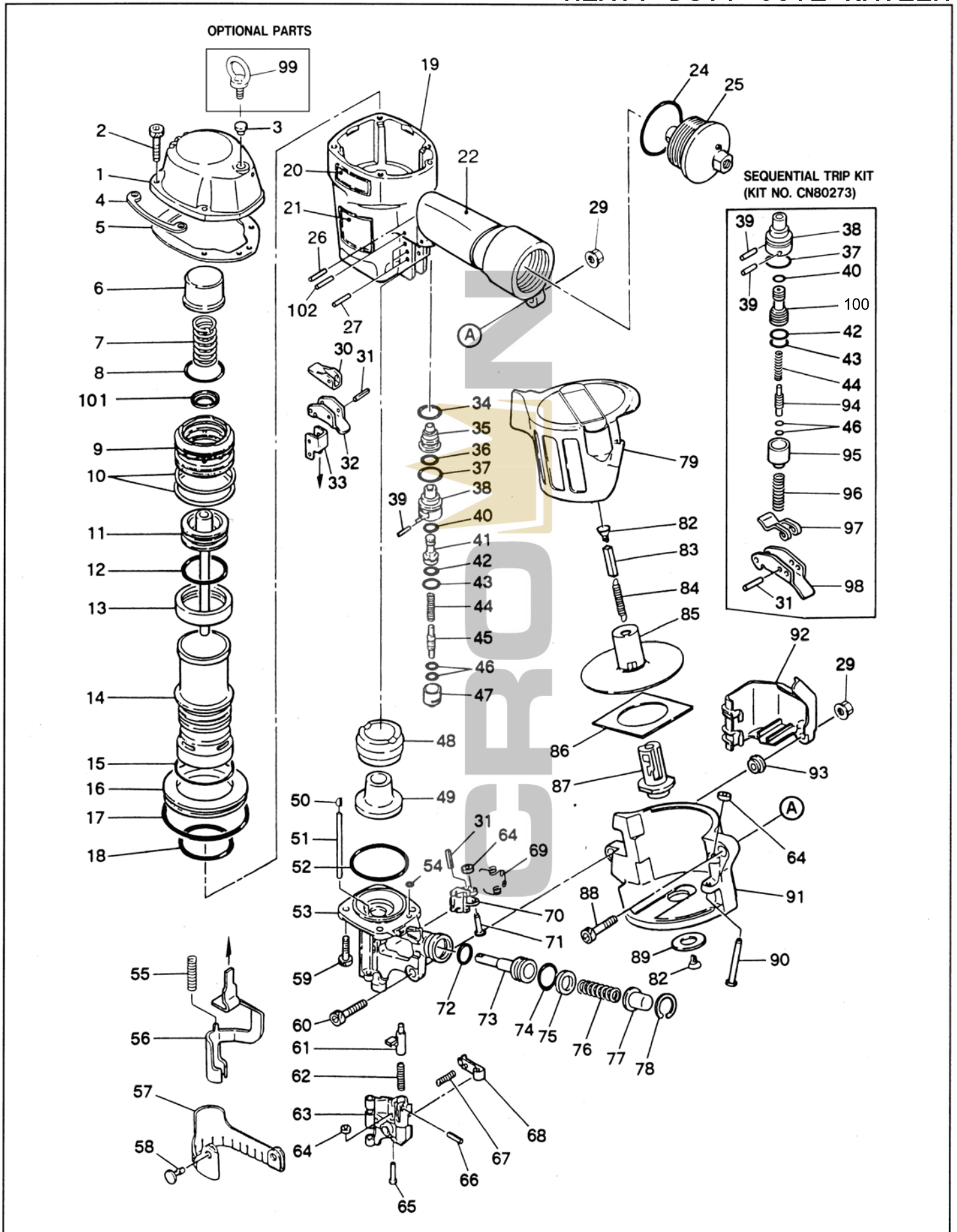

# MAX PARTS PRICE LIST

JUNE 2010

Model	Part NO	Part Code	Description	List Price	Ratio
CN70	1	CN81205	CYLINDER CAP UNIT (REPLACES CN34422)	\$54.66	1
CN70	2	BB40422	BOLT 6X30	\$0.50	20
CN70	3	TA12319	GROMMET	\$0.44	1
CN70	4	CN37550	PROTECTOR (REPLACES CN35766)	\$2.96	1
CN70	5	CN37549	CYLINDER CAP SEAL (REPLACES CN34467)	\$10.44	30
CN70	6	CN37525	PISTON STOP (REPLACES CN31555)	\$7.10	30
CN70	7	KK23195	COMPRESSION SPRING -3195	\$1.96	1
CN70	8	HH19142	O-RING 1A3X56,6	\$2.04	50
CN70	9	CN37526	HEAD VALVE PISTON (REPLACES CN35826)	\$25.18	5
CN70	10	HH19195	O-RING 1A3X56,8	\$3.40	50
CN70	11	CN81204	MAIN PISTON UNIT (REPLACES CN31657)	\$56.68	10
CN70	12	HH19196	O-RING 1A4,9X43	\$2.76	50
CN70	13	CN37527	CYLINDER SEAL (REPLACES CN31560)	\$2.64	50
CN70	14	CN37532	CYLINDER REPLACES CN31558	\$44.04	1
CN70	15	HH19192	O-RING 1A3,1X56,5	\$2.98	20
CN70	16	CN37524	CYLINDER RING (REPLACES CN31559)	\$6.98	1
CN70	17	HH12117	O-RING 1AG85	\$1.80	20
CN70	18	HH11169	O-RING 1AP56	\$2.12	5
CN70	19	CN37546	FRAME (REPLACES CN34441)	\$91.86	1
CN70	20	CN34426	"CN70" LABEL	\$1.18	1
CN70	21	CN37439	WARNING LABEL (MAGAZINE) (REPLACES CN34879)	\$2.12	1
CN70	22	CN34703	GRIP COVER	\$6.96	1
CN70	23	CN32722	GRIP TAPE	\$11.14	1
CN70	24	HH12102	O-RING 1AG50	\$1.88	1
CN70	25	CN81221	END CAP, REPLACES CN34455	\$18.36	1
CN70	26	FF21229	ROLL PIN 3X20	\$0.20	10
CN70	27	FF21221	ROLL PIN 3X25	\$0.20	10
CN70	29	CC00402	ELASTIC STOP NUT M6X1	\$0.44	5
CN70	30	CN37424	CONTACT LEVER (REPLACES TA10506)	\$2.70	1
CN70	31	FF21220	ROLL PIN 3X16	\$0.20	10
CN70	32	CN37423	TRIGGER (REPLACES TA10505)	\$2.48	1
CN70	33	CN37553	ARM GUIDE (REPLACES CN35855)	\$6.78	1
CN70	34	HH11159	O-RING ARP568-016	\$1.20	5
CN70	35	CN37529	TRIGGER VALVE CAGE (REPLACES CN31661)	\$0.92	1
CN70	36	HH11151	O-RING ARP 568-013 (CN70)	\$0.88	5
CN70	37	HH11138	O-RING 1AP20	\$0.44	20
CN70	38	CN32247	TRIGGER VALVE HOUSING	\$6.02	20
CN70	39	FF30161	STRAIGHT PIN 161	\$0.44	5
CN70	40	HH11119	O-RING 1AP6	\$0.44	50
CN70	41	CN31589	PILOT VALVE	\$4.60	5
CN70	42	HH11209	O-RING 1BP7	\$0.44	50
CN70	43	HH11113	O-RING 1AP9	\$0.44	50
CN70	44	KK24123	COMPRESSION SPRING 4123	\$1.22	5
CN70	45	CN31347	TRIGGER VALVE STEM	\$1.44	20
CN70	46	HH11901	O-RING 1B1, 4X2,5	\$0.20	30
CN70	47	CN31346	TRIGGER VALVE CAP	\$1.68	1
CN70	48	CN31563	BUMPER"A"	\$4.84	30
CN70	49	CN31564	BUMPER "B"	\$5.12	30
CN70	50	CN31594	PIN CAP	\$1.00	1
CN70	51	FF31127	STRAIGHT PIN 1127	\$1.58	1
CN70	52	HH19139	O-RING 1A1,5X53,5	\$2.88	5
CN70	53	CN37521	NOSE (REPLACES CN34432)	\$210.32	1
CN70	54	HH19125	O-RING 1A1, 6X4.2	\$0.44	5
CN70	55	KK23223	COMPRESSION SPRING 3223	\$0.86	1
CN70	56	CN35827	CONTACT ARM UNIT, REPLACES PART# CN31662	\$23.52	1
CN70	57	CN31582	DUST COVER	\$2.18	1
CN70	58	CN31083	DUST COVER HOOK	\$0.44	5

## MAX PARTS PRICE LIST

JUNE 2010

Model	Part NO	Part Code	Description	List Price	Ratio
CN70	59	BB40443	SCREW M8X28	\$0.44	20
CN70	60	BB40457	SCREW M6X38, REPLACES PART# BB40465	\$0.50	10
CN70	61	CN37371	DOOR LATCH (REPLACES CN30587)	\$11.26	1
CN70	62	KK23123	COMPRESSION SPRING 3123	\$0.44	5
CN70	63	CN37522	DOOR (REPLACES CN34427)	\$55.25	1
CN70	64	EE39602	RUBBER WASHER 7, REPLACES PART#'S EE39604, EE39623	\$0.44	20
CN70	65	FF41286	STEP IN 1286	\$1.84	1
CN70	66	FF21234	ROLL PIN 3X12	\$0.20	5
CN70	67	KK23109	COMPRESSION SPRING 3109	\$0.44	5
CN70	68	CN37523	CHECK PAWL (Replaces CN30584)	\$26.22	1
CN70	69	KK33058	TORSION SPRING 3058	\$4.70	20
CN70	70	CN31568	FEED PAWL	\$25.12	1
CN70	71	FF41263	STEP PIN 1263	\$5.44	1
CN70	72	HH11132	O-RING 1AP10A	\$0.44	5
CN70	73	CN37537	FEED PISTON (REPLACES CN31569)	\$26.44	1
CN70	74	HH11143	O-RING 1AP21	\$0.64	50
CN70	75	CN37528	FEED PISTON STOP (REPLACES CN31570)	\$2.12	1
CN70	76	KK23225	COMPRESSION SPRING 3225	\$0.44	1
CN70	77	CN37538	SPRING COLLAR (REPLACES CN31571)	\$4.36	1
CN70	78	JJ22407	RETAINING RING C26	\$1.54	5
CN70	79	CN35828	MAGAZINE COVER,---Replaces Old# CN33024, CN31580	\$12.24	1
CN70	82	CN37383	RECEIVER SPRING (REPLACES CN30602)	\$0.84	1
CN70	83	CN30601	SPACER	\$0.20	1
CN70	84	KK13144	TENSION SPRING 3144	\$1.20	1
CN70	85	CN31575	NAIL SUPPOR UNIT	\$14.74	1
CN70	86	CN31578	RUBBER PLATE	\$3.04	1
CN70	87	CN37530	MAGAZINE POST (REPLACES CN31579)	\$5.16	1
CN70	88	BB40487	SCREW M6X35	\$0.44	5
CN70	89	EE39608	POST RETAINER	\$0.94	1
CN70	90	FF41287	STEP PIN 1287	\$1.40	1
CN70	91	CN37545	MAGAZINE (REPLACES CN34431)	\$20.88	5
CN70	92	CN37535	CONTACT ARM COVER (REPLACES CN31566)	\$4.48	1
CN70	93	CN32170	COLLAR	\$1.14	1
CN70	94	CN31715	TRIGGER VALVE STEM	\$5.44	20
CN70	95	CN31716	TRIGGER VALVE CAP	\$25.54	1
CN70	96	KK23228	COMPRESSION SPRING 3228	\$0.98	1
CN70	97	CN34300	CONTACT LEVER	\$23.44	1
CN70	98	CN30276	TRIGGER	\$4.52	1
CN70	99	BB10401	HANGER	\$6.22	1
CN70	100	CN33627	PILOT VALVE	\$3.70	1
CN70	101	CN37547	HEAD VALVE WASHER (REPLACES CN34453)	\$4.14	1
CN70	102	FF21611	ROLL PIN 3X32 AW	\$0.20	10
CN70	103	CN80548	TRIGGER VALVE KIT (SN90A)	\$20.54	1