

# Maver

## INSTRUCTION MANUAL



**WIRELESS  
SPEAKER**



**10 MIN AUTO  
SHUT-OFF**



**RAPID  
CHARGE**



**AUTO  
DRAW**



**SAFE SESH  
MODE**



**PREP  
MODE**



**510  
THREAD**



# Maver

## WARRANTY INFORMATION

Enter the 6 digit authentication code printed on your battery, at [oozeflife.com/apps/product-registration](https://oozeflife.com/apps/product-registration) to register your product.



### POWER ON

To turn on, press the power button 5 times fast.

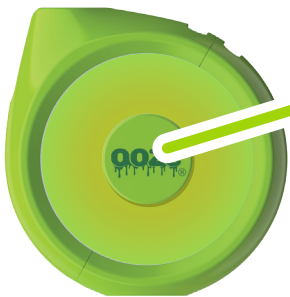

### GREEN LIGHT

Cartridge has been disconnected from Movez

Charging Complete



### RAINBOW LIGHT CYCLE

- When taking a pull from vape
- Speaker turned on
- Cycle restarts after you pull from device



### RED LIGHT

- While charging

**3x** Low battery warning when audio is paired

**4x** Connection error between cartridge & device

**5x** 10-Seconds Inhalation cycle completes

**10x** Low battery when smoking



### BLUE LIGHT

- Connection is made between cartridge & device

# Maver

## HOW TO USE

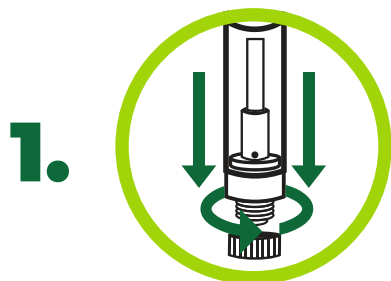

Screw the magnet adapter on bottom of cartridge



Drop cartridge with the magnetic adapter into the battery chamber.

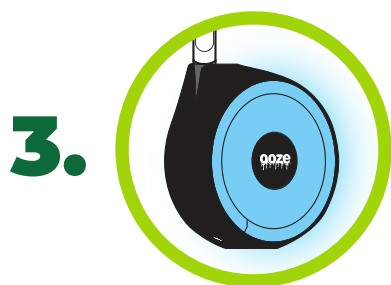

When your cartridge has made a connection to your device, a **blue light will flash once**.



**Take  
A Hit!**  
Auto Draw!

Just start inhaling! This provides a smoother, more accessible experience for those unable to operate devices with buttons.

# Mavez

## WIRELESS SETUP

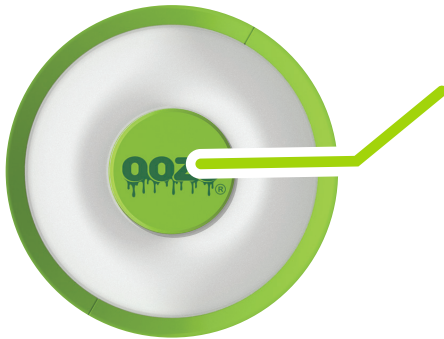

- 1.** Turn on device by pressing and holding center button for one second (You will hear 3 rising tones. The speaker is now on)
- 2.** Make Moves discoverable by holding the button down until rainbow cycle colors begin.

**3.** Select Movez in discoverable devices.

**4.** Pair with Movez and begin to play music!



## HOW TO CHARGE



### **Type-C:**

Plug the Type-C charging cord into the port located near the bottom.

### **Pass-Through Charging:**

Don't let low battery slow you down! Plug the battery in via Type-C and vape while it charges.