

DUPLEX

DUAL EXTRACT VAPORIZER

INSTRUCTION MANUAL



**ADJUSTABLE
VOLTAGE 3.4-4.0V**



**TML CERAMIC
GLASS OIL TANK**



**DUAL QUARTZ
WAX TANK**



**PRE-HEAT
MODE**



**USB
CHARGER**



**TRIGGER STYLE
BUTTON**



**MAGNETIC
CONNECTIONS**



**510
THREAD**



**900 MAH
BATTERY**



DUPLEX DUAL EXTRACT VAPORIZER

WARRANTY INFORMATION

Enter the 6 digit authentication code printed on your battery, at oozeflife.com/apps/product-registration to register your product.

ADAPTOR TIP

When using the adaptors, the **short adaptor** is made for the 1ml cartridges, while the **tall adaptor** is made for the .5ml cartridges and the Wax Atomizer.

POWER BUTTON



To turn ON and OFF, press the power button 5 times fast.

PREHEAT MODE



Once the Duplex is ON, press Power Button 2x quickly to begin preheat. Press Power Button 1 time to deactivate.

ADJUST VARIABLE VOLTAGE



Once the duplex is ON, press the power button 3 times quickly until the desired voltage is aquired.

- Red Light (4.0V)
- Orange Light (3.8V)
- Green Light (3.6V)
- Blue Light (3.4V)

CHARGING THE DUPLX



Attach the Duplex USB Charger into the charging port located on the front of the unit.

The USB LED indicator will turn **red** ● during the charging and **TURN OFF** when the charge is complete.

Total charge time is around 1 hour.

DUPLEX DUAL EXTRACT VAPORIZER

DUAL QUARTZ WAX ATOMIZER

HEATING
CHAMBER

MOUTHPIECE



HOW TO LOAD THE WAX ATOMIZER

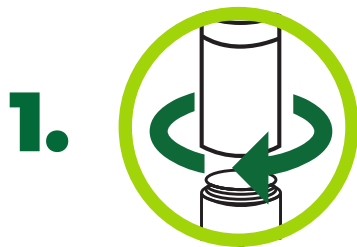

Unscrew the mouthpiece from the heating chamber.



Place extracts inside the heating chamber.



Screw the mouthpiece back onto the heating chamber.

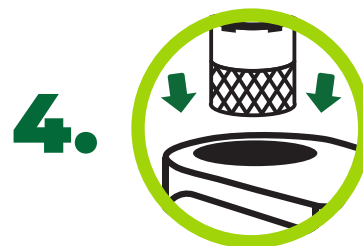

Place unit in battery

DUPLEX DUAL EXTRACT VAPORIZER

CERAMIC GLASS OIL TANK

MAGNETIC ADAPTOR



MOUTHPIECE

OIL RESIVOIR

HOW TO LOAD THE OIL TANK

1.



Unscrew the mouthpiece from the oil reservoir.

2.

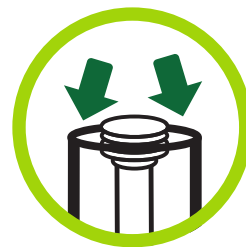

Place extracts on the side walls.

3.

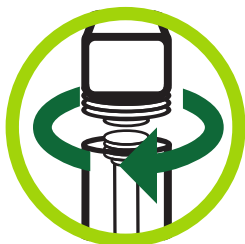

Screw the mouthpiece back onto the oil reservoir.

4.

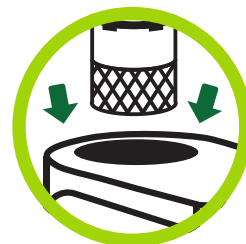

Place unit in battery