



Phoenix II Model #8612

Wood Stove Heater

Exploded Part Drawing, Revision 2.5

(from Serial #9761)

Production Dates: February 1999 -

Serial #: 006471 -

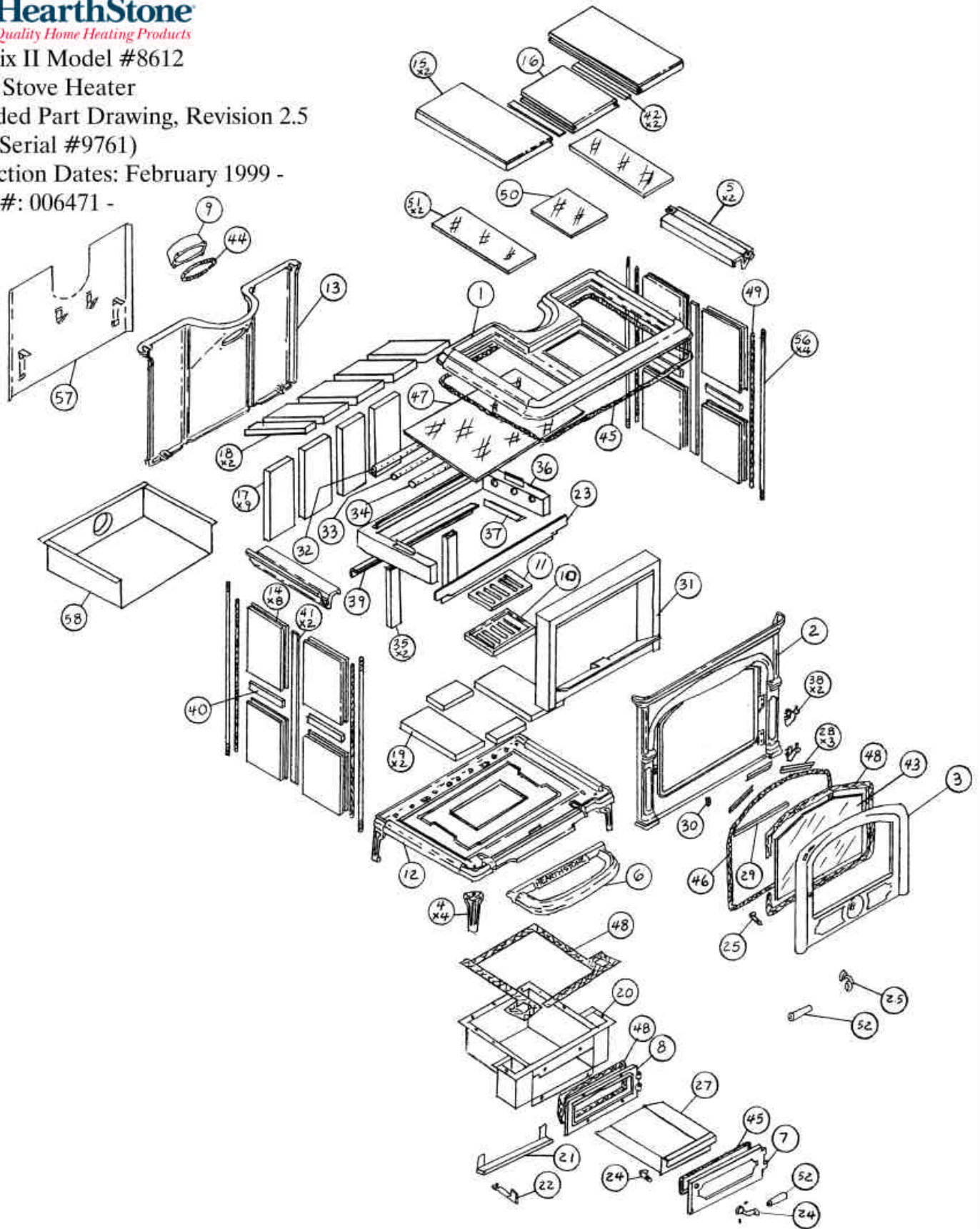



Model: Phoenix II #8612

Production Dates: February 1999 -

Serial #: 006471 -

Note: Color must be specified for cast iron parts which are available in enamel.

Key	Part #	Description
1	2610-003	Top Casting
2	2610-004	Front Panel (Prior to June '02 Serial # 006471-009731)
	2610-030	Front Panel (After June '02 Serial #009731)
3	2610-005	Front Door (Prior to June '02 Serial # 006471-009731)
	2610-040	Front Door (After June '02 Serial #009731)
4	2610-006A	Foot (Prior to June '02 Serial # 006471-009731)
	2610-000	Foot (After June '02 Serial #009731)
5	2610-009	Rib
6	2610-010	Ash Lip
7	2010-060	Ash Pan Door
8	2010-050	Ash Pan Door Frame
9	2610-016	Flue Collar
10	2610-017	Ash Grate Frame
11	2610-018	Ash Grate (Top)
12	2610-019	Bottom Casting
13	2610-020	Back Panel
14	1641-301	Side Stone 7 3/4" x 9 1/8"
15	1641-302	Top Stone Left/Right 6 17/32" x 16"
16	1641-303	Top Center Stone 10 3/4" x 11 1/8"
17	3060-426	Firebrick 4 1/2"x 9" x 1 1/4"
18	3060-427	Firebrick 1 15/16" x 9" x 1 1/4"
19	3060-428	Firebrick 5 3/8" x 11 3/4" x 1 1/4"
20	5012-052	Primary Air/Ash Box
21	5012-056	Primary Air Control Slider
22	5012-057	Primary Air Control Handle
23	5012-304	Baffle Support
24	90-73116	Ash Door Latch Assembly Includes: Set Screw (4) Spacer Handle Crank Spring

		Door Latch
25	96-73121	Front Latch Assembly
		Includes:
		Set Screw
		(4) Spacer
		Handle Crank
		Spring
		Door Latch
26		Chrome Crank (Included in Ash Door & Front Door Latch Assemblies)
27	5600-024	Ash Pan
28	5600-029J	Glass Retention Clip 3 1/2"
29	5600-029K	Glass Retention Clip 9 7/8"
30	5600-030	Front Door Latch Catch
31	5600-040	Primary Air Manifold
32	5600-041	Secondary Air Pipe (Rear)
33	5600-042	Secondary Air Pipe (Center)
34	5600-043	Secondary Air Pipe (Front)
35	5600-044	Secondary Air Riser Tube
36	5600-045	Secondary Air Manifold
37	5600-046	Secondary Air Pipe Retention Clip
38	96-58652	Hinge Assembly
		Includes:
		Phoenix Door Hinge
		(2) 1/4-20 Lock Nut
		(2) 1/4" Washer -Black
39	5600-054	Rear Firebrick Retention Bar
40	5000-008	Stone Spline 1/8" x 3/4" x 6 7/8"
41	5000-020	Stone Spline 1/8" x 3/4" x 10 3/8"
42	5000-014	Stone Spline 1/8" x 3/4" x 17 5/16"
43	96-58605	Phoenix Glass Kit
		Includes:
		Phoenix Glass IR 10 3/8" x 15 3/4" x 5mm
		(4 1/3') Gasket: Tape 3/4" Adhesive Backed
44	96-58601	Phoenix Gasket Kit
		Includes:
		(2 3/4')Gasket: Rope 1/4" Black Adhesive Backed
		(4 1/2')Gasket Rope 3/8" Adhesive Backed
		(4 1/3') Gasket Tape 3/4" Adhesive Backed
		Gasket Glue
45		Ash Pan Door Gasket 3/8" Medium Density (Included in Gasket Kit)
46		Front Door Gasket 3/8" Black (Included in Gasket Kit)
47	3120-210	Ceramic Blanket
48		Glass Gasket 3/4" (Included in Gasket Kit)
49	3110-051	Corner Gasket 1/2" Low Density Rope

50	3120-282	Ceramic Board 9" x 9 5/8"
51	3120-284	Ceramic Board 5 1/8" x 14 3/8"
52	90-71100	Wooden Handle Assembly
		Includes:
		Wood Handle
		1/4-20 x 3 1/4" Bolt
		(2) 1/4" Lock Washer
56	5210-3060	Threaded Rod 1/4-20 x 20 1/2"
57	96-58602	Rear Heat Shield (Optional)
58	96-56322	Outside Air Kit (Optional)