



# KING KING CANADA



## 950W PORTABLE GENERATOR



MODEL: KCG-951G

# INSTRUCTION MANUAL

COPYRIGHT © 2011 ALL RIGHTS RESERVED BY KING CANADA TOOLS INC.



## WARRANTY & SERVICE INFORMATION

**1-YEAR  
LIMITED WARRANTY  
FOR THIS 950W PORTATBLE GENERATOR**

**KING CANADA TOOLS  
OFFERS A 1-YEAR LIMITED WARRANTY  
FOR NON-COMMERCIAL USE.**



**BEFORE CALLING THE ABOVE TOLL-FREE NUMBER, PLEASE READ THIS MANUAL, SPECIFICALLY THE SAFETY PRECAUTIONS, THE INSPECTION BEFORE OPERATION AND THE TROUBLESHOOTING GUIDE.**

- **DO NOT RETURN THE DEFECTIVE PRODUCT TO THE RETAILER.**

### **WARRANTY INFORMATION**

#### **PROOF OF PURCHASE**

Please keep your dated proof of purchase for warranty and servicing purposes.

#### **REPLACEMENT PARTS**

Replacement parts for this generator are available at our authorized KING CANADA generator service centers across canada. For servicing, call the above toll free number to get servicing instructions and be sure to have your proof of purchase if you are claiming warranty work.

#### **LIMITED TOOL WARRANTY**

KING CANADA makes every effort to ensure that this product meets high quality and durability standards. KING CANADA warrants to the original retail consumer a 1-year limited warranty as of the date the product was purchased at retail and that each product is free from defects in materials.

#### **THIS WARRANTY IS NOT TRANSFERABLE AND DOES NOT COVER**

- Damage or liability caused by shipping, improper handling, improper installation, improper maintenance, improper modification, or the use of accessories and/or attachments not specifically recommended.
- Repairs necessary because of operator abuse or negligence, or the failure to install, operate, maintain, and store the product according to the instructions in the owner's manual.
- Damage caused by cold, heat, rain, excessive humidity, corrosive environments and materials, or other contaminants.
- Expendable items that become worn during normal use such as fuel filters, air cleaners, spark plugs, and engine oil.
- Cosmetic defects that do not interfere with product functionality.
- Freight costs from customer to an authorized warranty service location.
- Repair and transportation costs of products or parts determined not to be defective.
- ANY INCIDENTAL, INDIRECT OR CONSEQUENTIAL LOSS, DAMAGE, OR EXPENSE THAT MAY RESULT FROM ANY DEFECT, FAILURE OR MALFUNCTION OF THE PRODUCT.

- **RETAIN THE ORIGINAL CASH REGISTER SALES RECEIPT AS PROOF OF PURCHASE FOR WARRANTY WORK.**

KING CANADA shall in no event be liable for death, injuries to persons or property or for incidental, special or consequential damages arising from the use of our products. Shipping and handling charges may apply. If a defect is found, KING CANADA will either repair or replace the product.

# SAFETY INFORMATION, CONTROLS AND FUEL



## EXHAUST FUMES ARE DANGEROUS

- Never operate the engine in a closed area or it may cause unconsciousness and death within a short time. Operate in a well ventilated area.

## FUEL IS HIGHLY FLAMMABLE AND POISONOUS

- Always turn off the engine when refueling.
- Never refuel while smoking or in the vicinity of an open flame.
- When operating or transporting this generator, be sure to keep it upright. If it tilts, fuel may leak from the carburetor or fuel tank.

## ENGINE AND MUFFLER MAY BE HOT

- Place the generator in an appropriate location, away from children and pedestrians.
- Avoid placing any flammable materials near the exhaust outlet during operation.
- Keep a 2ft. clearance from buildings or other equipment around the generator to prevent overheating.

## ELECTRIC SHOCK PREVENTION

- Never operate in rain or snow.
- Never touch the generator with wet hands or electric shock can occur.
- Be sure to ground (earth) the generator. See Fig.3.

## ELECTRICAL CONNECTION NOTES

- Avoid connecting the generator to commercial power outlet.
- Avoid connecting the generator in parallel with any other generator.

## CONTROL FUNCTIONS

- 1) To turn generator "ON". Toggle switch (A) Fig.1 to the "ON" position. The engine can now be started.
- 2) Turning generator "OFF". Toggle switch to the "OFF" position. The engine will not run.

## AC BREAKER

The AC breaker turns off automatically when the load exceeds the generator rated output. Press the AC reset button (B) Fig.1 to reset the breaker. **Caution:** Reduce the load to within specified generator rated output if AC breaker turns off.

## PRE-OPERATION CHECK

Note: Pre-operation checks should be done every time you use your generator.

**WARNING!** The engine muffler will be very hot after use, avoid touching the engine or muffler while they are still hot.

## FUEL

### WARNING!

- Fuel is highly flammable. Check safety rules carefully before refueling.

Make sure there is sufficient fuel in the tank.

**Recommended fuel: Oil-Mixed Gasoline**

**Fuel Tank Capacity: 4.2L**

- Use oil-mixed gasoline, or engine will overheat. Mix ratio is 50:1.**

- Use clean, fresh unleaded gasoline with a minimum of 77 octane.
- Use special purpose oil for 2-stroke engine.
- Do not fill above the fuel fill or it may overflow, add fuel until it reaches 1 inch away from the top of the fuel filter.
- Secure gas cap after filling.

Use the fill cap located under the gas cap to measure the gasoline and oil mixture necessary. See Fig.2 for fill measurements.

## GROUNDING

Before operating make sure to ground the generator. A hex. bolt (A) Fig.3 next to the ground symbol can be found on the left side of the generator, attach a wire and ground it as shown in Fig.3. Your local electrical company or certified electrician should be able to help you with this information. Note: Your engine is already grounded to the frame with a ground wire.

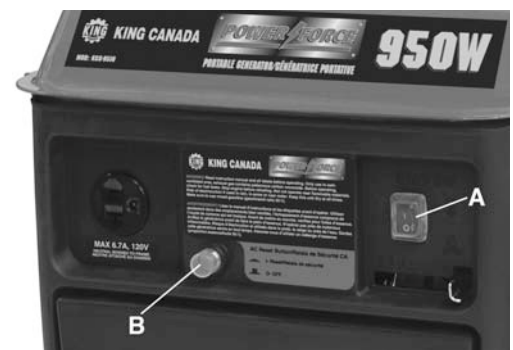

Figure 1

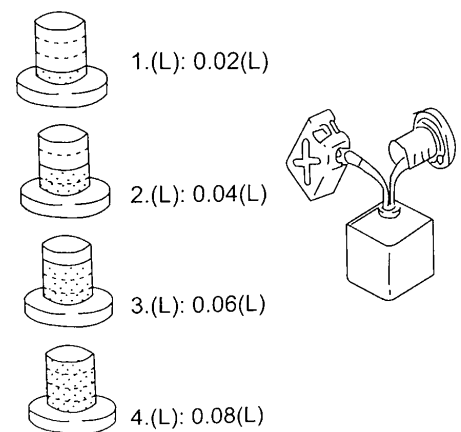

Figure 2

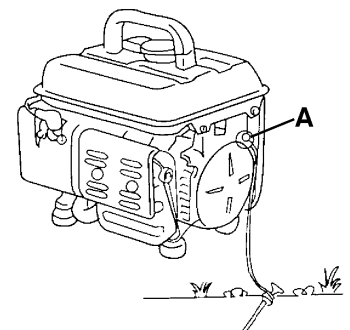

Figure 3



# OPERATION & MAINTENANCE

## STARTING THE ENGINE

Note: Before attempting to start engine, first it is recommended to assemble the top handle to the top of the fuel tank using the 2 pan hd screws, washers and spring washers.

### WARNING! Before starting the engine, do not connect the electric apparatus.

1. Turn the fuel cock lever (A) Fig.4 downwards to the "ON" open position.
2. Pivot the choke lever (B) to the far left position. The choke is not required to start a warm engine.
3. Push the engine switch (C) to "ON".
4. Pull slowly on the recoil starter (D) until it is engaged, then pull it briskly. Take your hand off the recoil starter immediately after the engine starts.
5. Warm up the engine. Move choke lever (E) toward the operating position a short distance at a time over several seconds in warm weather or minutes in cold weather. Let engine run smoothly before each change.
6. Move the choke lever back to the operating position (E).

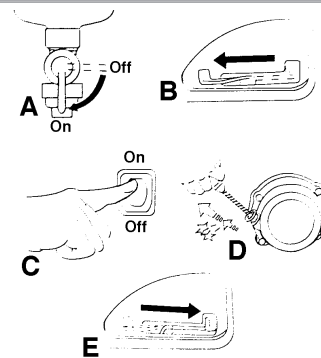

Figure 4

## CONNECTION

**Warning!** Potential hazards exist when a portable generator is connected to the main electrical supply coming from the house. It is at that point that the generator could feed back into the utility company's system causing possible electrocution of workers who are repairing the electrical lines.

## AC CURRENT

**CAUTION:** Be sure the electric apparatus is turned off before plugging in. Be sure the total load is within generator rated output.

1. Start the engine.
2. Plug electrical appliance into the 120V AC socket. See fig.5.
3. Turn on the electric apparatus. Reduce the load to within specified generator rated output if the AC breaker turns off.

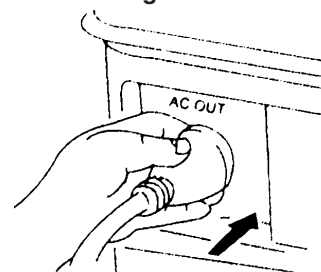

Figure 5

## STOPPING THE ENGINE

To stop the engine, first turn off all electric appliances. Then turn engine switch to "OFF" and turn fuel cock to the "OFF" closed position.

## EXTENSION CORDS

The use of any extension cord will cause some loss of power. Use the chart to determine the minimum wire size (A.W.G-American Wire Gauge) extension cord. Use only extension cords which accept the tool's plug.

### LENGTH OF CONDUCTOR

0-100 FEET

### WIRE SIZES REQUIRED (AMERICAN WIRE GAUGE)

120V LINES  
NO.12

## PERIODIC MAINTENANCE

### MAINTENANCE CHART

Regular maintenance is most important for best performance and safe operation. See maintenance chart for schedule.

Item	Remarks	Pre-Operation check (daily)	Initial 1 month or 20 Hr	Every 3 months or 50 Hr	Every 6 months or 100 Hr	Every 12 months or 300 Hr
Spark Plug	Check condition, adjust gap and clean. Replace if necessary.			●		
Air Filter	Clean. Replace if necessary.			●		
Fuel Filter	Clean fuel filter. Replace if necessary.				●	
Fuel Line	Check fuel hose for crack or damage. Replace if necessary.	●				
Exhaust System	Check for leakage. Retighten or replace gasket if necessary.	●				
	Check muffler screen.				●	
Carburetor	Check choke operation.	●				
Cooling System	Check fan damage.					●
Starting System	Check recoil starter operation.	●				
Decarbonization	Clean more frequently if necessary.					●
Fittings/Fasteners	Check all fittings and fasteners correct if necessary.				●	

# MAINTENANCE



## AIR FILTER

1. Remove foam air filter. See Fig.6.
2. Wash in solvent.
3. Soak in motor oil (SAE#20)
4. Gently squeeze out motor oil. **CAUTION:** Do not wring out the element. Never operate without a filter in place.

## SPARK PLUG INSPECTION

1. Remove spark plug cap and then spark plug using the supplied key. See Fig.7.
2. Remove carbon deposits.
3. Check for discoloration. Standard electrode color: Tan Color
4. Check spark plug gap: 0.7-0.8mm (0.028-0.031")
5. If spark plug needs to be replaced, replace with F5TC spark plug or equivalent (NGK-BP5ES, Champion-N14Y).

## FUEL TANK FILTER

1. Stop engine and turn fuel cock lever to the "OFF" closed position.
2. Clean tank filter with solvent. See Fig.8.
3. Wipe off and reposition fuel filter and fuel cap. Be sure the fuel cap is tightened securely.

## TROUBLESHOOTING

### ENGINE WON'T START

#### 1. Fuel systems

No fuel supplied to combustion chamber.

- No fuel in tank -- Supply fuel
- Clogged fuel line -- Clean fuel line.
- Foreign matter in fuel cock -- Clean fuel cock.
- Clogged carburetor -- Clean carburetor.

#### 2. Electrical systems

Poor spark

- Spark plug dirty with carbon or wet -- Remove carbon or wipe spark plug.

#### 3. Compression insufficient

- Worn out piston and cylinder -- Consult service centre.
- Loose cylinder head nuts -- Tighten nuts properly.

#### 4. Storage

Long-term storage of your machine will require some preventive procedures to guard against deterioration. Drain the fuel tank, fuel cock, and carburetor float bowl or add fuel stabilizer and run engine for 5 minutes.

## ENGINE

1. Pour in about one tablespoon of SAE 10W30 or 20W40 motor oil through the spark plug hole.
2. Use the recoil starter to turn the engine over several times (with ignition off).
3. Pull the recoil starter until you feel compression.
4. Stop pulling.
5. Clean exterior of the generator and apply a rust inhibitor.
6. Store the generator in a dry, well-ventilated place, with a cover placed over it.
7. The generator must remain in a horizontal position.

## PARTS DIAGRAM & PARTS LISTS

Refer to the Parts section of the King Canada web site for the most updated parts diagram and parts list.

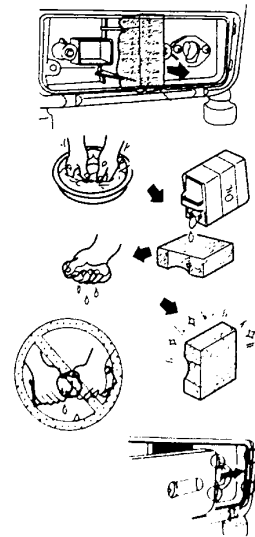

Figure 6

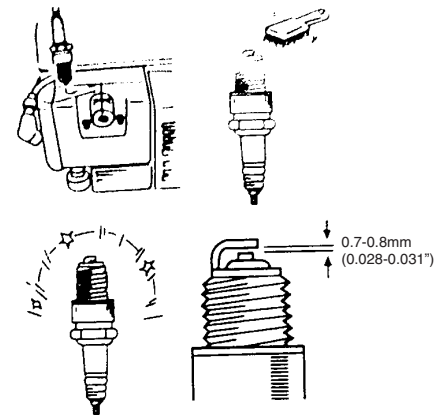

Figure 7

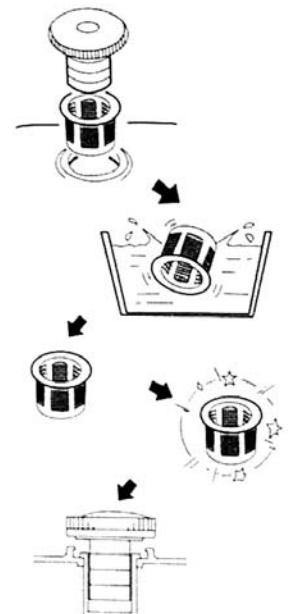

Figure 8