



## 5 HP DUST COLLECTOR



MODEL: KC-5043FX

# INSTRUCTION MANUAL

COPYRIGHT © 2009 ALL RIGHTS RESERVED BY KING CANADA TOOLS INC.



## IMPORTANT WARRANTY INFORMATION

**2-YEAR LIMITED WARRANTY FOR THIS DUST COLLECTOR**

**KING CANADA TOOLS OFFERS A 2-YEAR LIMITED WARRANTY FOR INDUSTRIAL USE.**

### PROOF OF PURCHASE

Please keep your dated proof of purchase for warranty and servicing purposes.

### REPLACEMENT PARTS

Replacement parts for this product are available through our authorized King Canada service centers across Canada. Please refer to the Parts section of the King Canada web site ([www.kingcanada.com](http://www.kingcanada.com)) for parts diagram and parts list.

### LIMITED TOOL WARRANTY

King Canada makes every effort to ensure that this product meets high quality and durability standards. King Canada warrants to the original retail consumer a 2-year limited warranty as of the date the product was purchased at retail and that each product is free from defects in materials. Warranty does not apply to defects due directly or indirectly to misuse, abuse, normal wear and tear, negligence or accidents, repairs done by an unauthorized service center, alterations and lack of maintenance. King Canada shall in no event be liable for death, injuries to persons or property or for incidental, special or consequential damages arising from the use of our products.

To take advantage of this limited warranty, return the product at your expense together with your dated proof of purchase to an authorized King Canada service center. Contact your retailer or visit our web site at [www.kingcanada.com](http://www.kingcanada.com) for an updated listing of our authorized service centers. In cooperation with our authorized serviced center, King Canada will either repair or replace the product if any part or parts covered under this warranty which examination proves to be defective in workmanship or material during the warranty period.

### NOTE TO USER

This instruction manual is ment to serve as a guide only. Specifications and references are subject to change without prior notice.

**KING CANADA INC. DORVAL, QUÉBEC, CANADA H9P 2Y4**  
**[www.kingcanada.com](http://www.kingcanada.com)**

## GENERAL SAFETY RULES FOR POWER TOOLS



### 1. KNOW YOUR TOOL

Read and understand the owners manual and labels affixed to the tool. Learn its application and limitations as well as specific potential hazards.

### 2. GROUND THE TOOL.

This tool is equipped with an approved 3-conductor cord and a 3-prong grounding type plug to fit the proper grounding type receptacle. The green conductor in the cord is the grounding wire. **NEVER** connect the green wire to a live terminal.

### 3. KEEP GUARDS IN PLACE.

Keep in good working order, properly adjusted and aligned.

### 4. REMOVE ADJUSTING KEYS AND WRENCHES.

Form habit of checking to see that keys and adjusting wrenches are removed from tool before turning it on.

### 5. KEEP WORK AREA CLEAN.

Cluttered areas and benches invite accidents. Make sure the floor is clean and not slippery due to wax and sawdust build-up.

### 6. AVOID DANGEROUS ENVIRONMENT.

Don't use power tools in damp or wet locations or expose them to rain. Keep work area well lit and provide adequate surrounding work space.

### 7. KEEP CHILDREN AWAY.

All visitors should be kept at a safe distance from work area.

### 8. MAKE WORKSHOP CHILD-PROOF.

Use padlocks, master switches or remove starter keys.

### 9. WEAR PROPER APPAREL.

Do not wear loose clothing, gloves, neckties or jewelry (rings, watch) because they could get caught in moving parts. Non-slip footwear is recommended. Wear protective hair covering to contain long hair. Roll up long sleeves above the elbows.

### 10. ALWAYS WEAR SAFETY GLASSES.

Always wear safety glasses (ANSI Z87.1). Everyday eyeglasses only have impact resistant lenses, they are **NOT** safety glasses. Also use a face or dust mask if operation is dusty.

### 11. AVOID ACCIDENTAL STARTING.

Make sure the switch is in the "OFF" position before plugging in.



## SPECIFIC SAFETY RULES FOR YOUR DUST COLLECTOR

**CAUTION:** If using this dust collector to keep airborne wood dust in heavy usage within acceptable limits, you must regularly monitor airborne dust and maintain the dust collector to avoid exceeding dust limits. Each application is unique. Your maintenance schedule must therefore be tailored to your specific use. Safety is a combination of common sense, staying alert and knowing how your dust collector works.

**WARNING:** TO AVOID MISTAKES THAT COULD RESULT IN SERIOUS, PERMANENT INJURY, DO NOT CONNECT THE POWER CORD UNTIL THE FOLLOWING STEPS HAVE BEEN COMPLETED:

1. Assembly, mounting and alignment.
2. Learn the function and proper use of the "ON/OFF" switch.
3. Read and understand all instructions and operating procedures throughout the manual.

### BEFORE EACH USE:

1. Inspect your dust collector. If any parts are missing, bent, or fail in any way, or any electrical components do not work properly, turn off the dust collector, remove the switch key and remove the power cord from the power supply. Replace damaged, missing or failed parts before using the dust collector again.
2. Plan your work to protect your eyes, hands, face, ears and body.
3. **WEAR SAFETY GOGGLES.** "FORE-SIGHT IS BETTER THAN NO SIGHT".

Wear safety goggles, not glasses, that comply with ANSI Z87.1. Operating any power tool can result in foreign objects being thrown into the eyes which can result in permanent eye damage.

4. When cleaning the dust collector bags, wear a dust mask.

This dust collector is specifically designed to capture sawdust and wood chips at the source. The fine dust is filtered by the upper dust bag while the heavier particles settle in the lower dust bag for easy removal. **DO NOT USE AS A VACUUM.**

**CAUTION:** The blower housing contains a high speed fan blade that can amputate fingers, grab loose clothing and neckties, or propel dust at high velocities. **DO NOT OPERATE WITHOUT ALL PARTS IN PLACE.**

Do not attempt to clean, remove dust bags or service while in operation. Disconnect from power source.

**IMPORTANT NOTE:** Static shock is common in dry areas or when the relative humidity of the air is low. To reduce the frequency of static shock in your home, the best remedy is to add moisture to the air with a console or installed humidifier.

# UNPACKING & CHECKING CONTENTS



## UNPACKING AND CHECKING CONTENTS

**WARNING:** IF ANY PARTS ARE MISSING OR BROKEN, GET THE PROPER PARTS REPLACED BEFORE ASSEMBLY OR USE OF THIS DUST COLLECTOR.

Remove entire contents of carton. Check each item against the loose parts list. Notify your KING CANADA retailer immediately if any parts are damaged or missing. This dust collector is intended for either commercial or for household use.

## LOOSE PARTS LIST

- 1) Motor and housing impeller .....1
- 2) Adaptor (8")-4 (4").....1
- 3) Housing.....2
- 4) Leg support.....2
- 5) Support bracket .....2
- 6) Upper hanger .....2
- 7) Lower hanger .....2
- 8) Base .....1
- 9) Lower dust bag .....2
- 10) Hardware bag .....1
- 11) Retainer strap (bag) .....4
- 12) Caster (bag) .....4
- 13) Manual .....1
- 14) Upper dust bag .....2

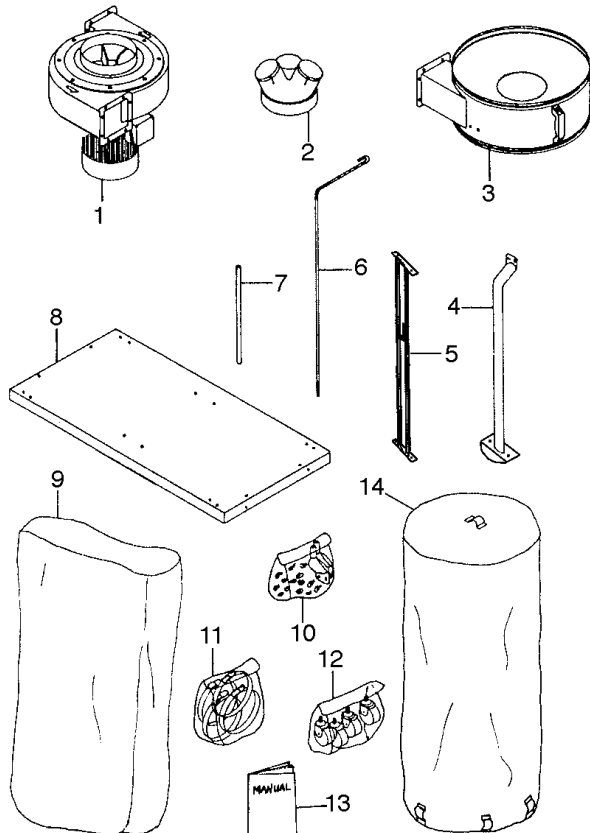

# ASSEMBLY INSTRUCTIONS

## MOUNTING THE PIVOTING CASTORS TO THE BASE

Place the base upside down and fix the 4 castors using lock washers and hex. nuts. See Fig.1.

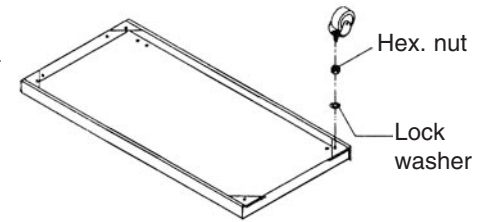

Figure 1

## MOUNTING THE SUPPORT BRACKETS TO THE BASE

Mount one support bracket at a time to the base using hex. bolts and washers. See Fig. 2. **NOTE:** Once this assembly is done, note that the support bracket with the welded switch bracket is now the front of the dust collector.

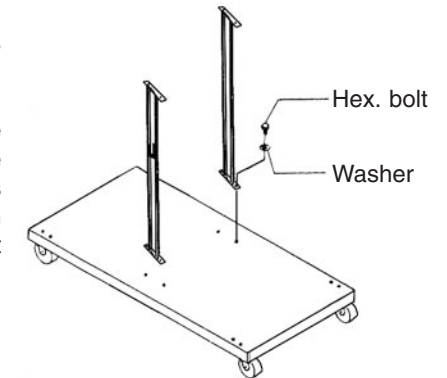

Figure 2

## MOUNTING THE SUPPORT LEGS TO THE BASE

Mount one support leg one at a time to the base using hex. bolts and washers. See Fig. 3.

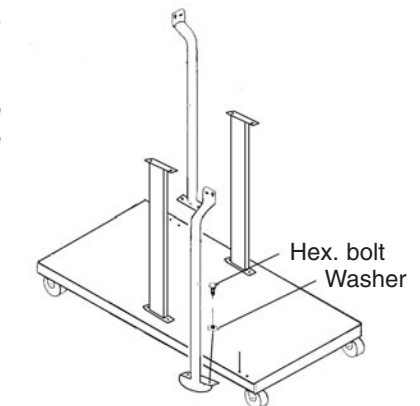

Figure 3

# ASSEMBLY INSTRUCTIONS



## MOUNTING THE IMPELLER HOUSING TO THE SUPPORT BRACKETS

Place the impeller housing onto the support brackets (It is recommended that you get assistance for this assembly; the impeller housing is heavy and awkward). Fix the impeller housing using hex. bolts, lock washers and washers. See Fig.4.

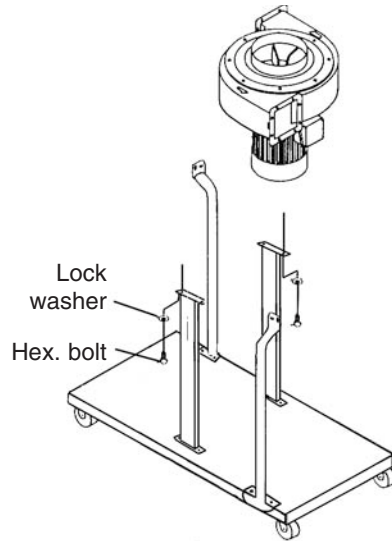

Figure 4

## MOUNTING THE HOUSINGS AND HANGER BRACKETS TO THE IMPELLER HOUSING

- 1) Fix the housings to the impeller housing using hex. bolts, washers, lock washers and hex. nuts. See Fig.5.
- 2) Now the support legs must be fixed to the housings but don't forget the hanger brackets. The hanger brackets must be placed between the housing and the support leg, see Fig.5. Fix them using hex. bolts and lock washers.

## MOUNTING THE BAG HANGERS TO THE HANGER BRACKETS

Insert lower hanger into the hanger bracket and then insert the upper hanger into the lower hanger and secure with fixing screw, see Fig.5.

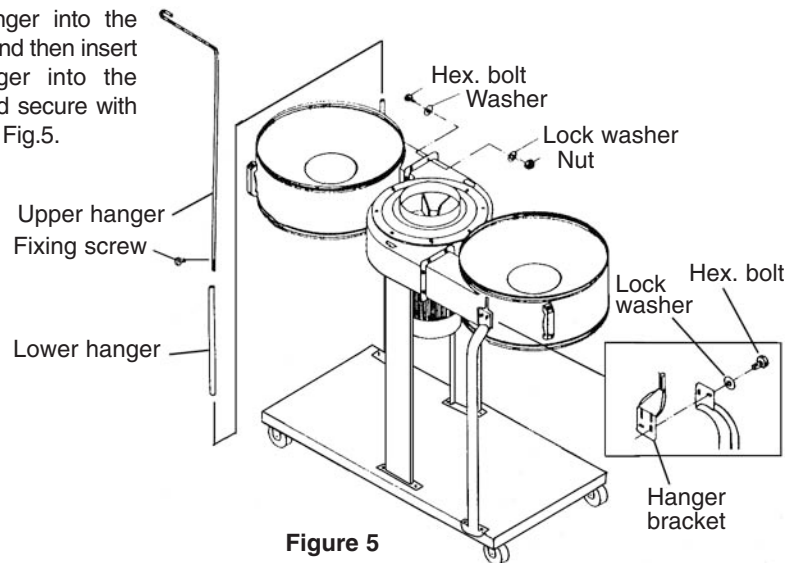

Figure 5



# ASSEMBLY INSTRUCTIONS

## MOUNTING THE SWITCH TO THE FRONT SUPPORT BRACKET

Simply slide the switch into the switch bracket, see Fig.6.

## MOUNTING THE DUST BAGS TO THE HOUSINGS AND THE HANGERS

Insert a retainer strap through the keepers of one of the filter bags (top bag) and attach it to the top part of one of the housings. Repeat this step for the second filter bag.

Insert a retainer strap through the keepers of one of the collection bags (bottom bag) and attach it to the bottom part of the housing. Repeat this step for the second collection bag.

## ADAPTOR

Place adaptor onto the top of the impeller housing.

At this point, your dust collector is assembled and should look like the picture in Fig.7.

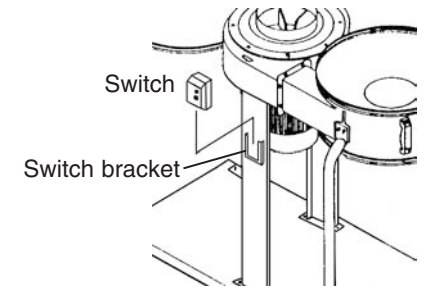

Figure 6



Figure 7

## OPERATION & MAINTENANCE



**WARNING:** NEVER PERFORM MAINTENANCE ON THIS MACHINE BEFORE TURNING THE SWITCH TO THE "OFF" POSITION AND REMOVING THE PLUG FROM THE POWER SOURCE.

### SWITCH

The magnetic switch is attached to the front housing support; it is an industrial type switch with standard "START" and "STOP" push buttons as shown in Fig.8.

### MOTOR

Motors used in woodworking environments are constantly exposed to sawdust and wood chips. The operator should make frequent inspections of the motor and remove, or vacuum any accumulations of foreign material in order to maintain normal motor ventilation.

Remove the dust from the motor with a low pressure air hose.

**CAUTION:** The operator should follow all safety procedures regarding dust particles and always wear safety glasses and a filter mask during any cleaning operation.

### DUST BAGS: UPPER & LOWER

Each operator has his own particular application for woodworking machinery. As such, a maintenance schedule for the dust collector must be performed on a regular and timely basis.

To remove dust and chips:

1. Disconnect the machine from its power source.
2. Shake the upper dust bag and allow the fine dust to settle down into the lower collection bag.

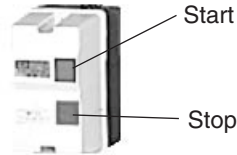

Figure 8

3. Release the retainer strap around the upper bag, remove the upper filtration bag and deposit chips and dust into a fire-proof metal container.
4. Release the retainer strap around the lower bag, remove the lower collection bag and deposit chips and dust into a fire-proof metal container.
5. Reconnect both sets of dust bags, make sure the retainer straps firmly secure the bags to the upper and lower chute extensions.

**WARNING:** CHECK WITH A QUALIFIED ELECTRICIAN OR A QUALIFIED SERVICE TECHNICIAN IF YOU ARE IN DOUBT AS TO WHETHER THE OUTLET HAS THE PROPER CONFIGURATION FOR 220V OR 600V. DO NOT ALTER OR MODIFY THE DUST COLLECTOR PLUG. IF IT WILL NOT FIT THE OUTLET, HAVE THE PROPER OUTLET INSTALLED BY A QUALIFIED ELECTRICIAN.

**WARNING:** TO AVOID SHOCK OR FIRE, IF THE POWER CORD IS WORN, CUT, OR DAMAGED IN ANY WAY, HAVE IT REPLACED IMMEDIATELY.



## TROUBLESHOOTING

PROBLEM	PROBABLE CAUSE	REMEDY SUGGESTED
Motor will not run.	<ol style="list-style-type: none"> <li>1. Defective cord, plug, switch and/or motor.</li> <li>2. Blown fuse or circuit breaker tripped.</li> </ol>	<ol style="list-style-type: none"> <li>1. Consult service. Any attempt to repair this motor may create a hazard unless repair is done by a qualified service technician. Repair service is available at your nearest service center.</li> <li>2. Check for blown fuses and replace with fuse of proper capacity.</li> </ol>
Excessive sawdust in air.	<ol style="list-style-type: none"> <li>1. Loose retainer strap.</li> <li>2. Filter/dust bag and/or collector bag releasing sawdust.</li> </ol>	<ol style="list-style-type: none"> <li>1. Tighten retainer straps.</li> <li>2.a. Sawdust trapped between clamp bag and housing.</li> <li>b. Lower bag is hung up on sawdust shoot extension. Reposition bag properly.</li> </ol>
Excessive impeller noise.	<ol style="list-style-type: none"> <li>1. Picked up large wood chips and debris.</li> <li>2. Loose impeller.</li> <li>3. Rubbing impeller.</li> </ol>	<ol style="list-style-type: none"> <li>1. Do not pick up metal or ferrous materials. Stop the machine and the material will fall to the bottom of the inlet tube.</li> <li>2. Unplug dust collector prior to disassembly. Hazardous moving parts inside. Attach inlet guard before plugging in. Use a piece of wood to free impeller.</li> <li>3. Consult service to repair loose or rubbing impeller. A repair to the housing may create a hazard unless it is done by a qualified service technician. Servicing is available at your nearest service center.</li> </ol>
Motor fails to develop full power. NOTE: LOW VOLTAGE (Power output of motor decreases rapidly with decrease in voltage at the motor terminals.)	<ol style="list-style-type: none"> <li>1. Motor.</li> <li>2. Overloaded circuit.</li> <li>3. Undersized extension cord or extension cord too long.</li> </ol>	<ol style="list-style-type: none"> <li>1. Have motor checked out by a qualified service technician.</li> <li>2. Do not overload circuit when using dust collector with other machines.</li> <li>3. Increase the wire sizes on extension cord, reduce length or use large wire sizes.</li> </ol>
Motor starts slowly or fails to come up to speed.	<ol style="list-style-type: none"> <li>1. Low voltage.</li> <li>2. Windings are burned out or open.</li> <li>3. Starting switch will not operate.</li> </ol>	<ol style="list-style-type: none"> <li>1. Request voltage check from your power company.</li> <li>2. Have motor repaired or replaced by a qualified service technician.</li> <li>3. Have capacitor replaced by a qualified service technician.</li> </ol>
Motor overheats.	<ol style="list-style-type: none"> <li>1. Motor overloaded.</li> <li>2. Improper cooling, air circulation is restricted through motor due to sawdust accumulation.</li> </ol>	<ol style="list-style-type: none"> <li>1. Clean out sawdust to provide normal air circulation through the motor. See "Maintenance" section in this manual.</li> </ol>