

SOHO

C O L L E C T I O N

Design • Evolution



Endless Functionality

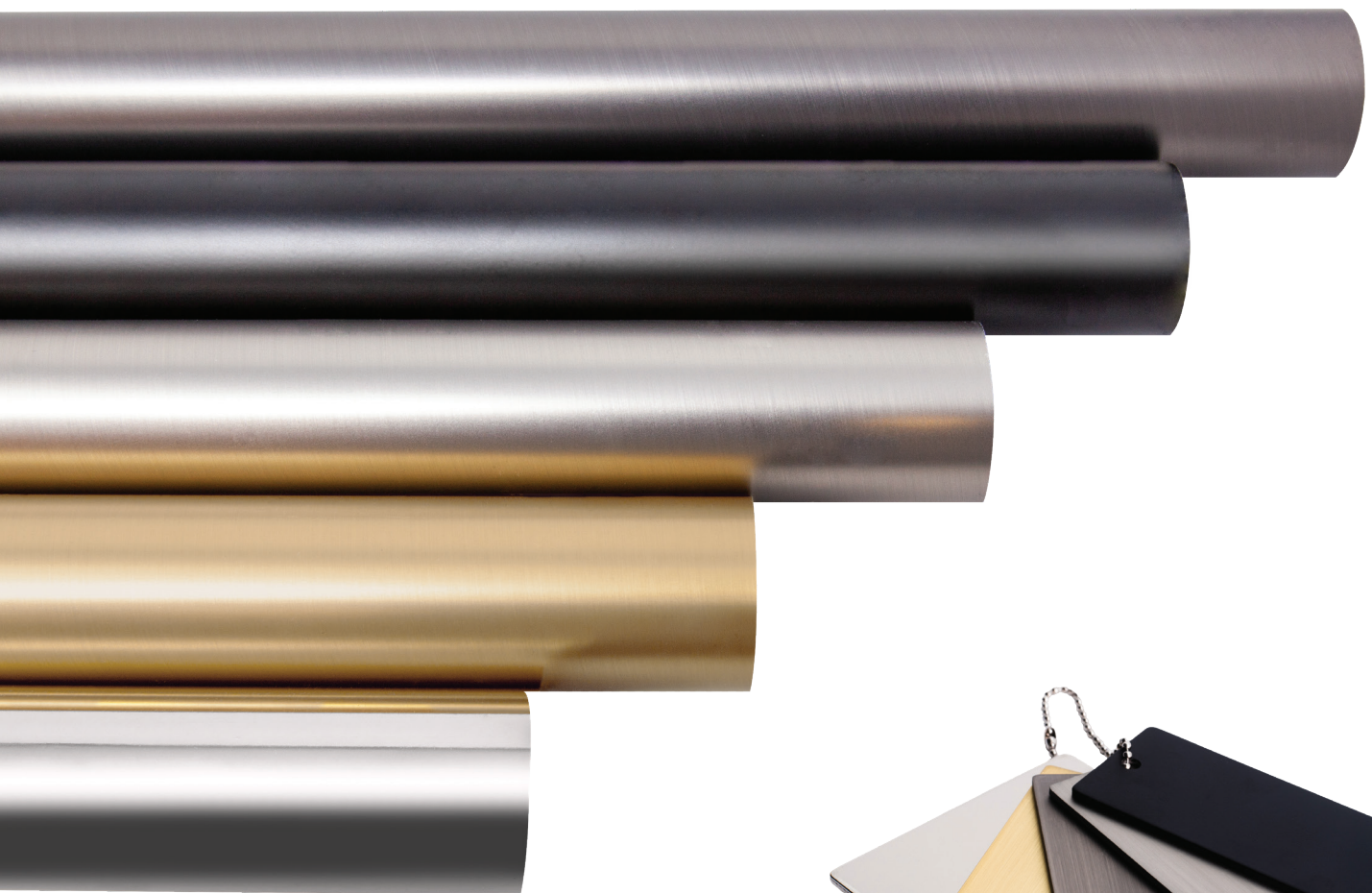



Design Revolution

Trax Drapery Hardware™ was founded on the principle that innovation, design, and quality do not need to be sacrificed to provide exceptional value. Offering a wide range of in-stock and ready-to-ship hardware, Trax Drapery Hardware™ has evolved and developed an extensive range of exclusive products, designs, and colors. The Soho Collection's commitment to continual advancement can be seen in our new patent pending installation assembly. The new mounting system simplifies the installation process and offers strength in the areas where it's needed the most while respecting customers' expectations of design and value.

The Soho Collection is the latest addition to the Trax Drapery Hardware™ range of products. The collection offers a wide range of finial designs in five designer colors. From modern to elegant, every curve has been carefully designed to enhance any room's

decor. Colors have been carefully selected, from Polished Nickel to Matte Black and Brushed Brass combinations, the design possibilities are endless.

Offering the widest range of components and accessories, the Soho Collection has been engineered for installation precision. Every component of this collection has been carefully engineered to meet almost every installation situation imaginable. Flush-mounted ceiling brackets allow channel rods to be mounted without a ceiling gap, while extra-strong channel rod joints allow for a more seamless joint over long spans and placement of a bracket at the center of the joint.

As we continue our never-ending goal of achieving design evolution, we trust that The Soho Collection will meet our discerning customer's technical and design needs.

NOTE: Sizes are approximate. Pictures of products may not be exact color.

Finials

Rod
Compatibility



SFN1 AP

Color: 
Antique Pewter: AP
Sold in Pairs



SFN1 BB

Color: 
Brushed Brass: BB
Sold in Pairs



SFN1 MB

Color: 
Matte Black: MB
Sold in Pairs



SFN1 PN

Color: 
Polished Nickel: PN
Sold in Pairs



SFN1 SN

Color: 
Satin Nickel: SN
Sold in Pairs



Dimensions

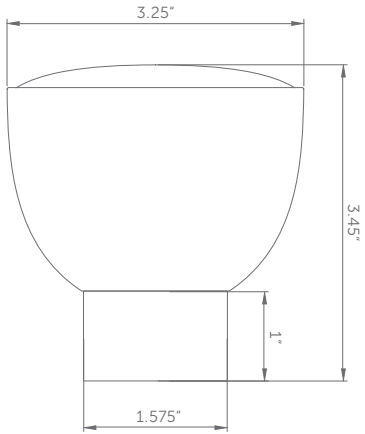

NOTE: Pair of SFN1 finials adds 5.5" to the total finished rod width.

Finials

Rod
Compatibility



SFN2 AP

Color: 
Antique Pewter: AP
Sold in Pairs

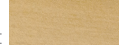

SFN2 BB

Color: 
Brushed Brass: BB
Sold in Pairs



SFN2 MB

Color: 
Matte Black: MB
Sold in Pairs



SFN2 PN

Color: 
Polished Nickel: PN
Sold in Pairs



SFN2 SN

Color: 
Satin Nickel: SN
Sold in Pairs



Dimensions

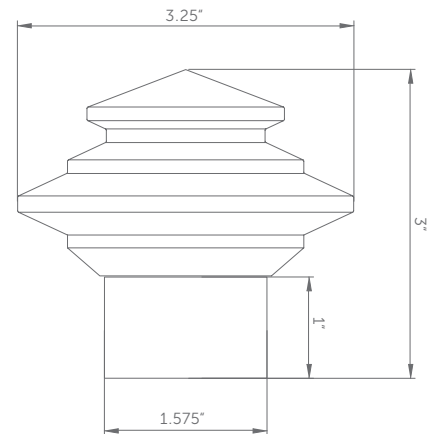

NOTE: Pair of SFN2 finials adds 4.5" to the total finished rod width.

Finials

Rod
Compatibility



SFN3 AP



Color: 
Antique Pewter: AP
Sold in Pairs

SFN3 BB



Color: 
Brushed Brass: BB
Sold in Pairs

SFN3 MB



Color: 
Matte Black: MB
Sold in Pairs

SFN3 PN



Color: 
Polished Nickel: PN
Sold in Pairs

SFN3 SN



Color: 
Satin Nickel: SN
Sold in Pairs

Dimensions

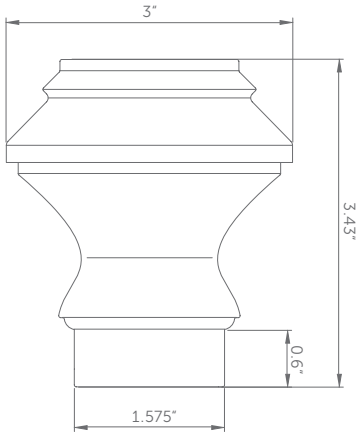

NOTE: Pair of SFN3 finials adds 5.5" to the total finished rod width.

Finials

Rod
Compatibility



SFN4 AP



Color: 
Antique Pewter: AP
Sold in Pairs

SFN4 BB



Color: 
Brushed Brass: BB
Sold in Pairs

SFN4 MB



Color: 
Matte Black: MB
Sold in Pairs

SFN4 PN



Color: 
Polished Nickel: PN
Sold in Pairs

SFN4 SN



Color: 
Satin Nickel: SN
Sold in Pairs

Dimensions

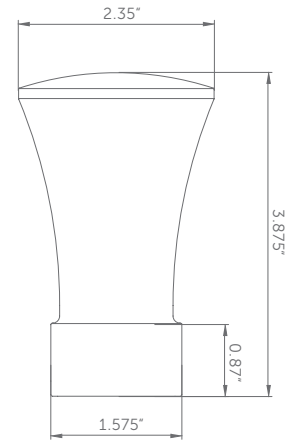

NOTE: Pair of SFN4 finials adds 6.5" to the total finished rod width.

Finials

Rod
Compatibility



SFN5 AP



Color: 
Antique Pewter: AP
Sold in Pairs

SFN5 BB



Color: 
Brushed Brass: BB
Sold in Pairs

SFN5 MB



Color: 
Matte Black: MB
Sold in Pairs

SFN5 PN



Color: 
Polished Nickel: PN
Sold in Pairs

SFN5 SN



Color: 
Satin Nickel: SN
Sold in Pairs

Dimensions

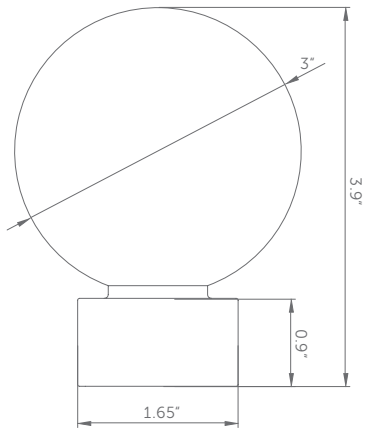

NOTE: Pair of SFN5 finials adds 6.5" to the total finished rod width.

Finials

Rod
Compatibility



SFN6 AP



Color: 
Antique Pewter: AP
Sold in Pairs

SFN6 BB



Color: 
Brushed Brass: BB
Sold in Pairs

SFN6 MB

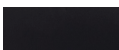

Color: 
Matte Black: MB
Sold in Pairs

SFN6 PN



Color: 
Polished Nickel: PN
Sold in Pairs

SFN6 SN



Color: 
Satin Nickel: SN
Sold in Pairs

Dimensions

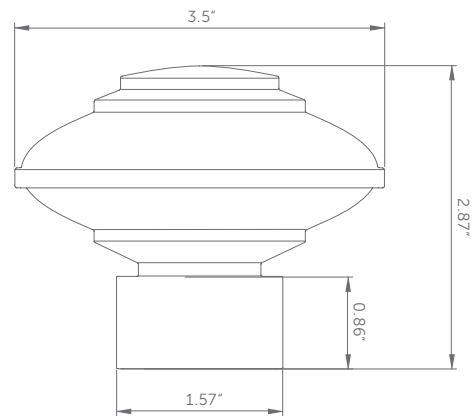

NOTE: Pair of SFN6 finials adds 4.5" to the total finished rod width.

Finials

Rod
Compatibility



SFN7 AP



Color: 
Antique Pewter: AP
Sold in Pairs

SFN7 BB



Color: 
Brushed Brass: BB
Sold in Pairs

SFN7 MB



Color: 
Matte Black: MB
Sold in Pairs

SFN7 PN



Color: 
Polished Nickel: PN
Sold in Pairs

SFN7 SN

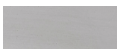

Color: 
Satin Nickel: SN
Sold in Pairs

Dimensions

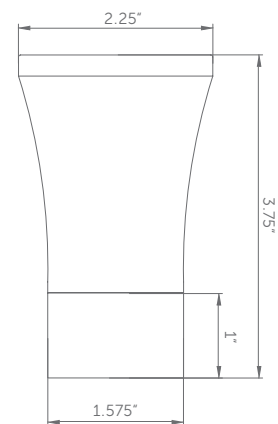

NOTE: Pair of SFN7 finials adds 6.25" to the total finished rod width.

Finials

Rod
Compatibility



SFN8 AP



Color: 
Antique Pewter: AP
Sold in Pairs

SFN8 BB



Color: 
Brushed Brass: BB
Sold in Pairs

SFN8 MB



Color: 
Matte Black: MB
Sold in Pairs

SFN8 PN



Color: 
Polished Nickel: PN
Sold in Pairs

SFN8 SN



Color: 
Satin Nickel: SN
Sold in Pairs

Dimensions

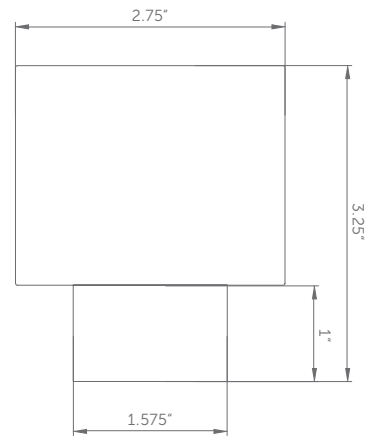

NOTE: Pair of SFN8 finials adds 5.25" to the total finished rod width.

Finials

Rod
Compatibility



SFN9 AP



Color: 
Antique Pewter: AP
Sold in Pairs

SFN9 BB



Color: 
Brushed Brass: BB
Sold in Pairs

SFN9 MB



Color: 
Matte Black: MB
Sold in Pairs

SFN9 PN



Color: 
Polished Nickel: PN
Sold in Pairs

SFN9 SN



Color: 
Satin Nickel: SN
Sold in Pairs

Dimensions

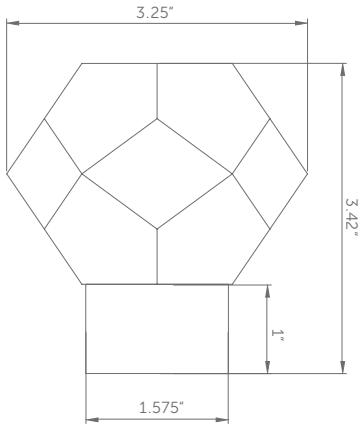

NOTE: Pair of SFN9 finials adds 5.5" to the total finished rod width.

Finials

Rod Compatibility



SFN10 AP

Color: 
 Antique Pewter: AP
 Sold in Pairs



SFN10 BB

Color: 
 Brushed Brass: BB
 Sold in Pairs



SFN10 MB

Color: 
 Matte Black: MB
 Sold in Pairs



SFN10 PN

Color: 
 Polished Nickel: PN
 Sold in Pairs



SFN10 SN

Color: 
 Satin Nickel: SN
 Sold in Pairs



Dimensions

NOTE: Pair of SFN10 finials adds 2.5" to the total finished rod width.

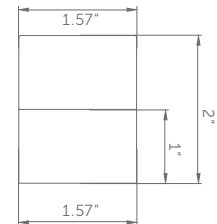

End Caps

Rod Compatibility



SEC AP

Color: 
 Antique Pewter: AP
 Sold in Pairs



SEC BB

Color: 
 Brushed Brass: BB
 Sold in Pairs



SEC MB

Color: 
 Matte Black: MB
 Sold in Pairs



SEC PN

Color: 
 Polished Nickel: PN
 Sold in Pairs



SEC SN

Color: 
 Satin Nickel: SN
 Sold in Pairs



Dimensions

NOTE: Pair of SEC end caps adds 0.25" to the total finished rod width.

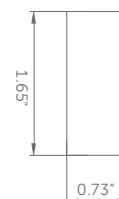

1 3/8" Conventional Rods

Rod Compatibility 



SRD4 AP
SRD6 AP
SRD8 AP

Color: 
Antique Pewter: AP
Sold Individually

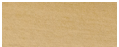

SRD4 BB
SRD6 BB
SRD8 BB

Color: 
Brushed Brass: BB
Sold Individually

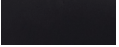

SRD4 MB
SRD6 MB
SRD8 MB

Color: 
Matte Black: MB
Sold Individually



SRD4 PN
SRD6 PN
SRD8 PN

Color: 
Polished Nickel: PN
Sold Individually



SRD4 SN
SRD6 SN
SRD8 SN

Color: 
Satin Nickel: SN
Sold Individually

SRD4 Length 4' | SRD6 Length 6' | SRD8 Length 8'

Additional handling charges may apply on 8' rods.
Please contact customer service for information.

Conventional Rod Joint

SJNT

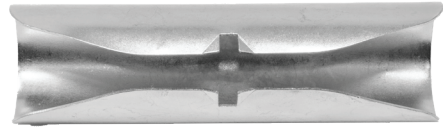

Wand

Rod Compatibility



TWND AP

Color: 
Antique Pewter: AP
Sold Individually

TWND BB

Color: 
Brushed Brass: BB
Sold Individually

TWND MB

Color: 
Matte Black: MB
Sold Individually

TWND PN

Color: 
Polished Nickel: PN
Sold Individually

TWND SN

Color: 
Satin Nickel: SN
Sold Individually

Dimensions

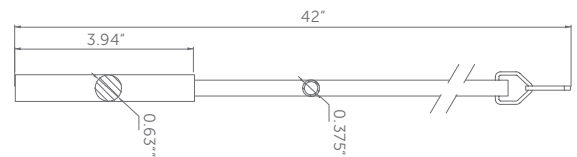

Round Rings

Rod Compatibility 

SRG AP

Color: 
Antique Pewter: AP
Sold in Packs of 10



SRG BB

Color: 
Brushed Brass: BB
Sold in Packs of 10



SRG MB

Color: 
Matte Black: MB
Sold in Packs of 10



SRG PN

Color: 
Polished Nickel: PN
Sold in Packs of 10



SRG SN

Color: 
Satin Nickel: SN
Sold in Packs of 10



Dimensions

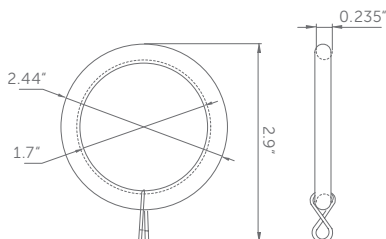

Elbows

Rod Compatibility 

SEB AP

Sold Individually
Color: 
Antique Pewter: AP
Sold Individually

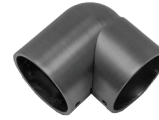

SEB BB

Sold Individually
Color: 
Brushed Brass: BB
Sold Individually



SEB MB

Sold Individually
Color: 
Matte Black: MB
Sold Individually



SEB PN

Sold Individually
Color: 
Polished Nickel: PN
Sold Individually



SEB SN

Sold Individually
Color: 
Satin Nickel: SN
Sold Individually

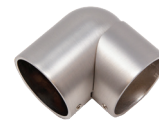

Dimensions

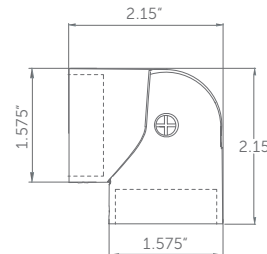

Single Bracket

Rod Compatibility 

Double Bracket

Rod Compatibility 

SBK AP



Color: 
Antique Pewter: AP
Sold Individually

SDBK AP



Color: 
Antique Pewter: AP
Sold Individually

SBK BB



Color: 
Brushed Brass: BB
Sold Individually

SDBK BB



Color: 
Brushed Brass: BB
Sold Individually

SBK MB



Color: 
Matte Black: MB
Sold Individually

SDBK MB



Color: 
Matte Black: MB
Sold Individually

SBK PN



Color: 
Polished Nickel: PN
Sold Individually

SDBK PN



Color: 
Polished Nickel: PN
Sold Individually

SBK SN



Color: 
Satin Nickel: SN
Sold Individually

SDBK SN



Color: 
Satin Nickel: SN
Sold Individually

Dimensions

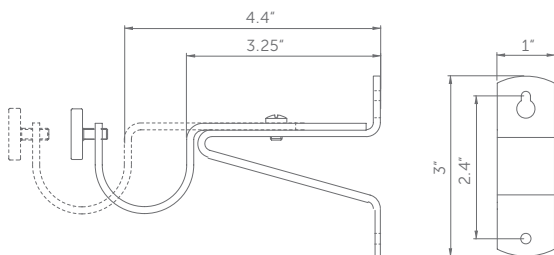

Dimensions

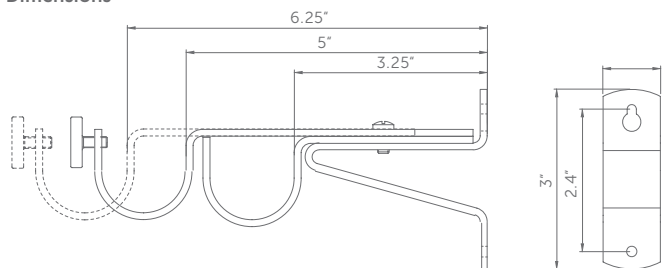

Ceiling Bracket

Rod Compatibility 

SCB AP

Color: 
 Antique Pewter: AP
 Sold Individually

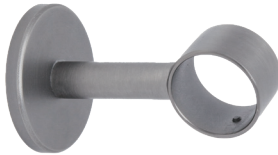

SCB BB

Color: 
 Brushed Brass: BB
 Sold Individually

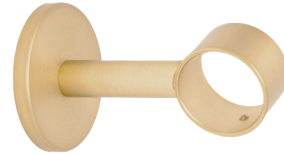

SCB MB

Color: 
 Matte Black: MB
 Sold Individually

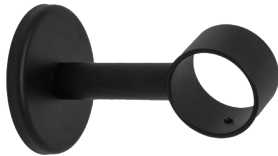

SCB PN

Color: 
 Polished Nickel: PN
 Sold Individually



SCB SN

Color: 
 Satin Nickel: SN
 Sold Individually

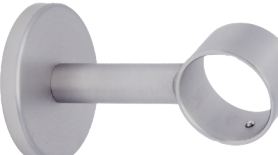

Dimensions

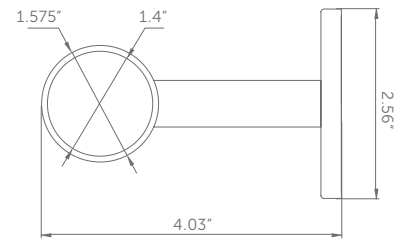

Wall Mounts

Rod Compatibility  

SWM AP

Color: 
 Antique Pewter: AP
 Sold in Pairs*



SWM BB

Color: 
 Brushed Brass: BB
 Sold in Pairs*



SWM MB

Color: 
 Matte Black: MB
 Sold in Pairs*



SWM PN

Color: 
 Polished Nickel: PN
 Sold in Pairs*



SWM SN

Color: 
 Satin Nickel: SN
 Sold in Pairs*



Dimensions

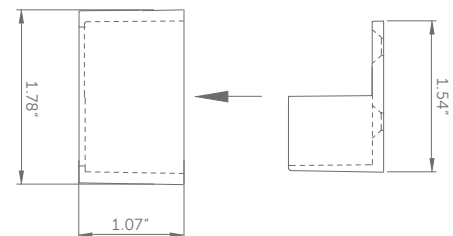

*Pairs consist of 2 wall mounts and 2 covers

1 3/8" Channel Rods



STRC4 AP
STRC6 AP
STRC8 AP

Color:
Antique Pewter: AP
Sold Individually



STRC4 BB
STRC6 BB
STRC8 BB

Color:
Brushed Brass: BB
Sold Individually



STRC4 MB
STRC6 MB
STRC8 MB

Color:
Matte Black: MB
Sold Individually



STRC4 PN
STRC6 PN
STRC8 PN

Color:
Polished Nickel: PN
Sold Individually



STRC4 SN
STRC6 SN
STRC8 SN

Color:
Satin Nickel: SN
Sold Individually

STRC4 Length 4' | STRC6 Length 6' | STRC8 Length 8'

Additional handling charges may apply on 8' rods.
Please contact customer service for information.

Channel Rod Joint



SCJNT

Channel Rod Joint allows for bracket to be installed centered behind it.

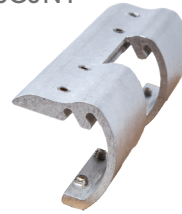

Dimensions

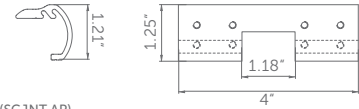

Available in Antique Pewter (SCJNT AP), Brushed Brass (SCJNT BB), Matte Black (SCJNT MB), Polished Nickel (SCJNT PN) and Satin Nickel (SCJNT SN) Sold Individually

Channel Rod Joint Cover

Dimensions

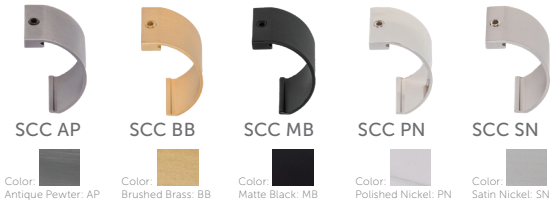
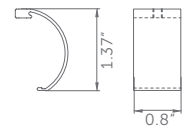

Color: Antique Pewter: AP
Color: Brushed Brass: BB
Color: Matte Black: MB
Color: Polished Nickel: PN
Color: Satin Nickel: SN

Sold Individually

Channel Rod End Caps

Dimensions

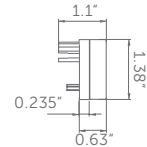

Color: Antique Pewter: AP
Color: Brushed Brass: BB
Color: Matte Black: MB
Color: Polished Nickel: PN
Color: Satin Nickel: SN

NOTE: Pair of SCAC end caps adds 1.375" to the total finished rod width.

Sold in Pairs

Channel Rod End Plug

Dimensions

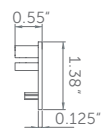

Color: Antique Pewter: AP
Color: Brushed Brass: BB
Color: Matte Black: MB
Color: Polished Nickel: PN
Color: Satin Nickel: SN

NOTE: Pair of SCEP end plugs adds 0.25" to the total finished rod width.

Sold in Pairs

Ceiling Flush Mount

Rod Compatibility 

Ceiling Recessed Mount

Rod Compatibility 



Color: 
Antique Pewter: AP
Sold Individually

SFM AP



Color: 
Antique Pewter: AP
Sold Individually

SCM AP

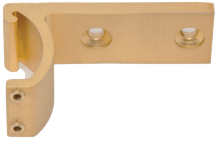

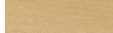
Color: 
Brushed Brass: BB
Sold Individually

SFM BB

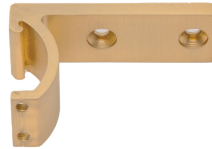

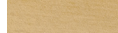
Color: 
Brushed Brass: BB
Sold Individually

SCM BB



Color: 
Matte Black: MB
Sold Individually

SFM MB



Color: 
Matte Black: MB
Sold Individually

SCM MB



Color: 
Polished Nickel: PN
Sold Individually

SFM PN



Color: 
Polished Nickel: PN
Sold Individually

SCM PN

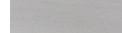

Color: 
Satin Nickel: SN
Sold Individually

SFM SN

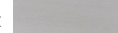

Color: 
Satin Nickel: SN
Sold Individually

SCM SN

Dimensions

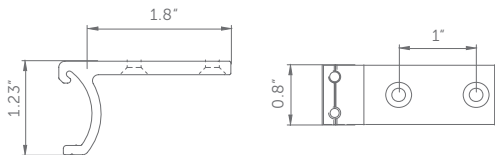

Dimensions

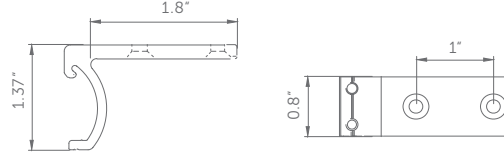

NOTE: The ceiling flush mount sits right up against the ceiling, whereas the ceiling recessed mount allows the rod some space to sit slightly below.



Ceiling Flush Mount

Ceiling Recessed Mount

Single Bracket

Rod Compatibility 

Extended Single Bracket

Rod Compatibility 

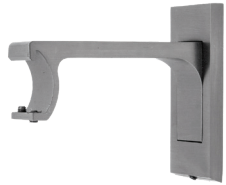

Color: 
Antique Pewter: AP
Sold Individually

SSV AP



Color: 
Antique Pewter: AP
Sold Individually

SXLV AP

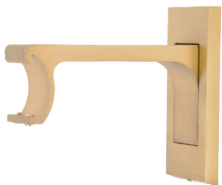

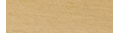
Color: 
Brushed Brass: BB
Sold Individually

SSV BB



Color: 
Brushed Brass: BB
Sold Individually

SXLV BB



Color: 
Matte Black: MB
Sold Individually

SSV MB



Color: 
Matte Black: MB
Sold Individually

SXLV MB



Color: 
Polished Nickel: PN
Sold Individually

SSV PN



Color: 
Polished Nickel: PN
Sold Individually

SXLV PN

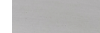

Color: 
Satin Nickel: SN
Sold Individually

SSV SN

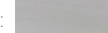

Color: 
Satin Nickel: SN
Sold Individually

SXLV SN

Dimensions

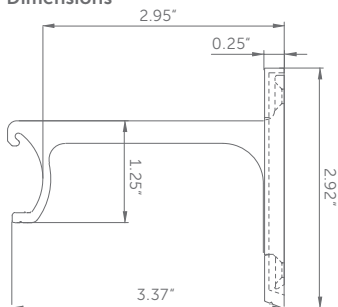

Dimensions

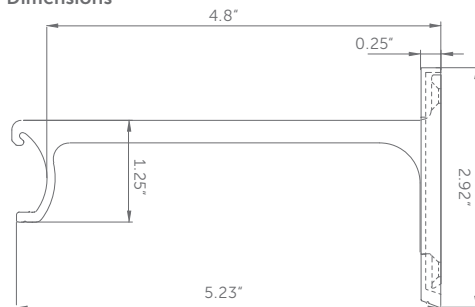

Cover

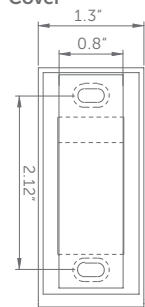

Adjustable Bracket

Rod Compatibility 

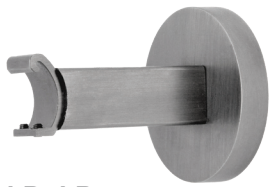

SAB AP

Color: 
Antique Pewter: AP
Sold Individually

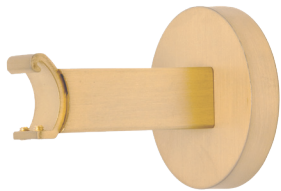

SAB BB

Color: 
Brushed Brass: BB
Sold Individually

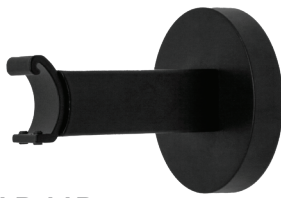

SAB MB

Color: 
Matte Black: MB
Sold Individually

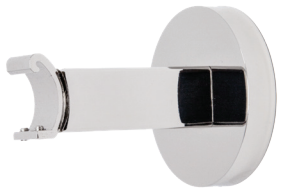

SAB PN

Color: 
Polished Nickel: PN
Sold Individually

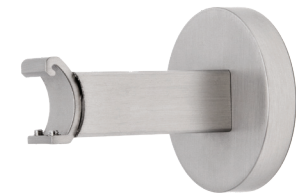

SAB SN

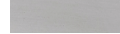
Color: 
Satin Nickel: SN
Sold Individually

Dimensions

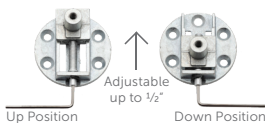
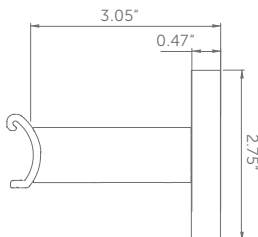

SmartSet™ Technology allows for up to half an inch in height adjustability after installation.

Double Bracket

Rod Compatibility 



SDV AP

Color: 
Antique Pewter: AP
Sold Individually

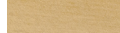

SDV BB

Color: 
Brushed Brass: BB
Sold Individually



SDV MB

Color: 
Matte Black: MB
Sold Individually



SDV PN

Color: 
Polished Nickel: PN
Sold Individually



SDV SN

Color: 
Satin Nickel: SN
Sold Individually

Dimensions

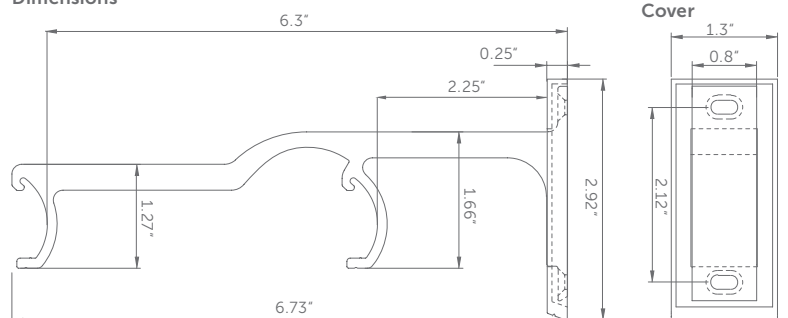

RPL-TECH® Carrier Guide

Carrier guide shows the maximum number of carriers required per track width.

Track Width in Inches	Fullness							
	60% One Way	60% Center Split	80% One Way	80% Center Split	100% One Way	100% Center Split	120% One Way	120% Center Split
24-30	12	12	13	14	15	16	16	16
31-36	14	14	16	16	17	18	20	20
37-42	16	16	18	18	20	20	23	24
43-48	19	20	21	22	23	24	26	26
49-54	21	22	23	24	26	26	29	30
55-60	23	24	26	26	29	30	32	32
61-66	26	26	28	28	32	32	36	36
67-72	28	28	31	32	34	34	39	40
73-78	30	30	33	34	37	38	42	42
79-84	32	32	36	36	40	40	45	46
85-90	35	36	38	38	43	44	48	48
91-96	37	38	41	42	46	46	52	52
97-102	39	40	43	44	48	48	55	56
103-108	42	42	46	46	51	51	58	58
109-114	44	44	48	48	54	54	61	62
115-120	46	46	51	52	57	58	64	64
121-126	48	48	54	54	60	60	68	68
127-132	51	52	56	56	63	64	71	72
133-138	53	54	59	60	65	66	74	74
139-144	55	56	61	62	68	68	77	78

Carrier Quantities

RPL-Tech® Calculator Available Upon Request

RPL-Tech® Tape



XTP-WH



XTP-CL



XTP-BL

Sold by the yard or rolls of 100 yards.

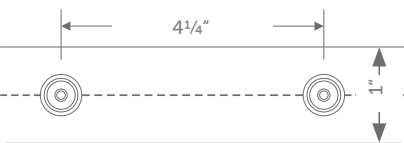
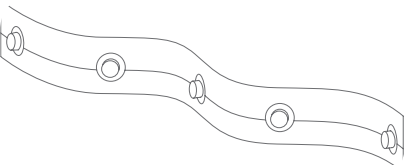

Channel Rod Components

Rod Compatibility



SM8L Left Master Underlap

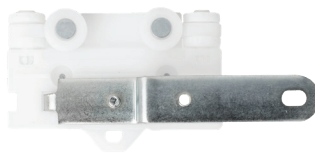

Sold Individually

SM8R Right Master Overlap



Sold Individually

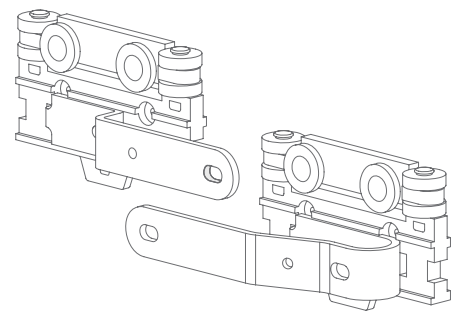

Ball Bearing Carriers

Reengineered, SmartSet™ ball bearing carriers offer the smoothest and quietest movement on the market today

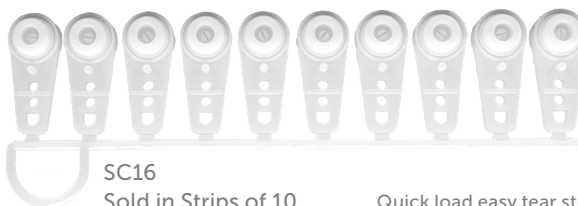

SC16
Sold in Strips of 10

Quick load easy tear strips of carriers

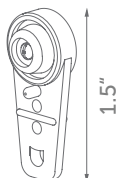

Wheeled RPL-Tech® Carrier

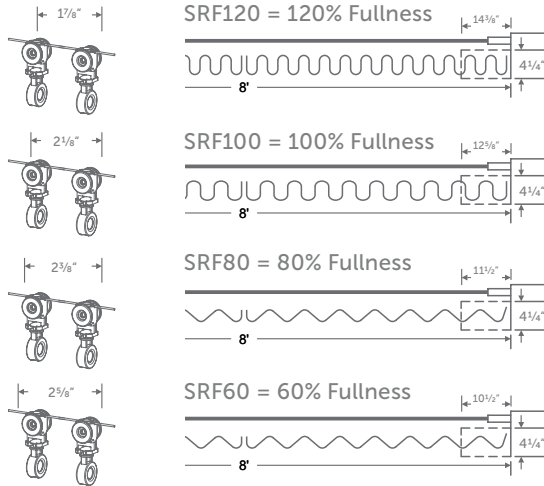

Sold in Strips of 20 Carriers

Only RPL-Tech® carriers are recommended for Soho rods

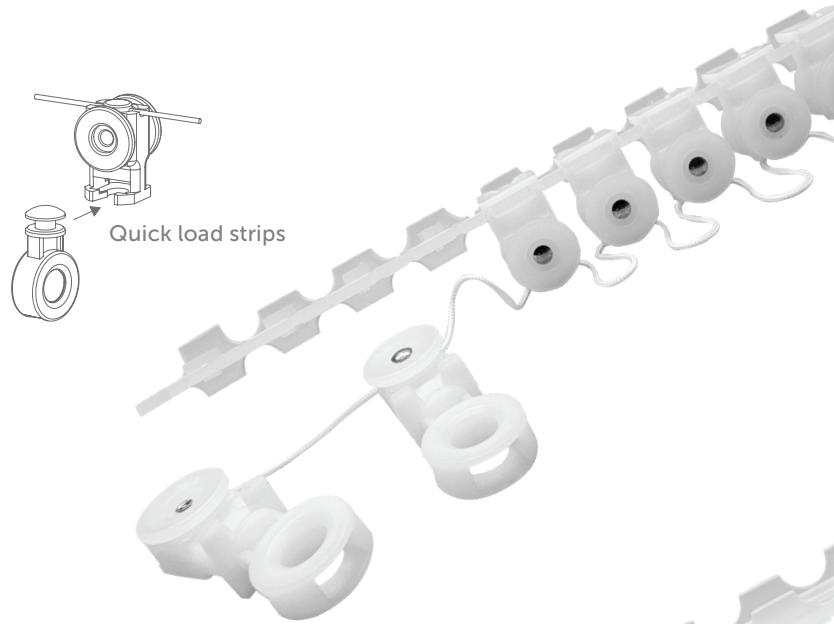

Glide RPL-Tech® Carrier

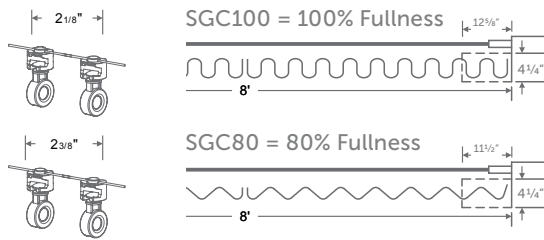

Sold in Strips of 20 Carriers

Only RPL-Tech® carriers are recommended for Soho rods

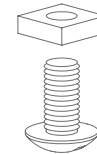

End Stop
 XES
 Sold as set.
 Set includes one
 nut and one bolt

XBML (Left Buttmaster)

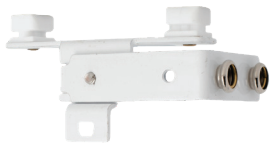

Sold Individually

XBMR (Right Buttmaster)



Sold Individually

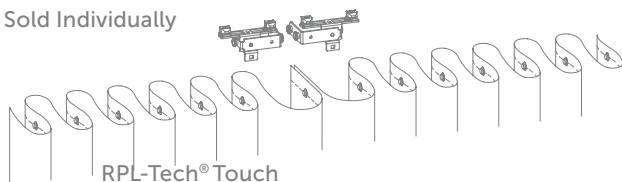

SMS6L (Left Master Carrier Underlap)

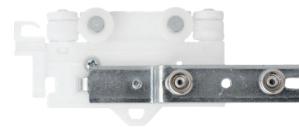

Sold Individually

SMS6R (Right Master Carrier Underlap)

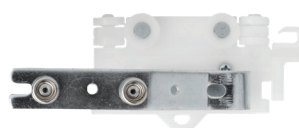

Sold Individually

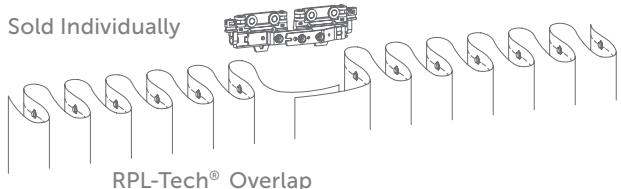

SOHO

COLLECTION

Design • Evolution



Distributed by:



490 Rowntree Dairy Rd.
Woodbridge, Ontario
L4L 8H2

Tel: 905-851-8866 | Fax: 905-851-8846
Toll Free: 1-800-653-0783 | Toll Free Fax: 1-877-388-5252

email: sales@uniquefinefabrics.com | uniquefinefabrics.com