

TYPE FIVE ASSEMBLY

Steps to Complete Your Faucet Install

Applicable for the following wall-mount faucet series:

NBF-W01

Please Note:

- Review and abide by all building and plumbing codes
- Standard codes for Novatto faucets: cUPC/CSA/AB1953
- Novatto faucets need to be installed by a professional
- Embedded mixture box should sit center of total length and width of working area.
- Max depth for embedded mixer box 2.5"

- **We recommend using a professional** when installing wall mounted bathroom fixtures and plumbing. For the following installation instructions, it is assumed the water is turned off at the source, old fixtures have been removed, water supply lines have been relocated to the proper installation location, the wall studs are exposed and the professional has installed wood blocking between the two studs where the embedded mixer box will mount.*

*** Important:** Take into consideration the thickness of your finished wall materials. If the mixer box is installed too far behind the finished wall, you may be left with insufficient clearance to attach the spout and handle.

- **The installation position** and height of embedded water control mixer box, can be determined according to your own needs. Make sure to have enough area created behind the wall in order to embed the mixer box. Using the mixer box and built in level (to ensure the proper placement), mark the location for your screw-holes to be drilled. Remove mixer box. Drill the holes and place provided plastic expansion sleeves into drilled holes.*

*** Important:** Remember, the higher the faucet is placed the more difficult it is to control where the water goes when turned on, and the more likely it is to splash.

- **Mount the embedded mixture box** into its prepared location. Attach the body using provided 4pcs screws & washers. Use built in level to ensure the box is mounted straight. Connect *main water lines (*NOT provided) to the mixer box. Apply provided plumber's tape to the threaded connection to ensure a watertight seal.

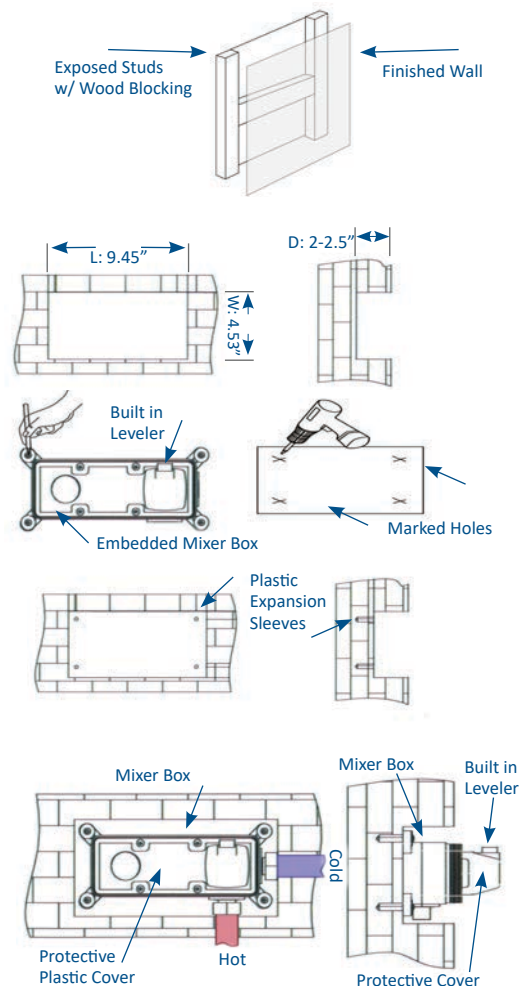

TROUBLESHOOTING TIPS

Issue	Reason	Solution
Need to access plumbing lines	Hot/cold lines connected incorrectly	Ask your plumber to install an access panel in case you need to get in
Leaking from under the handle	Dirt and debris collected in the valve/cartridge	Blow out pipe/hoses; Might have to replace the valve/cartridge
Finish is changing color or is shiny	Abrasive cleaners, soaps or other factors constantly in contact with it.	Stop using abrasives; Replace parts
Low Water Pressure/Flow	Shut-off valves not open all the way; Debris or air-pockets in pipes	Check the shut-off valves, must be open all the way; Blow out pipe/hoses

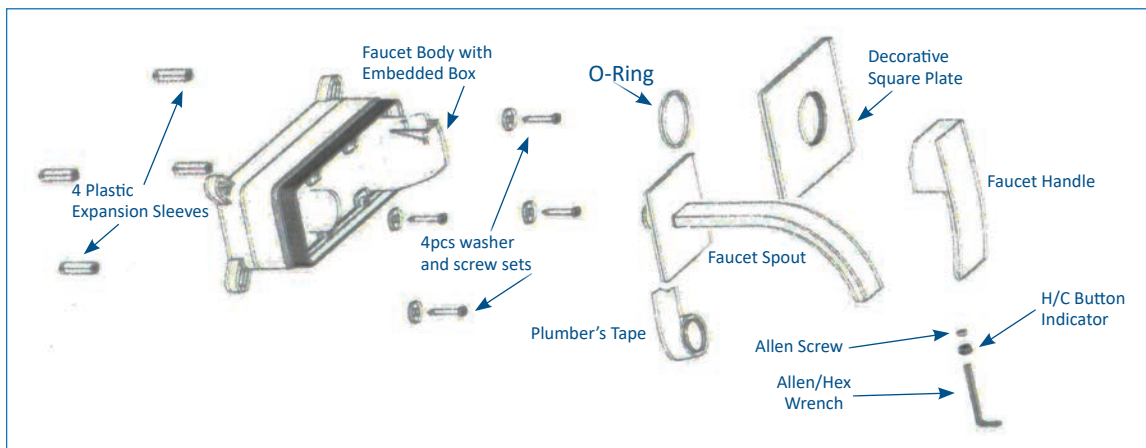

- **Remove plastic protective cover** with screw driver to reveal valve (handle will be attached there) and spout area. **STOP!***
- * **Important:** COMPLETE THE CONSTRUCTION OF YOUR WALL, INCLUDING ANY FINISHED WALL MATERIALS SUCH AS TILE, BEFORE PROCEEDING WITH THE REMAINDER OF THE INSTALLATION. **STOP!***
- * **Important:** Take into consideration the thickness of the finished wall materials. If the mixer box is installed too far behind the finished wall, you may be left with insufficient clearance to attach the spout and handle.

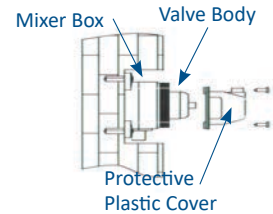

- **Once the finished wall is complete**, slide the o-ring & decorative square onto the base of the valve. (This is the base for your handle.)
- **Remove small hot/cold indicator** button on handle, to reveal small hexagonal socket and an allen screw. You might have to loosen it, using the provided allen wrench, in order to attach the handle to the valve body. Make sure to align the allen screw in the handle, to the hole in the valve body. Once handle is in place, tighten the allen screw underneath to secure it to the valve body. Replace the small hot/cold indicator button. (Red on left, blue on right.)
- **Apply plumber's tape** to the threaded connection on the end of the spout. Twist it into the spout connection. Making sure it is level and straight.
- **When the installation is complete**, turn the faucet handle wide open to the "mix" position, then slowly turn the main water supply lines, hot and cold, to their full open position. Allow faucet to run for a couple minutes in order for any dust or loose sediment to clear the system. Verify hot and cold water are running properly by positioning the handle to cold, then hot. Adjustments might need to be made at the main water supply lines under your bathroom cabinet for desired flow rate.

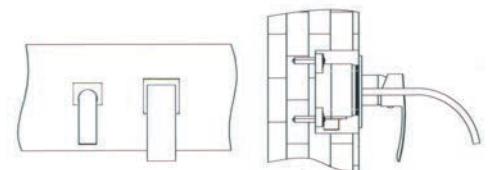
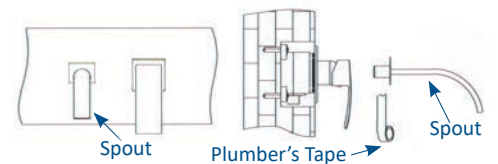
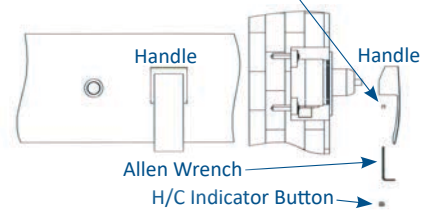
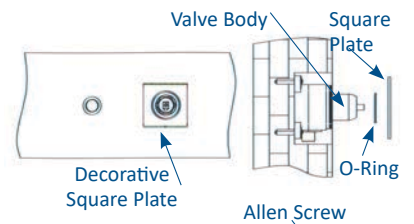
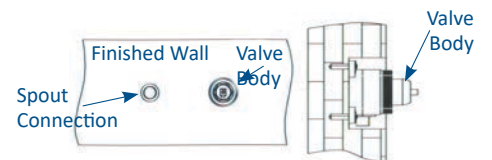

TOOLS NEEDED FOR ASSEMBLY

(not included)



Questions, problems, missing parts? Before returning to your retailer, call our customer service department at 844.404.4242, 8:00 a.m. - 5 p.m., MT, Monday - Friday or email us at: support@novattoinc.com