



NBF-Wo1BN Wall Mount Bathroom Faucet



## WARRANTY

Novatto products have been made under the highest standards of craftsmanship and quality. All Novatto faucets are backed by Novatto's Lifetime Limited warranty. Novatto warrants to the original consumer purchaser for as long as the original consumer purchaser owns their home (the "Warranty Period" for homeowners), this faucet will be free from defects in material and workmanship. All other purchasers (including purchasers for industrial, commercial and business use) are excluded from this warranty.

Damage due to installation error, product abuse, product misuse, or use of cleaners containing abrasives, alcohol or other organic solvents, whether performed by a contractor, service company, or yourself are excluded from this warranty. Novatto recommends using a plumbing professional to install your Novatto product. Except as provided by law, this warranty is in lieu of and excludes all other warranties, conditions and guarantees, whether expressed or implied, statutory or otherwise, including without restriction those of merchantability or of fitness for use.

Defects or damage caused using other than genuine Novatto parts is not covered by this warranty. This warranty is applicable only to faucets purchased after November 2009 and shall be effective from the date of purchase as shown on purchaser's receipt. If the faucet should leak or drip during normal use, Novatto will provide the purchaser the cartridge necessary to put the faucet in normal working condition. All finishes on Novatto faucets are warranted to the original consumer to be free from defects in material and craftsmanship for a period of one year starting the date of purchase by the consumer. If the faucet is used commercially or is installed outside of the United States of America or Canada, the warranty is voided.

Proof of purchase (original sales receipt) must be provided to Novatto, Inc. with all warranty claims. Novatto is not responsible for labor charges, installation, loss, injury or any other incidental or consequential costs. In no event shall the liability of Novatto products surpass the purchase price of the replacement part. In no event shall Novatto be liable for loss of profits or any such loss, or any direct or indirect, special, incidental or consequential damages howsoever incurred or designated arising out of any breached claim of warranty.

If you believe you have a warranty claim, contact Novatto, either through your local Dealer, Plumbing Contractor, Home Center, or by writing: Novatto, Inc., Attn: Product Support, 3533 E. Corona Ave., Phoenix, AZ, 85040, USA. Please be sure to provide all pertinent information regarding your claim, including a complete description of the problem, the product, model number, color, finish, the date the product was purchased and from whom the product was purchased. Also include your original invoice. For other information, or to obtain the name and address of a service or repair facility near you, email: [support@novatto.com](mailto:support@novatto.com) or write to the above address.

**Warning:** Never use cleaners containing abrasive cleansers, ammonia, bleach, acids, waxes, alcohol, solvents or other products not recommended for chrome, oil rubbed bronze or brushed nickel. This will void the warranty. Novatto products may be cleaned by using a mild soap with warm water and a dry, clean soft cloth. Using anything other than what is suggested will void the warranty.

Get the most out of your Novatto faucet by registering!

By registering, you also are establishing the product's warranty. Plus you will receive product information, helpful tips, learn of special events and much more.

# TYPE FIVE ASSEMBLY

## Steps to Complete Your Faucet Install

Applicable for the following wall-mount faucet series:

NBF-W01 NBF-W05

### Please Note:

- Review and abide by all building and plumbing codes
- Standard codes for Novatto faucets: cUPC/CSA/AB1953
- Novatto faucets need to be installed by a professional
- Embedded mixture box should sit center of total length and width of working area.
- Max depth for embedded mixer box 2.5"

- **We recommend using a professional** when installing wall mounted bathroom fixtures and plumbing. For the following installation instructions, it is assumed the water is turned off at the source, old fixtures have been removed, water supply lines have been relocated to the proper installation location, the wall studs are exposed and the professional has installed wood blocking between the two studs where the embedded mixer box will mount.\*

**\* Important:** Take into consideration the thickness of your finished wall materials. If the mixer box is installed too far behind the finished wall, you may be left with insufficient clearance to attach the spout and handle.

- **The installation position** and height of embedded water control mixer box, can be determined according to your own needs. Make sure to have enough area created behind the wall in order to embed the mixer box. Using the mixer box and built in level (to ensure the proper placement), mark the location for your screw-holes to be drilled. Remove mixer box. Drill the holes and place provided plastic expansion sleeves into drilled holes.\*

**\* Important:** Remember, the higher the faucet is placed the more difficult it is to control where the water goes when turned on, and the more likely it is to splash.

- **Mount the embedded mixture box** into its prepared location. Attach the body using provided 4pcs screws & washers. Use built in level to ensure the box is mounted straight. Connect \*main water lines (\*NOT provided) to the mixer box. Apply provided plumber's tape to the threaded connection to ensure a watertight seal.

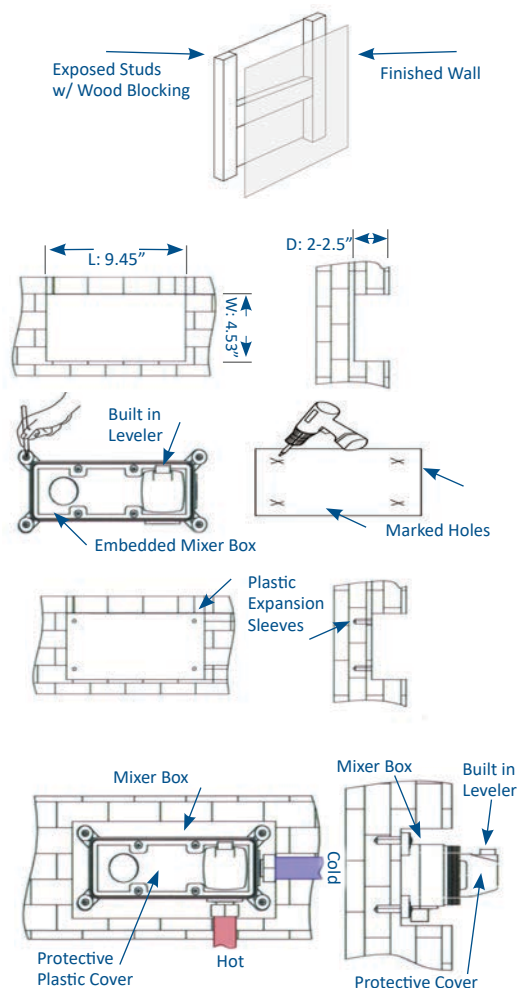

## TROUBLESHOOTING TIPS

Issue	Reason	Solution
Need to access plumbing lines	Hot/cold lines connected incorrectly	Ask your plumber to install an access panel in case you need to get in
Leaking from under the handle	Dirt and debris collected in the valve/cartridge	Blow out pipe/hoses; Might have to replace the valve/cartridge
Finish is changing color or is shiny	Abrasive cleaners, soaps or other factors constantly in contact with it.	Stop using abrasives; Replace parts
Low Water Pressure/Flow	Shut-off valves not open all the way; Debris or air-pockets in pipes	Check the shut-off valves, must be open all the way; Blow out pipe/hoses

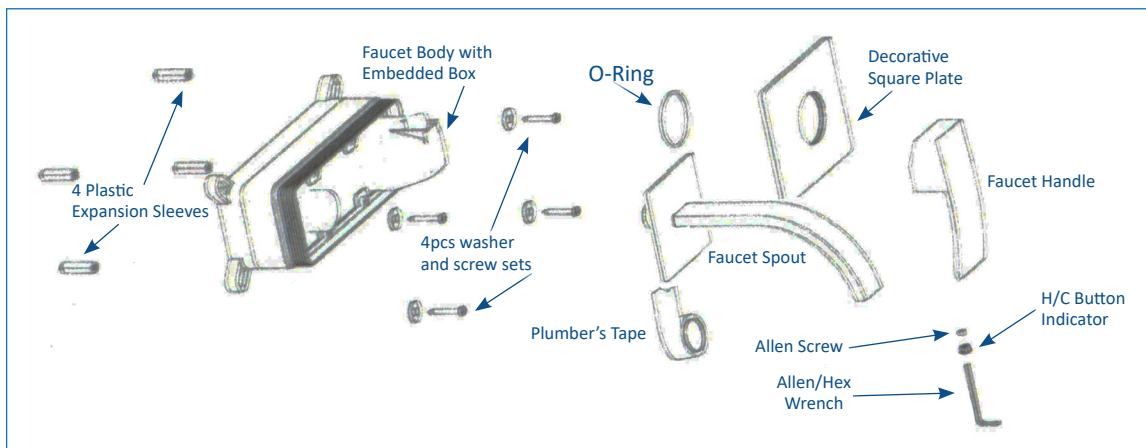

- **Remove plastic protective cover** with screw driver to reveal valve (handle will be attached there) and spout area. **STOP!\***
- \* **Important:** COMPLETE THE CONSTRUCTION OF YOUR WALL, INCLUDING ANY FINISHED WALL MATERIALS SUCH AS TILE, BEFORE PROCEEDING WITH THE REMAINDER OF THE INSTALLATION. **STOP!\***
- \* **Important:** Take into consideration the thickness of the finished wall materials. If the mixer box is installed too far behind the finished wall, you may be left with insufficient clearance to attach the spout and handle.

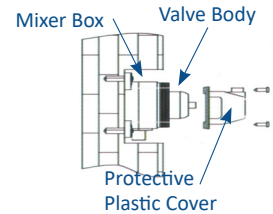

- **Once the finished wall is complete**, slide the o-ring & decorative square onto the base of the valve. (This is the base for your handle.)
- **Remove small hot/cold indicator** button on handle, to reveal small hexagonal socket and an allen screw. You might have to loosen it, using the provided allen wrench, in order to attach the handle to the valve body. Make sure to align the allen screw in the handle, to the hole in the valve body. Once handle is in place, tighten the allen screw underneath to secure it to the valve body. Replace the small hot/cold indicator button. (Red on left, blue on right.)
- **Apply plumber's tape** to the threaded connection on the end of the spout. Twist it into the spout connection. Making sure it is level and straight.
- **When the installation is complete**, turn the faucet handle wide open to the "mix" position, then slowly turn the main water supply lines, hot and cold, to their full open position. Allow faucet to run for a couple minutes in order for any dust or loose sediment to clear the system. Verify hot and cold water are running properly by positioning the handle to cold, then hot. Adjustments might need to be made at the main water supply lines under your bathroom cabinet for desired flow rate.

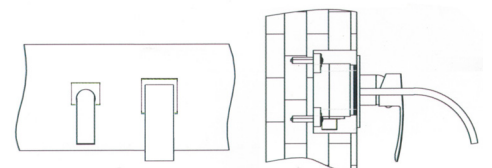
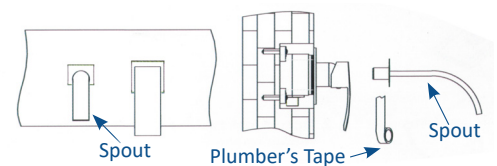
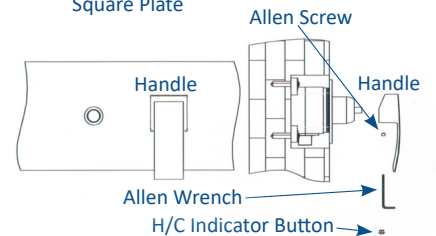
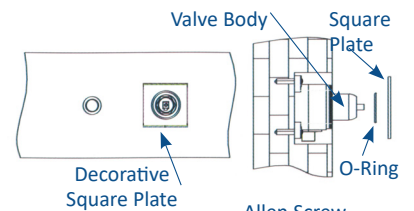
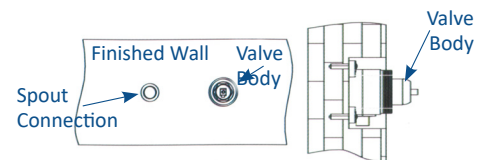

## TOOLS NEEDED FOR ASSEMBLY

(not included)

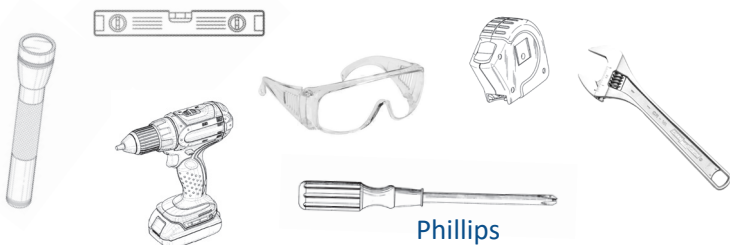

Questions, problems, missing parts? Before returning to your retailer, call our customer service department at 844.404.4242, 8:00 a.m. - 5 p.m., MT, Monday - Friday or email us at: support@novatto.com



Glacier Ice Faucet and Sink professional sealer kit will not only restore sinks, faucets and shower doors from mineral buildup and hard water spots, it will also protect from future corrosion, oxidation, mold and mildew. Treats up to 100 square feet.

## How should I care for my Novatto Faucet?

For the absolute best cleaning results, clean your faucet right after install and then use Glacier Ice Sealer kit. This will help seal the faucet and prevent hard water spots and mineral build up. Don't forget to rinse and dry off any excess cleaner which may have landed on adjacent surfaces. After that, cleaning will be easy. Just use a soft cloth or sponge with mild soap and water, rinse and dry. Do not use abrasive cleansers, or cleaners containing ammonia, bleach, acids, waxes, alcohol or other solvents. The effectiveness of all cleaners depends on factors like water hardness, temperature and condition of product being cleaned.

# FAQs

## How high up should I position the faucet?

The distance depends on the shape of the faucet. Typically 8-10-inches of clearance, measuring from the countertop to the faucet head. You want at least 1-3-inches above the sink. Remember, the higher you place the faucet the more difficult it is to control where the water goes when turned on, and the more likely it is to splash.

## It's always best to have a professional install your wall mounted faucet!

Wall faucets take a little more precision and forward thinking as the rough-in needs to be done before the dry walls, cabinets and sink are installed. Your professional plumber will know exactly what height to place the rough-in, based on your cabinet and finished sink height and location. Install the sink just a little too far in any one direction and when the faucet is turned on, the water will hit the sink at the wrong angle, causing it to splash and spatter. Once the cabinets and counter are installed the plumber will then finish the spout and handle.

## Where does the spout go and how should the water flow into the sink?

The water, depending on how it cascades out, should ideally flow into the sink just before the drain or towards the center. Just remember, the spout not only has to clear the gap between the sink and wall, but it also must clear about half the sink's width. Plus, you need to make sure to have enough room to wash your hands without banging them against the sink's basin.

**More questions?** Feel free to contact our technical support team, Monday - Friday 8:00 a.m. - 5 p.m., MT, P: 844.404.4242, or email us at: [support@novatto.com](mailto:support@novatto.com). More info is also available on our [website](#).

## THANK YOU

We would like to take this opportunity to thank you for choosing Novatto. We hope you are truly satisfied with our product and enjoy it for years to come. As a small business, we learn the most from you, the customer. Please visit the link to the right, leave us a review with high resolution pictures and you could win a \$25 Amazon or Visa gift card.

### It's easy as...

- Go to [novatto.com](http://novatto.com)
- Find your product's page
- On the right, about 1/2 way down, click "Write a review"
- Review, submit and let your style flow

**NOVATTO**  
WHERE STYLE FLOWS

Novatto | P: 844.404.4242  
[support@novatto.com](mailto:support@novatto.com)  
[Novatto.com](http://Novatto.com)

