

20 Ft. Modular Display



SET-UP MANUAL

OVERVIEW

PARTS LIST

BUILD VERTICAL
SUPPORT POSTS

ATTACHING
FABRIC GRAPHICS

CENTER ASSEMBLY
MONITOR MOUNT

RECEPTION DESK

SHELF ASSEMBLY

LIGHTS ASSEMBLY

WAVE TOP
ASSEMBLY

UN-PACKING
RE-PACKING

CARE - CLEANING

CONTAINS
(2) MOLDED PLASTIC WHEELED CASES
(1) CASE WILL CONTAIN CENTER SUPPORT BARS, MONITOR BRACKET AND CENTER DYE-SUB FABRIC PANEL

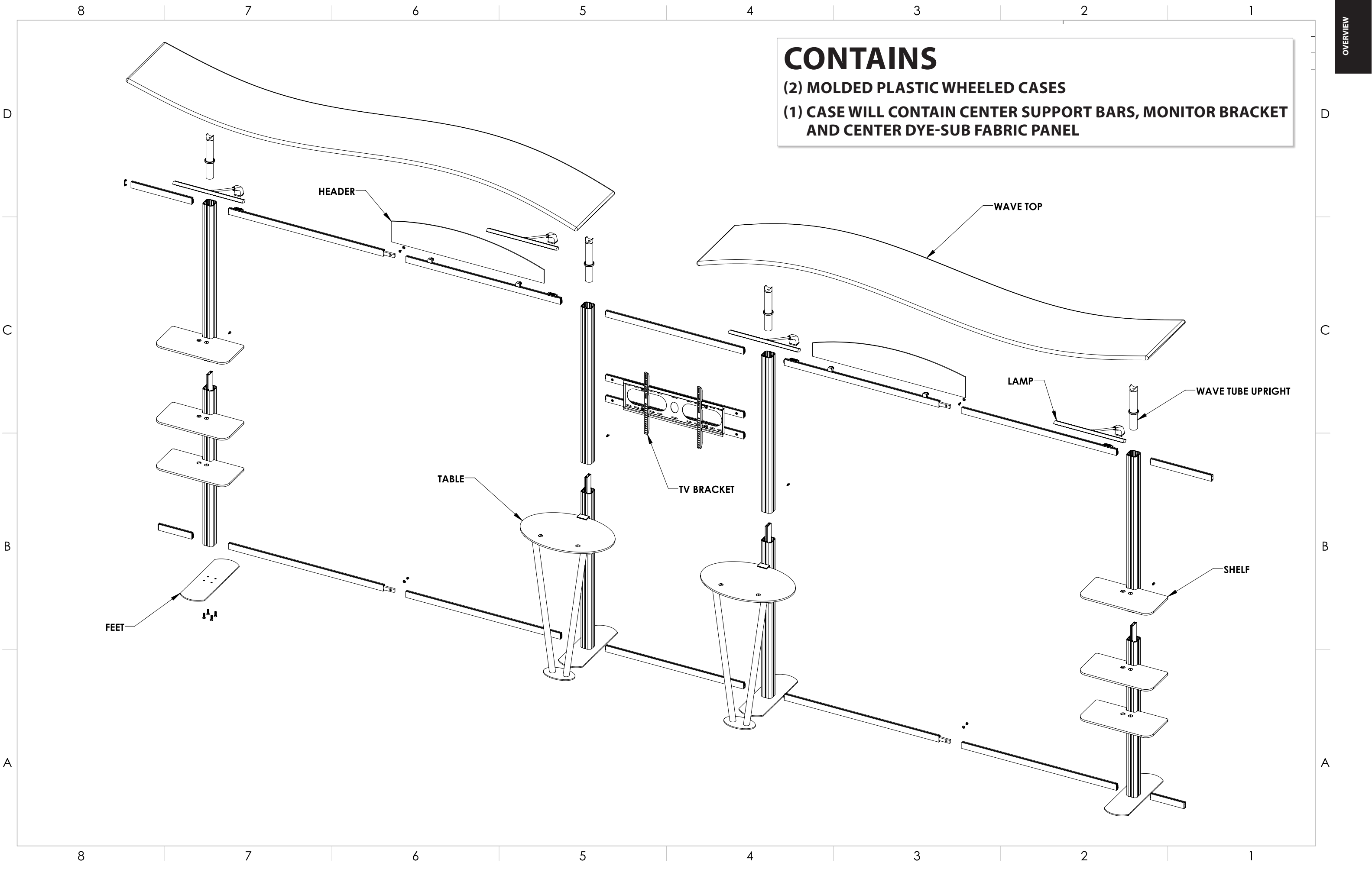

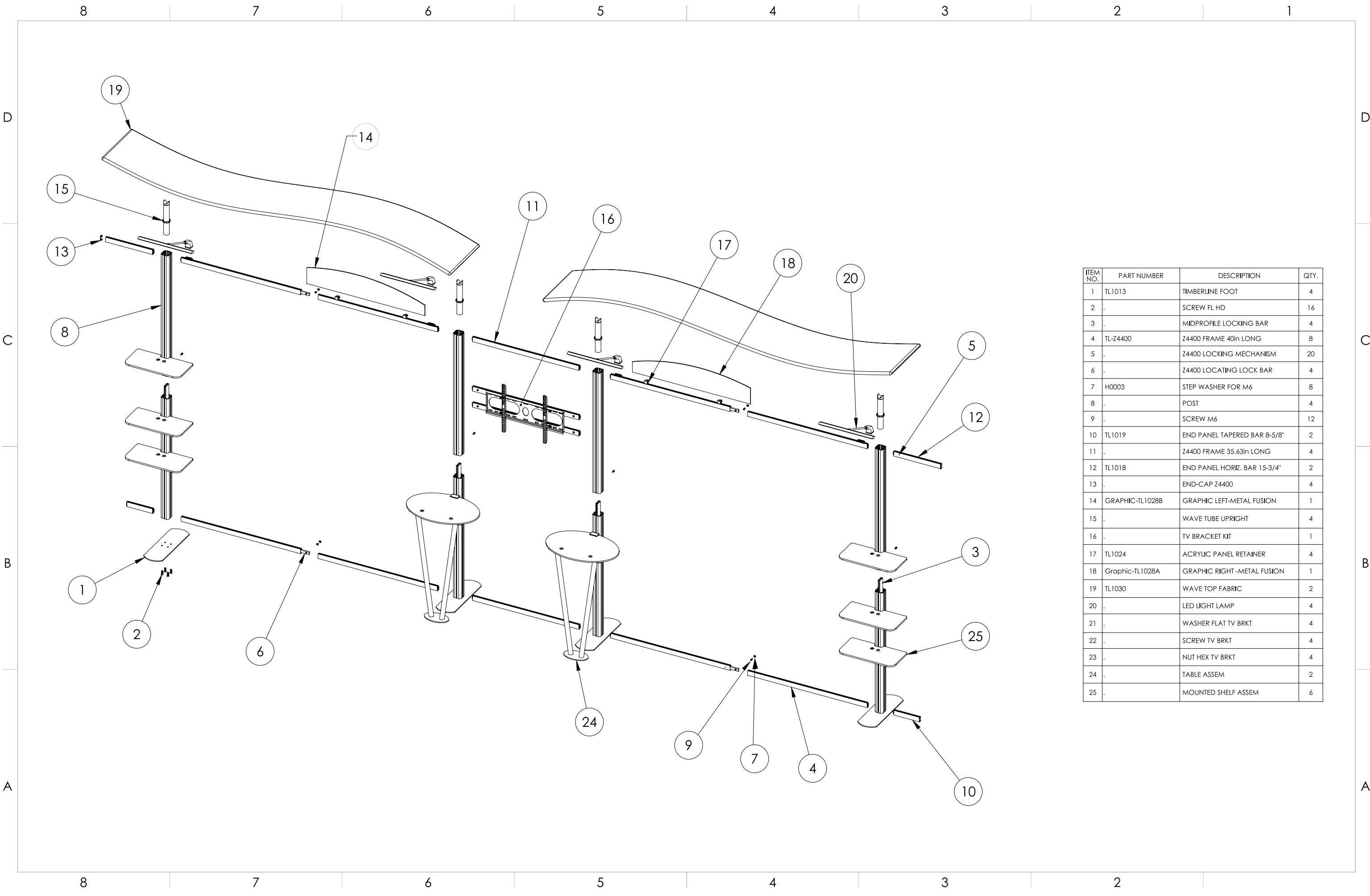

PARTS LIST

ITEM NO.	PART NUMBER	DESCRIPTION	QTY.
1	TL1013	TIMBERLINE FOOT	4
2	.	SCREW FL HD	16
3	.	MIDPROFILE LOCKING BAR	4
4	TL-Z4400	Z4400 FRAME 40in LONG	8
5	.	Z4400 LOCKING MECHANISM	20
6	.	Z4400 LOCATING LOCK BAR	4
7	H0003	STEP WASHER FOR M6	8
8	.	POST	4
9	.	SCREW M6	12
10	TL1019	END PANEL TAPERED BAR 8-5/8"	2
11	.	Z4400 FRAME 35.63in LONG	4
12	TL1018	END PANEL HORIZ. BAR 15-3/4"	2
13	.	END-CAP Z4400	4
14	GRAPHIC-TL1028B	GRAPHIC LEFT-METAL FUSION	1
15	.	WAVE TUBE UPRIGHT	4
16	.	TV BRACKET KIT	1
17	TL1024	ACRYLIC PANEL RETAINER	4
18	Graphic-TL1028A	GRAPHIC RIGHT-METAL FUSION	1
19	TL1030	WAVE TOP FABRIC	2
20	.	LED LIGHT LAMP	4
21	.	WASHER FLAT TV BRKT	4
22	.	SCREW TV BRKT	4
23	.	NUT HEX TV BRKT	4
24	.	TABLE ASSEM	2
25	.	MOUNTED SHELF ASSEM	6

BUILD VERTICAL SUPPORT POSTS - SUPPORT BARS

ATTACHING FEET

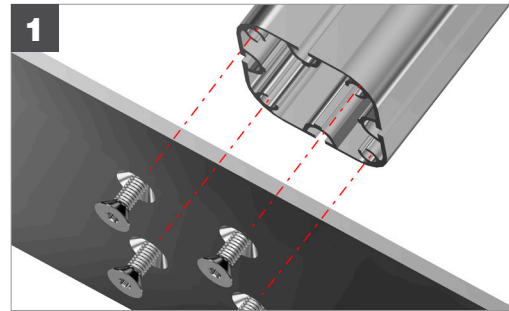
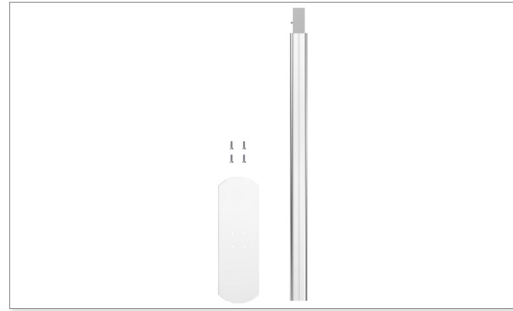

1
INSERT SCREWS
INTO BOTTOM POST



2
THUMB TIGHTENED
SCREWS

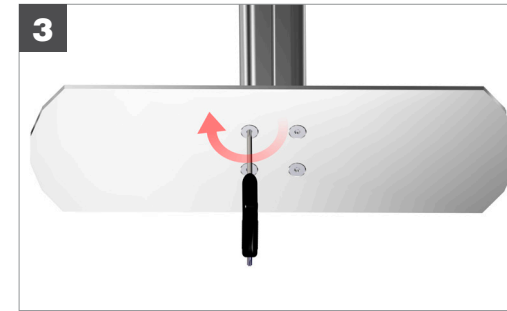

3
TIGHTENED WITH
TORX DRIVER

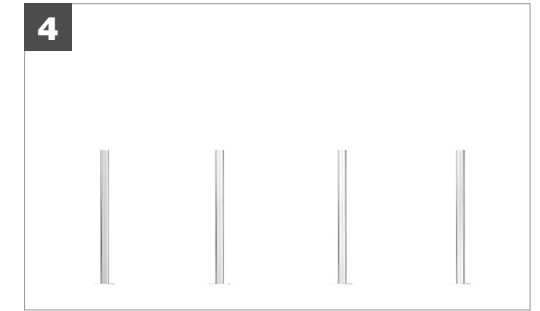

4
REPEAT STEPS 1-3 FOR REMAINING
BOTTOM SUPPORT POSTS/FEET

BUILD VERTICAL
SUPPORT POSTS

ATTACHING BOTTOM AND TOP SUPPORT POSTS

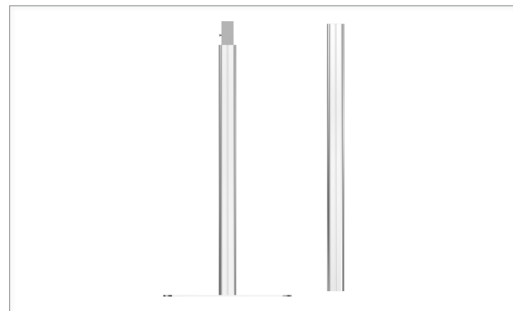

1
REMOVE TORX SCREW FROM
LOCATING BAR AND SET ASIDE

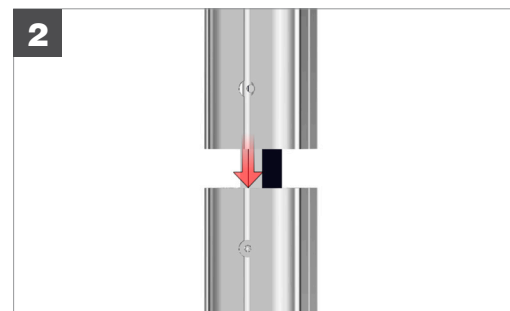

2
SLIDE TOP SUPPORT POST
ONTO BOTTOM SUPPORT POST

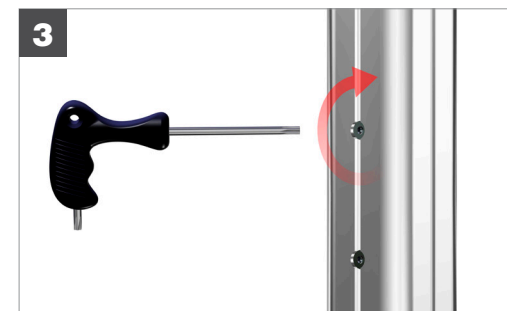

3
INSERT TORX SCREW FROM
STEP 1 AND TIGHTEN

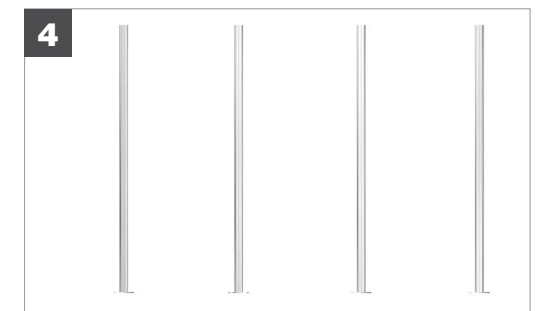

4
REPEAT STEPS 1-3 FOR
REMAINING SUPPORT POSTS

BUILDING BOTTOM AND TOP SUPPORT BARS

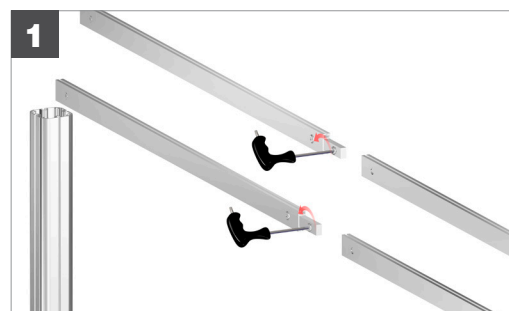
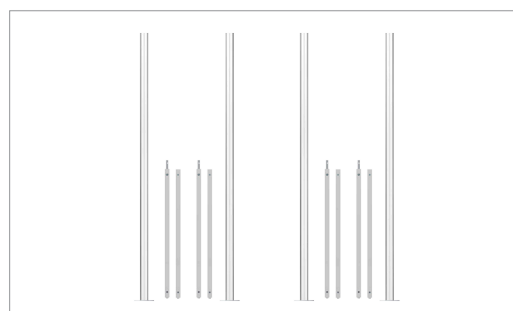

1
REMOVE TORX SCREW
AND SET ASIDE

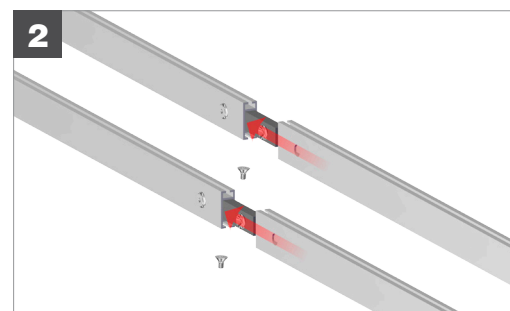

2
SLIDE SUPPORT
POST TOGETHER

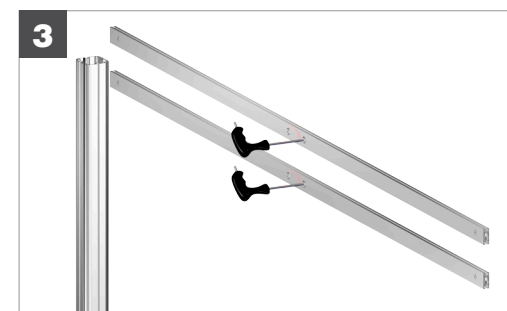

3
INSERT TORX SCREW FROM
STEP 1 AND TIGHTEN



4
REPEAT STEPS 1-3 FOR
REMAINING SUPPORT BARS

ATTACHING FABRIC GRAPHICS

WE RECOMMEND LAYING THE SUPPORT POSTS ON THE FLOOR TO ATTACH GRAPHICS

ATTACH FABRIC TO BOTTOM SUPPORT BAR FIRST

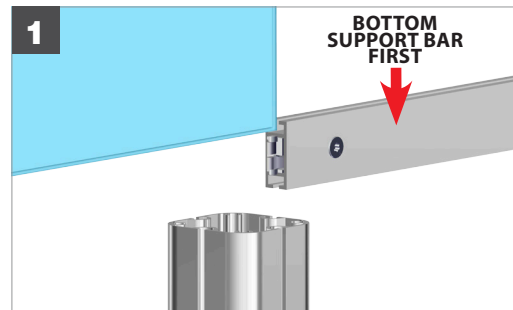

SLIDE FABRIC TUBE INTO BOTTOM SUPPORT BAR CHANNEL FIRST

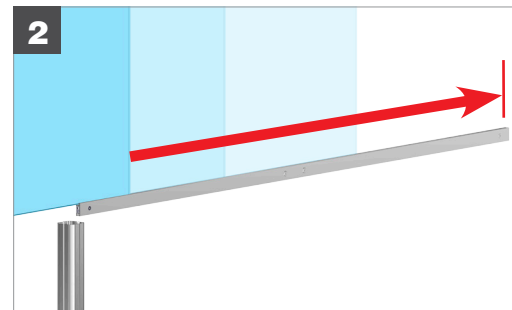

SLIDE FABRIC TO END OF SUPPORT BAR

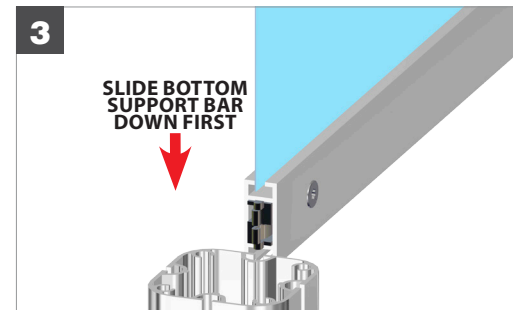

INSERT SPRING LOCK RETAINER INTO SUPPORT POST CHANNEL

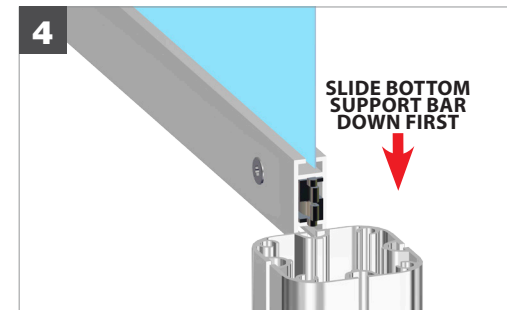

REPEAT ON OPPOSITE END

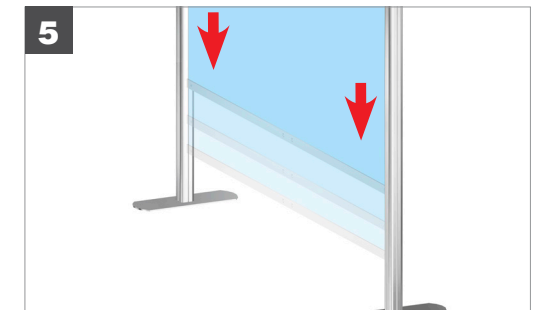

CONTINUE SLIDING DOWN-MIDWAY

ATTACH FABRIC TO TOP SUPPORT BAR

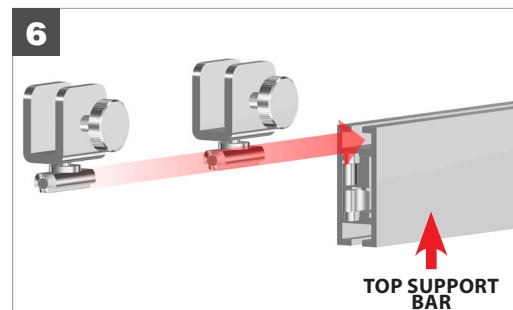

SLIDE (2) HEADER BRACKETS IN TOP SUPPORT BAR FIRST

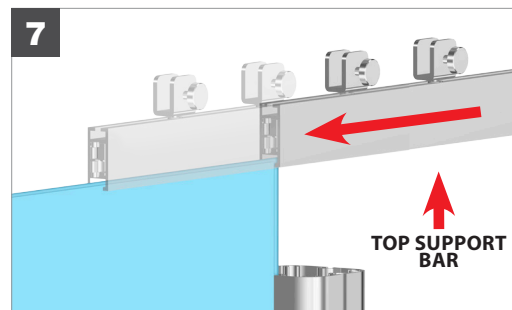

SLIDE "TOP SUPPORT BAR" ALONG THE FABRIC TUBE

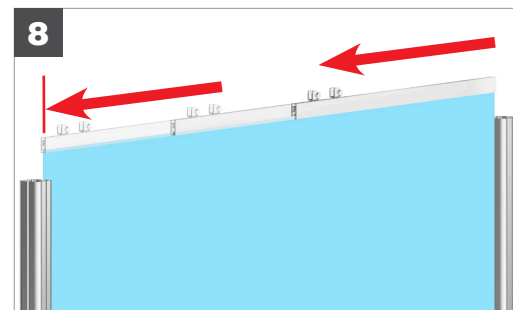

CONTINUE SLIDING SUPPORT BAR TILL IT REACHES END OF FABRIC

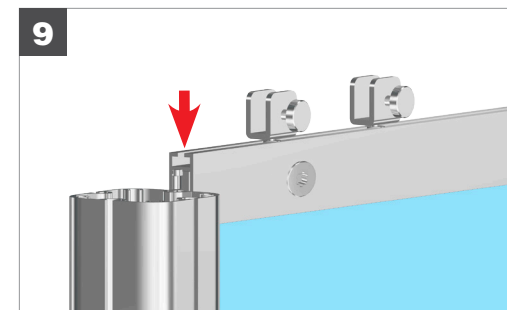

INSERT SPRING LOCK RETAINER INTO SUPPORT POST CHANNEL

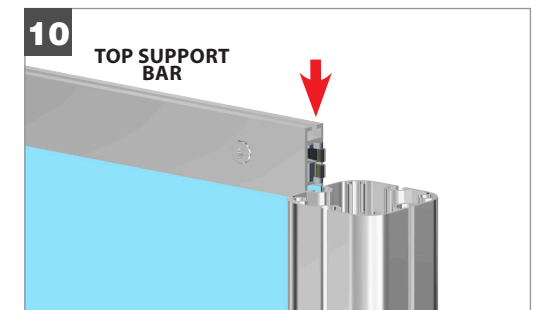

REPEAT ON OPPOSITE END

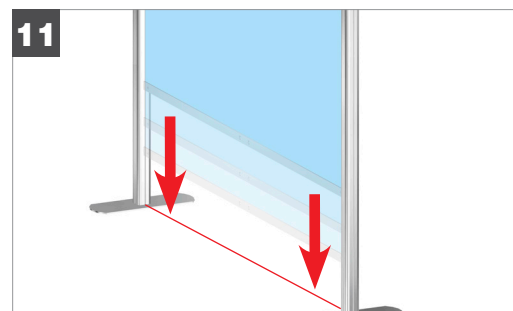

KEEP WORKING SUPPORT BARS AND FABRIC TILL BARS REACH TOP AND BOTTOM EVENLY WITH SUPPORT POSTS

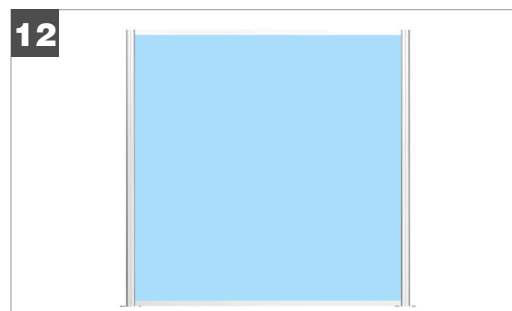

FABRIC INSERTED FULLY

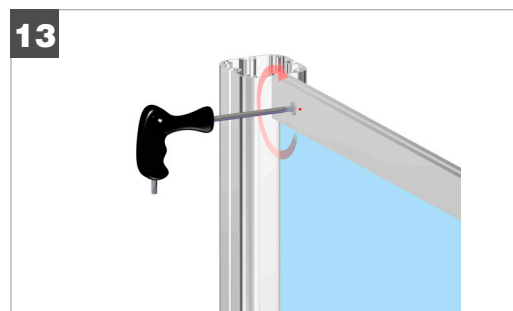

TIGHTEN CORNER TORX SCREW

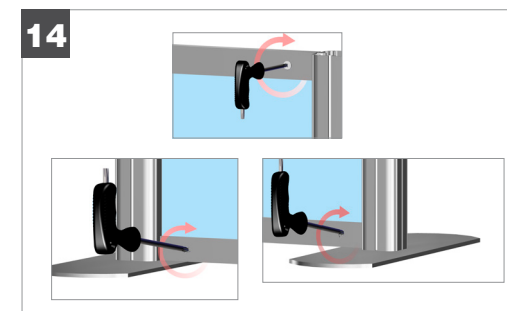

TIGHTEN REMAINING CORNER TORX SCREW

8

7

6

5

4

3

2

1

D

D

C

C

B

B

A

A

**FOLLOW STEPS 1-5, 7-14 FROM PAGE 5 TO
INSTALL FABRIC GRAPHICS.**

NOTE:
**FABRIC WILL NEED TO DETACH SLIGHTLY
 MONITOR BRACKET BARS**
(Monitor not included)

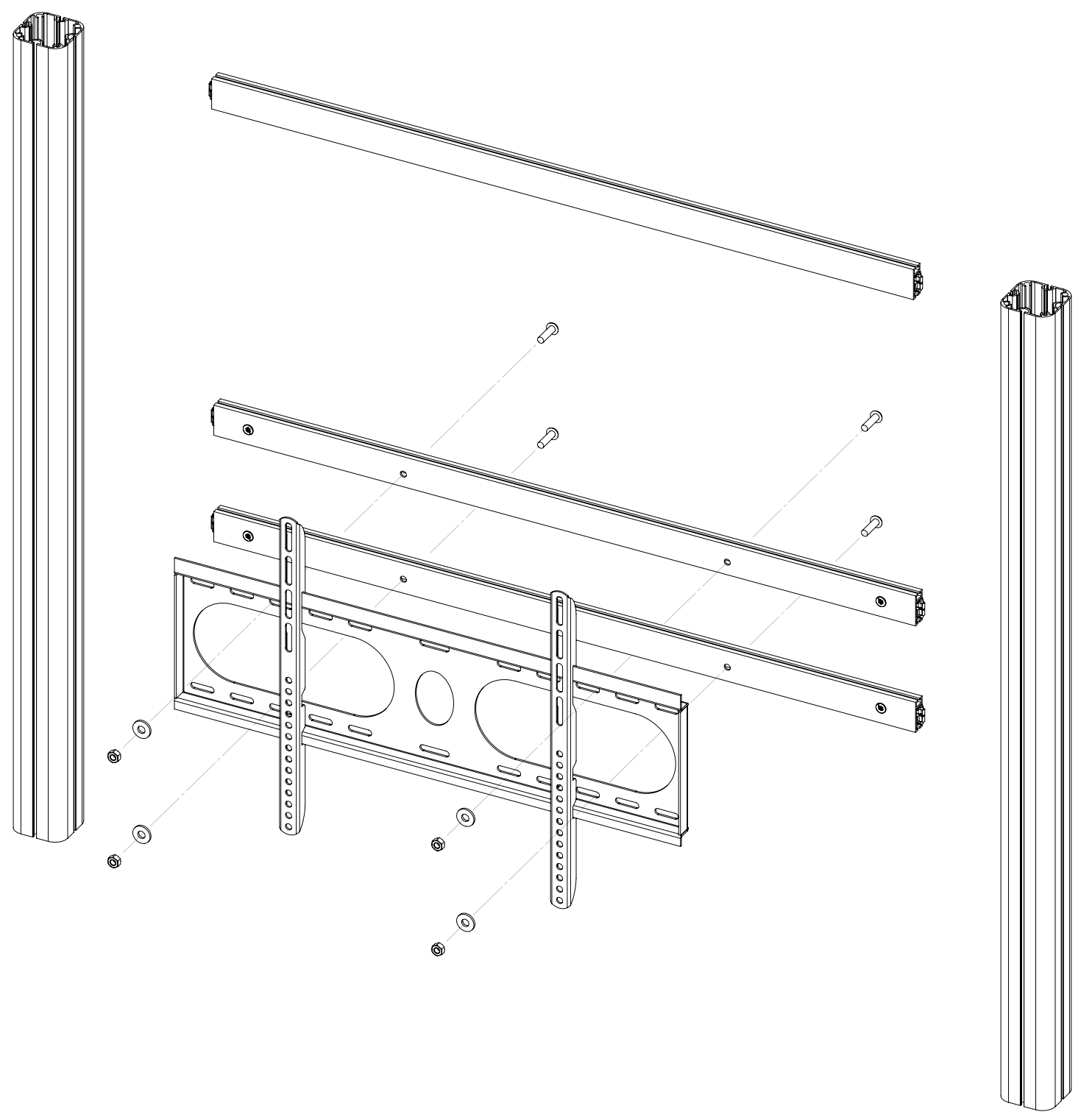

CENTER ASSEMBLY
 MONITOR MOUNT

8

7

6

5

4

3

2

8

7

6

5

4

3

2

1

D

D

SLIDE DOWN T-BOLTS ON MIDDLE POSTS BEFORE INSTALLING (WAVE-TUBE-UPRIGHTS)

C

C

B

B

A

A

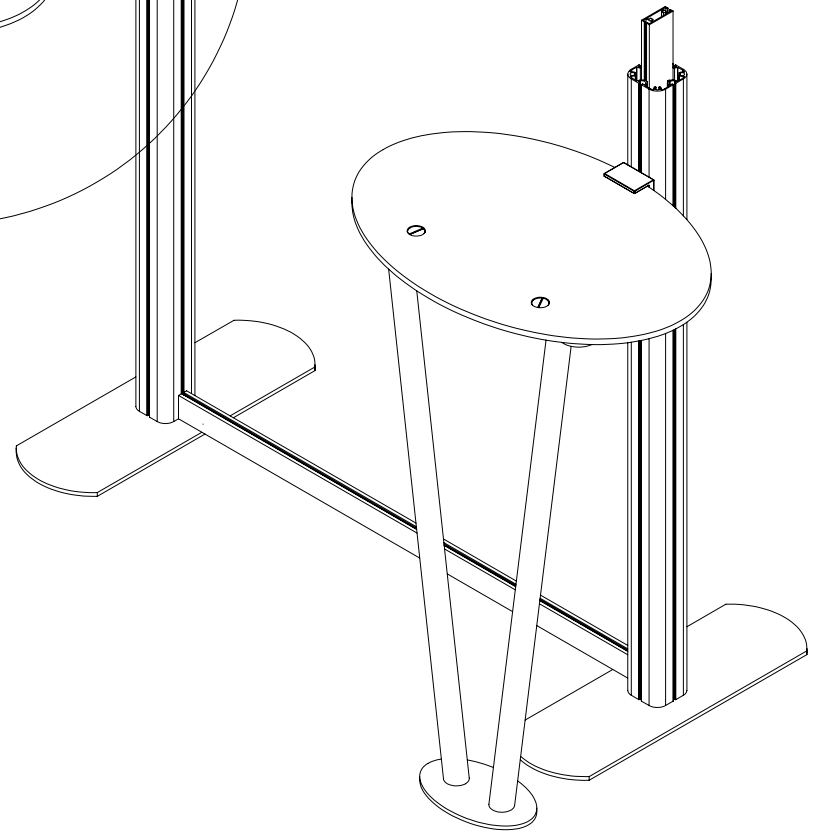
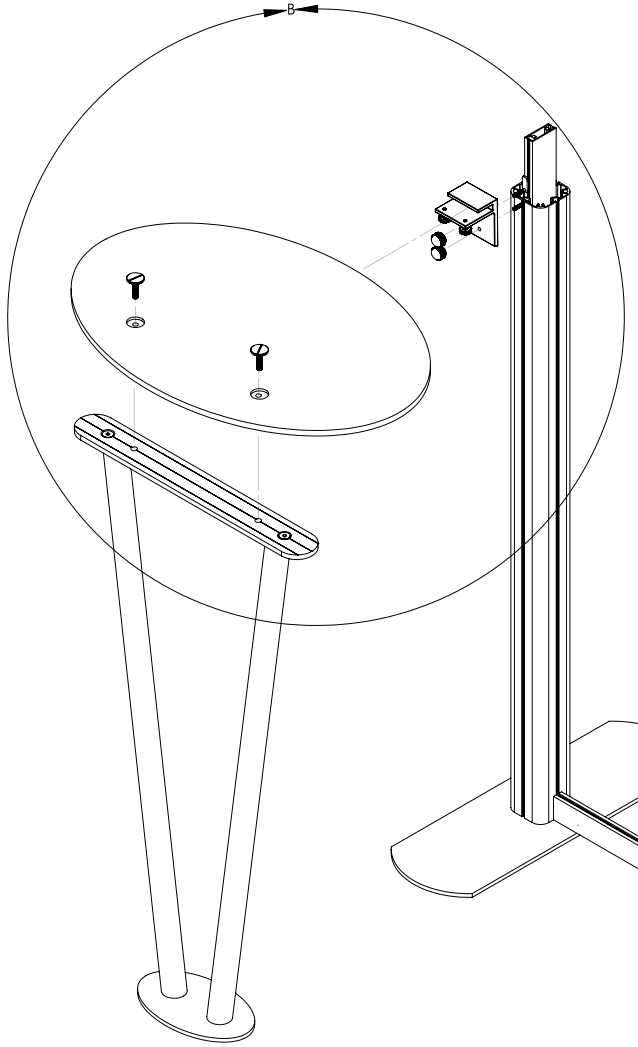
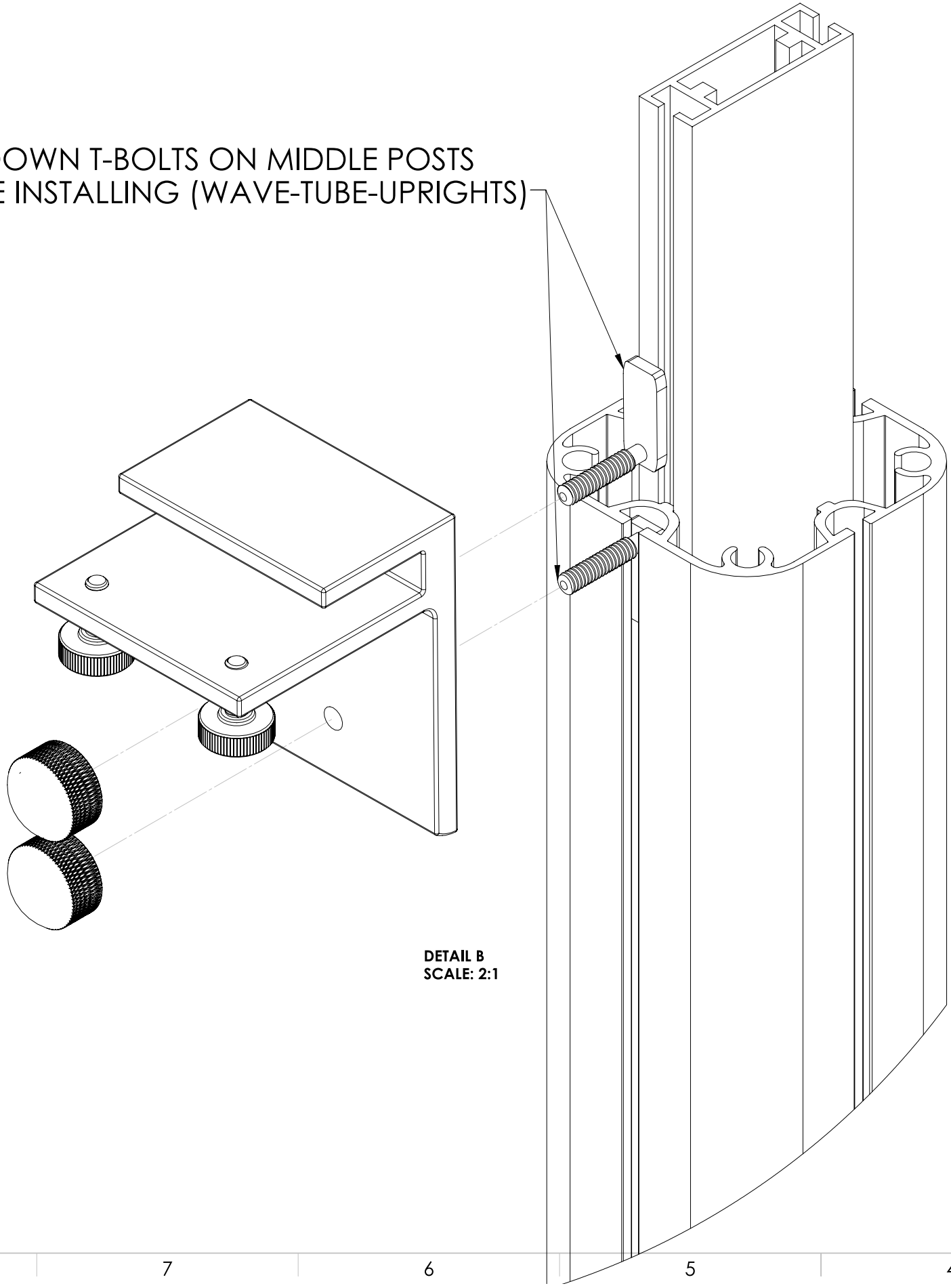

RECEPTION DESK

8

7

6

5

4

3

2

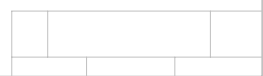

8

7

6

5

4

3

2

1

D

D

C

C

B

B

A

A

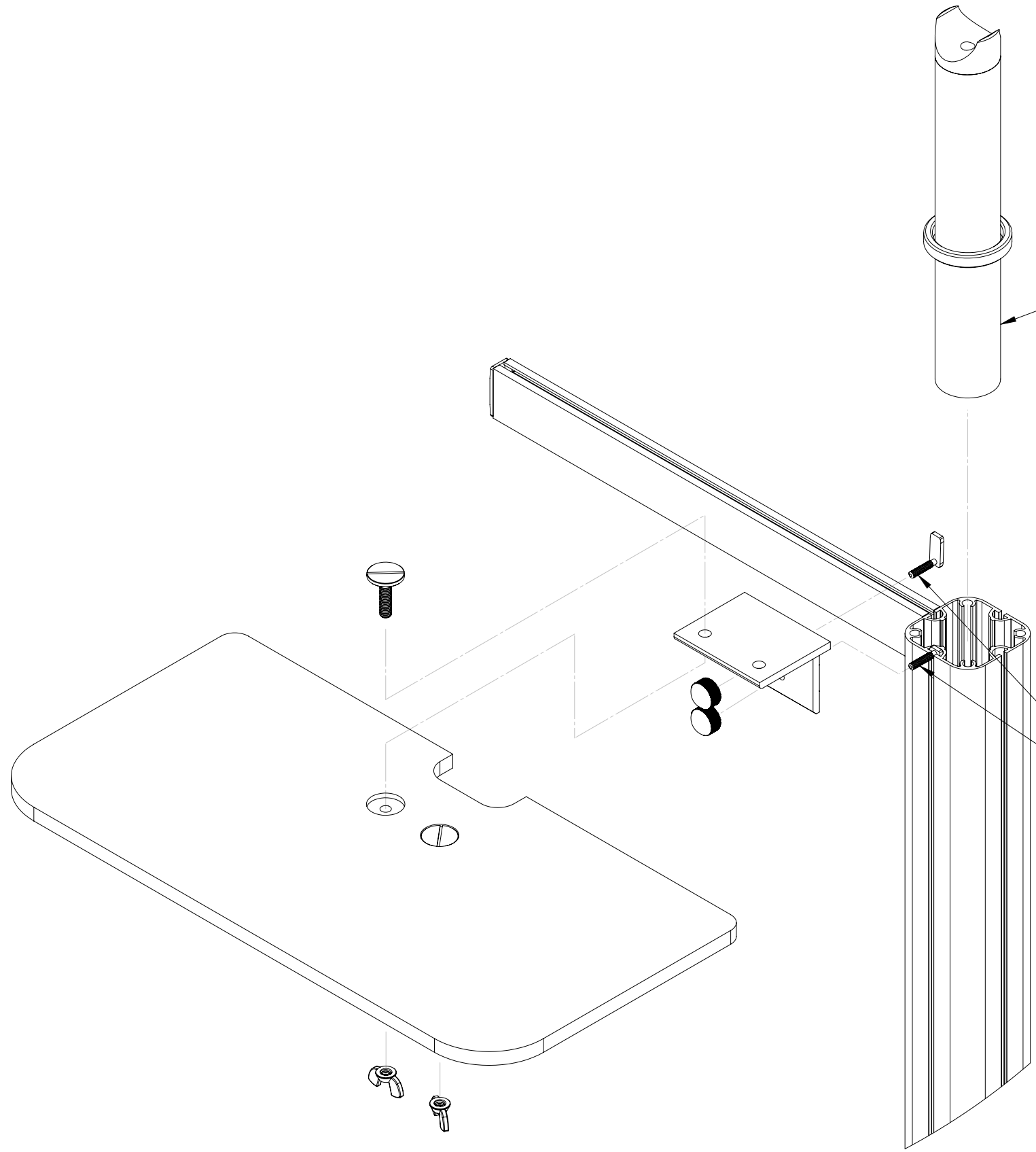

WAVE TUBE UPRIGHT

**SLIDE DOWN T-BOLTS ON POSTS
BEFORE INSTALLING
(WAVE-TUBE-UPRIGHTS)**

**THIS APPLIES TO ALL OTHER
SHELF BRACKETS**

**SHELF
ASSEMBLY - 1**

8

7

6

5

4

3

2

8

7

6

5

4

3

2

1

D

C

B

A

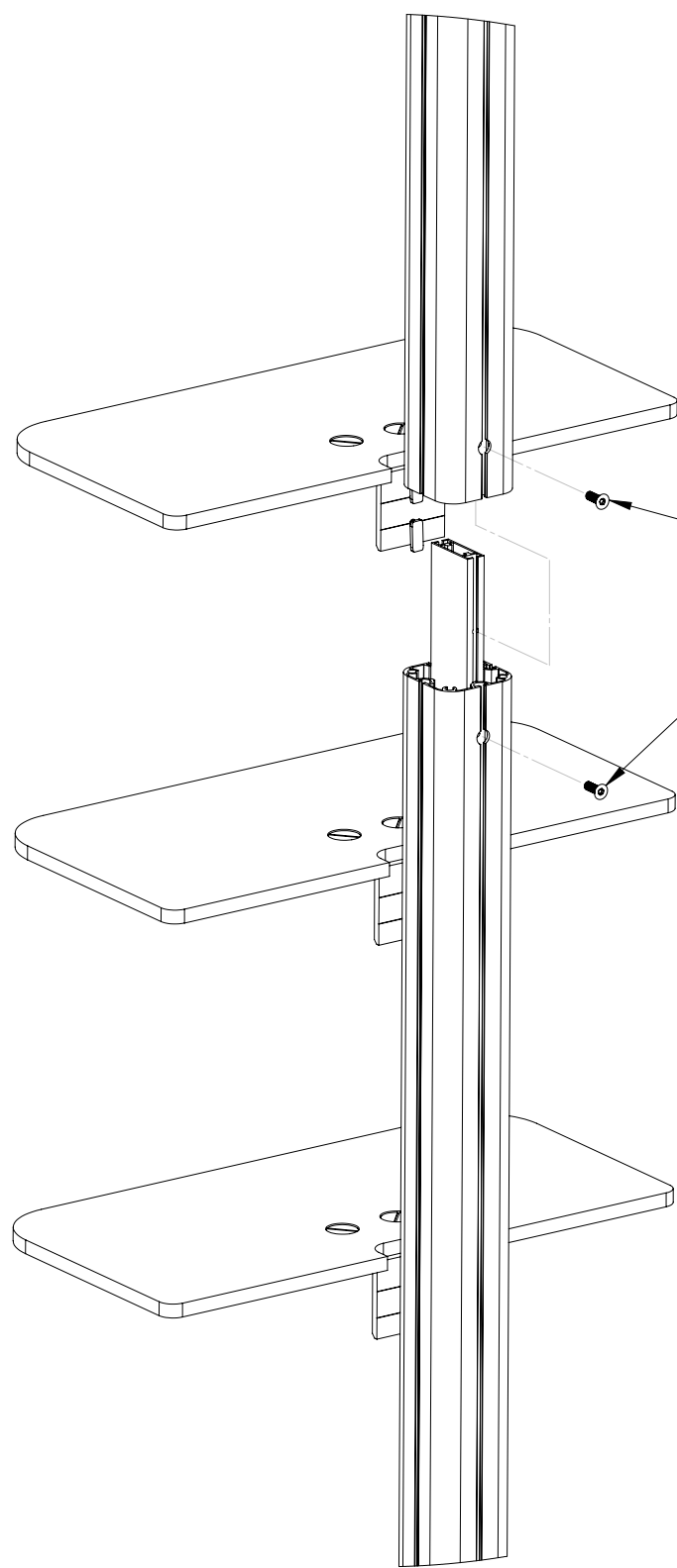

BACK VIEW

POST SCREWS ARE POSITIONED FROM THE BACK OF THE ENTIRE FRAME

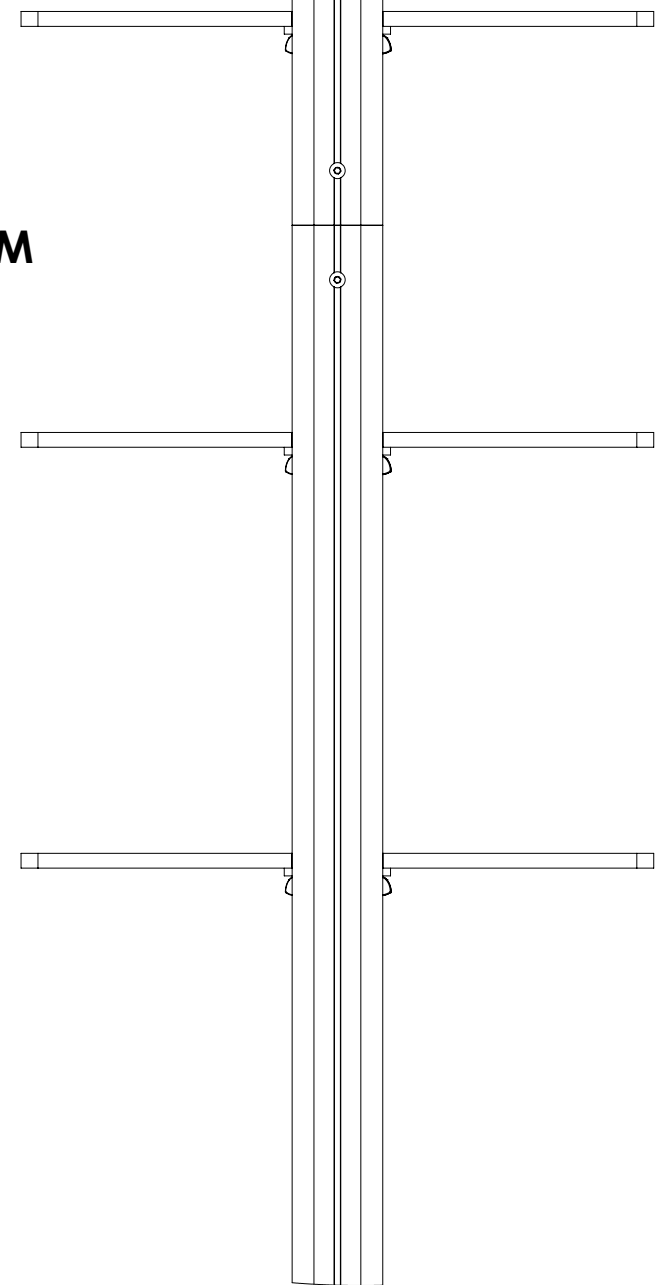

BACK VIEW

D

C

B

A

SHELF ASSEMBLY - 2

8

7

6

5

4

3

2

8

7

6

5

4

3

2

1

D

D

C

C

B

B

A

A

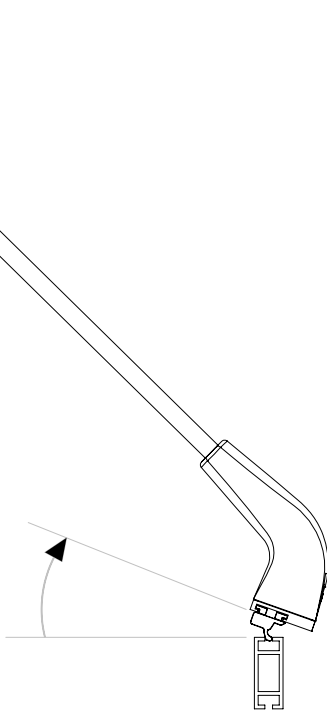
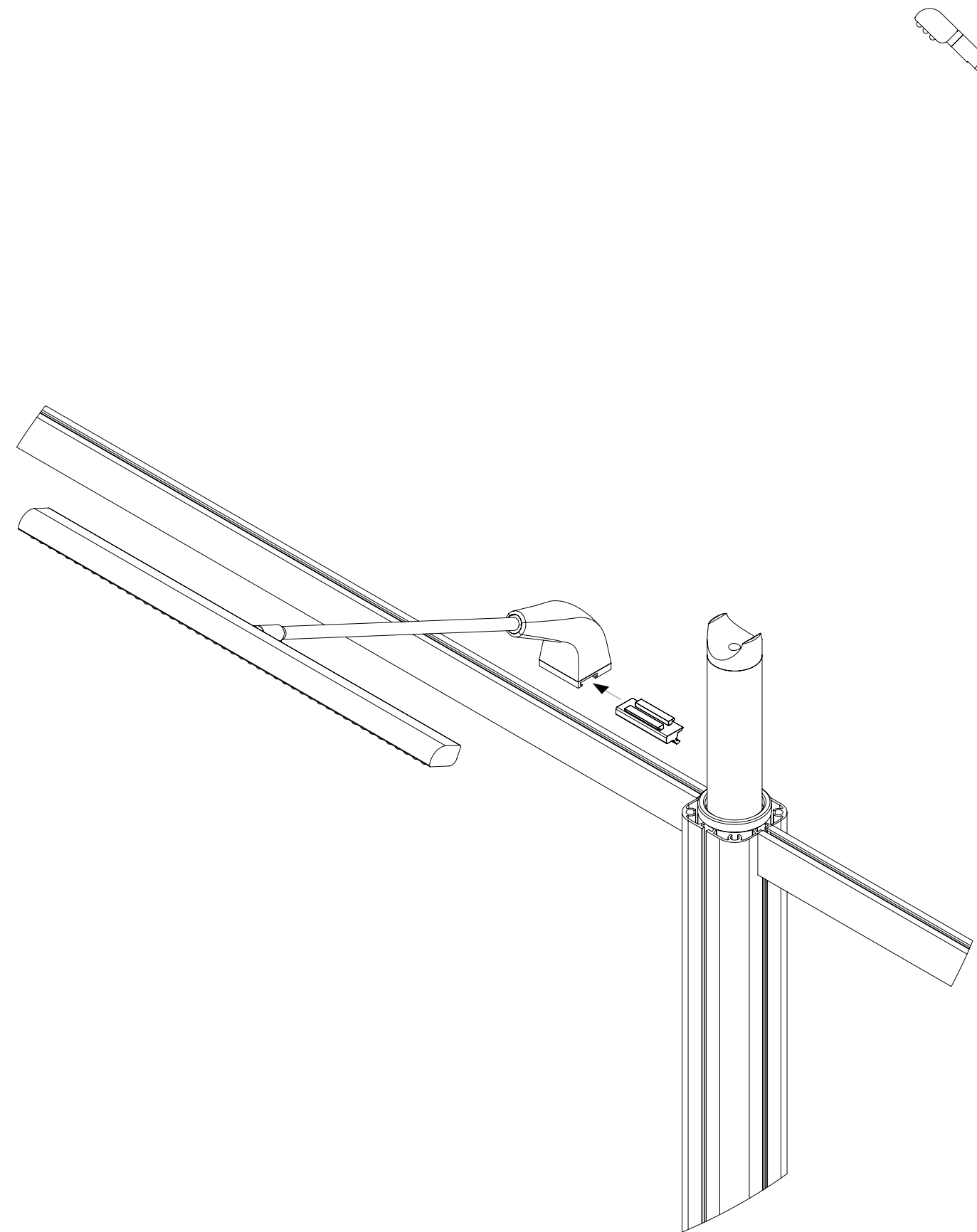

**TILT LED-LAMPS SLIGHTLY TO
INSERT SECURELY INTO TOP FRAME**

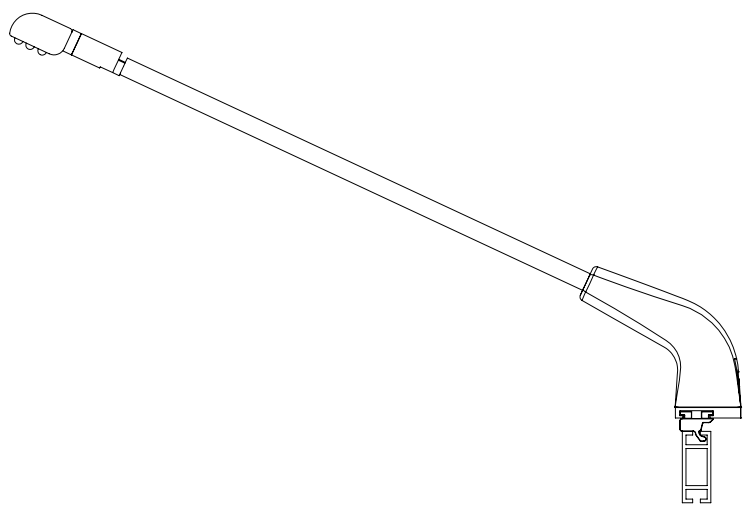

INSERTED INTO FRAME



DETAIL M
SCALE 1 : 2

LIGHTS
ASSEMBLY

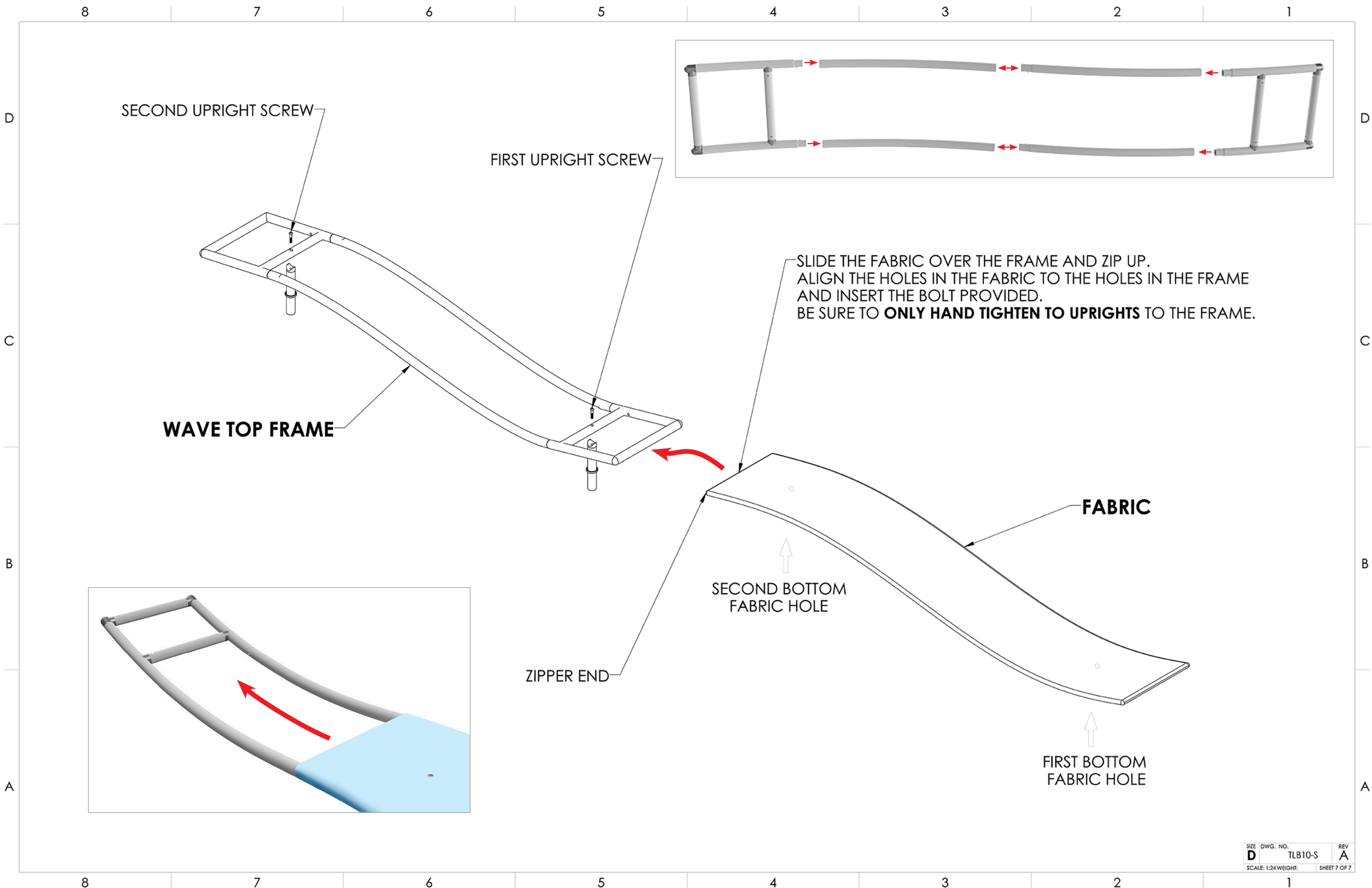

SECOND UPRIGHT SCREW

FIRST UPRIGHT SCREW

WAVE TOP FRAME

FABRIC

ZIPPER END

SECOND BOTTOM FABRIC HOLE

FIRST BOTTOM FABRIC HOLE

SLIDE THE FABRIC OVER THE FRAME AND ZIP UP.
ALIGN THE HOLES IN THE FABRIC TO THE HOLES IN THE FRAME
AND INSERT THE BOLT PROVIDED.
BE SURE TO **ONLY HAND TIGHTEN TO UPRIGHTS** TO THE FRAME.

WAVE TOP ASSEMBLY

PACKING - UNPACKING

RETAIN ALL PACKING MATERIAL WILL MAKE RE-PACKING EASIER AND REDUCE THE LIKELIHOOD OF SHIPPING DAMAGE



TOP LAYER 1

Description
Headers (optional)
(1) Dye-Sub Center and (2) Side Fabric Graphics
LIGHTLY FOLD GRAPHICS - DO NOT CREASE

DESCRIPTION
CASE 1 ONLY - CENTER PANEL PARTS
Description
(1) Center Panel TV Bracket Kit
(2) Z4400 Frame 35.63" Long
(1) Center Dye-Sub Fabric Panel

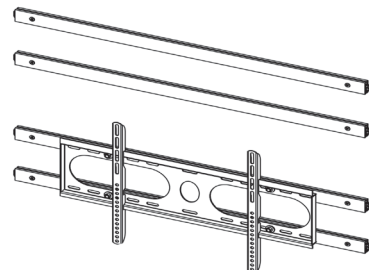

LAYER 2

Description
(2) Wave Tube Upright
(2) Wave Top Ends

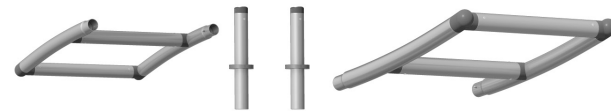

LAYER 3

Description	Description
(2) Timberline Feet	(3) Acrylic Shelves
(2) LED Lights / Electrical Cord Sets	(1) Reception Desk Kit

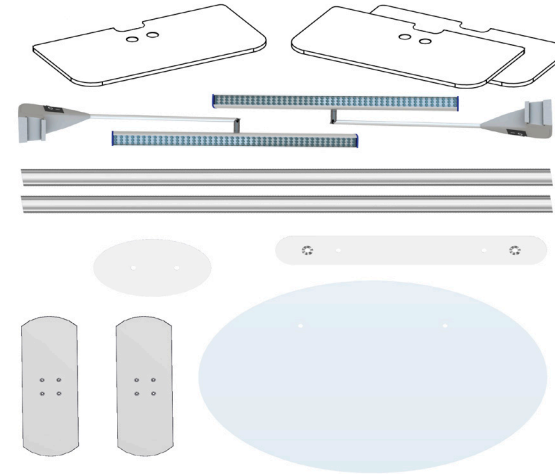

BOTTOM LAYER 4

Description	Description
(4) Timberline Posts	(6) Support Bars
(4) Wave Top Connector Tubes	Boxes with Bolts, Tools

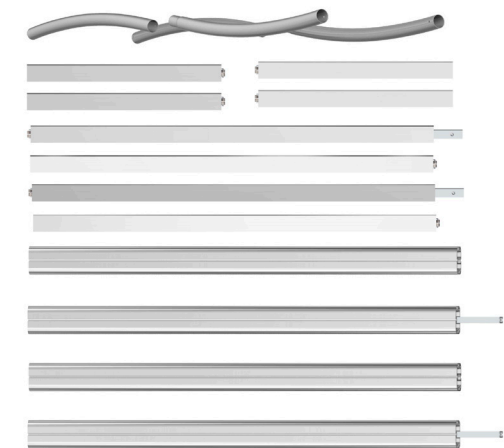

WHEN DISASSEMBLING ALUMINUM EXTRUSIONS, TIGHTEN ALL SET SCREWS AND LOCKS TO PREVENT LOSS DURING SHIPPING

STEP 1

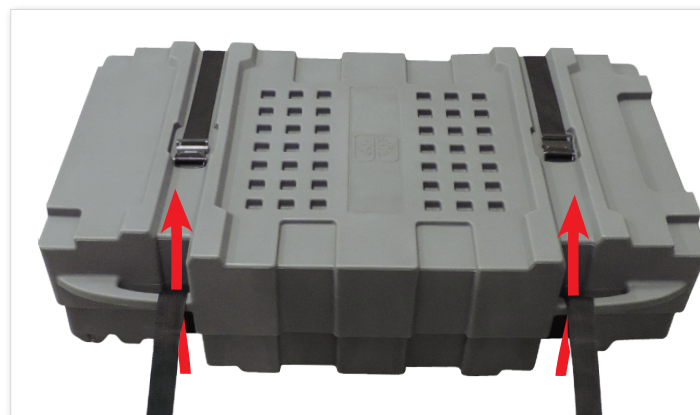

With cover on, feed the 2 front straps up thru the handles and over the top. Connect front & back straps thru seatbelt connection.

STEP 2



Feed strap thru strap divider

STEP 3



Pull strap up and backwards

STEP 4



Smooth strap down and snugly fasten strap via velcro

CLEANING / CARE INSTRUCTIONS

Use care when cleaning aluminum extrusion or acrylic inserts. Use only non-abrasive cleaners.
When cleaning laminate inserts or counter tops use mild cleansers and a soft material such as cotton
Keep all display components away from extreme heat and long exposure to sunlight to avoid warping and fading.

FABRIC CARE INSTRUCTIONS

FOLDING: Due to the fine quality, smoothness and weave of the fabric, great care must be taken to extend the life of your SEG fabric graphics. We recommend **very loosely** folding your graphic, making sure there are **no hard creases or folds or that the fabric doesn't catch on sharp objects.**

STORING: Store in a clean bag. A plastic bag or pillowcase is ideal. Graphics can also be spot cleaned with a damp cloth.

WASHING: To wash entire graphic, use a commercial size front loading washing machine on gentle cycle with cool water. **Do NOT dry clean.**

You can also gently iron the back side using the Polyester setting of your iron.