

# **Shelving Display Instructions**

# Overview

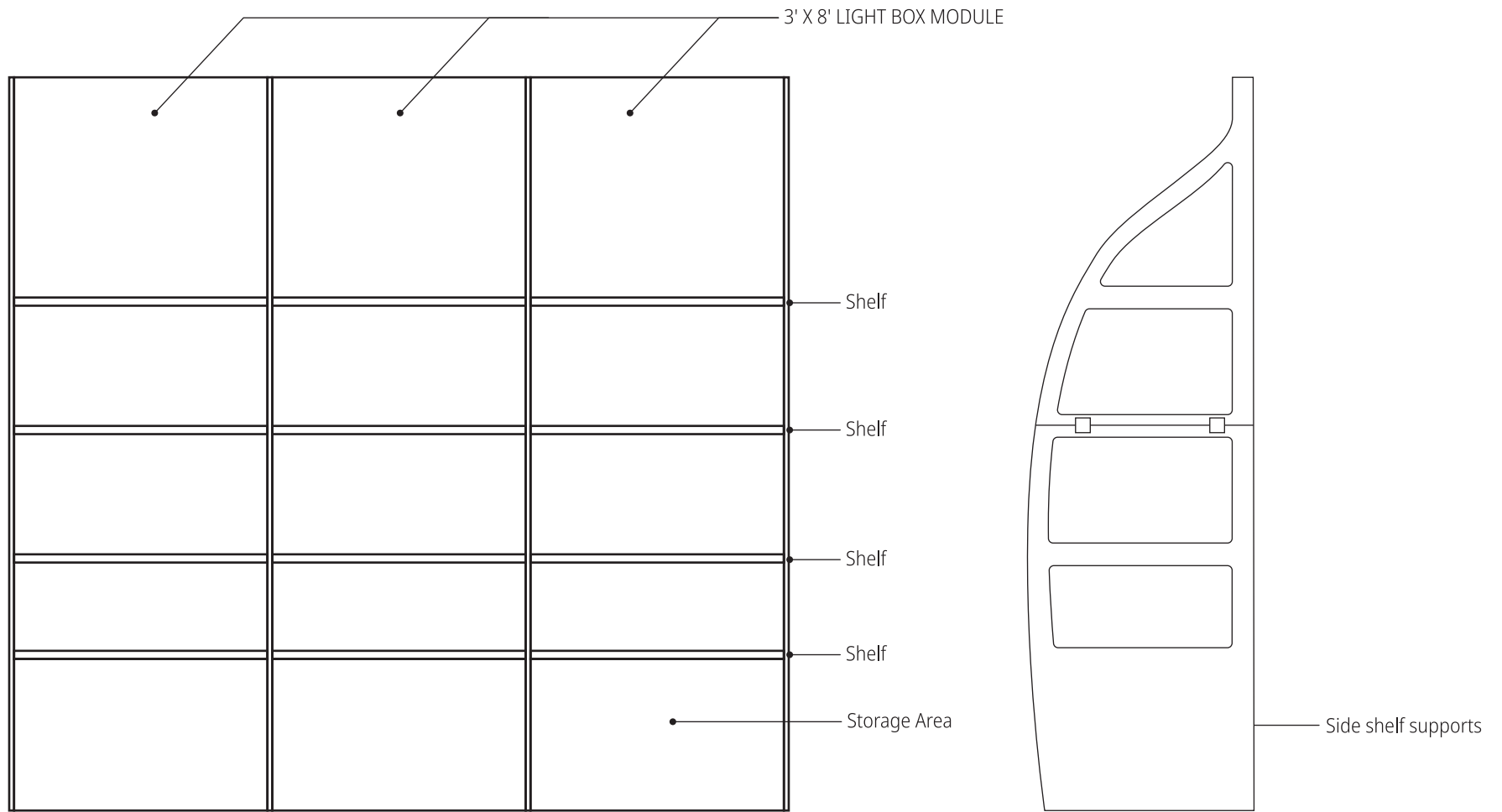

Front View

Side View

# 3' X 8' Light box module (3x)

Detailed step how to assemble the 3' X 8' LIGHT BOX MODULE.  
Repeat process on the other 2 LIGHT BOX MODULE.

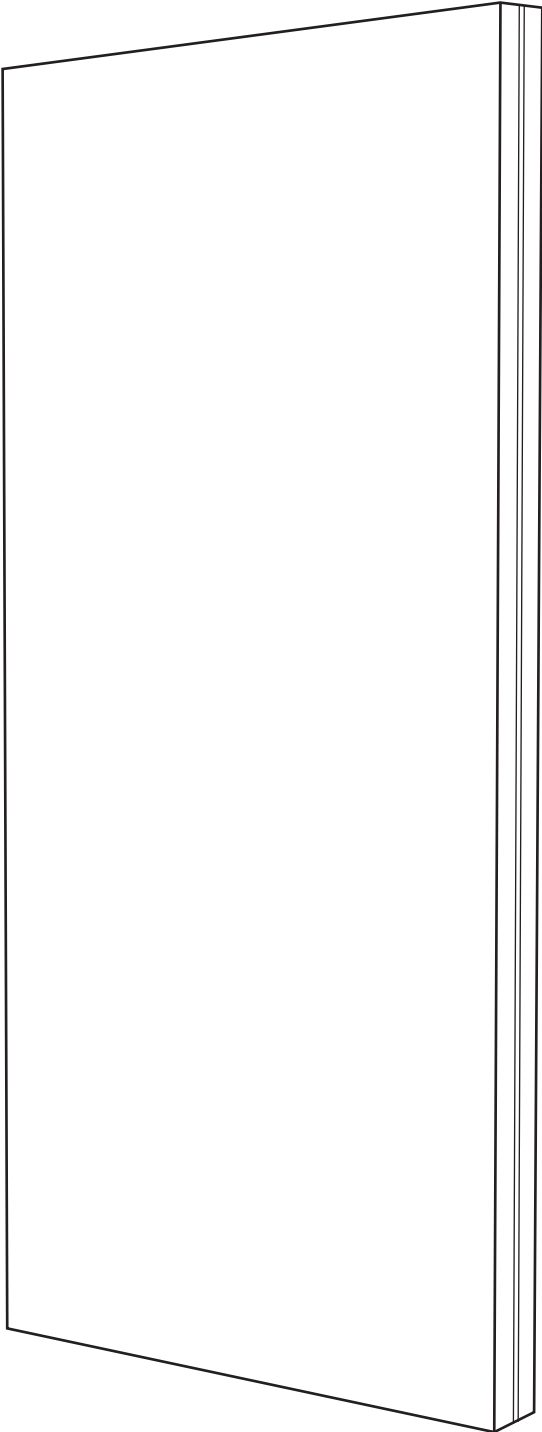
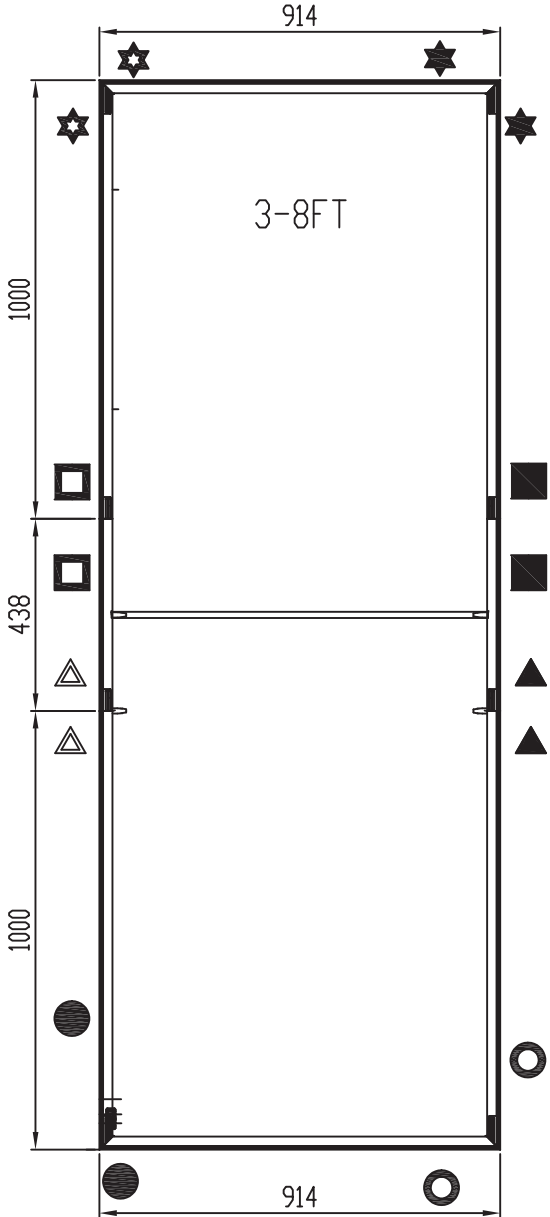

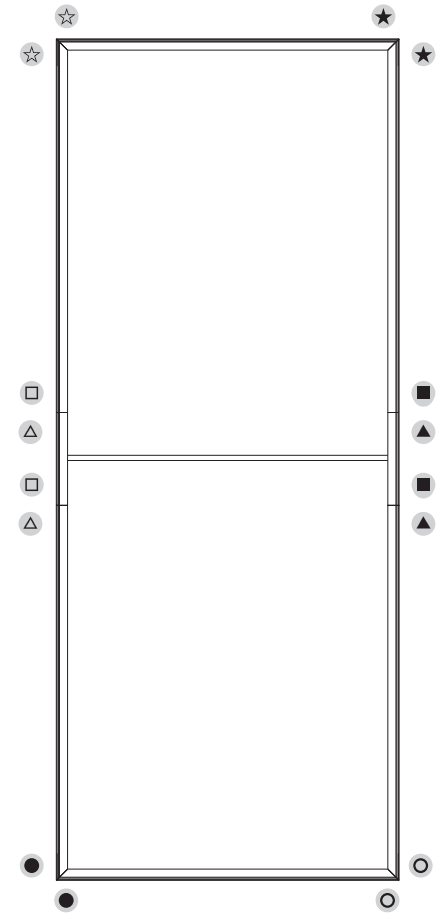
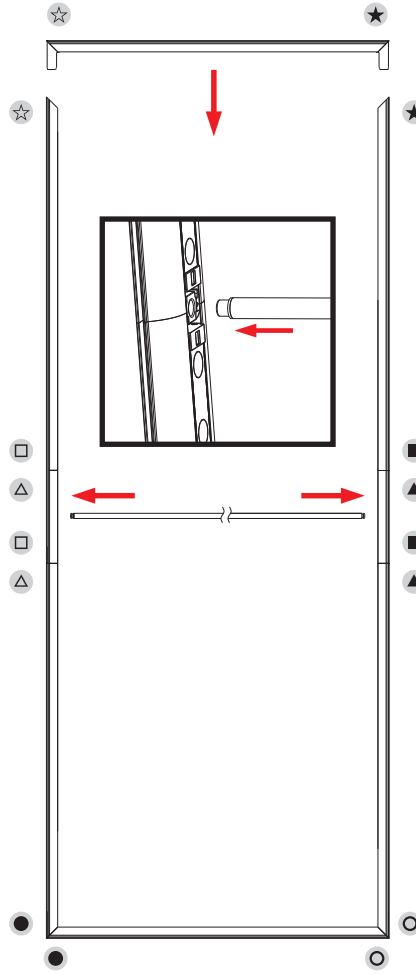
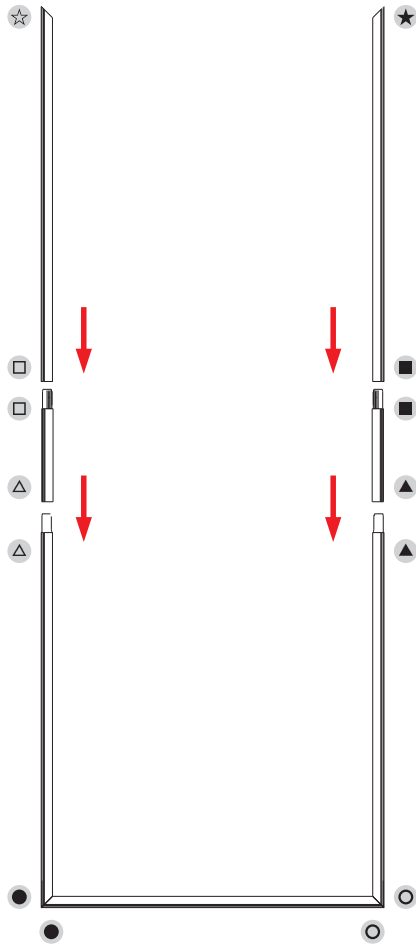
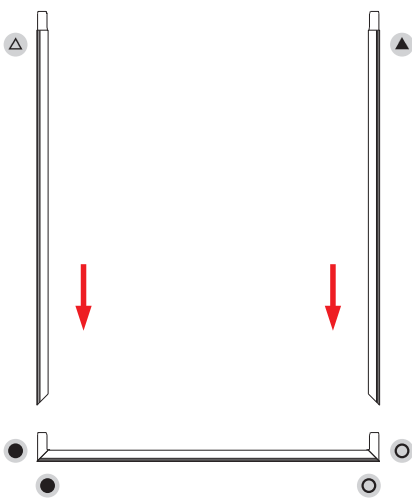
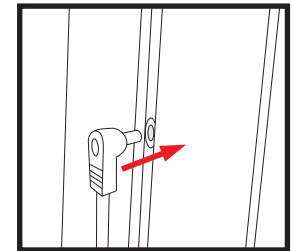
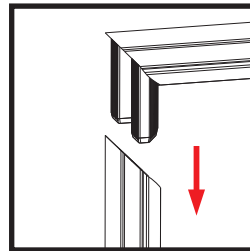
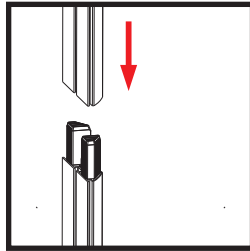
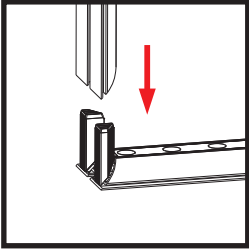

# Side shelf supports Assembly (4x)

Connect the top and lower part of the support using the provided clip, Repeat for other 3 Side shelf supports.

