

Parts List

A.) x8 - Bottom Columns

B.) x6 - Top Columns

C.) x2 - Top Columns w/ Standoffs

D.) x6 - L=34" Back Crossbars

E.) x14 - L=14" Side Crossbars

F.) x9 - L=34" Shelf Crossbars

G.) x9 - Shelves

H.) x18 - XV Shelf Knobs

I.) x3 - SEG Graphics

J.) x3 - Stem Lights

K.) x1 - Header

L.) x2 - Standoffs

M.) x3 - XV Stem Knobs

Step 1. Attach bottom crossbars to bottom columns.

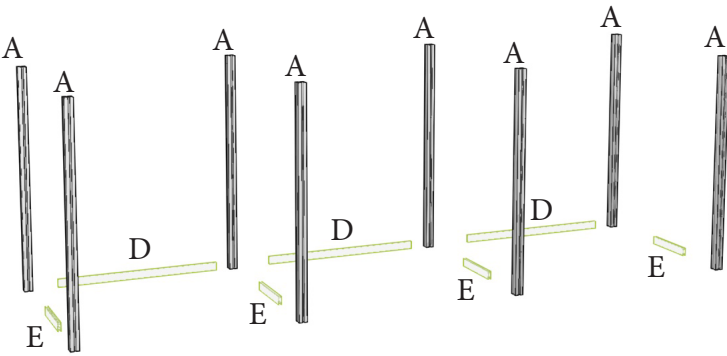
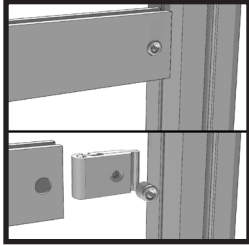

Step 2. Attach top columns to bottom columns.

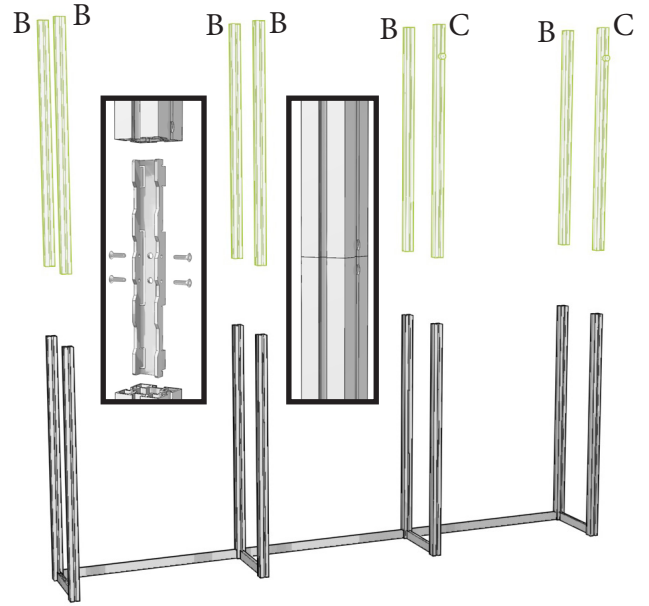

Step 3. Attach top crossbars to top columns.

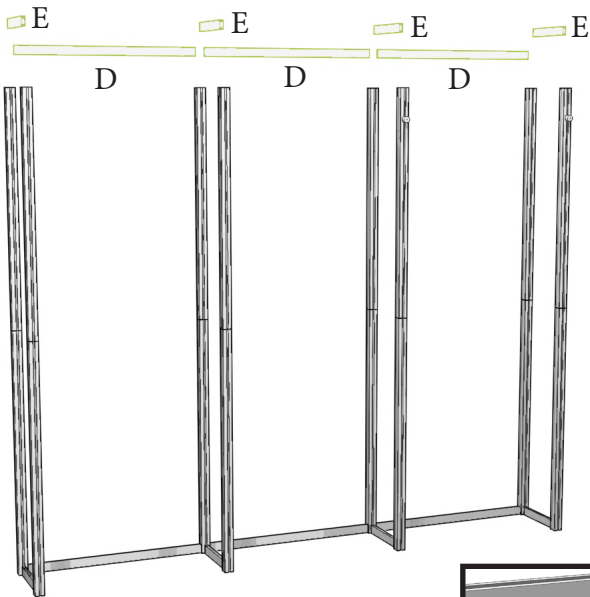

Step 4. Attach shelf supports to front columns.

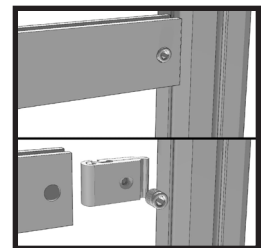
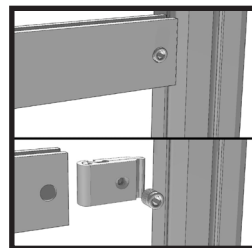
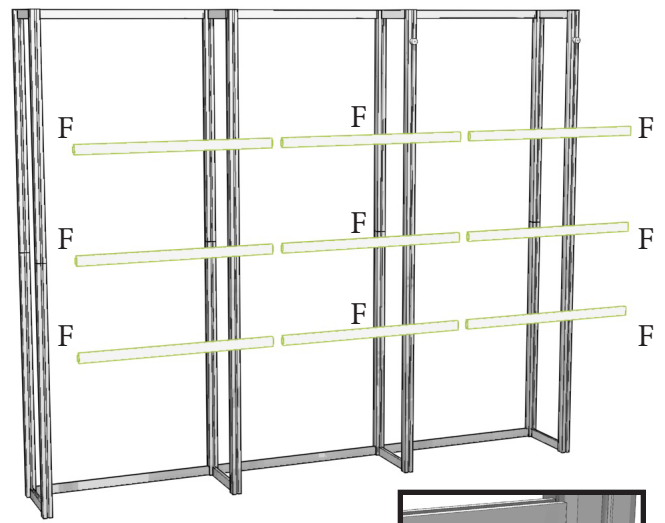

Step 5. Attach shelves using x2 XV Knobs each. **Step 6.** Attach graphics.

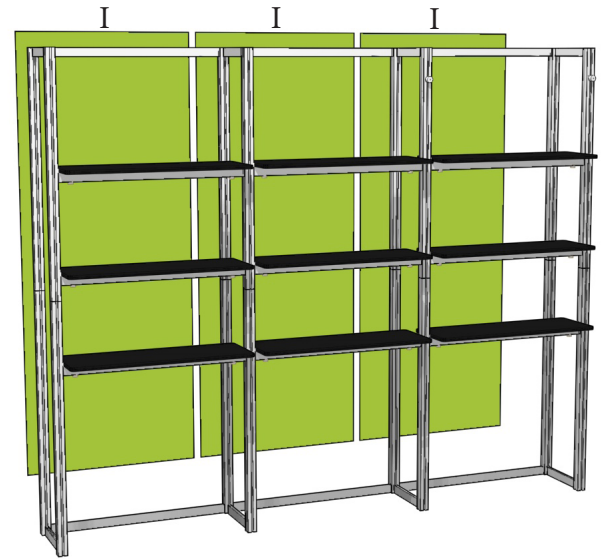
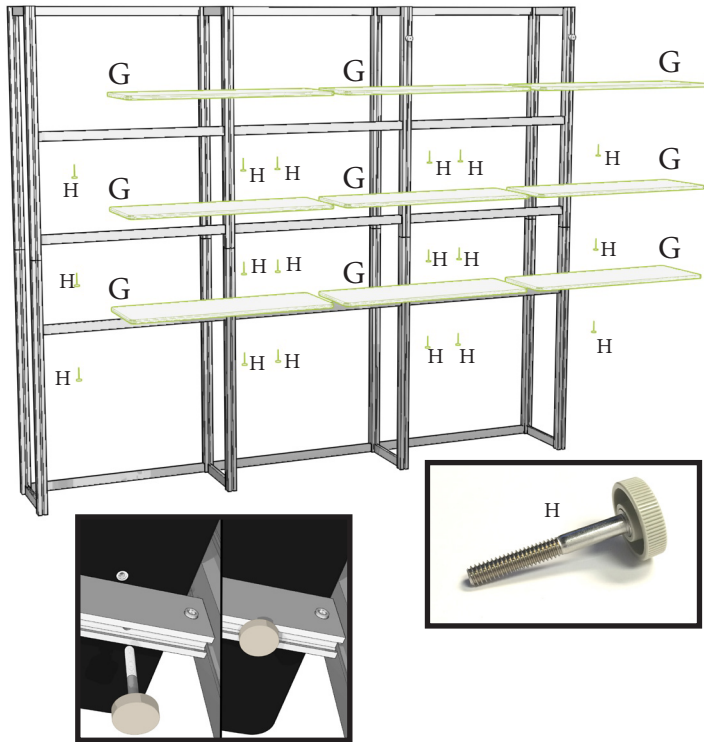

Step 6. Attach stem lights & standoff headers.

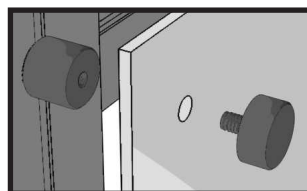
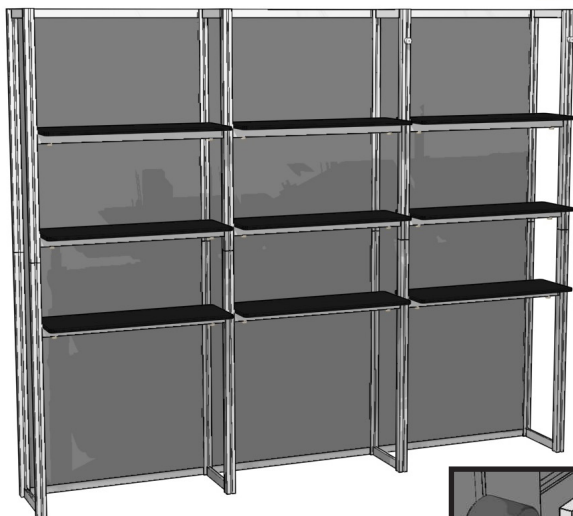

COMPLETE

