

Setup Instructions

OT-PKG-8_8ft. 4 Shelf Outrigger Package



8ft. StraightWall Frame with Fabric Face Panels

1. Assemble the Straightwall Frame. Frame Members connect via Snap-Fit Bullet Connectors. Simply line-up the Frame Holes/Bullet Connectors and push-in to engage. Frame Members are labeled and must be positioned as shown. Velcro on frames should face outward for panel attachment.
2. Velcro the 4 Fabric Panels to the assembled Straightwall Frame as shown at right. Begin at one end of the Frame and work across to the opposite end. The End Panels should fit flush to the edges of the frame while the Intermediate Panels set half-width on the Vertical Frames.
3. If applicable, the attached Instruction Sheets show the placement of the Graphic Panels.

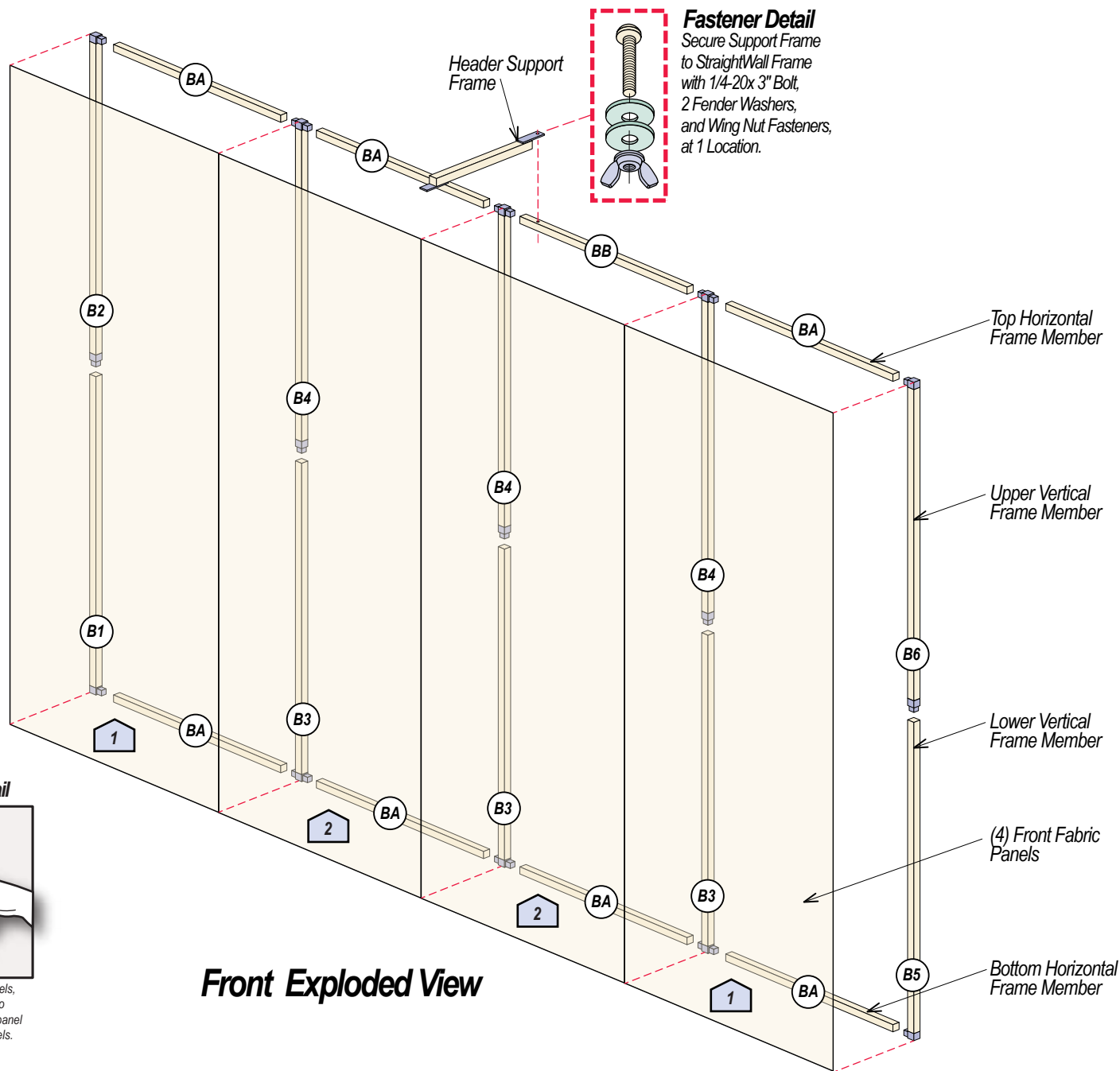

Typical Snap-Fit Bullet Connectors

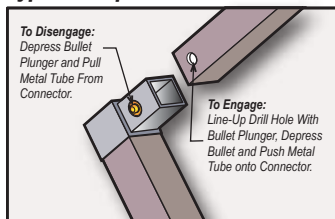

Separating Velcro Detail

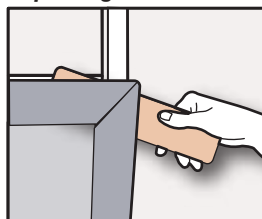

Please note that when removing panels, use a thin tool such as a putty knife to separate the Velcro. Separating the panel Velcro by force can damage the panels.

8ft. Outrigger Frame Assembly

1. All Frame Pieces connect via Snap-Fit Bullet Connectors. Simply line-up the Frame Holes/Bullet Connectors and push-in to engage (refer to detail at right). The Frame Members are labeled and must be attached were shown.
2. Assemble the 2-Section Vertical Outrigger Frames. Note that there is a Outrigger Short Center Frame. Then attach the Horizontal Shelf Support Frames to the Outrigger Frames. Outrigger Frames Velcro to the Front of the Assembled Fabric Panels between Graphic Panels.
3. Hang the 2 Fluorescent Light Bars over the Wall Frames. Refer to Fluorescent Light Detail Sheet. Connect all 4 Fixtures in-series then cable power cord to back of Wall Unit.

Separating Velcro Detail

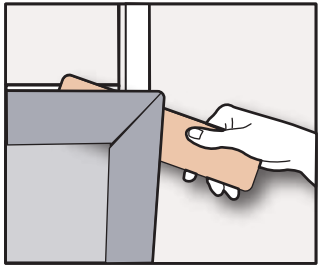

Please note that when removing panels, use a thin tool such as a putty knife to separate the Velcro. Separating the panel Velcro by force can damage the panels.

Typical Snap-Fit Bullet Connectors

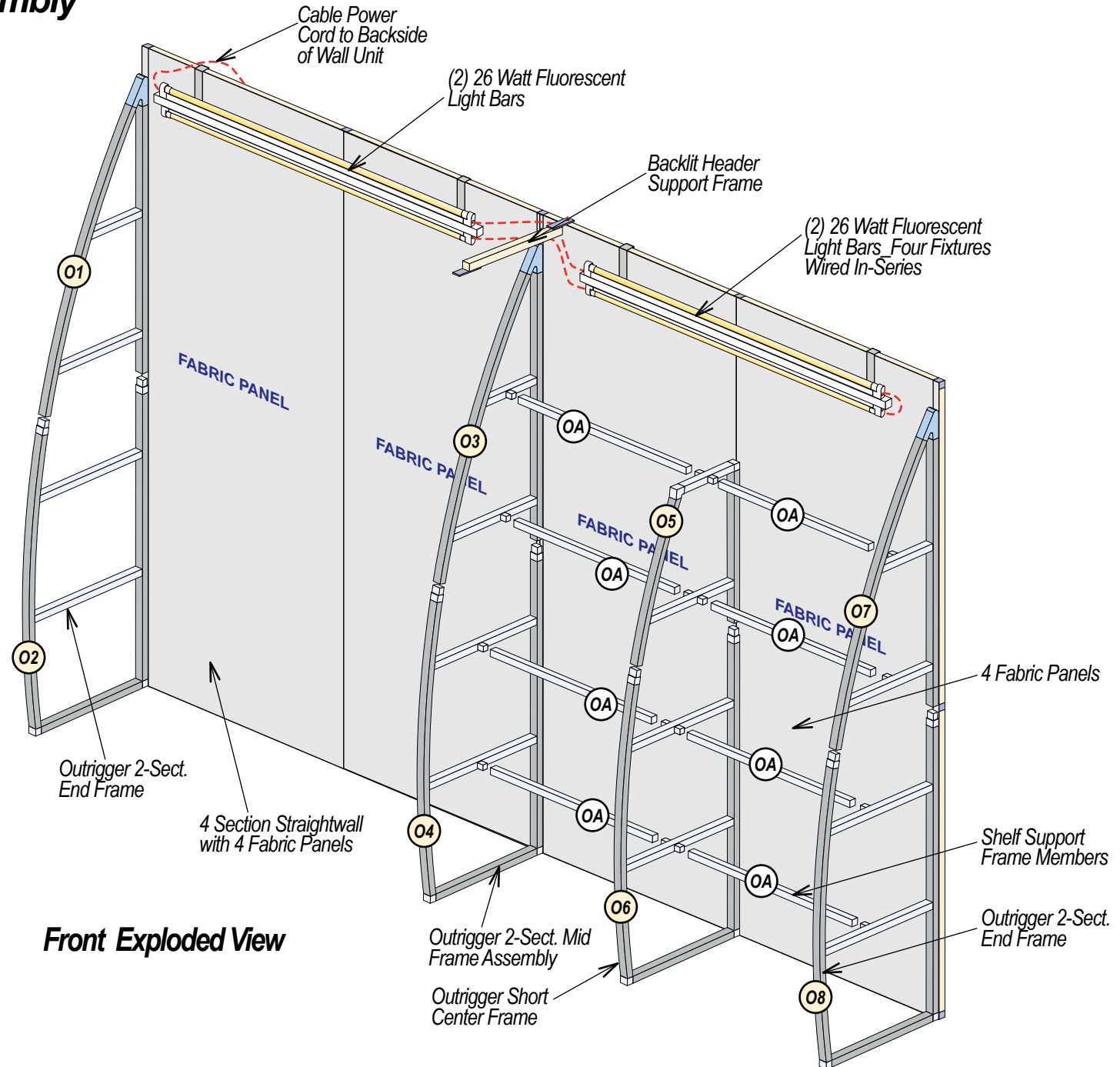
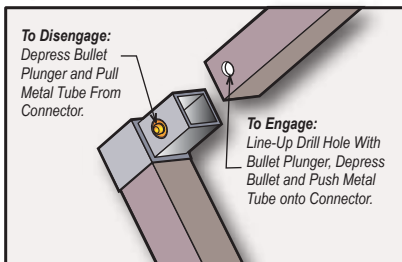

2-Section Backlit Curved Header Assembly

Step-by-Step Assembly

1. Assemble the Backlit Curved Header Frame as shown. Frame Members Connect via Snap-Fit Bullet Connectors. Simply line-up the Frame Holes/Bullet Connectors and push-in to engage. Note that the Frame Members are Labeled and must be positioned as shown.
2. Assemble the 2-piece Top and Bottom Horizontal Curved Frames then attach the Vertical End Frames as shown. Note that the Hanging Metal Brackets should be positioned on top at each end. Secure Bracket to Top Frame with fastener detailed and shown below.
3. Velcro the Backlit Graphic to the front perimeter of the Frame as shown. Begin at one side of the Header Frame and work to the opposite side.
4. Position the Backlit Header between the Outrigger End Frames and hang the Brackets over the Straightwall Unit as shown in the detail illustration at bottom-right.

Frame Assembly

Panel Assembly

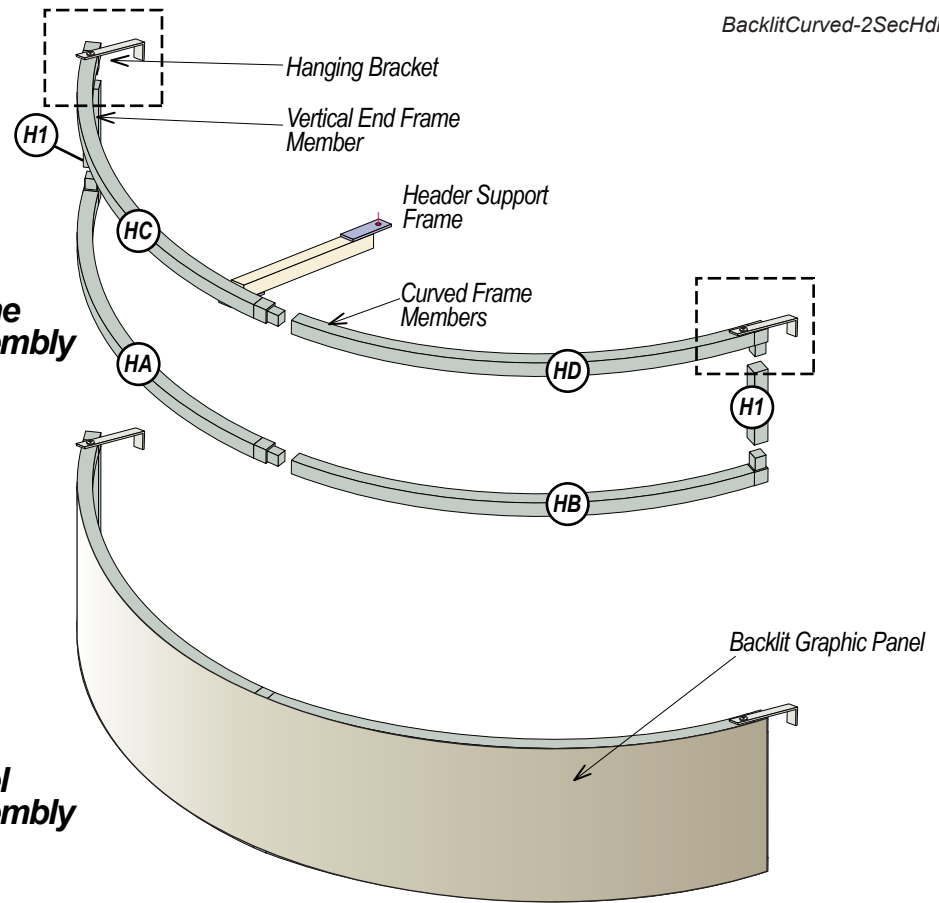

Typical Snap-Fit Bullet Connectors

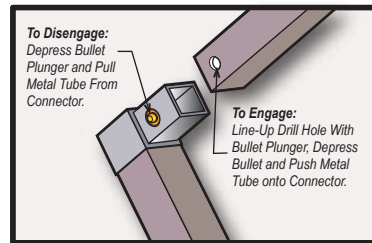

Separating Velcro Detail

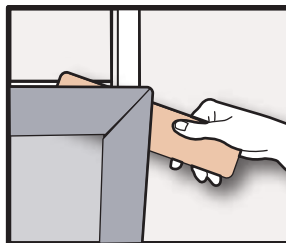

Please note that when removing panels, use a thin tool such as a putty knife to separate the Velcro. Separating the panel Velcro by force can damage the panels.

Header Hanging Bracket Detail



To Hang Header Loosen Screw and Reposition Bracket as shown.

Hanging Curved Header Assembly

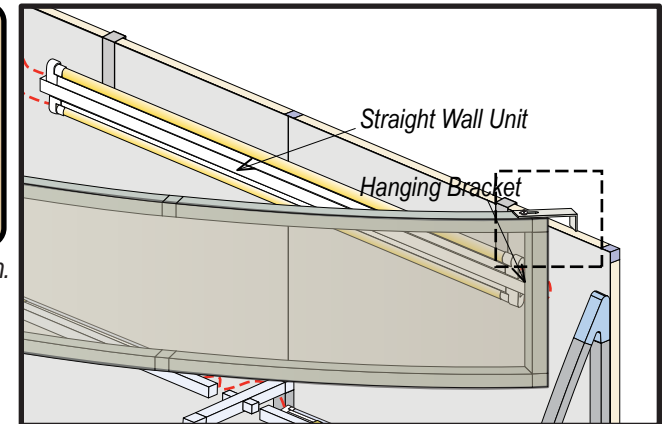

Position Hanging Brackets over the top of the Straight Wall Frame.

Key to Symbols

- Represents Frame Member
- Represents Fabric Panels

Outrigger Shelf Assembly

1. Hang the Metal brackets on the ends of the Curved Header over the Straight Wall Frame. Rest the Top Curved Header Frame onto the Header Support as shown.
2. Install the 8 Notched Shelf Panels onto the Outrigger Shelf Support Frames as shown. Note that the Shelf Panels are labeled and must be positioned as shown.

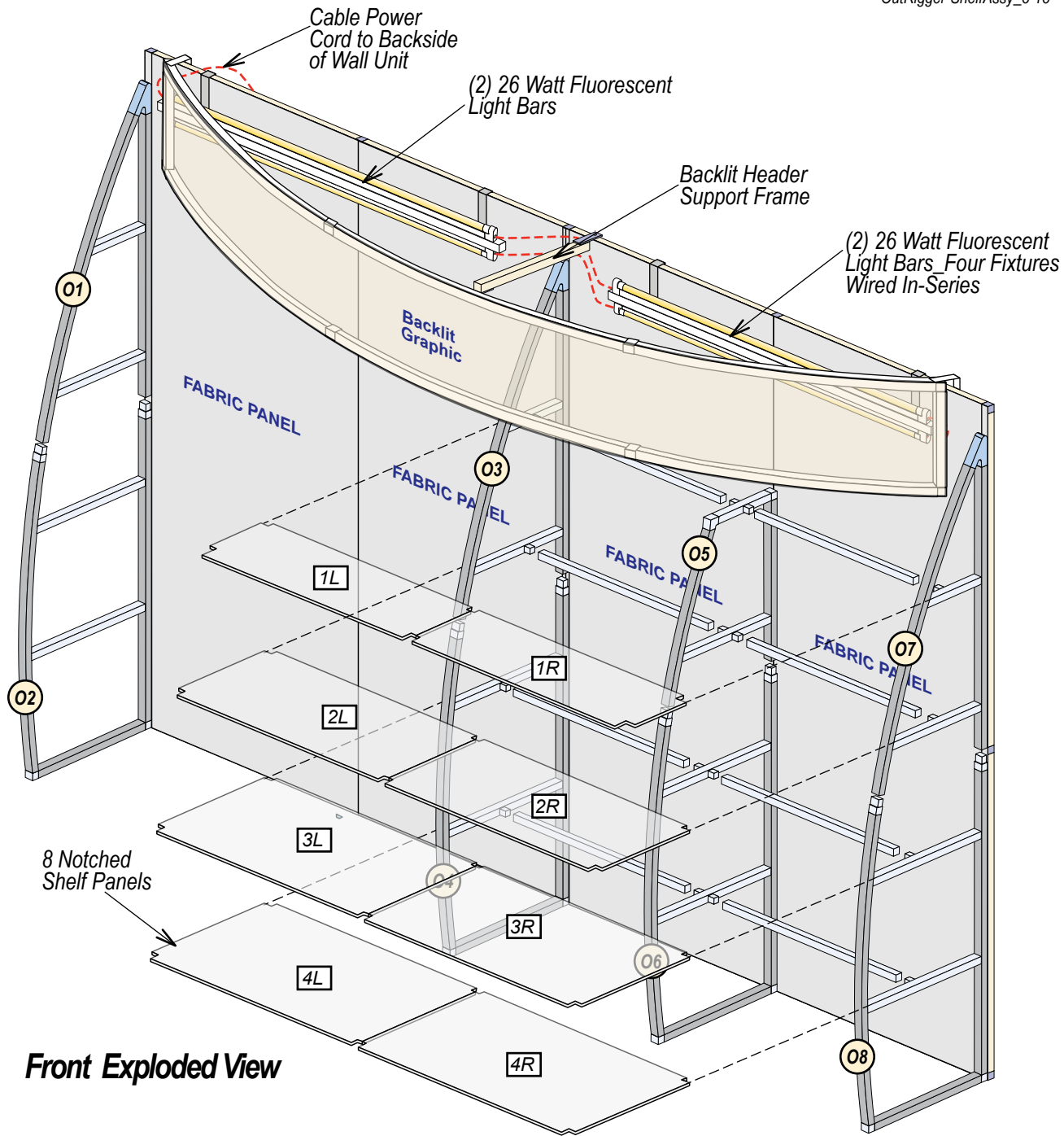

Separating Velcro Detail

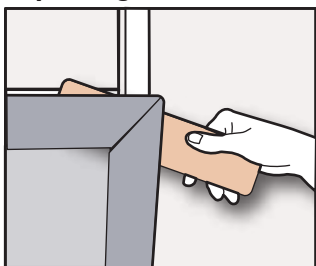

Please note that when removing panels, use a thin tool such as a putty knife to separate the Velcro. Separating the panel Velcro by force can damage the panels.

Front Exploded View

Fluorescent Light Fixture Assembly



Using Jumper Wires

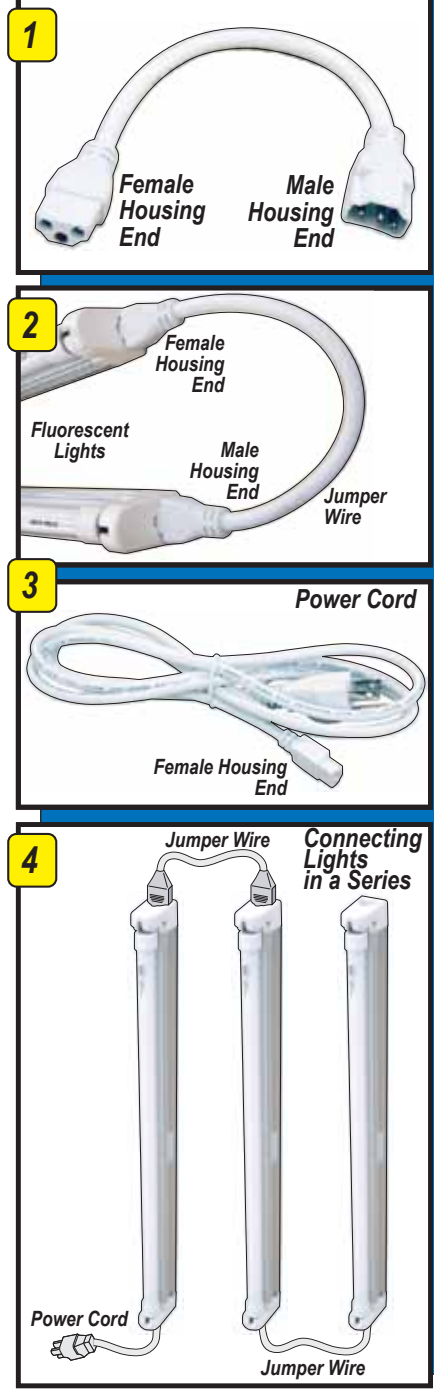

Fluorescent Bulb Attachment

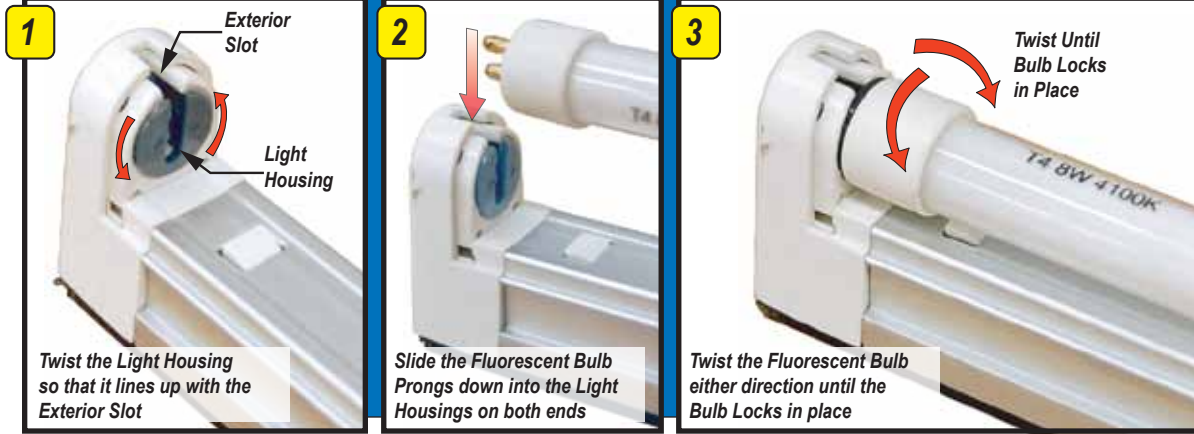

Joining Two Fixtures

