

ADDITIONAL IMAGES

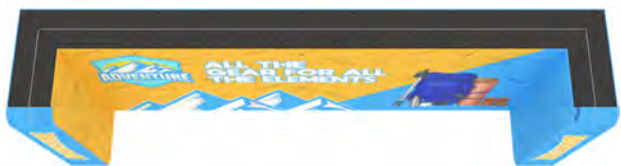

BACK AND TOP FABRIC COLORS

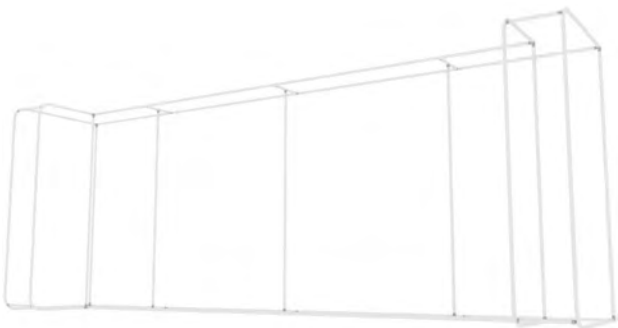
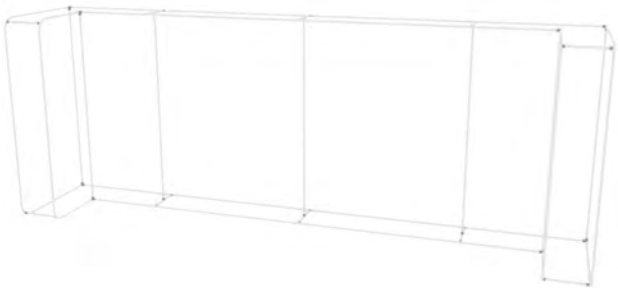

Single Sided Black Back Fabric



Single Sided White Back Fabric



Double Sided (Top is Always Black)

STORAGE AREA DETAILS



Storage area is located on the left and right hand sides of the display and is accessed via a zipper on the front face of the graphic. The zipper opens from the bottom up, starting from the corner where the front graphic meets the storage area and runs up along the end cap seam. Zipper color is white so keep that in mind when designing graphics.

SET UP INSTRUCTIONS/ PARTS LIST

REFERENCE LABELS ON TUBES WITH DIAGRAM BELOW FOR FRAME ASSEMBLY

OUTER FRAME ASSEMBLY

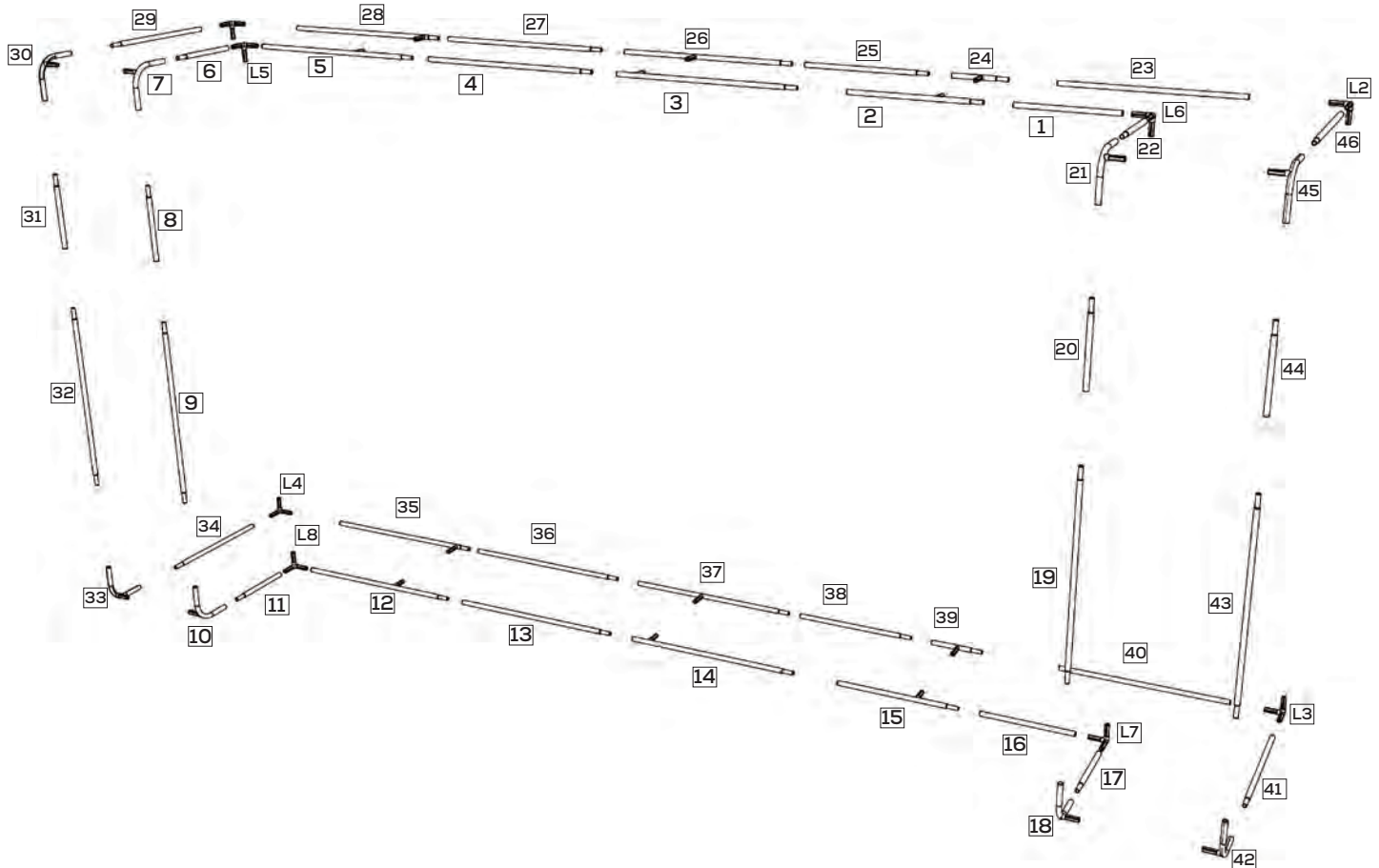

Define the location of the plastic connectors

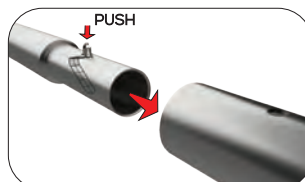

Press button & insert swaged end into receiving end of tubing



Press button & insert swaged end into receiving end of tubing

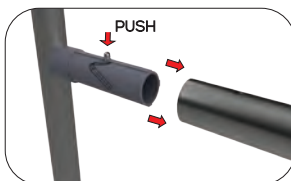

Attach the female tube in the right position and push the button, and slide the tube



Push the female tube until the button snaps

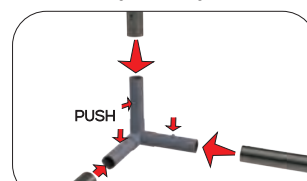

Place the female tubes in the right position

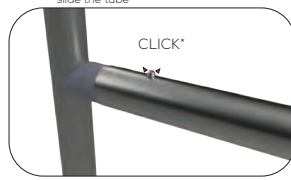

Push the female tube until the button snaps

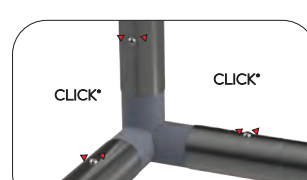

Push the female tube until the button snaps

SET UP INSTRUCTIONS/ PARTS LIST

SUPPORT STRUT INSTALLATION

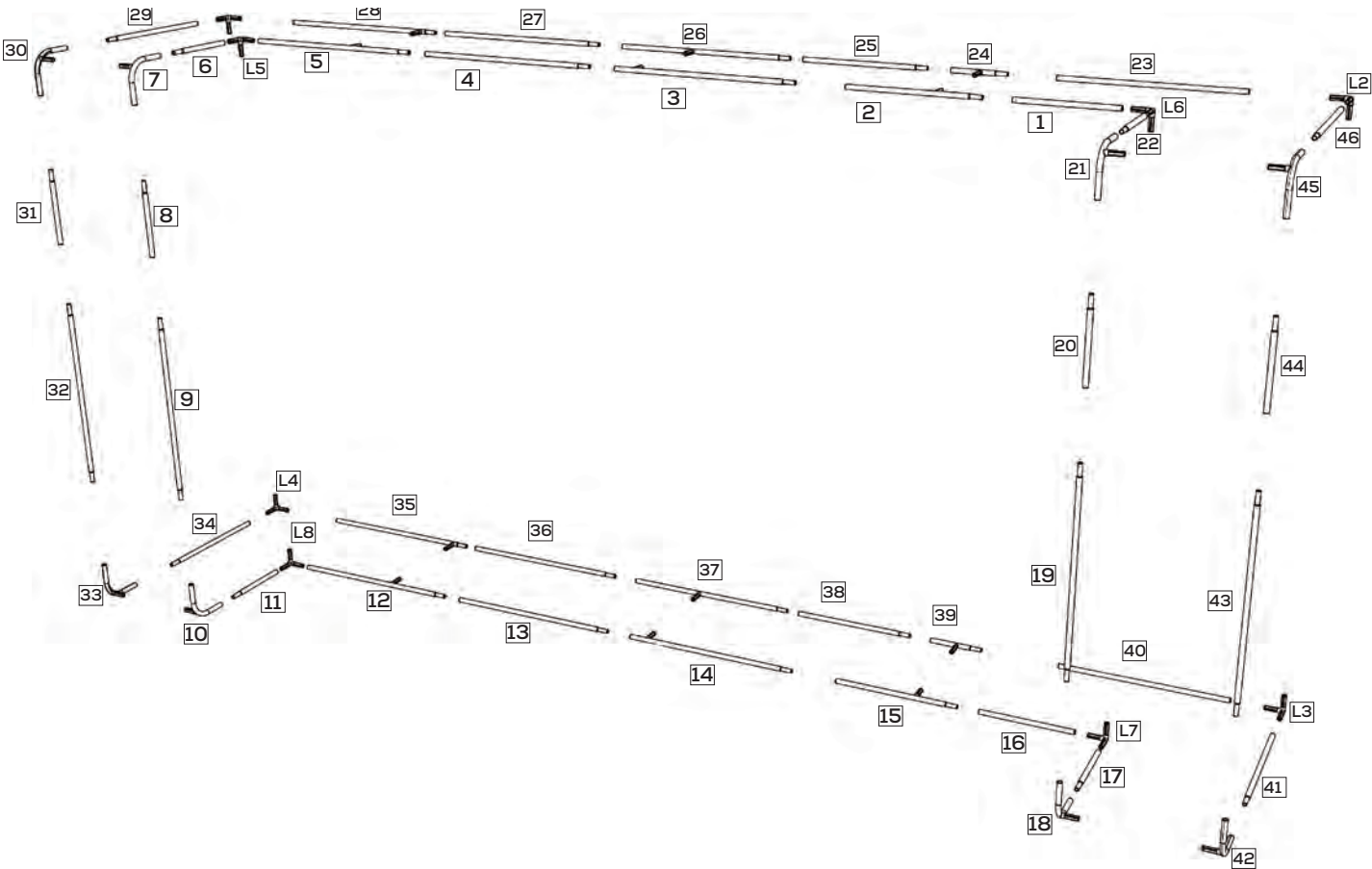

TEMPLATE GUIDE

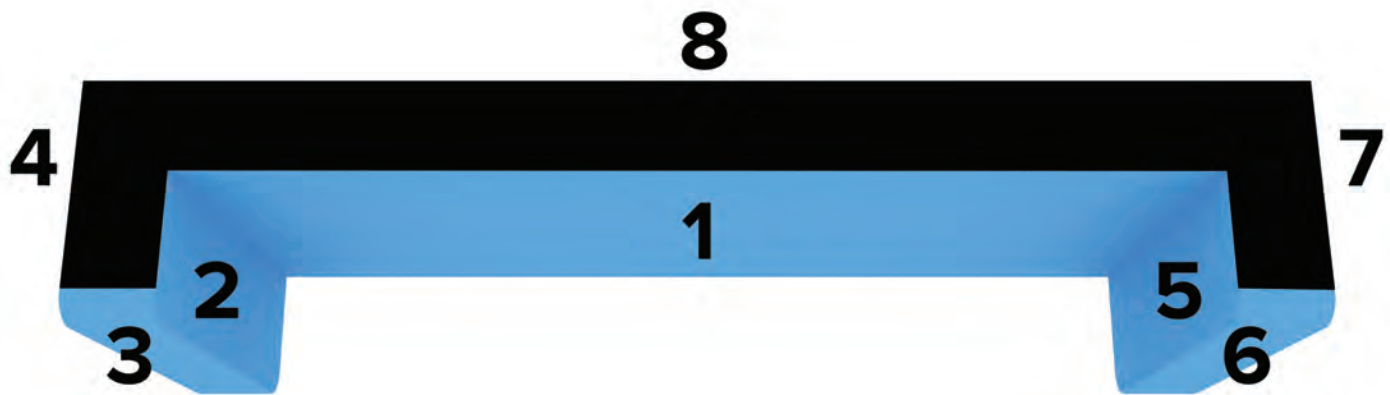

- 1. Main Panel Front
- 2. Left Storage Front
- 3. Left Storage End Cap
- 4. Left Storage Back

- 5. Right Storage Front
- 6. Right Storage End Cap
- 7. Right Storage Back
- 8. Main Panel Back

NUMBERS ON THE IMAGE ABOVE INDICATE THE TEMPLATE LOCATION # ON FRAME
PLEASE ADD TEMPLATE LOCATION # TO END OF FILENAME. EX: "WB-20-TS-1"
TOP AND BOTTOM PANELS WILL BE STOCK BLANK FABRIC