

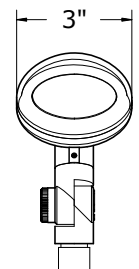

- MR11 or T3 bi-pin lamp (20W, 30° [FTD] MR11 and 20W T3 included)
- Solid die-cast brass luminaire
- Oval and round light distributions
- Sleek design with soft edges
- ½" NPS knuckle with ABS stake included for quick installation
- Large easy to adjust knuckle (can be tightened with a ¼" hex key)
- Potted knuckle to limit water and insect intrusion into luminaire
- Natural antique bronze patina finish (NAZ) standard
- Two oval reflectors included with the fixture for wide and medium wall washing
- Fixture can be mounted upright or upside down
- 12 volt UL 1838 listed luminaire is safe for wet locations up to 20W
- Fixed G4/GZ4 socket
- Shroud is lockable with hex key (included)
- 25' of 16 AWG SPT-2W cable and direct-bury wire connectors included
- Optional cast brass or powder coated cast aluminum stake
- Requires low voltage power supply, ordered separately

Solid Brass knuckle is easily adjustable and may be secured with a hex key. The knuckle is potted to limit moisture and insect intrusion.

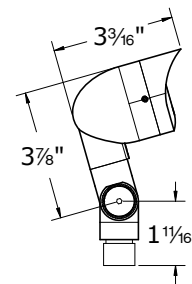

R-A3A



R-A3B

#### OPTIONAL PARTS

MODEL NO	DESCRIPTION
<b>R-A3A</b>	Aluminum Stake Powder Coat
<b>R-A3B</b>	Natural Solid Brass Stake

Model	Material	Lamp	Natural Finishes	Powder Coat
<b>R-F71</b>	<b>B</b> Solid Brass	MR11 or	<b>NAZ</b> <b>NAP</b>	<b>PAB</b> <b>PBZ</b>
		36° [BAB]	<b>NAR</b> <b>NAS</b>	<b>PDV</b> <b>POC</b>
		T3 Bin-Pin	<b>NOC</b> <b>UFB</b>	<b>PRI</b> <b>PSD</b>
		2000 hr, 20W T3	<b>NFC</b>	<b>PTB</b> <b>PWB</b>
				<b>PTW</b>

## R-F71B - NAZ

MODEL NO	MATERIAL	FINISH
	B=Brass	Natural Antique Bronze

\*We reserve the right to change specifications without notice.

## Natural Patinas

**Natural Antique Bronze (NAZ) is the Standard finish. Other Natural Patina finished and Powder Coat finishes are available for an extra charge.**

Troy Landscape Lighting Natural Patinas are chemically etched finishes available on Solid Brass and Solid Copper fixtures only. chemical etching accelerates the natural aging and weathering that copper and brass experience when used outdoors. These finishes will continue to develop and richen over time. They begin with an "N". Unfinished Brass and Unfinished Copper are just as described - unfinished. The metal will oxidize and darken with age.

## Powder Coat Finishes

Troy Landscape Lighting powder coat finish colors are available on all fixtures for an additional charge. The powder coat finish is baked on at 400° over a primer pre-coat for both chip and weather resistance. All powder coat finishes begin with a "P".

## Standard Finish on Solid Brass



### NAZ

Natural Antique Bronze

## Natural Patina Finishes on Solid Brass



### NAP

Natural Autumn Patina



### NAR

Natural Rust



### NAS

Natural Antique Brass



### NOC

Natural Old Copper



### UFB

Unfinished Brass

## Natural Patina Finishes on Solid Copper



### NOC

Natural Old Copper



### UFC

Unfinished Copper

**COPPER  
AVAILABLE ON  
LIMITED MODELS -  
SEE INDEX**

## Powder Coat Finishes All Metal Fixtures

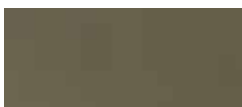

### PAB

Aged Bronze



### PBZ

Bronze



### PDV

Dark Verdi



### POC

Old Copper



### PRI

Rusty Iron



### PSD

Sand



### PTB

Textured Black



### PWB

Textured Weathered Brown

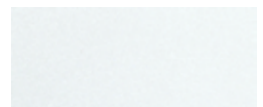

### PTW

Textured White

\*We reserve the right to change specifications without notice.