

NOTES:

- 2-person assembly

REQUIRED TOOLS:

- Phillips Head Screwdriver
- Adjustable Wrench

INCLUDED HARDWARE:

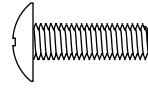

5/16" -18 x 1"
Truss Head Screws (x8)

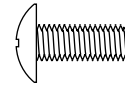

5/16" -18 x 3/4"
Truss Head Screws (x4) *twin*
(x6) *king/queen*

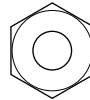

5/16" -18
Hex Nut (x6)

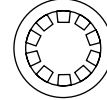

5/16"
Lock Washer (x6)

ASSEMBLY INSTRUCTIONS

1. Hold Headboard upright while attaching one side rail to the headboard using (2) 5/16" -18 x 1" Truss Head Screws and Phillips Head Screwdriver. Repeat on other side.
2. Attach Footboard using (2) 5/16" -18 x 1" Truss Head Screws and Phillips Head Screwdriver. Repeat on other side.

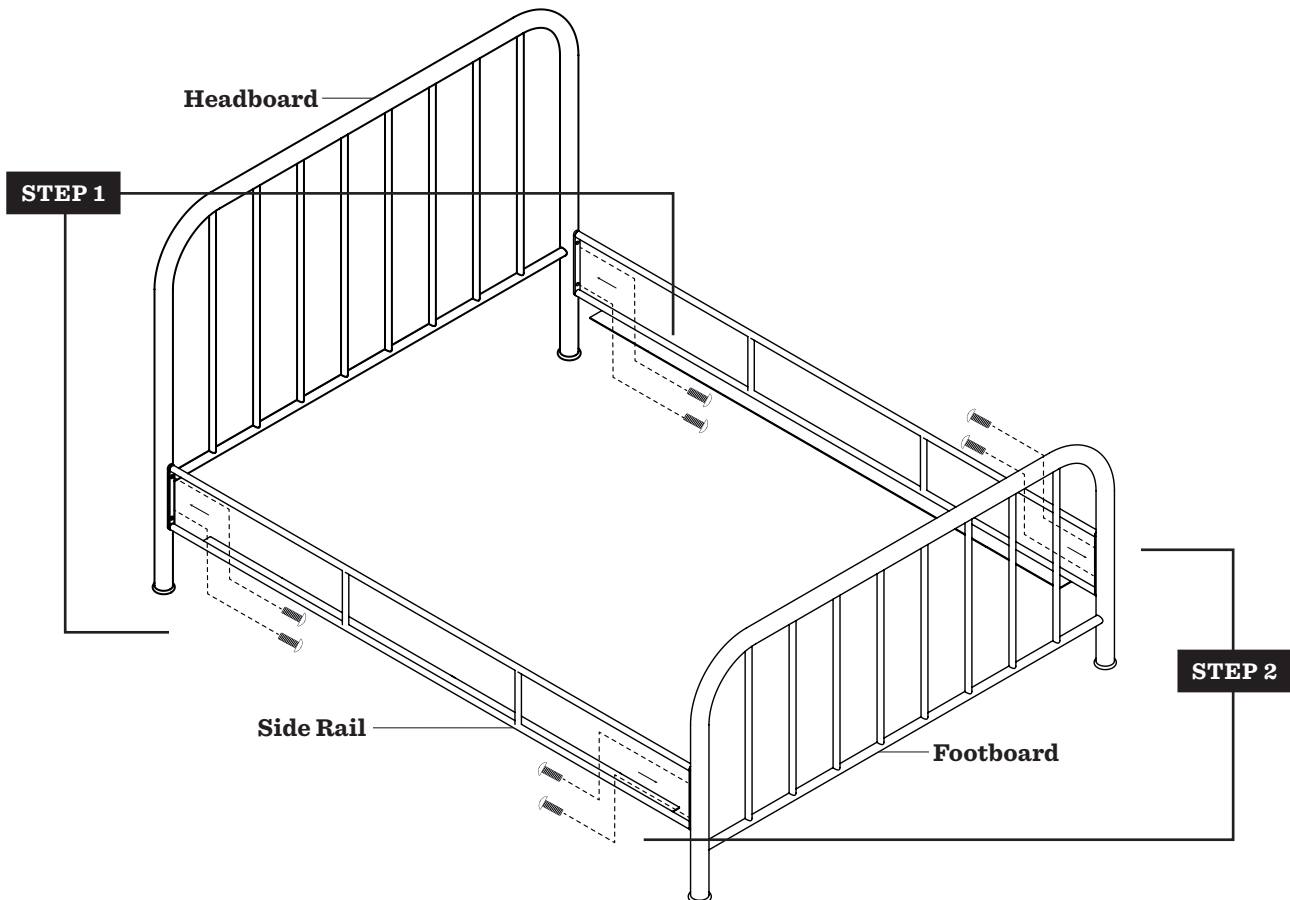

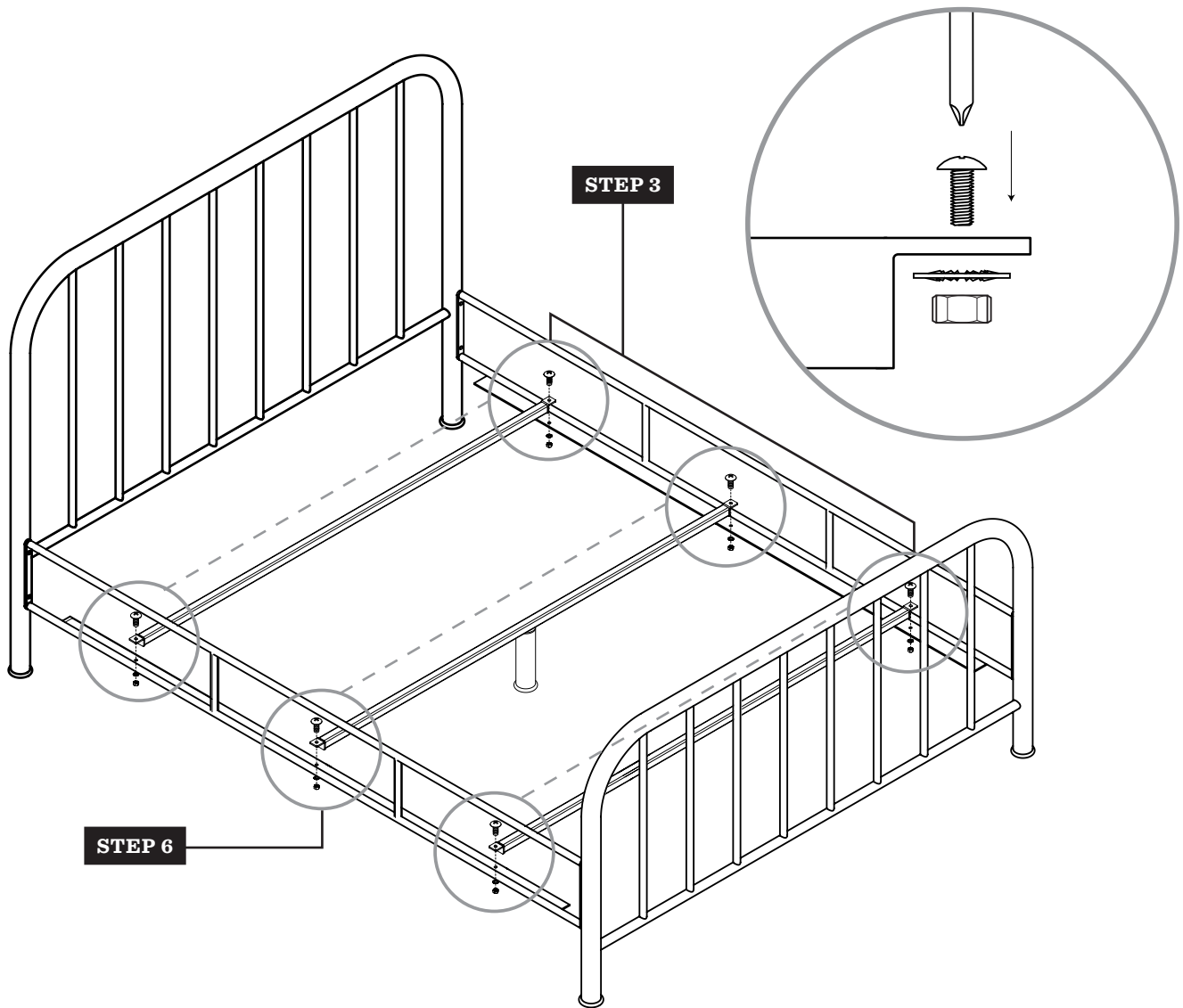

3. Attach 2 Support Bars using (4) $\frac{5}{16}$ "-18 x $\frac{3}{4}$ " Truss Head Screws, (4) $\frac{5}{16}$ "-18 Hex Nut, $\frac{5}{16}$ " Lock Washer, Phillips Head Screwdriver and Adjustable Wrench.

NOTE: For twin size, two spare Hex Nuts and Lock Washers included.

4. For Queen and King sizes proceed to step 5, for Twin sizes, skip to step 8.

5. Screw Support Leg into the center of remaining Support Bar. Do not fully tighten.

6. Place center Support Bar with Support Leg in the center of the bed frame and attach using (2) $\frac{5}{16}$ "-18 x $\frac{3}{4}$ " Truss Head Screw, (2) $\frac{5}{16}$ " x 18 Hex Nut, (2) $\frac{5}{16}$ " Lock Washer, Phillip Heads Screwdriver and Adjustable Wrench.

7. Unscrew Support Leg until it is secure against the floor.

8. Place box spring and mattress on frame and take a nap.

Support Leg

