

Test Coupling with Ball Check

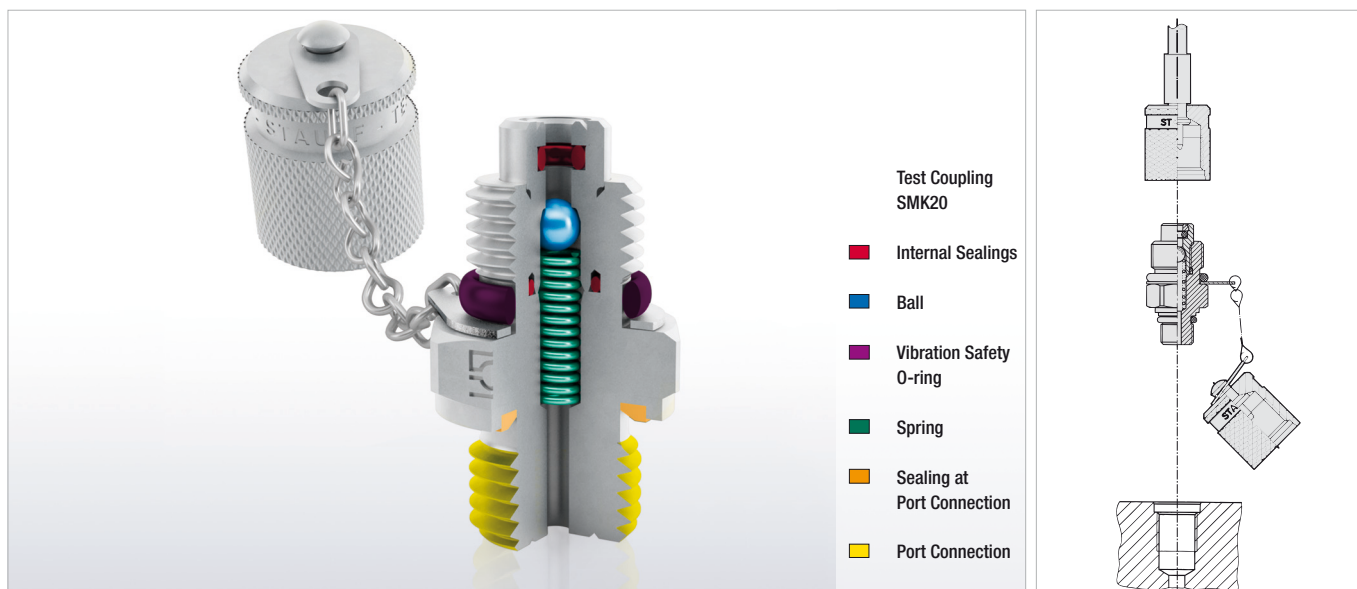

Fast Coupling for

- Monitoring and control of pressure
- Venting
- Sampling in high- and low-pressure systems

Advantages

- Test system at working pressure
- Leak proof connection before **ball check** is open
- Simple connection to measurement, control and switching devices
- Self locking metal protective cap

Working Pressure

- Max. working pressure 630 bar / 9137 PSI
For SMK Type G and K the recommended working pressure of fitting manufacturer should be noted.
- Connection under pressure up to 400 bar / 5801 PSI max.

Materials

- Metal Parts:**
Standard material: Steel, zinc/nickel-plated = **C6F (CrVI-free)**
Optional:
Stainless Steel **V2A** (1.4305 / AISI 303) on request
Stainless Steel **V4A** (1.4571 / AISI 316Ti) on request

For ordering "V2A" or "V4A" please replace "C6F" with "V2A" or "V4A".

- Ball:** Stainless Steel

Sealings:

P = NBR (Buna-N®)

(Temperature range -20 °C ... +100 °C / -4 °F ... +212 °F)

Note: Internal sealings made of FPM, even for standard NBR-type.

V = FPM (Viton®)*

(Temperature range -20 °C ... +200 °C / -4 °F ... +392 °F)

*** Standard option for North America is FPM (Viton®)**

E = EPDM Ethylene Propylene Diene Monomer Rubber

(for Brake fluid,

Temperature range -40 °C ... +150 °C / -40 °F ... +302 °F)

For ordering NBR or EPDM sealings please replace "V" with "P" or "E".

Vibration safety O-ring made of NBR (Buna-N®) (standard).

Media

- Suitable for hydraulic oils and other Mineral oil based fluids (Check compatibility of sealing material)
- For use with other liquid media please consult STAUFF

Protection Cap

- The complete STAUFF-Test-20-type-SMK range is also available with a hexagonal protection cap made of steel or plastic protection cap.

For ordering the hexagonal protection cap version please add "-SK" to the order code. (e.g. SMK20-M10x1-VA-SK-C6F)

For ordering the plastic protection cap version please add "-KK" to the order code. (e.g. SMK20-M10x1-VA-KK-C6F)

SMK20 Test Coupling with Port Connection	SMK20 Type G Test Coupling complete with Straight Fitting	SMK20 Type K Test Coupling for 24° Cone Fittings	SMK20-JIC Test Coupling SMK-JIC Connection (to SAE J514)	SSK20 Bulkhead

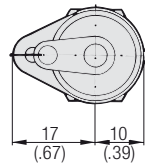
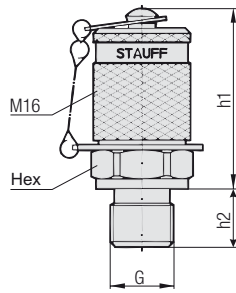

Test Coupling with Port Connection SMK20



Thread	Sealing	Working Pressure (bar/psi)	Dimensions (mm/in)			Order Codes	
			h1	h2	Hex	NBR	FPM* (Standard Option-North America)
M8 x 1	Type A	250	38	8,5	17	SMK20-M8x1-PA-C6F	SMK20-M8x1-VA-C6F
		3625	1.50	.33	.67		
M10 x 1	Type A	630	38	9,8	17	SMK20-M10x1-PA-C6F	SMK20-M10x1-VA-C6F
		9137	1.50	.39	.67		
M10 x 1	Type B	400	37	8	17	SMK20-M10x1-PB-C6F	SMK20-M10x1-VB-C6F
		5801	1.46	.31	.67		
M12 x 1,5	Type B	630	37	12	17	SMK20-M12x1,5-PB-C6F	SMK20-M12x1,5-VB-C6F
		9137	1.46	.47	.67		
M14 x 1,5	Type B	630	37	12	19	SMK20-M14x1,5-PB-C6F	SMK20-M14x1,5-VB-C6F
		9137	1.46	.47	.75		
M16 x 1,5	Type B	630	37	12	22	SMK20-M16x1,5-PB-C6F	SMK20-M16x1,5-VB-C6F
		9137	1.46	.47	.87		
G1/8	Type B	400	39	8	17	SMK20-G1/8-PB-C6F	SMK20-G1/8-VB-C6F
		5801	1.54	.31	.67		
G1/4	Type B	630	37	12	19	SMK20-G1/4-PB-C6F	SMK20-G1/4-VB-C6F
		9137	1.46	.47	.75		
G3/8	Type B	630	37	12	22	SMK20-G3/8-PB-C6F	SMK20-G3/8-VB-C6F
		9137	1.46	.47	.87		
M10 x 1	Type C	400	39	8	17	SMK20-M10x1-PC-C6F	SMK20-M10x1-VC-C6F
		5801	1.54	.31	.67		
M12 x 1,5	Type C	630	37	12	17	SMK20-M12x1,5-PC-C6F	SMK20-M12x1,5-VC-C6F
		9137	1.46	.47	.67		
M14 x 1,5	Type C	630	37	12	19	SMK20-M14x1,5-PC-C6F	SMK20-M14x1,5-VC-C6F
		9137	1.46	.47	.75		
M16 x 1,5	Type C	630	37	12	22	SMK20-M16x1,5-PC-C6F	SMK20-M16x1,5-VC-C6F
		9137	1.46	.47	.87		
G1/8	Type C	400	39	8	17	SMK20-G1/8-PC-C6F	SMK20-G1/8-VC-C6F
		5801	1.54	.31	.67		
G1/4	Type C	630	37	12	19	SMK20-G1/4-PC-C6F	SMK20-G1/4-VC-C6F
		9137	1.46	.47	.75		
G3/8	Type C	630	37	12	22	SMK20-G3/8-PC-C6F	SMK20-G3/8-VC-C6F
		9137	1.46	.47	.87		
G1/2	Type C	630	39	14	27	SMK20-G1/2-PC-C6F	SMK20-G1/2-VC-C6F
		9137	1.54	.55	1.06		
R1/8 K	Type D	400	37	8	17	SMK20-R1/8K-PD-C6F	SMK20-R1/8K-VD-C6F
		5801	1.46	.31	.67		
R1/4 K	Type D	630	35	12	17	SMK20-R1/4K-PD-C6F	SMK20-R1/4K-VD-C6F
		9137	1.38	.47	.67		
1/8 NPT	Type D	400	36	10	17	SMK20-1/8NPT-PD-C6F	SMK20-1/8NPT-VD-C6F
		5801	1.42	.39	.67		
1/4 NPT	Type D	630	35	15	17	SMK20-1/4NPT-PD-C6F	SMK20-1/4NPT-VD-C6F
		9137	1.38	.59	.67		
5/16-24 UNF	Type E	400	38	7,5	17	SMK20-5/16UNF-PE-C6F	SMK20-5/16UNF-VE-C6F
		5.801	1.50	.30	.67		
7/16-20 UNF	Type E	630	38	9,1	17	SMK20-7/16UNF-PE-C6F	SMK20-7/16UNF-VE-C6F
		9137	1.50	.36	.67		
1/2-20 UNF	Type E	630	38	9,2	17	SMK20-1/2UNF-PE-C6F	SMK20-1/2UNF-VE-C6F
		9137	1.50	.36	.67		
9/16-18 UNF	Type E	630	37	10	19	SMK20-9/16UNF-PE-C6F	SMK20-9/16UNF-VE-C6F
		9137	1.46	.39	.75		
3/4-16 UNF	Type E	630	37	11,1	19	SMK20-3/4UNF-PE-C6F	SMK20-3/4UNF-VE-C6F
		9137	1.46	.44	.75		
M10 x 1	Type E	630	38	9,5	17	SMK20-M10x1-PE-C6F	SMK20-M10x1-VE-C6F
		9137	1.50	.37	.67		
M12 x 1,5	Type E	630	37	11	17	SMK20-M12x1,5-PE-C6F	SMK20-M12x1,5-VE-C6F
		9137	1.46	.43	.67		
M14 x 1,5	Type E	630	38	11	19	SMK20-M14x1,5-PE-C6F	SMK20-M14x1,5-VE-C6F
		9137	1.50	.43	.75		

Metal Parts

Standard material: Steel, zinc/nickel-plated = **C6F (CrVI-free)**
 For ordering V2A (1.4305 / AISI 303) replace "C6F" with "V2A".
 For ordering V4A (1.4571 / AISI 316Ti) replace "C6F" with "V4A".

Sealings

For ordering NBR sealings replace "V" with "P".
 For ordering EPDM sealings replace "V" with "E".

* Standard option for North America is FPM (Viton®).

Sealing Details

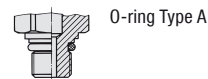

O-ring Type A



Metal Joint Type B

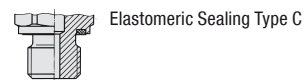

Elastomeric Sealing Type C

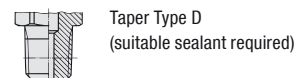

Taper Type D
(suitable sealant required)

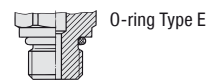

O-ring Type E

Protection Cap

Standard material: Steel
 For ordering the hexagonal protection cap version please add "-SK" to the order code. (e.g. SMK20-M10x1-VA-SK-C6F)
 For ordering the plastic protection cap version please add "-KK" to the order code. (e.g. SMK20-M10x1-VA-KK-C6F)

For further information on materials, sealings or protection caps, please see page B4.

Other port connections and sealings on request.
 Please consult STAUFF for further information.