

Straight Reducer with 24° Taper / O-Ring (DKO) Type FI-SNV ▪ Series L

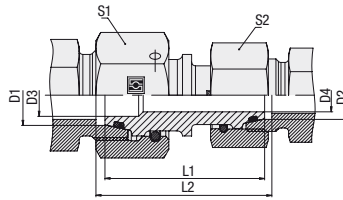

Series	Tube OD [mm]		PN [bar]	Dimensions [mm]					Weight [kg] ca. per 100	Ordering Codes Fitting body only	
	D1	D2		D3	D4	L1	L2	S1			S2
L	8 L	6 L	500	3	3	34	36	17	14	4,1	FI-SNV-08/06L-B-W3-DKO
	10 L	6 L	500	3	3	35	36,5	19	14	4,8	FI-SNV-10/06L-B-W3-DKO
	10 L	8 L	500	5	5	35	36,5	19	17	5,6	FI-SNV-10/08L-B-W3-DKO
	12 L	6 L	400	3	3	35	36,5	22	14	6,1	FI-SNV-12/06L-B-W3-DKO
	12 L	8 L	400	5	5	36	37,5	22	17	6,8	FI-SNV-12/08L-B-W3-DKO
	12 L	10 L	400	6,5	6,5	36,5	37,5	22	19	7,4	FI-SNV-12/10L-B-W3-DKO
	12 L	12 S	400	8	8	39	40,5	22	24	9,8	FI-SNV-12L/12S-B-W3-DKO
	15 L	8 L	400	5	5	36,5	38	27	17	9,4	FI-SNV-15/08L-B-W3-DKO
	15 L	10 L	400	6,5	6,5	37,5	38,5	27	19	10,1	FI-SNV-15/10L-B-W3-DKO
	15 L	12 L	400	8	8	44	45	27	22	12,3	FI-SNV-15/12L-B-W3-DKO
	18 L	10 L	400	6,5	6,5	38	39,5	32	19	12,8	FI-SNV-18/10L-B-W3-DKO
	18 L	12 L	400	8	8	38	39,5	32	22	13,8	FI-SNV-18/12L-B-W3-DKO
	18 L	15 L	400	11	11	45	46,5	32	27	17,4	FI-SNV-18/15L-B-W3-DKO
	18 L	16 S	400	11	11	43,5	46	32	30	19,1	FI-SNV-18L/16S-B-W3-DKO
	22 L	12L	250	8	8	40,5	42	36	22	18,7	FI-SNV-22/12L-B-W3-DKO
	22 L	15 L	250	11	11	42	43,5	36	27	20,9	FI-SNV-22/15L-B-W3-DKO
	22 L	18 L	250	13	13	45	47	36	32	24,5	FI-SNV-22/18L-B-W3-DKO
	22 L	20 S	250	14	14	50	53	36	36	29,4	FI-SNV-22L/20S-B-W3-DKO
	28 L	15 L	250	11	11	43	44,5	41	27	33,7	FI-SNV-28/15L-B-W3-DKO
	28 L	18 L	250	13	13	45	47	41	32	38,3	FI-SNV-28/18L-B-W3-DKO
	28 L	22 L	250	17	17	46	48	41	36	45,4	FI-SNV-28/22L-B-W3-DKO
	28 L	25 S	250	18	18	52,5	57	41	46	51,6	FI-SNV-28L/25S-B-W3-DKO
	35 L	18 L	250	13	13	48	51,5	50	32	39,6	FI-SNV-35/18L-B-W3-DKO
	35 L	22 L	250	17	17	49,5	53	50	36	41,9	FI-SNV-35/22L-B-W3-DKO
	35 L	28 L	250	23	23	50	53,5	50	41	48,7	FI-SNV-35/28L-B-W3-DKO
	35 L	30 S	250	22	22	61	68	50	50	63,7	FI-SNV-35L/30S-B-W3-DKO
	42 L	22 L	250	17	17	49,5	53,5	60	36	57,2	FI-SNV-42/22L-B-W3-DKO
	42 L	28 L	250	23	23	50	54	60	41	63,9	FI-SNV-42/28L-B-W3-DKO
	42 L	35 L	250	28	28	53	58,5	60	50	65,5	FI-SNV-42/35L-B-W3-DKO
	42 L	38 S	250	30	30	55	65	60	60	84,0	FI-SNV-42L/38S-B-W3-DKO

Standard seal material is NBR (Buna-N®).



Please make sure to follow the assembly instructions for this product as described on page G13.

Straight Reducer with 24° Taper / O-Ring (DKO) Type FI-SNV • Series S

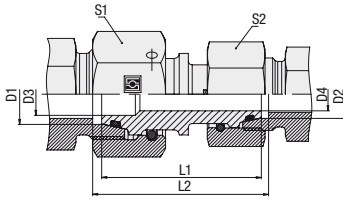

Series	Tube OD [mm]		PN [bar]	Dimensions [mm]					Weight [kg] ca. per 100	Ordering Codes Fitting body only	
	D1	D2		D3	D4	L1	L2	S1			S2
S	6S	6L	500	3	3	35,5	37	17	14	4,1	FI-SNV-06S/06L-B-W3-DKO
	8 S	6 S	800	3	3	37	39	19	17	4,9	FI-SNV-08S/06S-B-W3-DKO
	8 S	8 L	500	4	4	35,5	36,5	17	19	4,8	FI-SNV-08S/08L-B-W3-DKO
	10 S	6 S	800	3	3	40,5	42,5	22	17	6,0	FI-SNV-10S/06S-B-W3-DKO
	10 S	8 S	800	4	4	39	41	22	19	6,6	FI-SNV-10/08S-B-W3-DKO
	10 S	10 L	500	6	6	38,5	40	19	22	7,5	FI-SNV-10S/10L-B-W3-DKO
	12 S	6 S	630	3	3	39	43	24	17	8,1	FI-SNV-12/06S-B-W3-DKO
	12 S	8 S	630	4	4	44	46	24	19	10,0	FI-SNV-12/08S-B-W3-DKO
	12 S	10 S	630	6,5	6,5	41,5	43,5	24	22	8,9	FI-SNV-12/10S-B-W3-DKO
	16 S	10 S	630	6,5	6,5	43,5	46,5	30	22	13,6	FI-SNV-16/10S-B-W3-DKO
	16 S	12 S	630	8	8	47,5	50,5	30	24	16,2	FI-SNV-16/12S-B-W3-DKO
	16 S	15 L	400	11	11	42,5	45	30	27	15,7	FI-SNV-16S/15L-B-W3-DKO
	20 S	12 S	400	8	8	48,5	52	36	24	21,4	FI-SNV-20/12S-B-W3-DKO
	20 S	16 S	400	11	11	52,5	57	36	30	26,2	FI-SNV-20/16S-B-W3-DKO
	20 S	18 L	400	13	13	47,5	50,5	36	32	24,7	FI-SNV-20S/18L-B-W3-DKO
	25 S	16 S	400	11	11	52	58	46	30	38,9	FI-SNV-25/16S-B-W3-DKO
	25 S	20 S	400	14	14	58	64,5	46	36	44,4	FI-SNV-25/20S-B-W3-DKO
	25 S	22 L	250	17	17	57	61,5	46	36	41,4	FI-SNV-25S/22L-B-W3-DKO
	30 S	16 S	400	11	11	54	61,5	50	30	47,5	FI-SNV-30/16S-B-W3-DKO
	30 S	20 S	400	14	14	58,5	66,5	50	36	43,9	FI-SNV-30/20S-B-W3-DKO
	30 S	25 S	400	17	17	60	69,5	50	46	60,8	FI-SNV-30/25S-B-W3-DKO
	30 S	28 L	250	22	22	59	65	50	46	55,8	FI-SNV-30S/28L-B-W3-DKO
	38 S	20 S	400	14	14	61	71,5	60	36	67,1	FI-SNV-38/20S-B-W3-DKO
	38 S	25 S	400	17	17	62,5	74,5	60	46	75,2	FI-SNV-38/25S-B-W3-DKO
38 S	30 S	400	22	22	64,5	78	60	50	87,5	FI-SNV-38/30S-B-W3-DKO	
38 S	35 L	250	28	28	62	71,5	60	50	74,4	FI-SNV-38S/35L-B-W3-DKO	

Standard seal material is NBR (Buna-N®).



Please make sure to follow the assembly instructions for this product as described on page G13.