

Safety Locking Plate

(for Use with Stacking Bolt AF) Type SIG

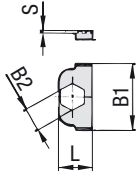

STAUFF Group 1

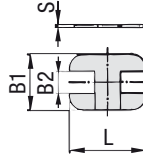

STAUFF Group 1A to 8

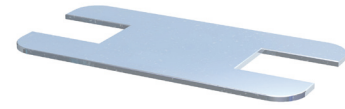

Group	STAUFF	DIN	Dimensions (mm/in)				Order Codes (Standard Options)
			L	B1	B2	S	
1	0		16	32	11,2	1	SIG 1 W3
			0.63	1.26	.44	.04	
1A	1		33	28	11,2	1	SIG 1A W3
			1.30	1.10	.44	.04	
2	2		39	28	11,2	1	SIG 2 W3
			1.54	1.10	.44	.04	
3	3		47	28	11,2	1	SIG 3 W3
			1.85	1.10	.44	.04	
4	4		56	28	11,2	1	SIG 4 W3
			2.20	1.10	.44	.04	
5	5		69	28	11,2	1	SIG 5 W3
			2.72	1.10	.44	.04	
6	6		85	28	11,2	1	SIG 6 W3
			3.35	1.10	.44	.04	
7	7		117	28	11,2	1	SIG 7 W3
			4.61	1.10	.44	.04	
8	8		143	28	11,2	1	SIG 8 W3
			5.63	1.10	.44	.04	

Alternative materials and surface finishings are available upon request. Consult STAUFF for further information.

Order Codes

Safety Locking Plate

***SIG*1*W3**

* Safety Locking Plate		SIG
* STAUFF Group		1
* Material code	Carbon Steel, zinc/nickel-plated	W3
	Stainless Steel V2A	W4
	1.4301 / 1.4305 (AISI 304 / 303)	
	Stainless Steel V4A	W5
	1.4401 / 1.4571 (AISI 316 / 316 Ti)	

Stacking Bolt

(for Use with Safety Locking Plate SIG) Type AF

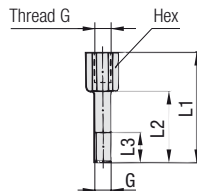

Group	STAUFF	DIN	Dimensions (mm/in)					Order Codes (Standard Options)
			Thread G	L1	L2	L3 min.	Hex	
1	0		M6	34	20	12	11	AF 1/1A/1D M W3
			1/4-20 UNC	1.34	.79	.47	.43	
1A	1		M6	34	20	12	11	AF 1/1A/1D M W3
			1/4-20 UNC	1.34	.79	.47	.43	
2	2		M6	40	25	12	11	AF 2 M W3
			1/4-20 UNC	1.57	.98	.47	.43	
3	3		M6	44	30	12	11	AF 3 M W3
			1/4-20 UNC	1.73	1.18	.47	.43	
4	4		M6	49	35	12	11	AF 4 M W3
			1/4-20 UNC	1.93	1.38	.47	.43	
5	5		M6	64	50	12	11	AF 5 M W3
			1/4-20 UNC	2.52	1.97	.47	.43	
6	6		M6	74	60	12	11	AF 6 M W3
			1/4-20 UNC	2.91	2.36	.47	.43	
7	7		M6	99	85	12	11	AF 7 M W3
			1/4-20 UNC	3.90	3.35	.47	.43	
8	8		M6	124	110	12	11	AF 8 M W3
			1/4-20 UNC	4.88	4.33	.47	.43	

Stacking Bolts, type AF 1/1A/1D are also suitable for Twin Series, STAUFF Group 1D.

All threaded parts are available with Metric ISO thread or unified coarse (UNC) thread according to dimension table. Alternative materials and surface finishings are available upon request. Consult STAUFF for further information.

Order Codes

Stacking Bolt

***AF*2*U*W3**

* Type of bolt	Stacking Bolt (according to STAUFF Standard)	AF
* STAUFF Group		2
* Thread code	Unified coarse (UNC) thread	U
	Metric ISO thread	M
* Material code	Carbon Steel, zinc/nickel-plated	W3
	Stainless Steel V2A	W4
	1.4301 / 1.4305 (AISI 304 / 303)	
	Stainless Steel V4A	W5
	1.4401 / 1.4571 (AISI 316 / 316 Ti)	