

Reservoir End Covers - Type EC

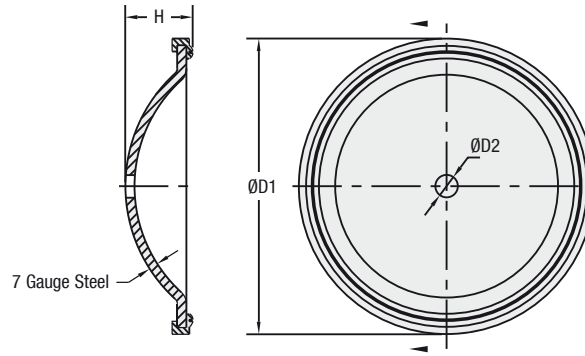

Characteristics

Materials

- End cover made of 7 Grade Steel (pickled and oiled); Stainless Steel available on request
- Double lip gasket (one-piece, molded) made of NBR (Buna-N®)
- Crush washer made of Polyamide (PA)

Options

- 3/4" drain hole (not for EC-6 and EC-16)
- Back mounting brackets (included for EC-6)
- Baffle adaptors
- Seal kits (double lip gasket and crush washer)

Special sizes, designs, materials and configurations are available on request. Consult STAUFF for details.

Dimensions and Order Codes

Order Code	Dimensions (mm/in)		Weight (kg/lbs)			
	w/o Drain Hole	with Drain Hole		Seal Kit		
EC - 6			146	11,1	33	1,2
			5.75	.44	1.31	2.5
EC - 10	EC - 10D	EC - 10 - SK	254	17,4	44,5	2,1
			10.00	.69	1.75	4.5
EC - 12	EC - 12D	EC - 12 - SK	308	17,4	44,5	3,0
			12.13	.69	1.75	6.5
EC - 14	EC - 14D	EC - 14 - SK	359	17,4	44,5	3,9
			14.13	.69	1.75	8.5
EC - 16		EC - 16 - SK	410	17,4	44,5	4,8
			16.15	.69	1.75	10.5
EC - 18	EC - 18D	EC - 18 - SK	460	17,4	51	6,2
			18.11	.69	1.75	13.5