

Metal Sight Glasses - Type SLW

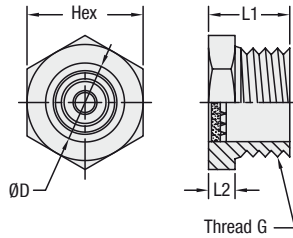

Dimensions

Order Code	Thread G	Dimensions (mm/in)				Max. Operating Pressure (bar/PSI)
		ØD	L1	L2	Hex	
SLW - 04	1/4-18 NPT	8,6 .34	16,0 .63	4,8 .19	16,0 .63	275 4000
SLW - 06	3/8-18 NPT	11,2 .44	18,3 .72	5,6 .32	19,1 .75	250 3700
SLW - 08	1/2-14 NPT	14,2 .56	19,8 .78	5,6 .32	23,9 .94	240 3500
SLW - 12	3/4-14 NPT	19,1 .75	23,9 .94	8,1 .32	26,9 1,06	200 3000
SLW - 16	1-11-1/2 NPT	23,9 .94	31,8 1,25	8,1 .32	35,1 1,38	170 2500
SLW - 20	1-1/4-11-1/2 NPT	30,5 .120	31,0 1,22	10,4 .41	44,5 1,75	138 2000
SLW - 24	1-1/2-11-1/2 NPT	36,6 1,44	31,0 1,22	10,4 .41	50,8 2,00	100 1500
SLW - 32	2-11-1/2 NPT	47,8 1,88	32,5 1,28	10,4 .41	63,5 2,50	70 1000

Characteristics

Visual fluid level indication in hydraulic reservoirs

Nominal Sizes and Designs

- Thread sizes from 1/4-18 NPT to 2-11-1/2 NPT
- SAE thread available on request

Materials

- Housings made of Steel, electroless nickel plated
- Hermetically sealed prism lenses made of Glass

Consult STAUFF for alternative materials.

Technical Data

- Max. operating temperature: +260 °C / +500 °F

Plastic Sight Glasses - Type OLG

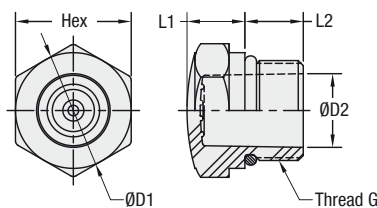

Dimensions

Order Code	Thread G	Dimensions (mm/in)				
		ØD1	ØD2	L1	L2	Hex
OLG - U08 - P - P	3/4-16 UNF	22 .90	14 .55	8 .31	11 .43	22,0 .90
OLG - U12 - P - P	1-1/16-12 UNF	32 1,26	20 .79	11,9 .47	15,1 .59	32 1,26
OLG - U16 - P - P	1-5/16-12 UNF	41 1,61	25 .98	12,9 .51	15,1 .59	41 1,61
OLG - U20 - P - P	1-5/8-12 UNF	50 1,97	30 1,18	15,9 .63	15,1 .59	50 1,97

Characteristics

Visual fluid level indication in hydraulic reservoirs

Nominal Sizes and Designs

- Thread sizes from 3/4-16 UNF to 1-5/8-12 UNF
- SAE thread available on request

Materials

- Housings made of Polyamide (TR-90-UV)
- Sealings made of NBR (Buna-N®)

Consult STAUFF for alternative materials.

Technical Data

- Operating temp. range: -30 °C ... +90 °C / -22 °F ... +194 °F