

Equal Elbow Type FI-W ▪ Series LL / L / S

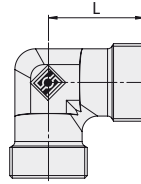
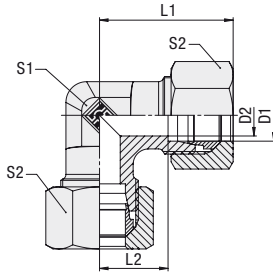

Series	Tube OD [mm] D1	PN [bar]	Dimensions [mm]						Weight [kg] ca. per 100 ²	Ordering Codes	
			D2	L	L ¹	L ₂	S1	S2		Fitting body supplied with cutting rings & union nuts	Fitting body only
LL	4	100	3	15	21	11	9	10	1,8	FI-W-04LL-W3-MS	FI-W-04LL-W3
	6	100	4,5	15	21	9,5	9	12	2,3	FI-W-06LL-W3-MS	FI-W-06LL-W3
	8	100	6	17	23	11,5	12	14	3,2	FI-W-08LL-W3-MS	FI-W-08LL-W3
L	6	500	4	19	27	12	12	14	4,5	FI-W-06L-W3-MS	FI-W-06L-W3
	8	500	6	21	29	14	12	17	6,1	FI-W-08L-W3-MS	FI-W-08L-W3
	10	500	8	22	30	15	14	19	7,6	FI-W-10L-W3-MS	FI-W-10L-W3
	12	400	10	24	32	17	17	22	10,5	FI-W-12L-W3-MS	FI-W-12L-W3
	15	400	12	28	36	21	19	27	17,6	FI-W-15L-W3-MS	FI-W-15L-W3
	18	400	15	31	40	23,5	24	32	25,9	FI-W-18L-W3-MS	FI-W-18L-W3
	22	250	19	35	44	27,5	27	36	34,4	FI-W-22L-W3-MS	FI-W-22L-W3
	28	250	24	38	47	30,5	36	41	58,4	FI-W-28L-W3-MS	FI-W-28L-W3
	35	250	30	45	56	34,5	41	50	87,3	FI-W-35L-W3-MS	FI-W-35L-W3
	42	250	36	51	63	40	50	60	115,2	FI-W-42L-W3-MS	FI-W-42L-W3
S	6	800	4	23	31	16	12	17	7,6	FI-W-06S-W3-MS	FI-W-06S-W3
	8	800	5	24	32	17	14	19	9,6	FI-W-08S-W3-MS	FI-W-08S-W3
	10	800	7	25	34	17,5	17	22	13,2	FI-W-10S-W3-MS	FI-W-10S-W3
	12	630	8	29	38	21,5	17	24	16,3	FI-W-12S-W3-MS	FI-W-12S-W3
	14	630	10	30	40	22	19	27	23,9	FI-W-14S-W3-MS	FI-W-14S-W3
	16	630	12	33	43	24,5	24	30	30,5	FI-W-16S-W3-MS	FI-W-16S-W3
	20	400	16	37	48	26,5	27	36	46,1	FI-W-20S-W3-MS	FI-W-20S-W3
	25	400	20	42	54	30	36	46	82,7	FI-W-25S-W3-MS	FI-W-25S-W3
	30	400	25	49	62	35,5	41	50	107,5	FI-W-30S-W3-MS	FI-W-30S-W3
	38	400	32	57	72	41	50	60	161,4	FI-W-38S-W3-MS	FI-W-38S-W3

¹ Approximate dimension with union nuts tightened.

² Weight including cutting rings and union nuts.



Also available from STAUFF, your single source manufacturer and supplier of pipework equipment and hydraulic components:
Multi-Way Block Body Ball Valves LBV/TBV/XBV for in-line assembly to shut off fluid media in industrial and mobile hydraulics