

## Straight Male Stud Fitting

### Type FI-GE-...-M-WD • Series L

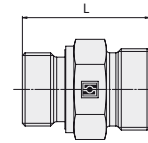
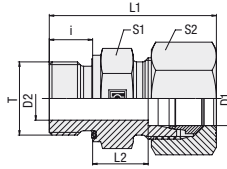

Metric Parallel Thread

Profile Sealing Ring

Series	Tube OD [mm]	PN [bar]	Dimensions [mm]										Torque [N-m] ca.	Weight [kg] ca. per 100 <sup>2</sup>	Ordering Codes	
			Thread T	D2	i	L	L <sup>1</sup>	L2	S1	S2	Thread T	Fitting body supplied with cutting ring & union nut			Fitting body only	
L	6	500	M 10 x 1	4	8	23,5	31,5	8,5	14	14	18	2,7	FI-GE-06LM-WD-B-W3-MS	FI-GE-06LM-WD-B-W3		
	6	500	M 12 x 1,5	4	12	29	37	10	17	14	25	3,7	FI-GE-06LM12x1.5-WD-B-W3-MS	FI-GE-06LM12x1.5-WD-B-W3		
	8	500	M 10 x 1	4	8	23,5	31,5	8,5	14	17	18	3,4	FI-GE-08LM10x1-WD-B-W3-MS	FI-GE-08LM10x1-WD-B-W3		
	8	500	M 12 x 1,5	6	12	29	37	10	17	17	25	4,2	FI-GE-08LM-WD-B-W3-MS	FI-GE-08LM-WD-B-W3		
	8	500	M 14 x 1,5	6	12	29	37	10	19	17	45	4,8	FI-GE-08LM14x1.5-WD-B-W3-MS	FI-GE-08LM14x1.5-WD-B-W3		
	8	400	M 16 x 1,5	6	12	30	38	11	22	17	55	6,1	FI-GE-08LM16x1.5-WD-B-W3-MS	FI-GE-08LM16x1.5-WD-B-W3		
	10	400	M 12 x 1,5	6	12	30	38	11	17	19	25	4,9	FI-GE-10LM12x1.5-WD-B-W3-MS	FI-GE-10LM12x1.5-WD-B-W3		
	10	400	M 14 x 1,5	7	12	30	38	11	19	19	45	5,4	FI-GE-10LM-WD-B-W3-MS	FI-GE-10LM-WD-B-W3		
	10	400	M 16 x 1,5	8	12	31,5	39,5	12,5	22	19	55	6,5	FI-GE-10LM16x1.5-WD-B-W3-MS	FI-GE-10LM16x1.5-WD-B-W3		
	10	400	M 18 x 1,5	8	12	31,5	39,5	12,5	24	19	70	7,5	FI-GE-10LM18x1.5-WD-B-W3-MS	FI-GE-10LM18x1.5-WD-B-W3		
	10	400	M 22 x 1,5	8	14	34	42	13	27	19	125	8,8	FI-GE-10LM22x1.5-WD-B-W3-MS	FI-GE-10LM22x1.5-WD-B-W3		
	12	400	M 12 x 1,5	4	12	32	40	11	19	22	25	6,1	FI-GE-12LM12x1.5-WD-B-W3-MS	FI-GE-12LM12x1.5-WD-B-W3		
	12	400	M 14 x 1,5	7	12	30	38	11	19	22	45	6,4	FI-GE-12LM14x1.5-WD-B-W3-MS	FI-GE-12LM14x1.5-WD-B-W3		
	12	400	M 16 x 1,5	9	12	31,5	39,5	12,5	22	22	55	7,3	FI-GE-12LM-WD-B-W3-MS	FI-GE-12LM-WD-B-W3		
	12	400	M 18 x 1,5	10	12	31,5	39,5	12,5	24	22	70	7,9	FI-GE-12LM18x1.5-WD-B-W3-MS	FI-GE-12LM18x1.5-WD-B-W3		
	12	400	M 22 x 1,5	10	14	34	42	13	27	22	125	9,7	FI-GE-12LM22x1.5-WD-B-W3-MS	FI-GE-12LM22x1.5-WD-B-W3		
	15	400	M 16 x 1,5	9	12	32,5	40,5	13,5	24	27	55	10,3	FI-GE-15LM16x1.5-WD-B-W3-MS	FI-GE-15LM16x1.5-WD-B-W3		
	15	400	M 18 x 1,5	11	12	32,5	40,5	13,5	24	27	70	10,3	FI-GE-15LM-WD-B-W3-MS	FI-GE-15LM-WD-B-W3		
	15	400	M 22 x 1,5	12	14	35	43	14	27	27	125	12,5	FI-GE-15LM22x1.5-WD-B-W3-MS	FI-GE-15LM22x1.5-WD-B-W3		
	18	400	M 18 x 1,5	11	12	33,5	42,5	14	27	32	90	13,7	FI-GE-18LM18x1.5-WD-B-W3-MS	FI-GE-18LM18x1.5-WD-B-W3		
	18	400	M 22 x 1,5	14	14	36	45	14,5	27	32	125	15,0	FI-GE-18LM-WD-B-W3-MS	FI-GE-18LM-WD-B-W3		
	22	250	M 22 x 1,5	14	14	38	47	16,5	32	36	125	19,1	FI-GE-22LM22x1.5-WD-B-W3-MS	FI-GE-22LM22x1.5-WD-B-W3		
	22	250	M 26 x 1,5	18	16	40	49	16,5	32	36	180	20,3	FI-GE-22LM-WD-B-W3-MS	FI-GE-22LM-WD-B-W3		
	28	250	M 33 x 2	23	18	43	52	17,5	41	41	310	33,7	FI-GE-28LM-WD-B-W3-MS	FI-GE-28LM-WD-B-W3		
35	250	M 42 x 2	30	20	48	59	17,5	50	50	450	52,2	FI-GE-35LM-WD-B-W3-MS	FI-GE-35LM-WD-B-W3			
42	250	M 48 x 2	36	22	52	64	19	55	60	540	62,9	FI-GE-42LM-WD-B-W3-MS	FI-GE-42LM-WD-B-W3			

<sup>1</sup> Approximate dimension with nut tightened.

Male stud according to ISO 9974-2 (Type E)

<sup>2</sup> Weight including cutting ring and union nut.

Port according to ISO 9974-1

Standard seal material is NBR (Buna-N®).

Torque recommendations for Steel mating material.



Also available from STAUFF, your single source manufacturer and supplier of pipework equipment and hydraulic components:  
**Analogue Flow Indicators SDM / SDMCR** for in-line assembly to determine flow rates, temperatures and operating pressures