

Gauge Isolator Valve ■ Type SWS-S1 (Single Station)

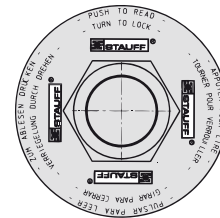
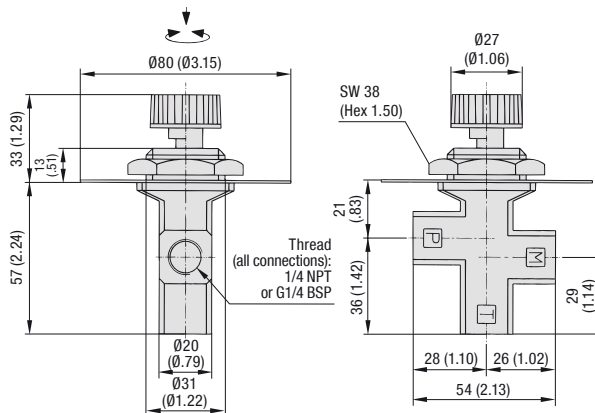

Characteristics

Effective protection of pressure gauges against overload caused by pressure peaks

Features

- Suitable for panel installation
- Max. panel thickness of 5 mm / .20 in
- Fixed with hexagonal nut
- Push button to read and turn to lock
- Multilingual instructions printed on face plate

Media Compatibility

- Suitable for hydraulic fluids

Please consult STAUFF before using with other media.

Materials

- Body made of Cast Iron
- Spindle made of Steel
- Push / turn button made of Polyamide (PA)
- Face plate made of Aluminium
- O-rings made of NBR (Buna-N®)

Technical Data

- Maximum working pressure: 400 bar / 5800 PSI
- Operating temperature range:
-30 °C ... +115 °C / -22 °F ... +239 °F

Order Codes

SWS - N04 - S1		
①	②	③
1 Type		
Gauge Isolator Valve		SWS
2 Connection Thread		
1/4 NPT (for all connections)		N04
G1/4 BSP (for all connections)		B04
3 Style		
Single station		S1

Gauge Isolator Valve ■ Type SWS-M (Multi Station)

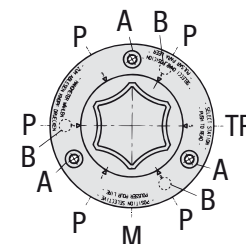
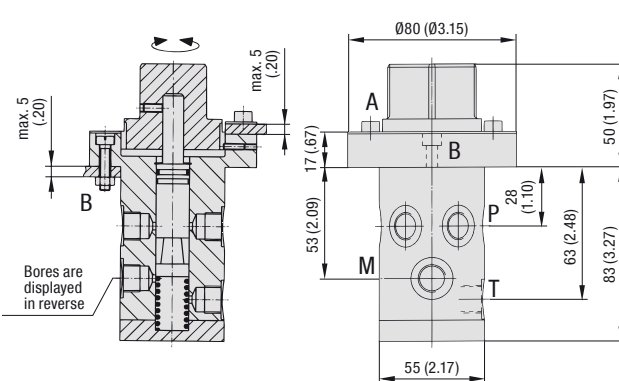

Mounting Bores (ø6 mm / .24 in)

- A 3 bores, equally spaced (120°), BCD ø65 mm / 2.56 in
- B 3 bores, equally spaced (120°), BCD ø65 mm / 2.56 in

Connections (7/16–20 UNF or G1/4 BSP)

- P 6 bores, equally spaced (60°)
- M 1 bore
- T 1 bore

Characteristics

Pressure measurement on six positions in the hydraulic circuit with only one pressure gauge

Features

- Suitable for bulkhead installation
- Max. panel thickness of 5 mm / .20 in
- Fixed with connection flange and screws: 3 hexagon head bolts M5 x 10 (DIN 933) for mounting the printed panel and 3 socket cap screws M5 x 25 (DIN 912) with washers (DIN 127) and nut (DIN 934) for panel installation included in delivery
- Turn button to select position of measurement
- Multilingual instructions printed on panel

Media Compatibility

- Suitable for hydraulic fluids

Please consult STAUFF before using with other media.

Materials

- Body made of Cast Iron
- Spindle made of Steel
- Push / turn button made of Polyamide (PA)
- Face plate and end cover made of Aluminium
- O-rings made of NBR (Buna-N®)

Technical Data

- Maximum working pressure: 400 bar / 5800 PSI
- Operating temperature range:
-30 °C ... +115 °C / -22 °F ... +239 °F

Order Codes

SWS - U04 - M		
①	②	③
1 Type		
Gauge Isolator Valve		SWS
2 Connection Thread		
7/16–20 UNF (1/4" SAE) for all connections		U04
G1/4 BSP for all connections		B04
3 Style		
Multi station		M