

Straight Reducer Type FI-G ▪ Series S

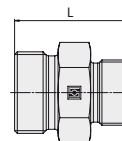
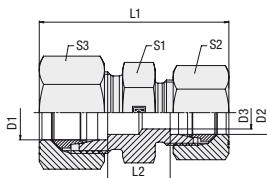

Series	Tube OD [mm]		PN [bar]	Dimensions [mm]							Weight [kg] ca. per 100 ²	Ordering Codes	
	D1	D2		D3	L	L1 ¹	L2	S1	S2	S3		Fitting body supplied with cutting rings & union nuts	Fitting body only
S	8	6	800	4	32	47	18	17	19	8,1	FI-G-08/06S-W3-MS	FI-G-08/06S-W3	
	10	6	800	4	32	48	17,5	19	22	9,9	FI-G-10/06S-W3-MS	FI-G-10/06S-W3	
	10	8	800	5	32	48	17,5	19	22	10,1	FI-G-10/08S-W3-MS	FI-G-10/08S-W3	
	12	6	630	4	34	50	19,5	22	17	24	11,8	FI-G-12/06S-W3-MS	FI-G-12/06S-W3
	12	8	630	5	34	50	19,5	22	19	24	12,4	FI-G-12/08S-W3-MS	FI-G-12/08S-W3
	12	10	630	7	34	51	19	22	22	24	13,5	FI-G-12/10S-W3-MS	FI-G-12/10S-W3
	14	10	630	7	36	54	20,5	24	22	27	17,0	FI-G-14/10S-W3-MS	FI-G-14/10S-W3
	14	12	630	8	36	54	20,5	24	24	27	17,6	FI-G-14/12S-W3-MS	FI-G-14/12S-W3
	16	10	630	7	36	54	20	27	22	30	19,2	FI-G-16/10S-W3-MS	FI-G-16/10S-W3
	16	12	630	8	36	54	20	27	24	30	20,1	FI-G-16/12S-W3-MS	FI-G-16/12S-W3
	16	14	630	10	38	57	21,5	27	27	30	22,7	FI-G-16/14S-W3-MS	FI-G-16/14S-W3
	20	10	400	7	40	60	22	32	22	36	28,7	FI-G-20/10S-W3-MS	FI-G-20/10S-W3
	20	12	400	8	40	60	22	32	24	36	29,4	FI-G-20/12S-W3-MS	FI-G-20/12S-W3
	20	16	400	12	42	63	23	32	30	36	33,1	FI-G-20/16S-W3-MS	FI-G-20/16S-W3
	25	16	400	12	46	68	25,5	41	30	46	53,0	FI-G-25/16S-W3-MS	FI-G-25/16S-W3
	25	20	400	16	48	71	25,5	41	36	46	58,2	FI-G-25/20S-W3-MS	FI-G-25/20S-W3
	30	20	400	16	50	74	26	46	36	50	67,6	FI-G-30/20S-W3-MS	FI-G-30/20S-W3
30	25	400	20	52	77	26,5	46	46	50	79,3	FI-G-30/25S-W3-MS	FI-G-30/25S-W3	
38	30	400	25	59	87	29,5	55	50	60	113,2	FI-G-38/30S-W3-MS	FI-G-38/30S-W3	

¹Approximate dimension with union nuts tightened.

²Weight including cutting rings and union nuts.



Also available from STAUFF, your single source manufacturer and supplier of pipework equipment and hydraulic components:
Complete range of **SAE Flanges and Components** in accordance with SAE J518 C and ISO 6162-1/2 (Standard and High Pressure Series)