

## Straight Reducer Type FI-G ▪ Series LL / L

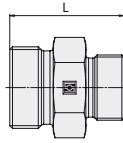
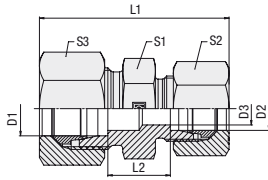

Series	Tube OD [mm]		PN [bar]	Dimensions [mm]							Weight [kg] ca. per 100 <sup>2</sup>	Ordering Codes	
	D1	D2		D3	L	L <sup>1</sup>	L2	S1	S2	S3		with cutting rings & union nuts	Fitting body only
LL	6	4	100	3	20	32	10,5	11	10	12	1,5	FI-G-06/04LL-W3-MS	FI-G-06/04LL-W3
	8	4	100	4,5	22	34	12,5	12	10	14	2,1	FI-G-08/04LL-W3-MS	FI-G-08/04LL-W3
	8	6	100	6	22	34	11	12	12	14	2,8	FI-G-08/06LL-W3-MS	FI-G-08/06LL-W3
L	8	6	500	4	25	40	11	14	14	17	5,5	FI-G-08/06L-W3-MS	FI-G-08/06L-W3
	10	6	500	4	26	41	12	17	14	19	5,9	FI-G-10/06L-W3-MS	FI-G-10/06L-W3
	10	8	500	6	26	41	12	17	17	19	6,3	FI-G-10/08L-W3-MS	FI-G-10/08L-W3
	12	6	400	4	27	42	13	19	14	22	6,8	FI-G-12/06L-W3-MS	FI-G-12/06L-W3
	12	8	400	6	27	42	13	19	17	22	7,5	FI-G-12/08L-W3-MS	FI-G-12/08L-W3
	12	10	400	8	28	43	14	19	19	22	8,2	FI-G-12/10L-W3-MS	FI-G-12/10L-W3
	15	10	400	8	29	45	15	24	19	27	11,5	FI-G-15/10L-W3-MS	FI-G-15/10L-W3
	15	12	400	10	29	45	15	24	22	27	12,5	FI-G-15/12L-W3-MS	FI-G-15/12L-W3
	18	10	400	8	30	46	15,5	27	19	32	15,4	FI-G-18/10L-W3-MS	FI-G-18/10L-W3
	18	12	400	10	30	46	15,5	27	22	32	15,8	FI-G-18/12L-W3-MS	FI-G-18/12L-W3
	18	15	400	12	31	48	16,5	27	27	32	18,7	FI-G-18/15L-W3-MS	FI-G-18/15L-W3
	22	12	250	10	32	48	17,5	32	22	36	20,6	FI-G-22/12L-W3-MS	FI-G-22/12L-W3
	22	15	250	12	33	50	18,5	32	27	36	22,8	FI-G-22/15L-W3-MS	FI-G-22/15L-W3
	22	18	250	15	33	50	18	32	32	36	25,5	FI-G-22/18L-W3-MS	FI-G-22/18L-W3
	28	18	250	15	34	52	19	41	32	41	36,5	FI-G-28/18L-W3-MS	FI-G-28/18L-W3
	28	22	250	19	36	54	21	41	36	41	39,3	FI-G-28/22L-W3-MS	FI-G-28/22L-W3
	35	22	250	19	39	59	21	46	36	50	51,6	FI-G-35/22L-W3-MS	FI-G-35/22L-W3
35	28	250	24	39	59	21	46	41	50	58,9	FI-G-35/28L-W3-MS	FI-G-35/28L-W3	
42	35	250	30	42,5	66	21	55	50	60	79,1	FI-G-42/35L-W3-MS	FI-G-42/35L-W3	

<sup>1</sup> Approximate dimension with union nuts tightened.

<sup>2</sup> Weight including cutting rings and union nuts.



Also available from STAUFF, your single source manufacturer and supplier of pipework equipment and hydraulic components:  
High-precision **Digital Pressure Gauges SPG-DIGI** for stem mounting and for operating pressures from -1 bar to 600 bar