

High-Pressure Round Body Ball Valve - Type BBVF

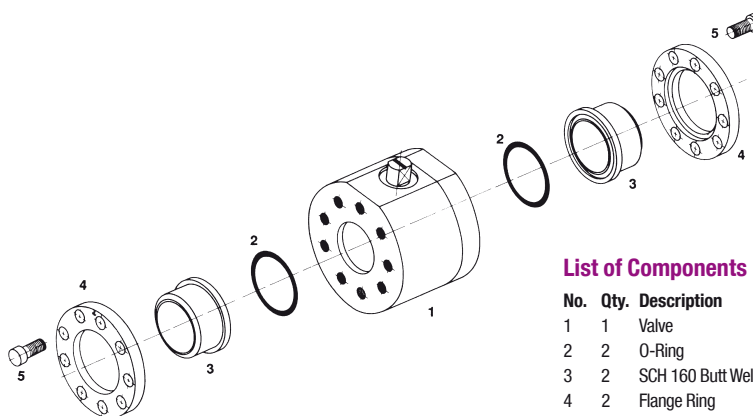

List of Components

No.	Qty.	Description
1	1	Valve
2	2	O-Ring
3	2	SCH 160 Butt Weld End
4	2	Flange Ring
5	18	Flange Bolt

Characteristics

Two-way high-pressure round body ball valves designed for use as on/off devices for hydraulic applications

Standard Construction

- Round body design for in-line assembly
- Machined parts for reduced torque operation
- Designed for direct mount to reduce threads in fluid flow
- High-pressure DIN flange connection
- Supplied with removable, adjustable lever

Standard Materials

- Body: Carbon Steel, zinc/iron-plated
- Ball: Carbon Steel, hard chrome-plated
- Stem: Carbon Steel
- Lever: Carbon Steel
- Ball seat: Delrin® (POM)
- O-rings: FPM (Viton®)

Standard Connections Styles / Sizes

- DIN flange connection with SCH 160 butt weld ends

Pressure Range

- Pressure range: up to 345 bar / 5000 PSI (depending on size and material combination of the ball valve)

Temperature Range

- Operating temperature range: -20°C ... +100°C / -4°F ... + 212°F

Options / Accessories

- Locking devices (see pages F99-F101)
- Pneumatic actuator packages (see page F102)
- Limit switches (see page F102)
- Stainless Steel body
- Stainless Steel ball and stem
- Special ball seat and O-ring materials available for lower/higher temperatures and more aggressive media
- Electrical actuators available on request. Please consult STAUFF for further information.

Order Codes

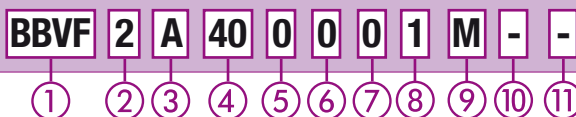

① Type

High-Pressure Round Body Ball Valve **BBVF**

② Number of Ports

Two Ports (Two-Way Ball Valve) **2**

③ Connection Style

DIN Flange Connection with Butt Weld Ends with Unified Coarse (UNC) Bolts **A**

Please consult STAUFF for alternative connection styles.

④ Connection Size

STAUFF Size (according to dimension table):  

40	48	64	80
----	----	----	----

Please consult STAUFF for alternative connection sizes.

⑤ Body Material / Surface Finishing

Carbon Steel, zinc/iron-plated **0**  
 Stainless Steel V4A (AISI 316Ti) **1**

Alternative materials / surface finishings are available upon request. Consult STAUFF for further information.

⑥ Ball / Stem Material

Ball: Carbon Steel, hard chrome-plated **0**  
 Stem: Carbon Steel **0**  
 Ball / Stem: Stainless Steel V4A (AISI 316Ti) **1**

Alternative materials / surface finishings are available upon request. Consult STAUFF for further information.

⑦ Ball Seat Material

Delrin® (POM) **0**

Alternative materials are available upon request. Consult STAUFF for further information.

⑧ O-Ring Material

NBR (Buna-N®) **0**  
 FPM (Viton®) **1**

Alternative materials are available upon request. Consult STAUFF for further information.

⑨ Manufacturing Code

Manufacturing code for all connection styles **M**

⑩ Lever Options

Supplied with standard lever (according to table) **-**  
 Supplied without lever **-0**

Alternative levers can be ordered separately. Please see page F98 for further information.

⑪ Accessories / Options

Supplied without accessories **-**  
 Supplied with Locking Device LD5A (standard) **-LD5A**  
 Supplied with Locking Device LD5B **-LD5B**  
 Supplied with Double-Acting Pneumatic Actuator (Please add size \*\*) **-EDA\*\***  
 Supplied with Single-Acting Pneumatic Actuator (Please add size \*\*) **-ESA\*\***  
 Supplied with Limit Switch in open position **-LS-0**  
 Supplied with Limit Switch in closed position **-LS-C**  
 Supplied with Limit Switch in open and closed position **-LS-OC**

Please see page F99 for further information.

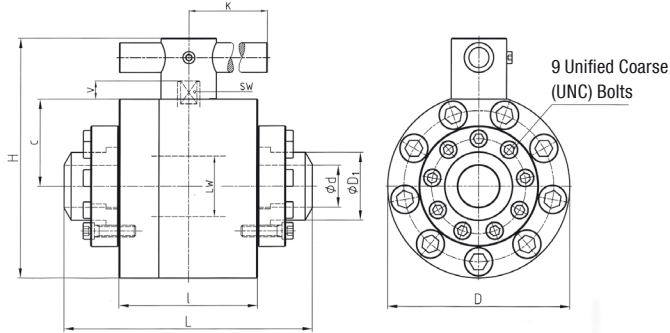
**High-Pressure Round Body Ball Valve - Type BBVF  
DIN Flange Connection with Butt Weld Ends**

When ordering the standard option as indicated in the table below, the following materials will be supplied:

- Body, ball and stem: Carbon Steel
- Lever: Carbon Steel
- Ball seat: Delrin® (POM)
- O-rings: FPM (Viton®)

STAUFF Size	Nominal Size DN	Dimensions (mm/in)											Nom. Pressure (bar/PSI)	Weight (kg/lbs)	Order Codes (Standard Option)	
		LW	L	I	D	H	c	V	K	SW	d	D1				Bolt Type
40	65	65	250	150	198	259	94	21	600	16	45	73	1/2-13 UNC x 1-3/4 (Grade 8)	475	40	BBVF2A400001M
		2.56	9.84	5.91	7.80	10.20	3.70	.83	23.62	.63	1.77	2.87		6800	88.00	
48	80	76	260	140	210	277	100	26	600	19	58,4	88,9	5/8-11 UNC x 1-3/4 (Grade 8)	420	45,5	BBVF2A480001M
		2.99	10.24	5.51	8.27	10.91	3.94	1.02	23.62	.75	2.30	3.50		6000	100.10	
64	100	100	330	170	260	327	122	27	900	24	80,1	114,3	5/8-11 UNC x 1-3/4 (Grade 8)	365	75	BBVF2A640001M
		3.94	12.99	6.69	10.24	12.87	4.80	1.06	35.43	0.94	3.15	4.50		5200	165.00	
80	125	118	370	210	300	380	140	33	900	36	103,2	141,3	3/4-10 UNC x 2-1/4 (Grade 8)	329	120	BBVF2A800001M
		4.65	14.57	8.27	11.81	14.96	5.51	1.30	35.43	1.42	4.06	5.56		4700	264.00	

Please note: Lever must be fixed in central position during operation. In case of vibration, the lever may otherwise operate the valve by itself.