

# S-LOK Tube Fittings

## Gauge Connector SCG

See page 24  
for SGG gasket

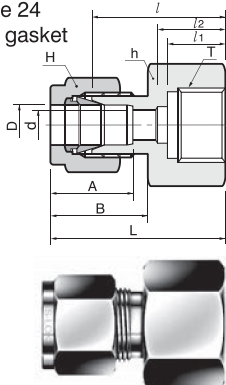

Connects metric tube to ISO parallel thread (gauge)

Part No.	Tube O.D.		T R(PF)	E Min.	Width across flat		A	B	l	l <sub>1</sub>	l <sub>2</sub>	d	L
	D				h	H							
SCG-3M-4G	3		1/4	2.4	19	12	12.9	15.3	28.7	13	17.0	5.5	35.3
SCG-6M-4G	6		1/4	4.8	19	14	15.3	17.7	30.2	13	17.0	5.5	37.6
SCG-6M-6G	6		3/8	4.8	24	14	15.3	17.7	30.2	14	20.3	6.5	37.6
SCG-6M-8G	6		1/2	4.8	27	14	15.3	17.7	36.1	19	24.9	7.0	43.5
SCG-8M-4G	8		1/4	5.5	19	16	16.2	18.6	31.0	13	-	5.5	38.5
SCG-8M-6G	8		3/8	6.5	24	16	16.2	18.6	28.7	14	-	6.5	36.2
SCG-8M-8G	8		1/2	7.0	27	16	16.2	18.6	33.5	19	-	7.0	41.0
SCG-10M-4G	10		1/4	5.5	19	19	17.2	19.5	31.8	13	-	5.5	39.4
SCG-10M-6G	10		3/8	6.5	24	19	17.2	19.5	31.2	14	-	6.5	38.8
SCG-10M-8G	10		1/2	7.0	27	19	17.2	19.5	34.5	19	-	7.0	42.1
SCG-12M-4G	12		1/4	5.5	22	22	22.8	22.0	31.8	13	-	5.5	41.9
SCG-12M-6G	12		3/8	6.5	24	22	22.8	22.0	34.3	14	-	6.5	44.4
SCG-12M-8G	12		1/2	7.0	27	22	22.8	22.0	38.1	19	-	7.0	48.2
SCG-20M-8G	20		1/2	7.0	30	32	26.0	22.0	44.2	19	-	7.0	54.3
SCG-22M-8G	22		1/2	7.0	30	32	26.0	22.0	44.2	19	-	7.0	54.3

Connects fractional tube to ISO parallel thread (gauge)

Part No.	Tube O.D.		T G(PF)	E Min.	Width across flat				A	B	l	l <sub>1</sub>	l <sub>2</sub>	d	L
	D				h	h <sub>1</sub>	H								
	in	mm													
SCG-4-2G	1/4	6.35	1/8	4.82	9/16	14.28	9/16	14.28	15.24	17.78	26.30	12.00	17.0	5.6	33.55
SCG-4-4G	1/4	6.35	1/4	4.82	3/4	19.05	9/16	14.28	15.24	17.78	30.22	12.95	17.0	5.6	37.59
SCG-4-6G	1/4	6.35	3/8	4.82	15/16	24.81	9/16	14.28	15.24	17.78	30.22	14.22	20.3	6.6	37.59
SCG-4-8G	1/4	6.35	1/2	4.82	1-1/16	26.96	9/16	14.28	15.24	17.78	36.07	18.80	24.9	7.1	43.43
SCG-5-4G	5/16	7.93	1/4	5.58	3/4	19.05	5/8	15.87	16.25	18.54	30.98	12.95	-	-	38.6
SCG-5-8G	5/16	7.93	1/2	7.11	1-1/16	26.98	5/8	15.87	16.25	18.54	33.53	18.80	-	-	40.89
SCG-6-4G	3/8	9.52	1/4	5.58	3/4	19.05	11/16	17.46	16.76	19.30	31.75	12.95	-	-	39.12
SCG-6-6G	3/8	9.52	3/8	6.60	15/16	24.81	11/16	17.46	16.76	19.30	31.24	14.22	-	-	38.61
SCG-6-8G	3/8	9.52	1/2	7.11	1-1/16	26.98	11/16	17.46	16.76	19.30	34.54	18.80	-	-	41.91
SCG-8-4G	1/2	12.70	1/4	5.50	7/8	22.22	7/8	22.22	22.86	21.84	31.80	12.95	-	-	41.95
SCG-8-6G	1/2	12.70	3/8	6.60	15/16	23.81	7/8	22.22	22.86	21.84	34.29	14.22	-	-	44.45
SCG-8-8G	1/2	12.70	1/2	7.11	1-1/16	26.98	7/8	22.22	22.86	21.84	38.10	18.80	-	-	48.26

## Bulkhead Female Connector SCBF

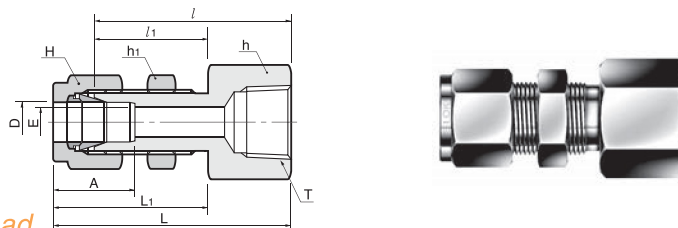

Connects fractional tube to male NPT thread

Part No.	Tube O.D.		T (NPT)	E Min.	Width across flat						A	l	l <sub>1</sub>	L	L <sub>1</sub>	Panel Hole Drill Size	Panel Max Thickness
	D				h	h <sub>1</sub>	H										
	in	mm								in							
SCBF-2-2N	1/8	3.17	1/8	2.28	9/16	14.28	1/2	12.70	7/16	11.11	12.70	38.10	24.63	44.70	31.24	8.33	12.70
SCBF-4-2N	1/4	6.35	1/8	4.82	5/8	15.87	5/8	15.87	9/16	14.28	15.24	39.62	26.16	46.99	33.52	11.50	10.16
SCBF-4-4N	1/4	6.35	1/4	4.82	3/4	19.05	5/8	15.87	9/16	14.28	15.24	44.45	26.16	51.81	33.52	11.50	10.16
SCBF-6-4N	3/8	9.52	1/4	7.11	3/4	19.05	3/4	19.05	11/16	17.46	16.76	47.75	29.46	55.11	36.83	14.68	11.17
SCBF-6-6N	3/8	9.52	3/8	7.11	7/8	22.22	3/4	19.05	11/16	17.46	16.76	49.41	29.46	56.77	36.83	14.68	11.17
SCBF-8-6N	1/2	12.70	3/8	10.41	15/16	23.81	15/16	23.81	7/8	22.22	22.86	51.56	31.75	61.72	41.91	19.44	12.70
SCBF-8-8N	1/2	12.70	1/2	10.41	1-1/16	26.98	15/16	23.81	7/8	22.22	22.86	56.38	31.75	66.54	41.91	19.44	12.70
SCBF-12-12N	3/4	19.05	3/4	15.74	1-1/4	31.75	1-3/16	30.16	1-1/8	28.57	24.38	63.60	37.33	73.51	47.21	25.79	16.76
SCBF-16-16N	1	25.40	1	22.35	1-5/8	41.27	1-5/8	41.27	1-1/2	38.10	31.24	81.04	45.21	93.23	57.40	33.73	19.05
SCBF-20-20N	1-1/4	31.75	1-1/4	27.68	1-7/8	47.63	1-7/8	47.63	1-7/8	47.63	41.14	83.49	47.75	105.59	69.85	41.67	19.05
SCBF-24-24N	1-1/2	38.10	1-1/2	34.03	1-1/4	57.15	2-1/4	57.15	2-1/4	57.15	50.03	87.39	49.27	114.57	76.45	49.61	19.05
SCBF-32-32N	2	50.80	2	45.97	1-3/4	69.85	2-3/4	69.85	3	76.20	67.56	95.30	56.38	132.63	93.71	57.94	19.05

Connects metric tube to male NPT thread

Part No.	Tube O.D.		T (NPT)	E Min.	Width across flat			A	l	l <sub>1</sub>	L	L <sub>1</sub>	Panel Hole Drill Size	Panel Max Thickness
	D				h	h <sub>1</sub>	H							
SCBF-6M-2N	6		1/8	4.8	15.8	15.8	14	15.3	39.6	26.2	46.90	35.00	11.5	10.2
SCBF-6M-4N	6		1/4	4.8	19.0	16.0	14	15.3	44.4	26.2	51.80	33.60	11.5	10.2
SCBF-8M-4N	8		1/4	6.3	19.0	17.4	16	16.2	46.7	28.6	53.85	35.55	13.1	11.2
SCBF-12M-8N	12		1/2	9.5	27.0	24.0	22	22.8	56.4	31.8	66.50	41.90	19.5	12.7