

Service Schematic

NOTICE - PROPRIETARY INFORMATION: THIS SERVICE SCHEMATIC AND ITS CONTENTS ARE WHOLLY OWNED BY HYDRO-GEAR OF SULLIVAN, IL, AND MAY NOT BE USED, DISCLOSED, PUBLISHED OR REPRODUCED WITHOUT THE WRITTEN CONSENT OF HYDRO-GEAR.

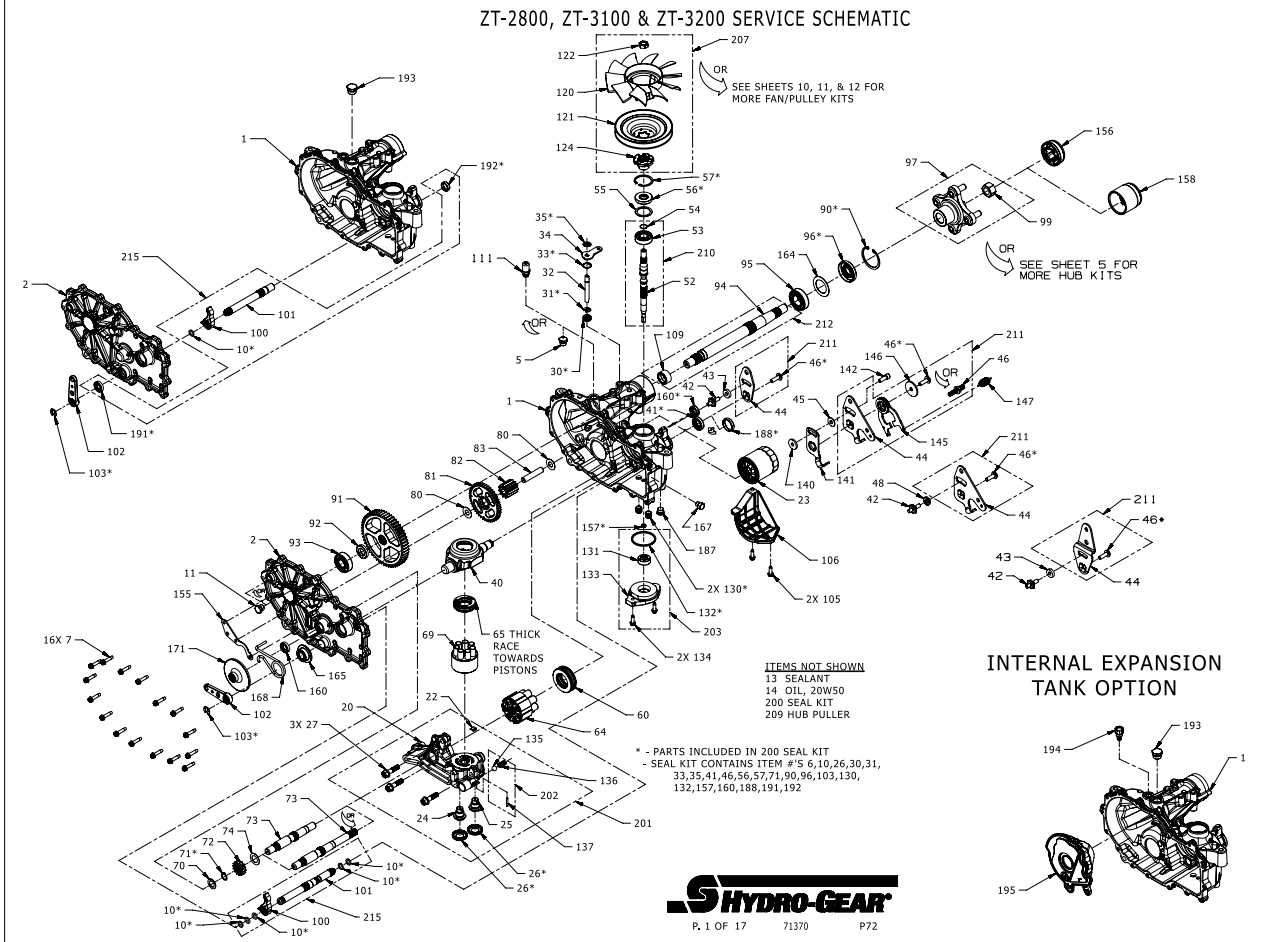

Service Schematic

| # | PART # | DESCRIPTION | QTY | Note |
|-----|--------|------------------------------------|--------|------|
| 1 | 73069 | KIT, HOUSING, MAIN, RH, CHRГ, CNTL | 1 | |
| 2 | 73095 | KIT, SIDE COVER, RH | 1 | |
| 7 | 53246 | SCREW 1/4-20 X 1.125 HEX WASHER | 16 | |
| 10 | 51804 | O-RING -111 .103 X .424 | 1 | |
| 11 | 54730 | PLUG, EXTERNAL, HEX | 1 | |
| 13 | 50928 | SEALANT TUBE | 1 | |
| 14 | | OIL, 20W50 | 71.9oz | |
| 22 | 51448 | PLATE, BYPASS | 1 | |
| 23 | 52114 | FILTER, OIL | 1 | |
| 26 | 52162 | SEAL 1.375 X .250 PLUG | 2 | |
| 27 | 52137 | SCREW 3/8-16 X 1.50 HFH | 3 | |
| 30 | 55232 | SEAL, LIP .375 X .75 X .25 | 1 | |
| 31 | 51628 | RING RET 37 EXT KLIPRING | 1 | |
| 32 | 52136 | ROD BYPASS | 1 | |
| 33 | 51627 | RING RET 75 INT | 1 | |
| 34 | 51910 | ARM, BYPASS | 1 | |
| 35 | 51630 | RING RET 37 EXT PUSH | 1 | |
| 40 | 51048 | TRUNNION, SWASHPLATE | 1 | |
| 41 | 51140 | SEAL 18 X 32 X 7 LIP | 1 | |
| 45 | 44130 | WASHER .34 X .88 X .06 | 1 | |
| 46 | 51812 | SCREW 5/16-24 X 1.00 TWHCS PATCH | 1 | |
| 55 | 50951 | WASHER 1.23 X 1.57 X .04 | 1 | |
| 56 | 55486 | SEAL, LIP 17 X 40 X 7 HNBR | 1 | |
| 57 | 50329 | RING RET 156 INT | 1 | |
| 60 | 51462 | BEARING 35X62X16 BALL THRUST | 1 | |
| 64 | 72882 | ASS'Y, CYLINDER BLOCK, 16cc | 1 | |
| 65 | 50551 | BEARING 30X52X13 BALL THRUST | 1 | |
| 69 | 70723 | ASSY, BLOCK 7 PISTON | 1 | |
| 70 | 44371 | WASHER .63 X 1.0 X .05 FLAT | 1 | |
| 71 | 44145 | RETAINING RING, MOTOR SHAFT | 1 | |
| 72 | 52341 | GEAR 14T | 1 | |
| 73 | 52150 | SHAFT MOTOR | 1 | |
| 74 | 51069 | WASHER .71 X 1.16 X .04 FLAT | 1 | |
| 80 | 50132 | WASHER .51 X 1.10 X .03 FLAT | 2 | |
| 81 | 52110 | GEAR, 45T | 1 | |
| 82 | 52586 | GEAR, 11T STEEL | 1 | |
| 83 | 55710 | JACK SHAFT (PIN) | 1 | |
| 90 | 50859 | RING, RETAINING 206 INTERNAL | 1 | |
| 91 | 52108 | GEAR, 54T | 1 | |
| 92 | 53336 | SPACER, .75 X 1.32 X .257 | 1 | |
| 93 | 72749 | KIT, BEARING | 1 | |
| 95 | 53656 | BEARING 25.4X52X15 BALL 6205R-1 | 1 | |
| 96 | 53699 | SEAL 1.0 X 2.06 X .38 LIP TC4 | 1 | |
| 97 | 71446 | KIT, HUB 4 BOLT | 1 | |
| 99 | 53768 | NUT 3/4-16 HEX LOCK | 1 | |
| 100 | 52766 | PAWL, BRAKE | 1 | |

Service Schematic

| # | PART # | DESCRIPTION | QTY | Note |
|-----|--------|---|-----|------|
| 101 | 55480 | SHAFT, BRAKE, INBOARD | 1 | |
| 102 | 53973 | HANDLE, ACTUATING | 1 | |
| 103 | 53019 | RING RET 43 EXT KLIPRING | 1 | |
| 105 | 50752 | SCREW 1/4-20 X .75 HF | 2 | |
| 106 | 73041 | GUARD, FILTER, RH | 1 | |
| 111 | 71393 | KIT 1/2 BEADED 9/16 SAE FITTING | 1 | |
| 130 | 54501 | TUBE CHARGE TRIPLE O-RING | 2 | |
| 131 | 50273 | GEROTOR TANGX1.15X.39 (1.9CC) | 1 | |
| 132 | 55204 | O-RING -137, 2.05 X .099 SQUARE | 1 | |
| 133 | 53738 | HOUSING CHARGE PUMP | 1 | |
| 134 | 50752 | SCREW 1/4-20 X .75 HF | 2 | |
| 140 | 54315 | SPACER 0.320 ID X 1.005 OD X 0.1495 THK | 1 | |
| 141 | 51945 | ARM, NEUTRAL RIGHT | 1 | |
| 142 | 51616 | SHCS 5/16-24 X .875 | 1 | |
| 147 | 51605 | SPRING, EXTENSION | 1 | |
| 157 | 72291 | KIT GEROTOR SEAL | 1 | |
| 158 | 53501 | CAP, AXLE | 1 | |
| 164 | 53514 | SPACER 1.719 X 2.039 X .021 | 1 | |
| 186 | 53496 | TUBE AXLE 2.03 | 1 | |
| 191 | 53138 | SEAL .625 X .875 X .250 LIP | 1 | |
| 192 | 55177 | SEAL, PLUG .875 X .250 | 1 | |
| 193 | 54974 | PLUG, 3/4 - 16 | 1 | |
| 200 | 73107 | KIT, SEAL | 1 | |
| 201 | 71561 | KIT, CENTER SECTION RH, CHRG | 1 | |
| 202 | 71436 | KIT, CHARGE RELIEF | 1 | |
| 203 | 72274 | KIT CHARGE | 1 | |
| 209 | 72320 | KIT HUB PULLER | 1 | |
| 210 | 73047 | KIT, INPUT SHAFT | 1 | |
| 211 | 71590 | KIT, RTN CW | 1 | |
| 212 | 71570 | KIT, SHAFT, AXLE | 1 | |
| 215 | 73120 | KIT, INBOARD RH ROT "A" / LH ROT "B" | 1 | |