

User's Manual  
Saturn V Moon Lander



Dare to LIV



User's Manual  
Saturn V Moon Lander

# *Table of contents*

<i>Caliber 19</i>	01
<i>Caring for your watch</i>	03
<i>Deployant Clasp</i>	06
<i>FAQ</i>	09



## Saturn V Moon Lander *Caliber 19*

### The Movement

#### Description

- › Made in Switzerland
- › Powered by a battery

#### Performance

- › Estimated battery life  
38 months

#### Display

- › Three eyes
- › Multi-function chronograph
- › Perpetual Moon phase display
- › Date window at 4 o'clock
- › Small seconds in a subdial

#### User's Manual

## Parts of your new watch

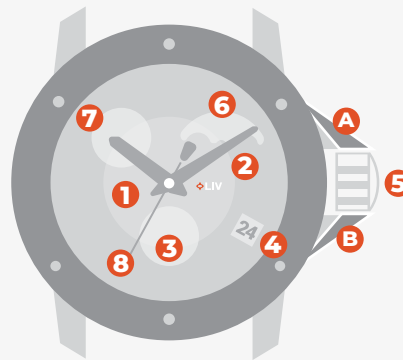

- 1** › Hour hand
- 2** › Minute hand
- 3** › Second hand
- 4** › Date display
- 5** › Crown, screw down
- 6** › Moon Phase
- 7** › 60 min/12 hour Counter
- 8** › 60 sec Counter
- A-B** › Buttons

## Setting your watch

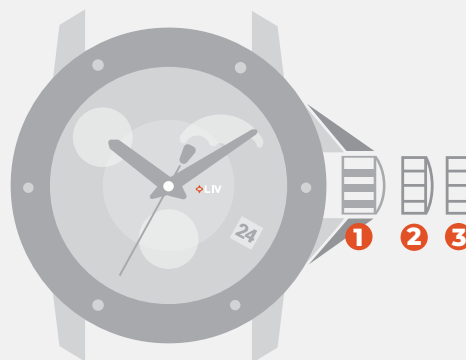

**1** › POSITION 1  
Normal position

**2** › POSITION 2  
Setting the date  
Screw crown out and pull once to position 2 and turn counterclockwise to set the date.

**3** › POSITION 3  
Unscrew/pull crown to position 3 and turn to desired time. Important: To set time to the exact second, pull crown to position 3 when the second hand is at "60." Once the hour and minute hands have been set, push the crown back to position 1 and screw down to preserve the water resistance.

**Important:** The date of the following day must be set in the calendar changing phase between 9 pm and 12 am.



## Saturn V Moon Lander *Caliber 19*

### The Movement

#### Description

- › Made in Switzerland
- › Powered by a battery

#### Performance

- › Estimated battery life  
38 months

#### Display

- › Three eyes
- › Multi-function chronograph
- › Perpetual Moon phase display
- › Date window at 4 o'clock
- › Small seconds in a subdial

### User's Manual

## Correction of Moon Phase

- › Unscrew and pull crown to position III.
- › Adjust Moon phase by pushing button B:
  - › Short press (less than 1 second) advances the display by one (1) hour.
  - › Long press (longer than 1 second) advances the display 5 days.  
Hold the button to advance at a slow/medium/fast rate.

## Timing Mode

### SIMPLE chronograph operation

- › Make sure the crown is in position I.
- › Press button A to start timing.
- › Press button A again to stop timing and read elapsed time.
- › Press button B to reset to zero.

### Accumulated Timing

- › Make sure the crown is in position I.
- › Press button A to start timing.
- › Press button A again to stop timing and read elapsed time.
- › Repeat steps 2 - 3 until you are finished.
- › Press button B to reset to zero.

### Intermediate or Interval Timing

- › Make sure the crown is in position I.
- › Press button A to start timing.
- › Press button B to stop and read split time 1.
- › Press button B to restart and catch up.
- › Press button B to stop and read split time 2.
- › Repeat steps as necessary.
- › Press button A followed by button B (twice if running) to reset to zero.



# *Caring for your LIV Swiss Watch*



# *Caring for your LIV Swiss Watch*

## Clean your watch regularly as follows;

- 1.** Ensure that the crown is completely screwed down/pushed in before you get started.
- 2.** If the seals in your watch have been tested and changed within the last 12 months by an authorized LIV service center, then you may use a soft brush with mildly soapy water to clean the case, then rinse it off with clear water and dry it with a soft cloth. If your watch is fitted with a fabric, alligator, leather or python skin strap, take care not to get it wet.
- 3.** If you have any doubts whatsoever about the water resistance of your watch, simply clean it with a soft brush, and then dry it. Avoid contact with detergents, solvents, cosmetics or any other chemical product, as these may damage the water-resistant gaskets and the bracelet.

## Condensation & Water Resistance

Some condensation may form under the crystal of your watch due to a sudden temperature change. This will disappear by itself and does not impact the watch's function. If the condensation persists, contact LIV or an authorized LIV dealer. Given the nature of rubber seals, water resistance cannot be a permanent condition. The rubber seals are designed to prevent water entry, however the fact that they are under constant pressure means that over time they will deteriorate. It is therefore necessary, throughout your watch's warranty coverage period, to have the water-resistance tested by LIV or an authorized LIV repair center every two years after the date of purchase. These tests are conducted free of charge. The International Warranty does not cover problems with water resistance and associated consequences if periodic water-resistance tests have not been conducted every two years following the date of purchase.



# *Caring for your LIV Swiss Watch*

## Crystals

The crystal in your watch may be coated with an anti-reflective treatment (single or double), to make the time more readable. Marks may appear due to normal wear and tear of the watch, and are not covered by the International Warranty. The coating will be sufficient with normal watch wear.

## Straps in Leather, Fabric, & Python/Alligator Skin

Be sure to avoid letting these watch straps get into contact with water. Please note that no matter how careful you are with leather, it is a living material and its color will naturally (slightly) fade or darken over time. Leather straps should be cleaned with a dry, soft cotton cloth. Avoid any abrasive products during cleaning.

## Silicone Straps

Since silicone attracts dust, there is an anti dust coating on the band which makes the silicone strap matte. It is normal for that coating to start coming off after approximately 6 months of everyday wear. The strap will begin to appear shiny as time progresses.



# *Deployant Clasp*



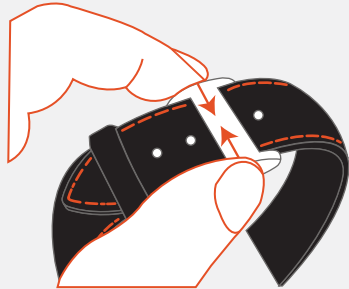

**1 ›** To open the clasp, press in the push-pieces on either side simultaneously.

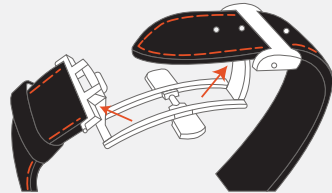

**2 ›** Open the clasp to enlarge the bracelet and remove the watch from your wrist.

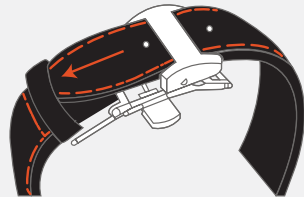

**3 ›** Put the strap on your wrist and slide the long section through the small fixed buckle.

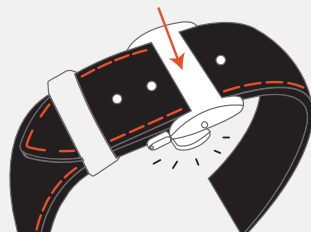

**4 ›** Close the deployant clasp until it clicks into place. If necessary, slide the long section through the small mobile buckle.

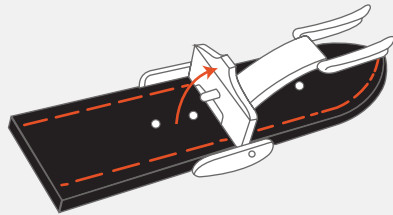

**1** › Release the adjusting mechanism by removing the pin from the hole in the long section of the strap.

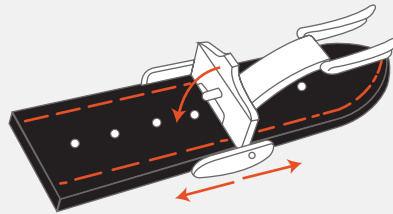

**2** › Slide the mechanism along the long section, then fix it by reinserting the pin in the desired hole.



*FAQ*

## I've been setting the date at all times of the day and night but it always changes date at noon instead of midnight. What should I do?

Your watch is set to PM instead of AM – it's a 12 hour clock. So for example, your 11 AM is set to 11 PM. The date changes between 11 PM and 1 AM. You simply need to bring the time forward by 12 hours.

## How long will my battery last?

Your battery should last 38 months.. Your time may vary, especially if you make heavy use of the chronograph capabilities.

## Can I tell if my battery needs replacing before it dies completely?

Yes, you can. The constant running seconds hand will start moving 2 seconds at a time rather than 1. This tells you it's time to get a fresh battery.

## Can anyone replace the battery?

We recommend you let us replace the battery. We can open and close the case without damaging the water resistance seals. Plus, we can inspect them to be sure they are still good at the same time. If someone else replaces the battery and damages the seals, it voids the International Warranty.



[www.livwatches.com](http://www.livwatches.com)



DARE TO LIV