

MEGA STAGE

DYNA  STAGE®

Quick Specs

Model 40 38 25



*Dynastage model 42 38 25 used as main stage at the International Vocal Arts Festival in Trois-Rivières, QC, Canada.
This event has been using MegaStage products since 1998, delighting 200 000 spectators annually.*

Copyright Mega-Stage 2007

Any representation or reproduction, in whole or partial, made without written consent from Mega-Stage is prohibited (Law of March 11, 1957, article 40, subparagraph 1). Such representation or reproduction, by any means, constitutes counterfeiting punished by article 425 et sq. of the Criminal Code.



One of two Dynastage 42 38 25 mobile stages used by the 2005 edition of Divers/Cité Festival in downtown Montreal. Another Dynastage product was also used for smaller venues.

Contents

<i>Technical specifications</i>	<i>Page 1</i>
<i>Rigging Plan</i>	<i>Page 2</i>
<i>Side view</i>	<i>Page 3</i>
<i>Front view</i>	<i>Page 4</i>
<i>Stage floor</i>	<i>Page 5</i>
<i>Trailer</i>	<i>Page 6</i>





Trailer

Width	8' - 2 1/2" or 2,50 m
Length	44' - 7 3/4" or 13,61 m
Height	13' - 1 1/2" or 4,0 m
Nominal gross vehicle weight	49 020 lbs or 22 235 kg
Nominal gross axle weight	33 039 lbs or 14 986 kg
Maximum load on axles	40 560 lbs or 18 398 kg
Additional weight allowed	7 521 lbs or 3 411 kg
Cargo space	5' - 3" x 8' - 0" x 40' - 6" (1 701 ft ³) 1,60 m x 2,44 m x 12,34 m (48,17 m ³)

Overall dimensions (stage)

Depth	38' - 2 3/4" (44' - 4" including FOH) 11,65 m (13,51 including FOH)
Width	44' - 4" (65' - 0" with PA wings) 13,51 m (19,81 with PA wings)
Height	31' - 6" to 33' - 3" (37' - 7" with columns) 9,60 m to 10,14 m (11,45 m with columns)

Stage dimensions

Floor dimensions	41' - 10 1/4" x 37' - 7" 12,75 m x 11,46 m
Ground to floor height	5' - 2" to 6' - 7 1/4" (with 1 block) 1,57 m to 2,01 m (with 1 block)
Clearance under center trussing	24' - 4 3/4" or 7,44 m
Clearance under other trussing	24' - 10 1/4" or 7,58 m
Clearance under purlin	26' - 5" or 8,05 m
Clearance under roof membrane	26' - 7" or 8,10 m

Other specifications

Floor materials	Plywood over steel
Load bearing capacity of the floor	150 lbs per ft ² (7,2 kpa or 732 kg/m ²)
Roof materials	Fiberglass bonded to steel structure
PA wings dimensions	6' - 0" or 1,83 m
Front of house (FOH) supports dimensions	6' - 1 1/4" or 1,86 m
PA wings dimensions	9' - 0" to 20' - 0" (2,74 m to 6,1 m)
Hanging pipes	Six (6) industry-standard 2" (50,8 mm) nominal diameter
Maximum load bearing : Roof	26 000 lbs* or 11 793 kg
Maximum load bearing : FOH supports	1 000 lbs* or 454 kg
Maximum load bearing : Inside supports	750 lbs* or 340,2 kg
Maximum load bearing : PA wings	4 400 - 8 000 lbs* or 1 996 kg - 3 629 kg
Maximum load bearing : Center trusses	6 000 lbs* or 2 722 kg
Maximum load bearing : Intermediate trusses	3 000 lbs* or 1 361 kg
Maximum load bearing : Edge trusses	4 000 lbs* or 1 814 kg
Wind resistance	60 mph (100 km/h) with wind screens
Wind lift resistance	15 lbs/ft ² or 73,2 kg/m ³
Stairs	44" (1,12 m) wide with handrails
Motor	20 HP fuel powered Honda GX620
Install time	2 to 3 hours with 2 technicians
Transport	Standard tractor-trailer
Wind screen (sides and back)	16 oz. flame retardant black vinyl
Wind screen openings (doors)	Two 8' x 8' (2,44 m x 2,44 m) and two 5' x 8' (1,52 m x 2,44 m)
Wind screen openings (wind flaps)	Eight 6' x 3' (1,83 m x 0,91 m)
Stage skirt	Black Novathene TG
Stairs	44" (1,12 m) wide
* Options	Refer to rigging plan

All dimensions and specifications are subject to change without prior notice

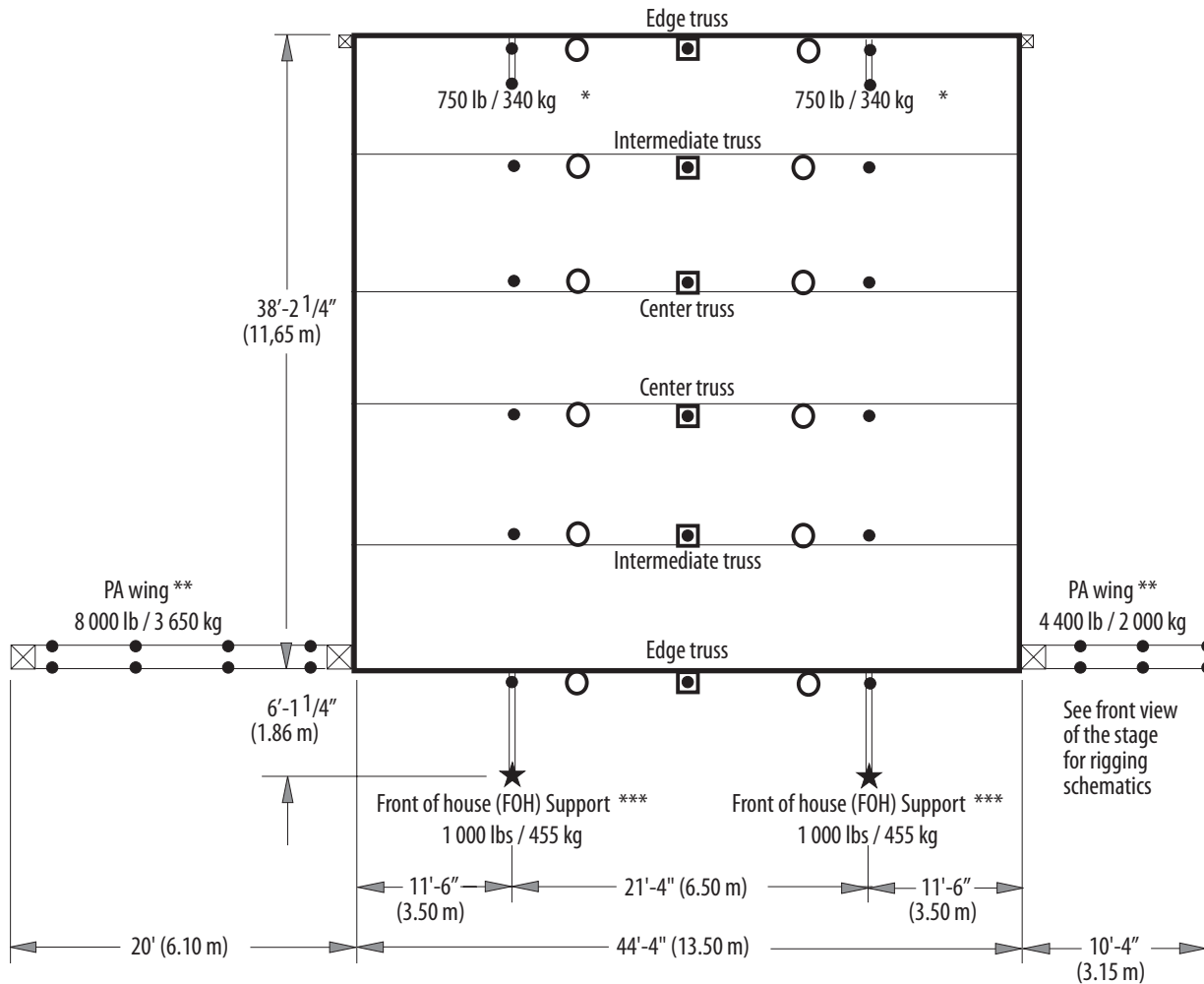

Maximum load

26 000 lbs or 11 793 kg
 34 800 lbs (15 785 kg) with 4 400 lbs (1 996 kg) PA wings
 42 000 lbs (19 051 kg) with 8 800 lbs (3 629 kg) PA wings

Load distribution

	Distributed Load	1/2 □	1/3 ○	1/4 ●
End truss	4 000 lbs 1 814 kg	2 000 lbs 907 kg	1 500 lbs 680 kg	1 000 lbs 454 kg
Middle truss	3 000 lbs 1 361 kg	1 500 lbs 680 kg	1 120 lbs 508 kg	750 lbs 340,2 kg
Center truss	6 000 lbs 2 722 kg	3 000 lbs 1 361 kg	2 250 lbs 1 020 kg	1 500 lbs 680 kg

Notes

- * Inside supports replace corresponding rigging points
- ** PA wings can be used with any rigging combination
- *** It is forbidden to attach anything to the edge truss when the corresponding FOH supports are loaded

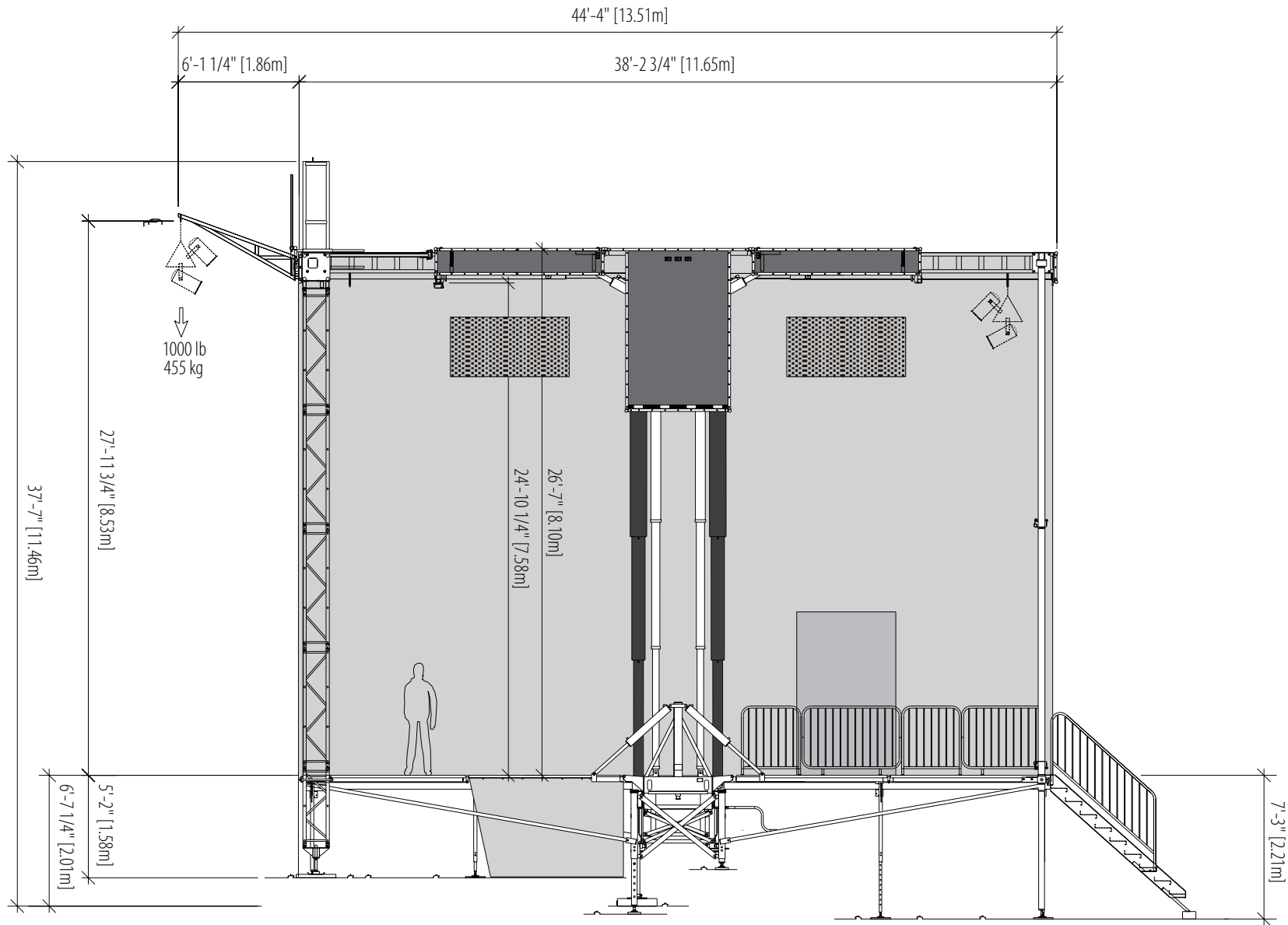

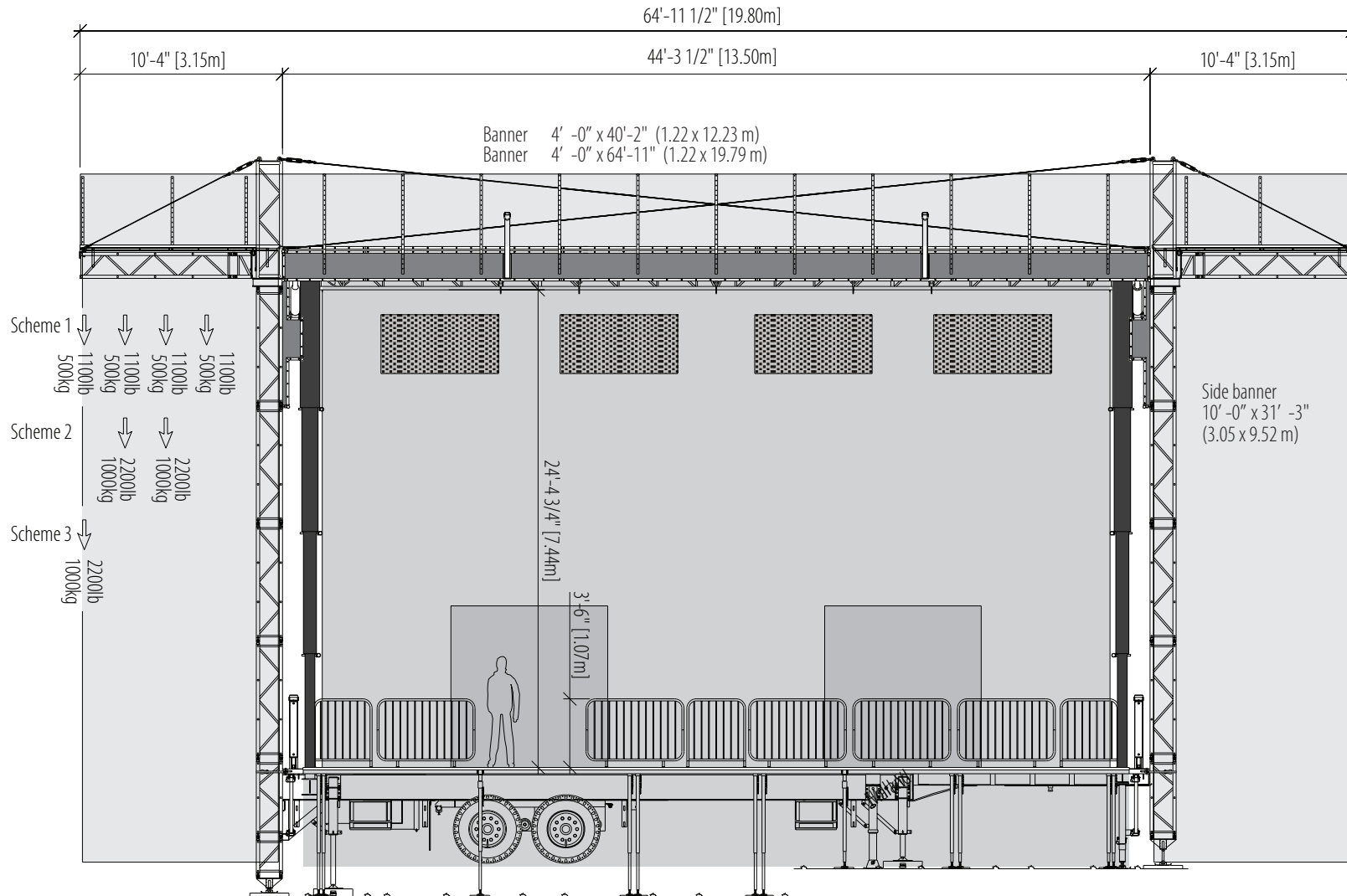

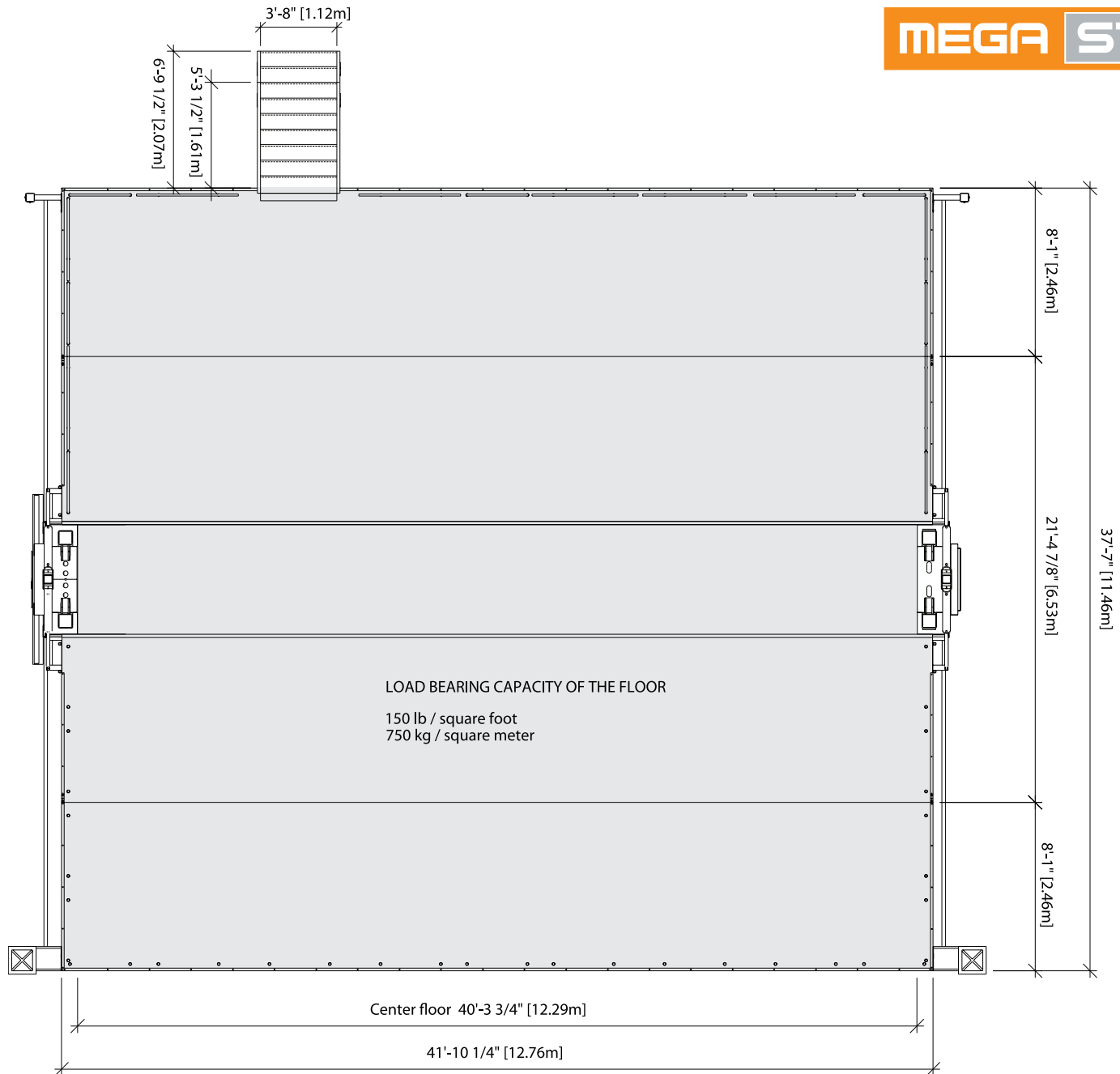

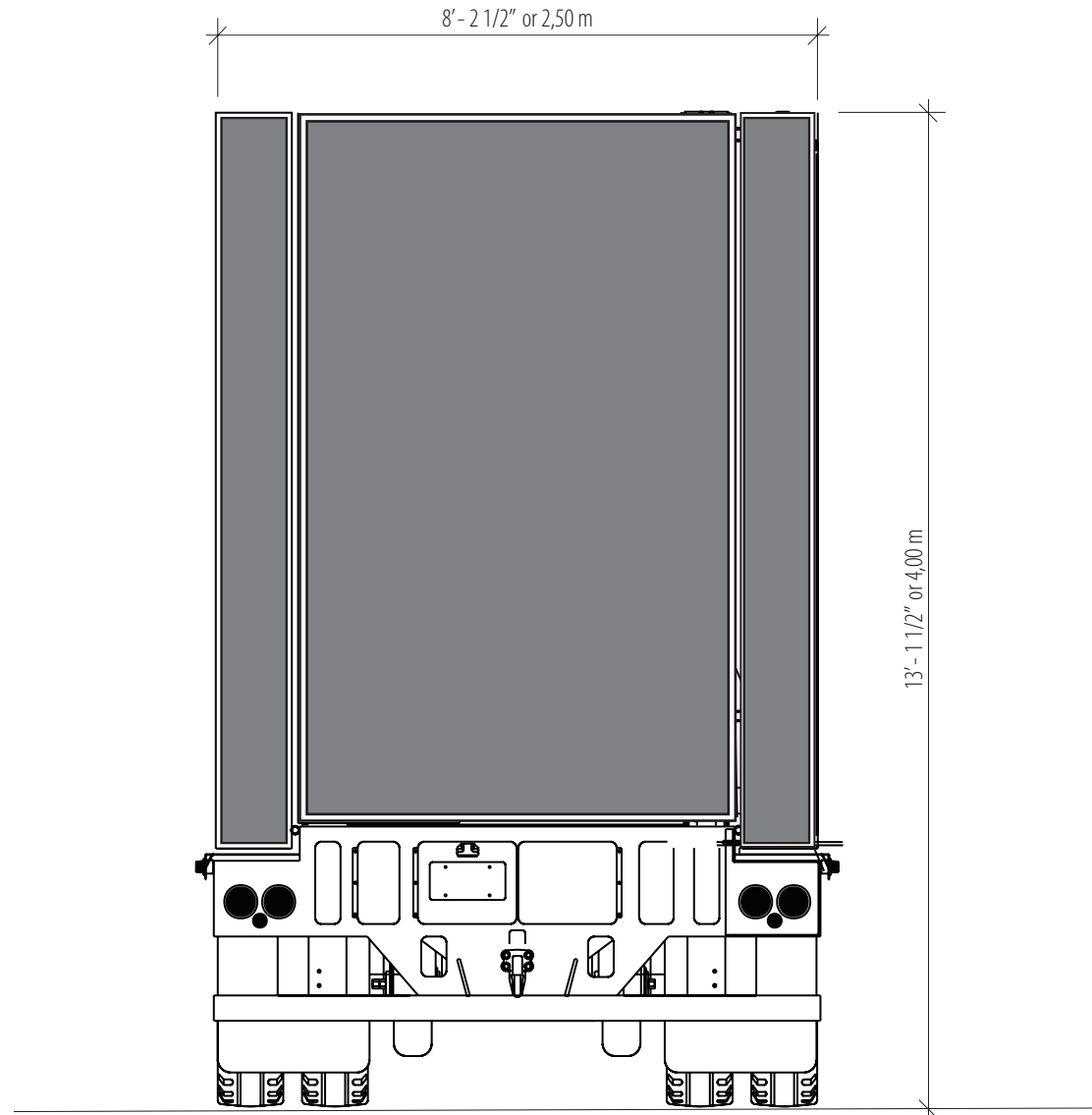

MEGA STAGE 

DYNA  STAGE[®]

Model 40 38 25

*Specifications subject to change without prior notice
©2007 Mega-Stage*