



# SMART SOCKET INSTRUCTIONS

## How to setup Smart Socket on ECO1 Smart Control

### 1 Add Socket

- 1) Click "Add" button in the room interface (see Figure 1)
- 2) Click "Smart outlet" on the add devices screen (see Figure 2)
- 3) Scan the QR code on the socket, then insert a name and click "DONE",
- 4) To test press "socket" button in the controller interface, on the socket page (as shown in Figure 3)
- 5) Click "Timer" into the timer edit page (see Figure 4&5), to setup up to 5 group timer functions.
- 6) On the socket page (as shown in Figure 3), click the power button, to control the socket ON/OFF function.
- 7) On the room interface page the socket can be also controlled by a long press on this button to control the socket ON/OFF (as shown in figure 1).
- 8) Socket also has a power monitoring feature shown at the bottom of the screen (see Figure 3).
- 9) click on the power monitoring buttons to set the power control settings (see Figure 6).

Frequency	2.4GHz IEEE 802.15.4
Voltage	85VAC - 265VAC 50/60Hz
Max Load current	10A
Operating temperature	-40° C-85° C
Operating Humidity	≤ 80%

### 2 Delete and modify the socket

Click the setting button, then click the "Equipment Management", to find the socket as shown in figure 7)

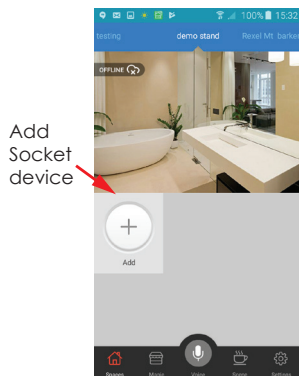

Figure 1

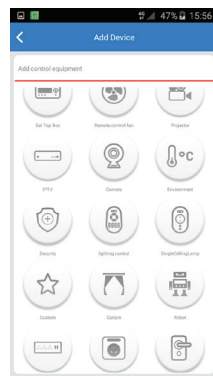

Figure 2

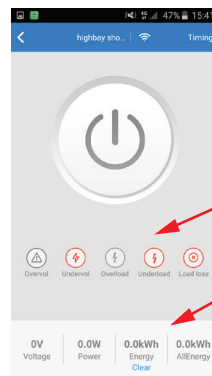

Figure 3

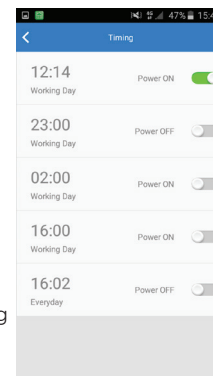

Figure 4

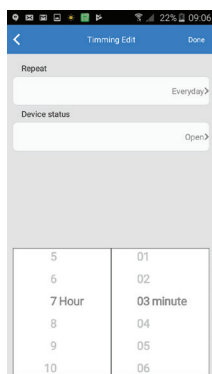

Figure 5

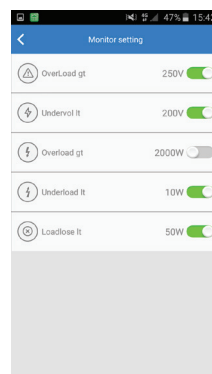

Figure 6

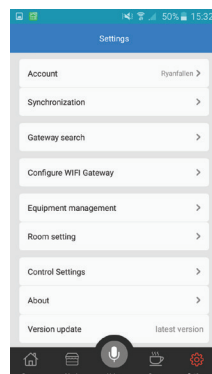

Figure 7