

EHA Enhanced Hop-up Adjustment

Step by step Installation guide

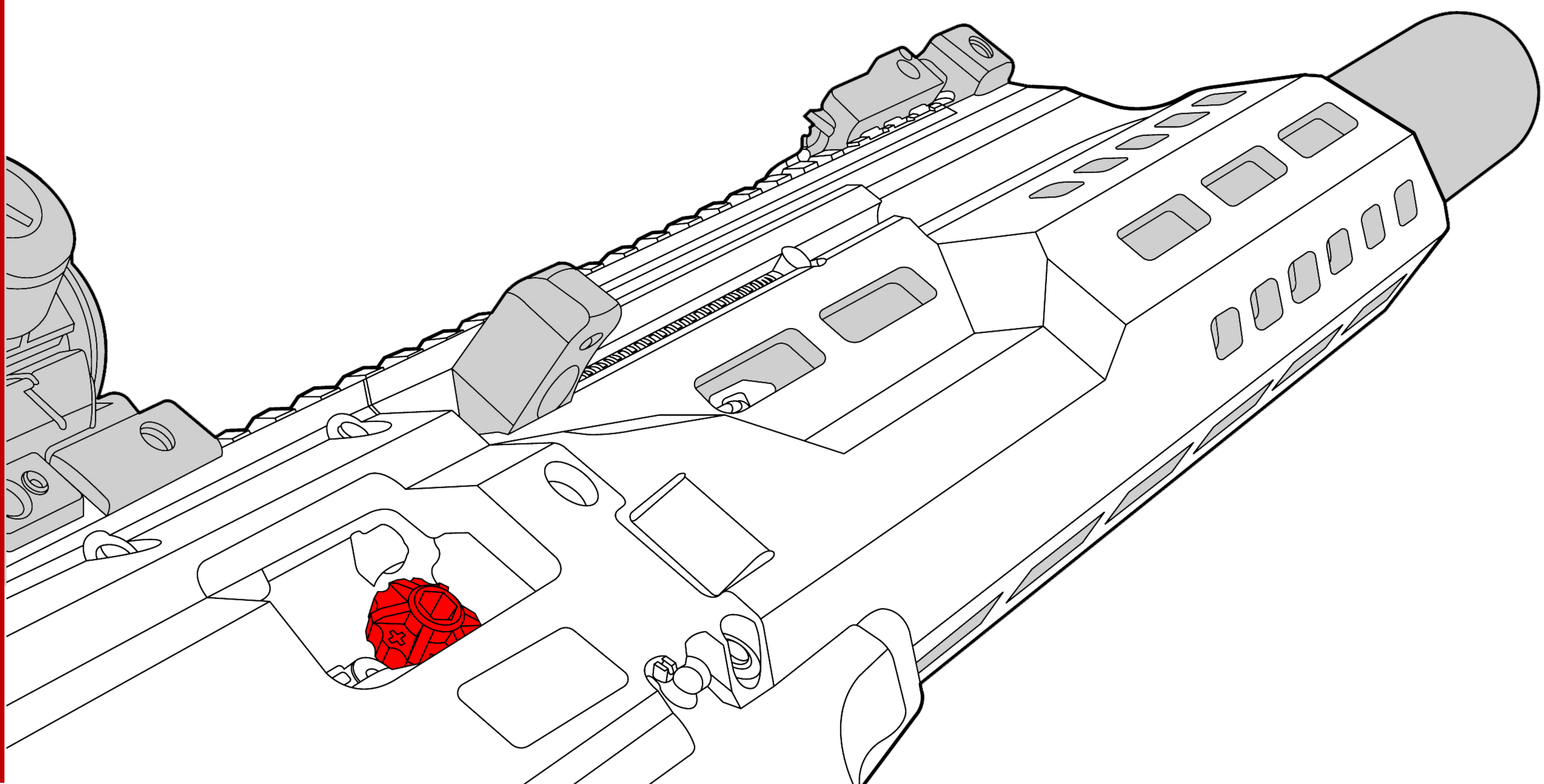

1

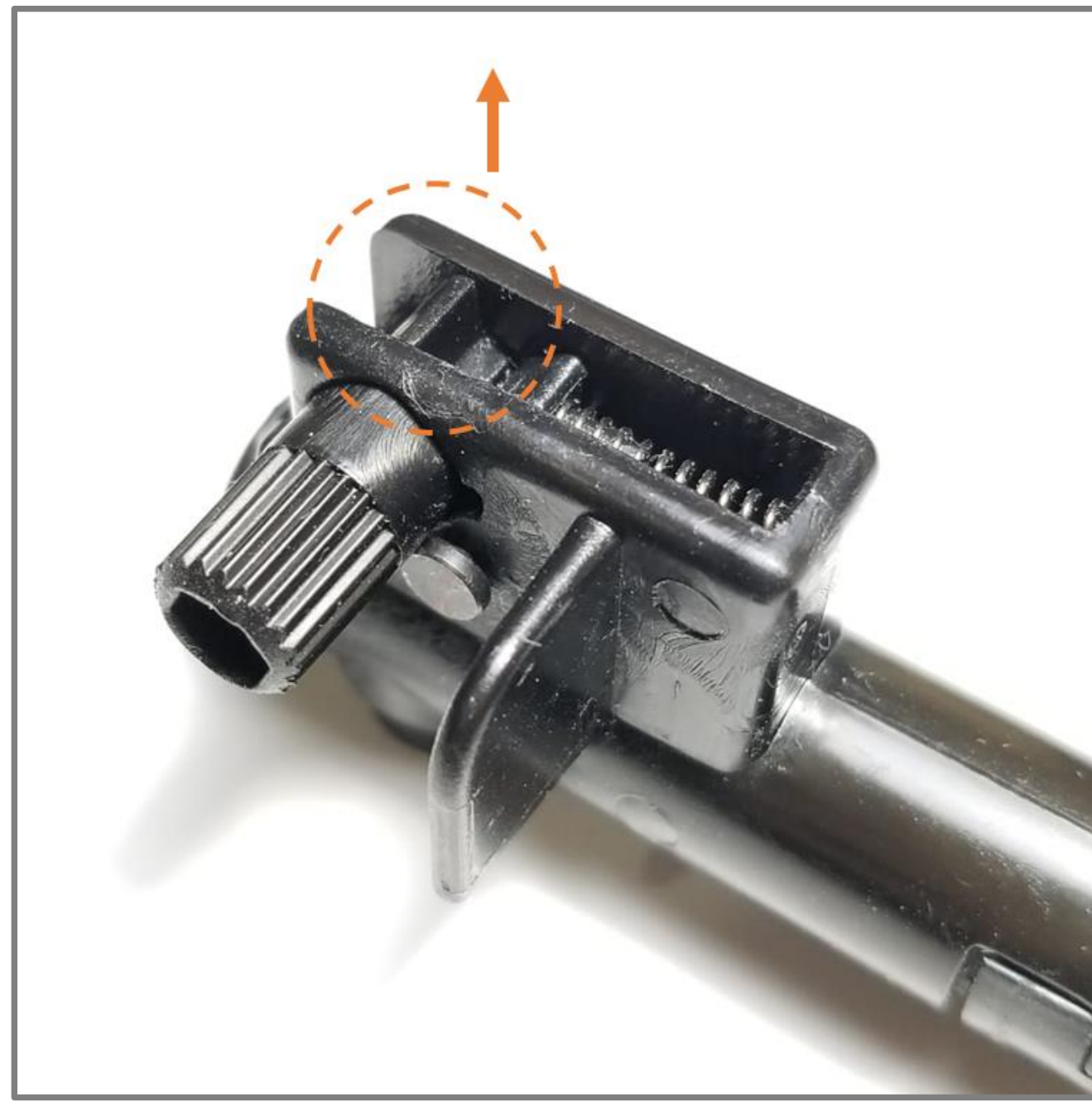

Turn the original adjustment into the neutral position. The protruding part should be facing skywards.

2



Remove the hop up arms pin. You can use a thin screw driver to punch it through.

3



Next, removing the hop-up arm. Use the screw driver to insert into the hop-up unit underneath the adjustment knob. Tilt your screwdriver and push up. The hop-up arm will then pop out easily.

4



Hop up arm removed.

5



Twist the adjustment knob 90 degrees to the right until it reaches the slot enabling it to be pulled out.

6



Insert the upgraded Airtech Adjustment knob into the hop-up unit.

Keep the barrel nub inside the hop-up unit.

7



Twist knob until the intruding part of the knob aligns perfectly with the pin hole. This will place the knob on the neutral position.

8



Insert the hop-up arm directly into the hop-up unit slot downwards. Ensure the spring is against the wall of the unit.

9



Hold/press the hop-up arm to align the holes together enough to insert the pin into place.

10



Apply pressure to ensure the whole pin is fully inserted into the hole.

11

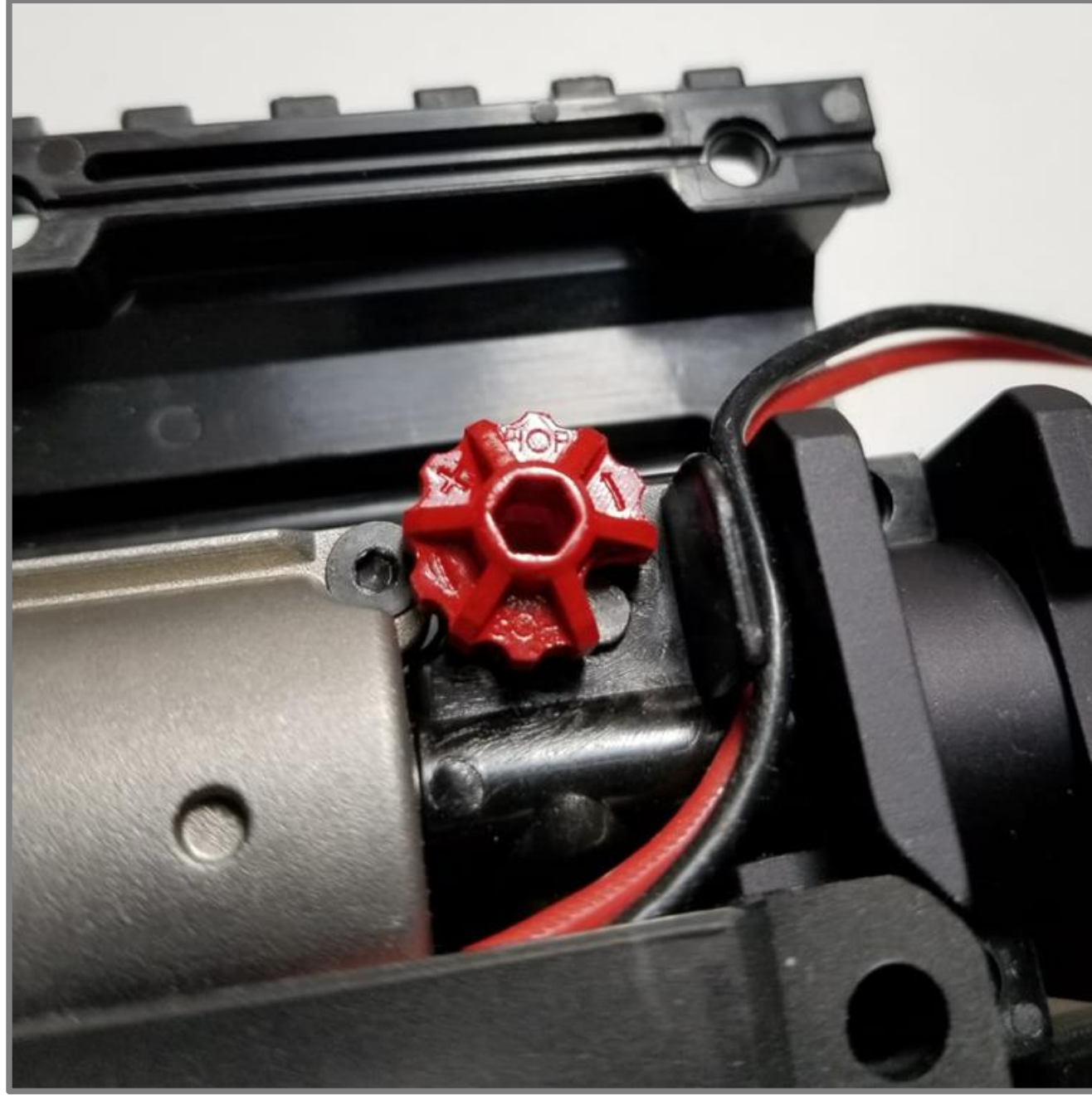

Install the whole hop-up unit with barrel back into the Scorpion Evo.

12



Congratulations! New hop-up gear installed!

