

NORMALLY APPLIES TO THESE WINCHES AND MOTORS

MOTOR 24V	2000W
WINCH MODEL	VR/C 4000
	HR4200 THOR

CHAIN METER
P/N : F80-CMAA560

NOTE:
REFER TO MUIR AUTO ANCHOR
OPERATION MANUAL FOR CHAIN
METER INSTALLATION WIRING
DIAGRAMS. THESE ARE
SUPPLIED WITH MUIR AUTO
ANCHOR KIT.

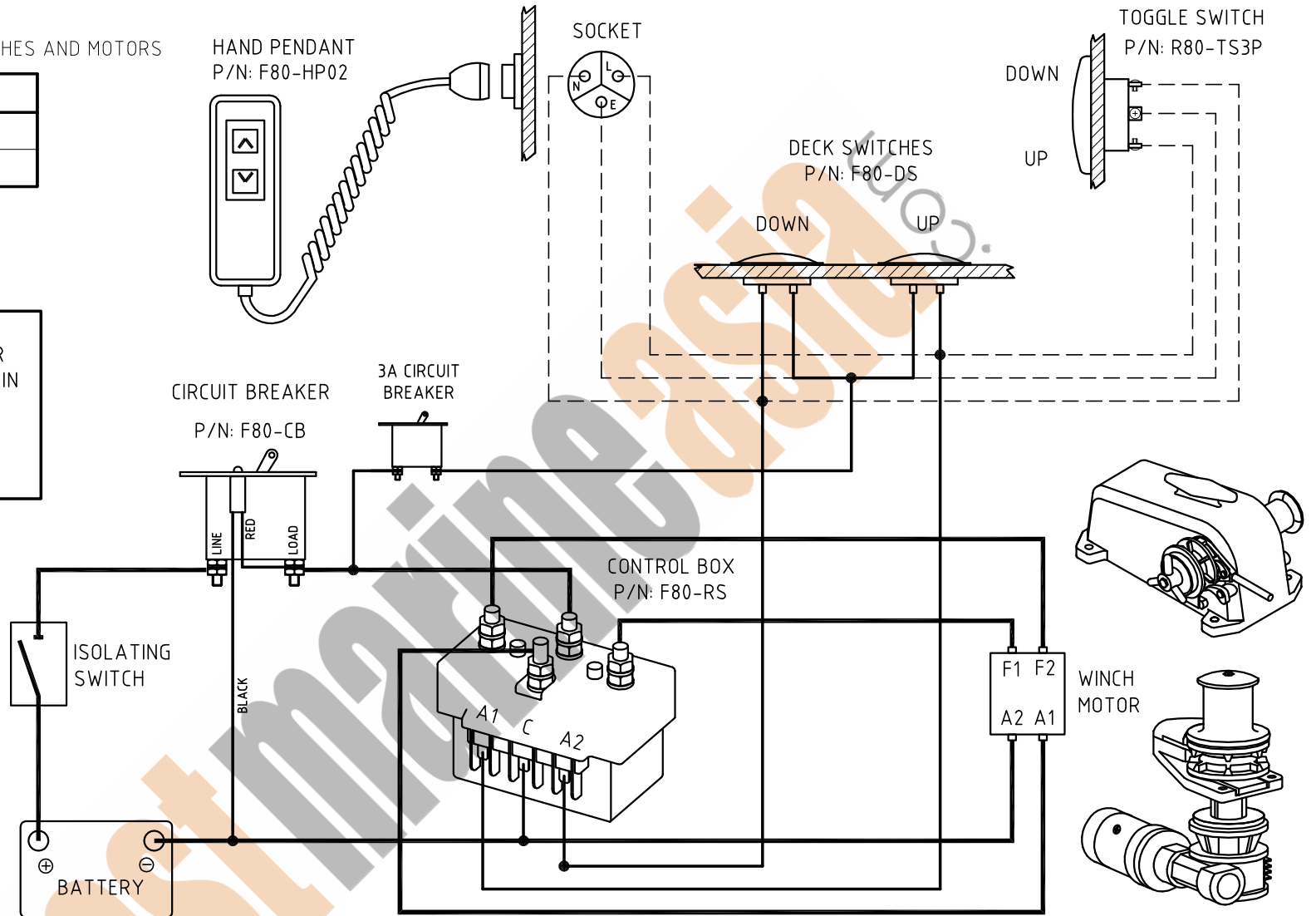

- REFER TO MANUAL FOR WIRING INDICATED BY HEAVY LINES
- LIGHTER LINES INDICATE LIGHT WIRING.
- - -** DASHED LINES INDICATE OPTIONAL WIRING.

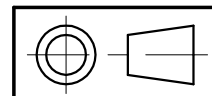

TOLERANCES (mm)	
X.	±
X.X	±
X.XX	±
UNLESS OTHERWISE SPECIFIED	
MATERIAL	
FINISH	

muir WINDLASSES AUSTRALIA			
TITLE FOUR TERMINAL MOTOR (REVERSING) WIRING DIAGRAM (POSITIVE ACTING SOLENOID)			
PART No.			
DRN JK	DATE 11/10/00	DRG No. WIRE1077	
SCALE NTS	APP1	APP2	SIZE A4
© COPYRIGHT MUIR ENGINEERING PTY. LTD.			