

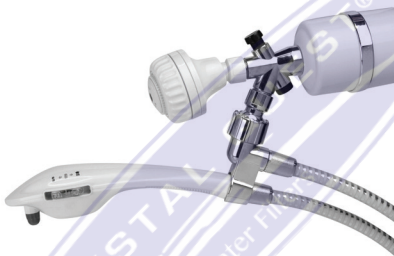

Handheld & Shower Head Combo Filter INSTALLATION AND OPERATION GUIDE



ONLINE WARRANTY INFORMATION
CrystalQuest.com/warranty.html

Copyright 2018
Crystal Quest®
All rights reserved
MADE IN THE USA



INSTALLATION INSTRUCTIONS

1. Remove existing shower head from shower arm (pipe) by unscrewing it counterclockwise (do not unscrew shower arm).
2. Install shower filter by turning clockwise onto the shower arm.*
3. Attach diverter valve by turning clockwise onto the front of the shower filter.*
4. Install the shower head by turning clockwise onto other side of the diverter valve.*
5. Attach the bracket by turning clockwise onto the other side of the diverter valve.*
6. Attach one side of the hose by turning clockwise onto the other side of the bracket.*
7. Attach the other side of the hose by turning clockwise onto the handheld shower head.*
8. Attach shower head by turning clockwise.
9. If leaks appear, tighten or reinstall.

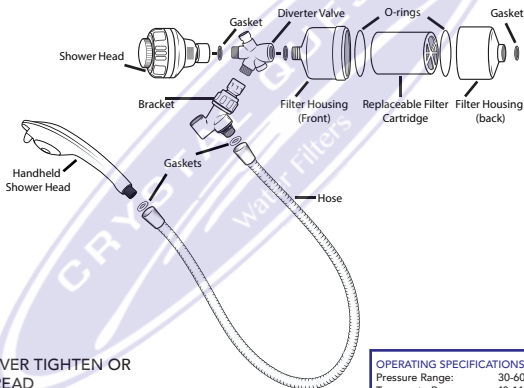

- *DO NOT OVER TIGHTEN OR CROSS THREAD
- *Thread seal tape may be required.

OPERATING SPECIFICATIONS:

Pressure Range:	30-60 psi (2.1-4.1 bar)
Temperature Range:	40-110°F (4.4-43.3°C)
Optimum Service Flow:	2-4 gpm

BEFORE ENTERING THE SHOWER

1. Activate filter by turning the shower water to "full-hot" for 3-5 minutes to flush media fines from shower filter. Loose media fines in a new cartridge are normal and will be flushed. This could require additional flushing.
2. Cool to the desired temperature before entering shower

WHEN AND HOW TO CHANGE YOUR CARTRIDGE

CARTRIDGE REPLACEMENT

1. Unscrew the shower filter from the shower arm. It may not be necessary to unscrew the complete assembly from the shower arm (Fig 1).
2. Remove the old cartridge and replace with a new cartridge.
3. Make sure both O-rings are properly seated in the O-ring grooves. Apply a small amount of lubricant, such as any non-petroleum oil (do not use coconut oil), to each O-ring (Fig 2).
4. Screw the housing back together (Fig 3).
5. Run hot water for 2-3 minutes to flush media fines from shower filter. Loose media fines in a new cartridge are normal will be flushed out when in use.



(Fig 1)

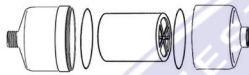

(Fig 2)

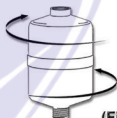

(Fig 3)

MAINTENANCE / CAUTION

Caution: Protect disc from freezing temperatures. If freezing temperatures exist, drain unit and set wet replacement disk aside to dry. Protect disk from direct sunlight. Not intended for outdoor use.

- Do not use non-Crystal Quest® replacement cartridges.
- Do not use non-Crystal Quest® parts or modify/tamper with unit.

Note: O-rings may need to be cleaned and lubricated periodically with any non-petroleum oil (do not use coconut oil).

PROBLEMS / SOLUTIONS

1. Leaking around threaded connections: Apply thread seal tape to threads
2. Leaking between two housing halves: Check that O-rings are properly seated in grooves and that housing halves are snugly threaded together. Clean any media fines.
3. Poor water flow or chlorine odor returns: Replace filter cartridge

BACK FLUSHING

1. Unscrew the filter housing.
2. The cartridge can be used inversely. Simply remove the cartridge and reverse it by turning it around.
3. Reassemble the housing as per the instructions.
4. Use as normal.

WHEN TO CHANGE FILTER

Cartridge life (approximate) is 6-12 months. Cartridge life is directly related to your water conditions and volume of water filtered. Local water conditions may require more frequent replacement.

FILTER CHANGE REMINDER

Date Installed:

____/____/____

Date to Change:

____/____/____



ONE-YEAR LIMITED WARRANTY

CRYSTAL QUEST® warrants your CRYSTAL QUEST® Dual Luxury Shower Power System for one year from the date of purchase against all defects in materials and workmanship when used in compliance with the manual. CRYSTAL QUEST® disclaims all implied warranties including, without limitation, warranties of merchantability and fitness for a particular purpose. If for any reason the product proves to be defective within one year from the date of purchase, please call for assistance. This warranty gives you specific legal rights and you may have other legal rights, which vary from state to state. CRYSTAL QUEST® assumes no responsibility for incidental or consequential damages; for damages arising out of misuse of the product or the use of any unauthorized attachment. Some states do not allow the exclusion or limitation of implied warranties or incidental or consequential damages, so the above limitations or exclusions may not apply to you. Should service be required during or after the warranty period or should you have any questions regarding how to use your CRYSTAL QUEST® Dual Luxury Shower Power System, contact our Technical Support department at warranty@crystalquest.com, Monday through Friday, 9 AM to 5 PM Eastern Standard Time.

KEEP THIS MANUAL FOR FUTURE REFERENCE AND UNIT MAINTENANCE

Online warranty information
<http://crystalquest.com/warranty.htm>

Product design is subject to change without notice.

For further assistance, contact your Crystal Quest dealer
or visit us at www.crystalquest.com

To view the latest edition of the Dual Luxury Power Shower Guide, visit CrystalQuest.com

Please note all drawings, pictures, colors and sizes are approximate for illustrative purposes only and may not exactly resemble the end product.

CQE-SP-00806



7 85084 008066

CQE-SP-00807



7 85084 200163

CQE-RC-04045



7 85084 040455