

## Technical Specifications

# TL-NS5R1S-POE

1G Network Switch with 5 RJ45 & 1 SFP - 30W PoE+

- Four 10/100/1000 Mbps IEEE 802.3at/af-compliant RJ45 PoE ports, one gigabit RJ45 port and one gigabit SFP port
- Provides up to four PoE network devices with power and data
- Total power budget of 91 watts
- Power output up to 30 watts per port
- Saves installation costs by delivering data and power over existing network cables
- Complies with the IEEE 802.3az (Energy Efficient Ethernet EEE) specification
- Mounting holes for wall mounting
- Fully NDAA-compliant

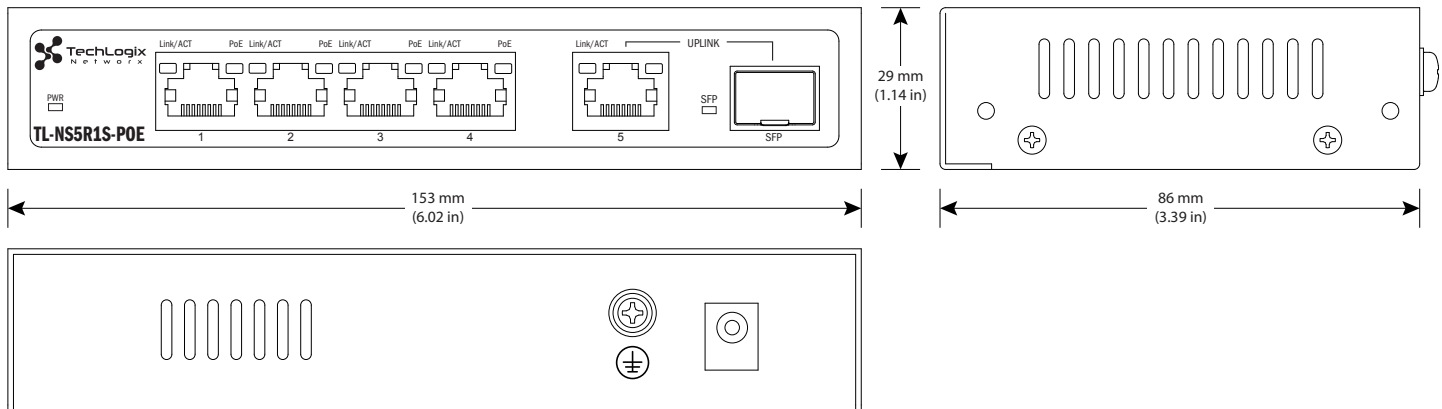

## Inputs and Outputs

Data/PD Input (Port 1)	8P8C Port (RJ45)
Data/PSE Output (Ports 2 through 5)	8P8C Port (RJ45)
DC	5.5 mm Outside Diameter, 2.6 mm Inside Diameter
LED Indicators	Device Power, Link/Activity, PoE Output, SFP

## Signal Specifications

Fiber Optic Module Support	IEEE 802.3z (Fiber Optic Gigabit Ethernet) Compliant
Supported Fiber Types	Single Mode and Multimode (Depends on the SFP Module)
Maximum Fiber Distance	Depends on SFP Module
Ethernet Port (RJ45) Support	IEEE 802.3 (10Base-T Ethernet), IEEE 802.3ab (Twisted Pair Gigabit Ethernet), IEEE 802.3af (Power over Ethernet 802.3at Type 1) IEEE 802.3at (Power over Ethernet 802.3at Type 2), IEEE 802.3az (Energy Efficient Ethernet EEE), IEEE 802.3u (100Base-TX Fast Ethernet), IEEE 802.3x (flow control, for full duplex mode)
Supported Twisted Pair Cable	1000Base-T Cat5e or higher UTP/STP RJ45
Maximum Twisted Pair Distance Input	100m (328 ft)
Maximum Twisted Pair Distance Output	100m (328 ft)
Backplane Speed	12 Gbps
Switch Architecture	Store and Forward

## Power, ESD, and Regulatory

Maximum Power Consumption	96W
Power Input (DC)	48V DC, 2A
Maximum PoE Budget (DC)	91W
Maximum Power Consumption (PD)	30W
Maximum PoE Output per Port (Budget Dependent)	30W
Regulatory	FCC Class A, CE, UKCA, NDAA

## Environmental Specifications

Operating Temperature (Environment)	0° to +40° C (32° to 104° F)
Storage Temperature (Environment)	0° to +70° C (32° to 158° F)
Operating Relative Humidity (Environment)	10% to 90% RH, Non-condensing

## Chassis Specifications

Enclosure	Steel Housing
Dimensions (H x W x D)	29mm (1.14 in) x 153mm (6.02 in) x 86mm (3.39 in)
Weight	563.7 g (2.24 lb)

## Other

Warranty	1 year
Included Accessories	1 ea US Power Cord, 1 ea Power Adapter, 1 ea Product Manual