

48" CAZO SS FIRE PIT - NARROW LEDGE

OPT-SS48FP
OPT-SS48FPEKIT

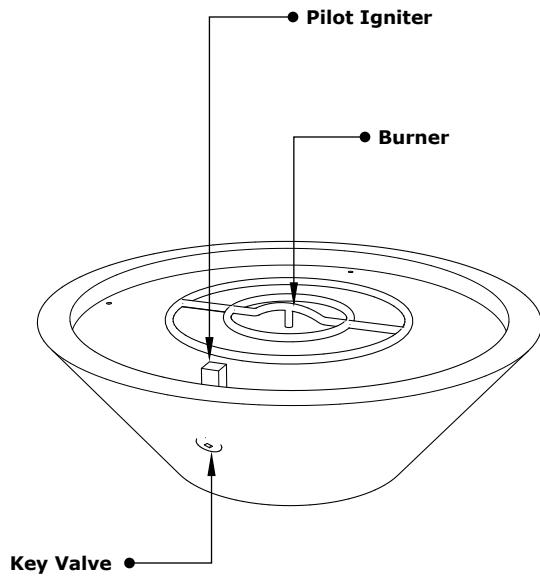

ISOMETRIC VIEW

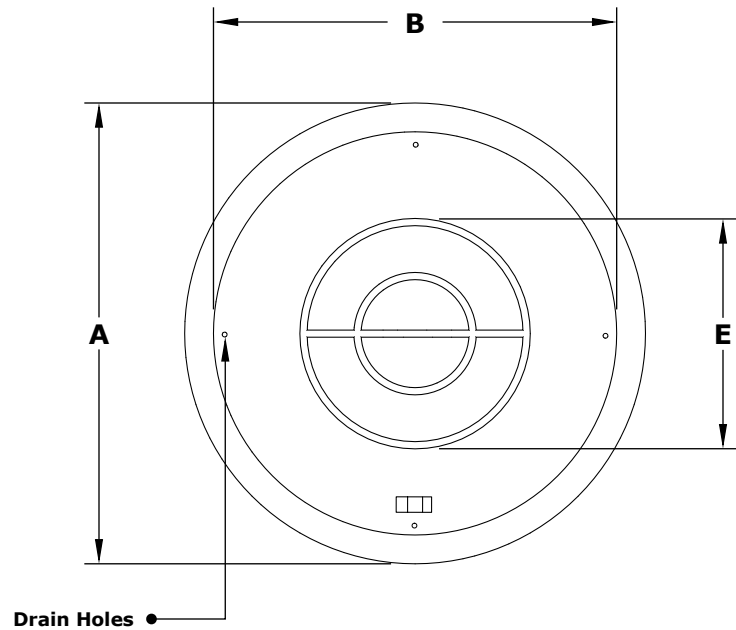

TOP VIEW

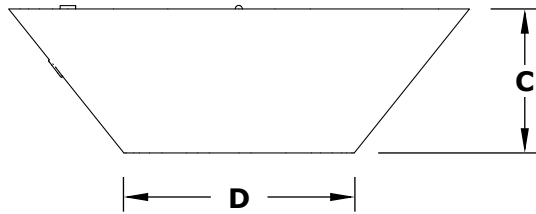

RIGHT SIDE VIEW

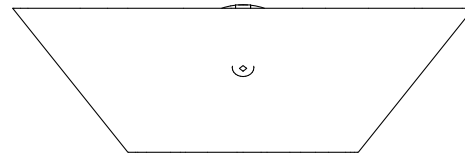

FRONT SIDE VIEW

SKU	A	B	C	D	E	BTU
OPT-SS48FP	48"	42"	15"	24"	24"	65,000

Fire Pit Material: Stainless Steel
Pan Material: 304 Stainless Steel
Burner Material: 304 Stainless Steel
Standard 2" Depth on all pans
110V ELECTRONIC IGNITION
ANSI Z21.97-(2017) / CSA 2.41-(2017)



Match Lit Unit Includes: Pan, Burner, Gas Orifice, Gas Hoses, Key Valve, Key,
110v Ignition Unit Includes: Pan, Burner, Gas Orifice, Gas Hoses, Key Valve, Key, Plug & Play Electronic Valve, Pilot Igniter.