



CHECK OUT OUR WEBSITE FOR UPDATE AND GREAT DEALS!

# PLEASE READ ALL DIRECTIONS

COMMON SENSE DISCLAIMER:

IF USED IN VEHICLE, NEVER PLACE ABOVE/ON/BELOW AIRBAG AND ALWAYS CHECK ADHERENCE BEFORE OPERATING VEHICLE.

1) REMOVE PLASTIC PROTECTIVE FILM FROM STICKY POLY PAD



QUICK TIP: IF YOU WOULD LIKE YOU MAY KEEP FILM TO PLACE BACK ON PAD. \*\*NOTE\*\* PLASTIC FILM MUST BE PLACE BACK WITH THE SAME SIDE FACING BEFORE REMOVAL OR REMOVAL AGAIN WILL BECOME DIFFICULT

2) PRESS FIRM TO ANY TABLE SURFACE TO ENGAGE ADHERENCE

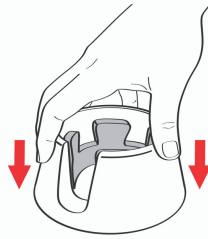

VERY IMPORTANT TIP: FOR SUPER SMOOTH SURFACES LIKE GRANITE, GLASS, OR HIGHLY COATED WITH POLYURETHANE WE RECOMMEND TAPPING THE TACKY TECH PAD TO CLOTHING OR ANY LOOSE FABRIC SURFACE TO WEAKEN GRIP. FAILURE TO DO THIS MAY RESULT IN GREATER DIFFICULTY TO RELEASE FROM TABLE OR POSSIBLE TABLE SURFACE DAMAGE

\*\*NOTE\*\* PAD GRIP CAN BE STRENGTHENED AGAIN BY WASHING WITH WATER

3) TEST GRIP STRENGTH

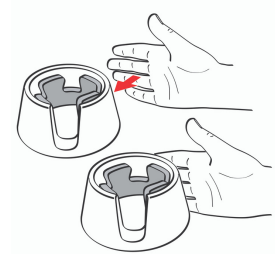

QUICK TIP: THOUGH THE CONESTER'S TACKY-TECH GRIP APPEARS AND FEELS PERMANENT, WE RECOMMEND ALWAYS TESTING ITS GRIP STRENGTH BEFORE EVERY USE.

4) INSERT SMALL CUP/GLASS

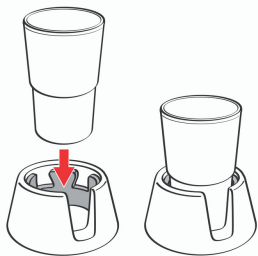

QUICK TIP: FOAM INSERT IS MEANT TO BE TIGHT. TO REDUCE FRICTION, TWIST CUP WHILE INSERTING OR REMOVING. DRINK WARE LIKE YETIS WILL BE EXTRA TIGHT, BUT INSERT WILL ADAPT WITH A FEW USES. TO BRING BACK ORIGINAL THICKNESS, SOAK FOAM INSERT IN WARM WATER TIL ORIGINAL SHAPE RETURNS

5) FOR LARGER DRINKWARE, REMOVE SNUG ZONE AND INSERT INTO BOTTOM CAVITY FOR STORAGE



QUICK TIP: SNUG ZONE INSERT CAN ALSO BE USED TO HOLD YOUR CELLPHONE HORIZONTALLY. HAVE YOUR OWN PERSONAL MOVIE THEATER AT YOUR DESK WHILE ENJOYING A CUP OF JOE. HINT: NOTCHED SIDE FACES UP AND PHONE SITS IN PLACE.

6) INSERT MUG OR LARGE CUP



QUICK TIP: COLD DRINKS WILL INCREASE TACKY-TECH PAD'S GRIP STRENGTH. WE RECOMMEND LETTING YOUR CONESTER WARM UP BEFORE REMOVAL.

7) TO RELEASE THE CONESTER'S GRIP, TWIST AND PULL

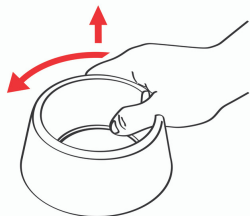

QUICK TIP: FOR BETTER LEVERAGE, PLACE ONE HAND WITHIN THE CONESTER'S HANDLE GAP. USE BOTH HANDS AND GENTLY WITH FORCE TWIST YOUR CONESTER WHILE SLIGHTLY PULLING UPWARD. FAST AND ERRATIC JERKING WILL RESULT IN DAMAGE TO THE TACKY-TECH PAD OR TABLE SURFACE

8) IF PAD BECOMES SATURATED WITH PARTICLES, RINSE AND WIPE WITH WARM WATER AND AIR DRY

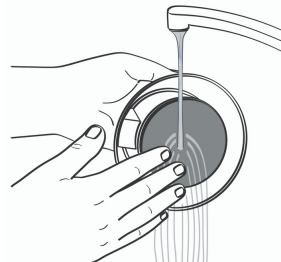

QUICK TIP: YOU MAY ALSO DRY WITH A MICRO FIBER CLOTH. STANDARD CLOTHS WILL LEAVE FIBERS ON TACKY-TECH PAD DECREASING PADS ABILITY. CLEANING WILL BE NECESSARY AGAIN.

9) IF NEEDED, STORE YOUR CONESTERS OUT OF THE WAY OF SMALL CHILDREN AND PETS

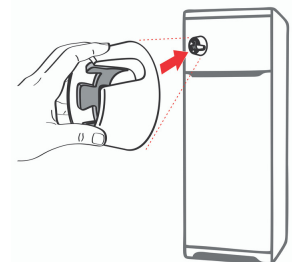

QUICK TIP: PLACES TO STORE ARE, ON THE FRIDGE, UNDER TABLE, BEHIND CABINET DOOR, OR ANYWHERE ELSE

GIVE US A GREAT REVIEW ON AMAZON! THANKS - TYLER THE INVENTOR