

# Ms RAM AIR SYSTEM

## CARBON DUCT INTAKE KIT

### Installation Instructions

FR-0329

Nissan Ergrand E51 VQ35DE

Thank you for buying the GruppeM Ram Air System

Before installation, verify that you have all of the parts in the Parts List on the right.



#### CAUTION

- Do not install on a road or other place that could interfere with automobile or pedestrian traffic.
- Park on flat, horizontal ground with the emergency brake on, to prevent the vehicle from rolling. Remove the key from the ignition and let the engine cool down completely before beginning installation.
- Wear work clothes suitable for the job. When necessary, wear protective gloves and glasses.
- After installation, regular maintenance is necessary. Periodically check for realignment, clearance, and tightening of all components.
- GruppeM Inc. will not be held responsible for installations to any motor vehicle model other than the one specified.
- Keep these instructions in a safe place after using them.

Speeding and reckless driving are completely unacceptable. Please use this product with care, following all traffic regulations.

#### PARTS LIST

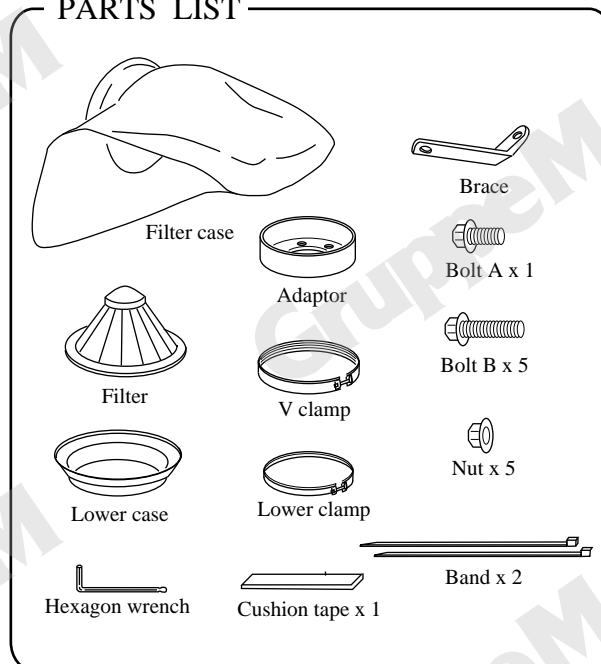

The adaptor, lower case, v-clamp and filter are presassembled

### Remove original air cleaner

- 1: Remove the introductory duct, connection pipe, and engine cover of an original air filter box.
- 2: Remove an air mass sensor from an original air filter box.
- 3: Remove the resonator in an intake hose once.

- 4: Rotate a cleaner case up and down in an engine room, and take out a air filter box, pushing and avoiding an air-conditioner hose.

\* Please take out after removing cowl top in the case of extraction is difficult.

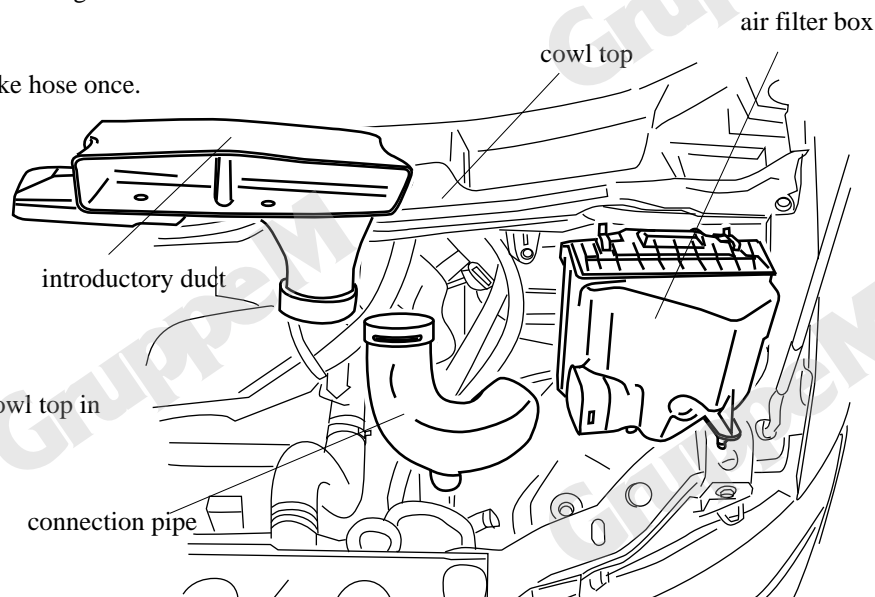

### Install Ram Air System

- 1: To an adapter, using an attached bolt, as shown in a figure, assemble air mass sensor and a brace. An original hose clip is also installed.

- 2: Install a resonator in the original position of an original intake hose.

- 3: Fix a brace to a resin bracket.

- 4: Attach a connection pipe with an original introductory duct like origin, and fix in an attached band so that it may not separate.

An engine cover is also returned.

- 5: Install a lower case in an adapter, insert a filter and install a filter case.

Because it interferes in an original introductory duct and a duct case in that case, please stick a cushion tape on the hitting portion.

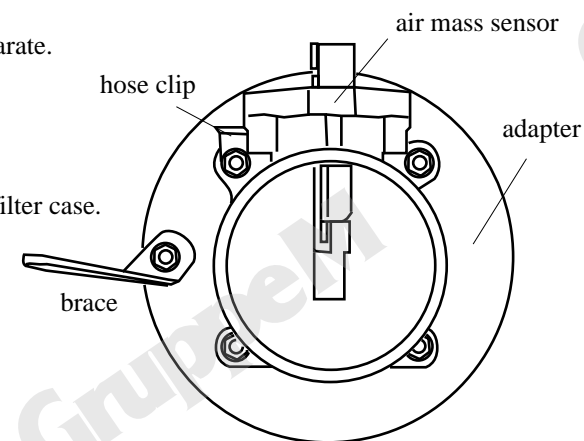

- 6: Install wiring of an air mass sensor.

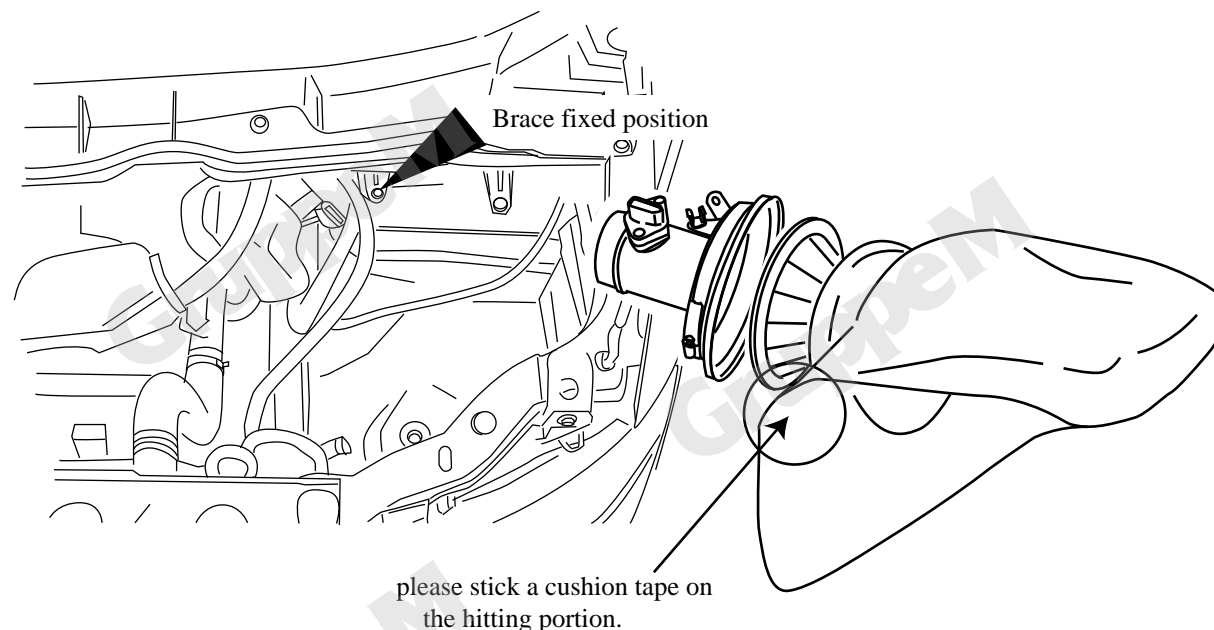

Copyright GruppeM Inc.©