

Ms RAM AIR SYSTEM

CARBON DUCT INTAKE KIT

Installation Instructions

FR-0129

LEXUS RC F (2014 -) USC10 engine: 2UR-GSE(V8-5.0L)

Thank you for buying the GruppeM Ram Air System.

Before installation, verify that you have all of the parts in the Parts List on the right.



- Do not install on a road or other place that could interfere with automobile or pedestrian traffic.
 - Park on flat, horizontal ground with the emergency brake on, to prevent the vehicle from rolling. Remove the key from the ignition and let the engine cool down completely before beginning installation.
 - Wear work clothes suitable for the job. When necessary, wear protective gloves and glasses.
 - After installation, regular maintenance is necessary. Periodically check for realignment, clearance, and tightening of all components.
 - GruppeM Inc. will not be held responsible for installations to any motor vehicle model other than the one specified.
 - Keep these instructions in a safe place after using them.
- Speeding and reckless driving are completely unacceptable. Please use this product with care, following all traffic regulations.

PARTS LIST

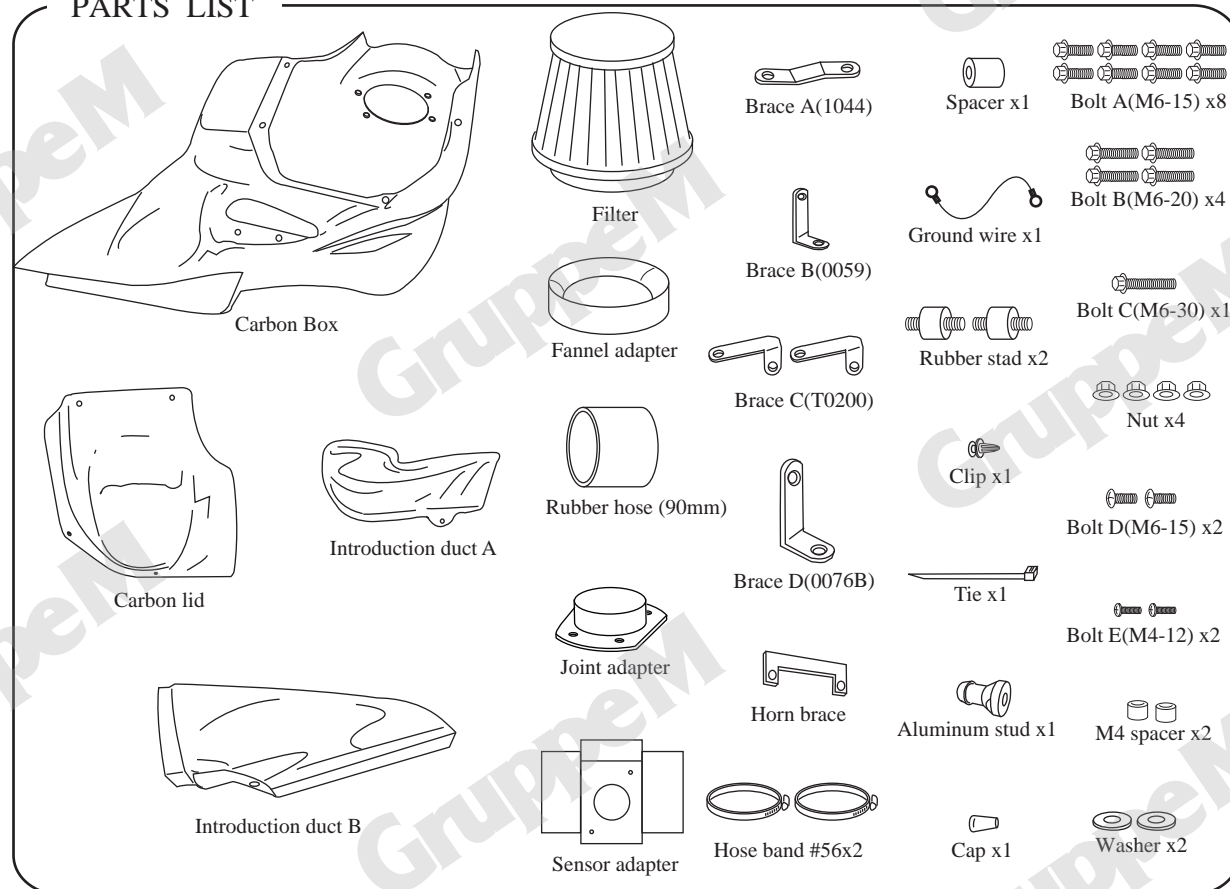

Installation of ram air system



1. Remove the vacuum hose.



2. Remove the sensor connector.
Loosen the suction hose band.



3. Remove the front panel.



4. Remove the introduction duct.



5. Remove the solenoid valve connector.

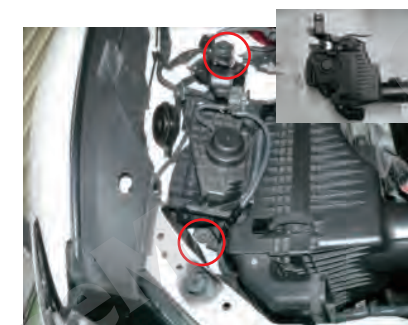

6. Remove the two bolts circled in red and remove the box.

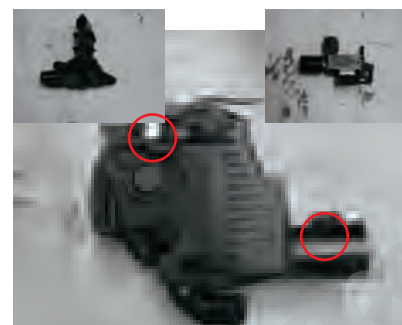

7. Remove the sensor and solenoid valve from the box.



8. Remove the horn and horn bracket.



9. Remove the side panel.



10. Cut the side panel as seen here, using the attached pattern.



11. Attach the cut panels to the vehicle.



12. Attach the vacuum cap to the vacuum hose from the engine circled in red.

Installation Instructions

FR-0129

Installation of ram air system



13. Attach the rubber stud to the brace A using a nut.



14. Attach the brace with bolt A at the angle as pictured.



15. Attach the rubber stud to the body.



16. Fix the ground wire between in the horn brace and the horn with the original nut.



17. Put a spacer in the position circled in red and fix the horn using Bolt B. Attach the horn's connector.

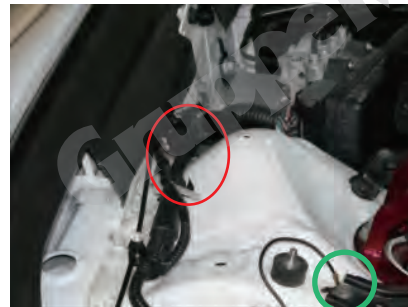

18. Connect the connector to the solenoid valve and fix it with a tie to the red circle mark. Fix the ground wire at the green circle.

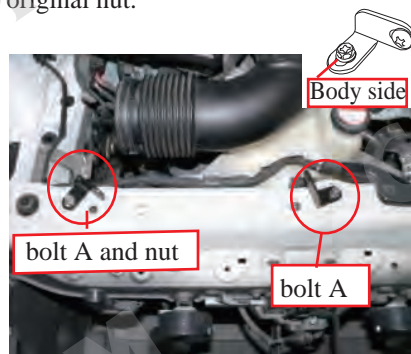

19. Attach two braces C using the bolt A and nut to the photo position



20. Install brace B using bolt A



21. Secure the aluminum stud to the carbon box using bolt C.



22. Attach the joint adapter and funnel adapter to the carbon box using bolt A.



23. Attach the rubber hose to the joint adapter.



24. Sandwich the M4 spacer between the sensor adapter and install the sensor with bolts E.



25. Attach the sensor adapter to the rubber hose. Please pay attention to the direction of the maf sensor.

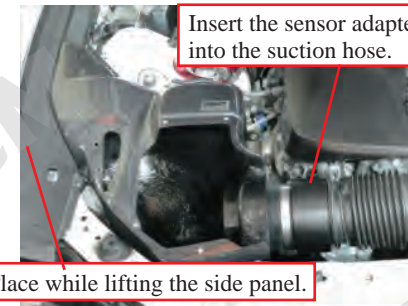

26. Place the carbon box ASSY in the vehicle.



27. When inserting the aluminum stud into the grommet of the body, fine adjust the brace so that the bolt of the rubber stud enters into the hole of the red circle. Fix the brace after adjustment and secure the carbon box with a nut.



28. Fix the rubber stud and the carbon box with brace D using bolts B and nuts.

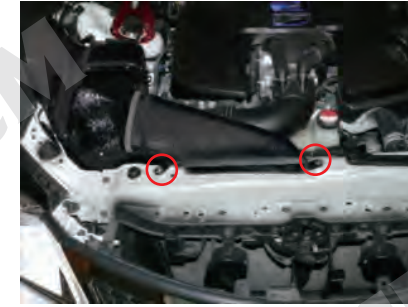

29. Fix the introduction duct B with bolt D.



30. Fix the original clip in two places using the washer on the front side panel.



31. Replace the front side panel.

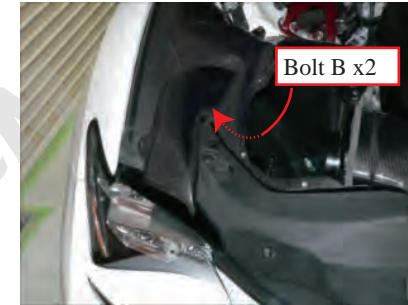

32. Fix the introduction duct A from inside the carbon box using bolt B.



33. Drill a φ5.5mm hole in the side panel.



34. Attach the clip to the opened hole.



35. Install the filter.



36. Install the carbon lid. Attach sensor wiring bracket to brace and connect coupler.

Installation Instructions

FR-0129

Side panel cut pattern paper

1. Cut along the line.
2. Trace the cut pattern paper on panel.
3. Mark the cut line on the side panel in reference to the paper pattern.
4. Cut the side panel along the cut line.



Before



After

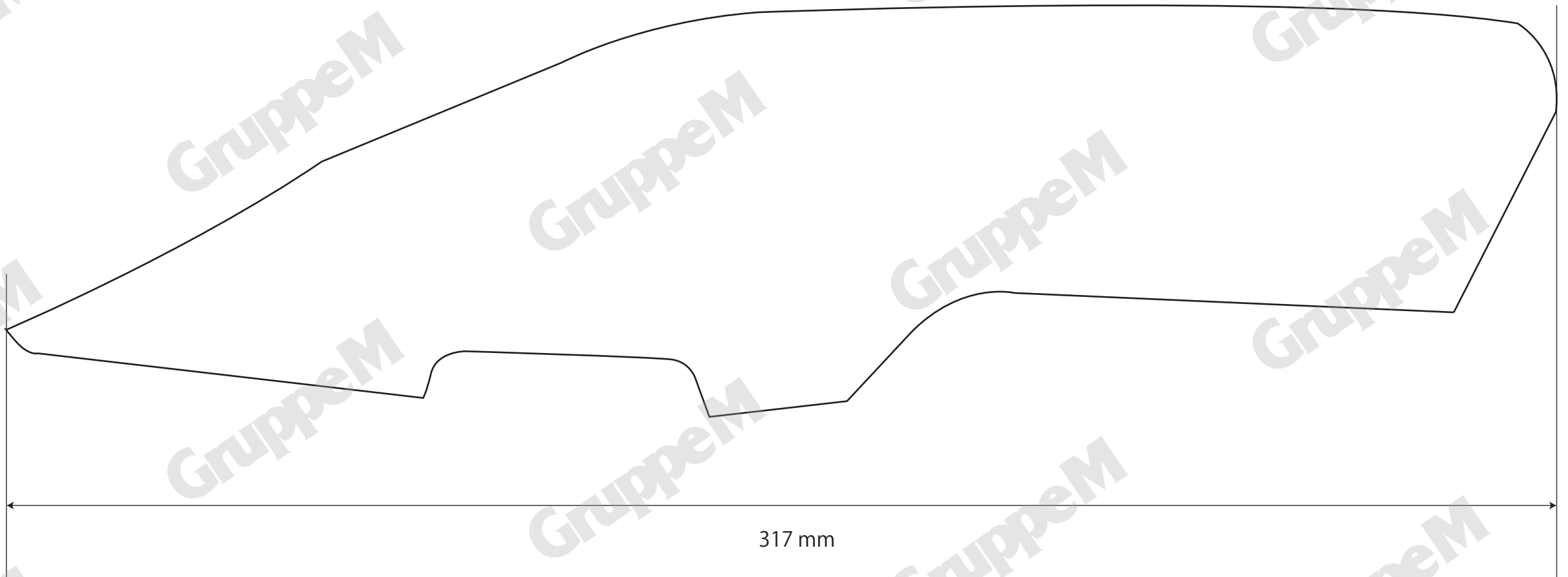

317 mm