

# Ms RAM AIR SYSTEM

## CARBON DUCT INTAKE KIT

### Installation Instructions

FR-0039

BD5/BG5 Legacy RS/GT EJ20R (M/T 280ps)

GC8 Impreza STI EJ20R ('96.09~)

Thank you for buying the GruppeM Ram Air System

Before installation, verify that you have all of the parts in the Parts List on the right.



#### CAUTION

- Do not install on a road or other place that could interfere with automobile or pedestrian traffic.
- Park on flat, horizontal ground with the emergency brake on, to prevent the vehicle from rolling. Remove the key from the ignition and let the engine cool down completely before beginning installation.
- Wear work clothes suitable for the job. When necessary, wear protective gloves and glasses.
- After installation, regular maintenance is necessary. Periodically check for realignment, clearance, and tightening of all components.
- GruppeM Inc. will not be held responsible for installations to any motor vehicle model other than the one specified.
- Keep these instructions in a safe place after using them.

Speeding and reckless driving are completely unacceptable. Please use this product with care, following all traffic regulations.

#### PARTS LIST

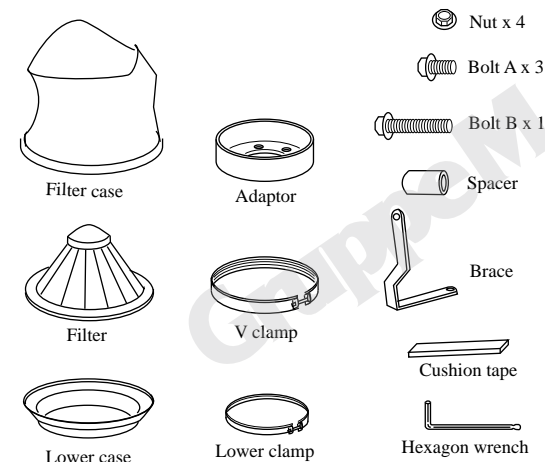

The adapter, lower case, v-clamp and filter are preassembled

### Remove original air cleaner

1. Remove the mass air sensor electrical connection, then remove the original air cleaner together with the original air cleaner case.  
(Remove together with the mass air sensor assembly. Save the bolts for reuse during installation.)
2. When you install the original inlet air duct it would rub against the filter case, so remove the bolt as shown in the illustration below and push the original inlet air duct in.  
(If you remove the bolt inside the fender, you can completely remove the original inlet air duct assembly.)

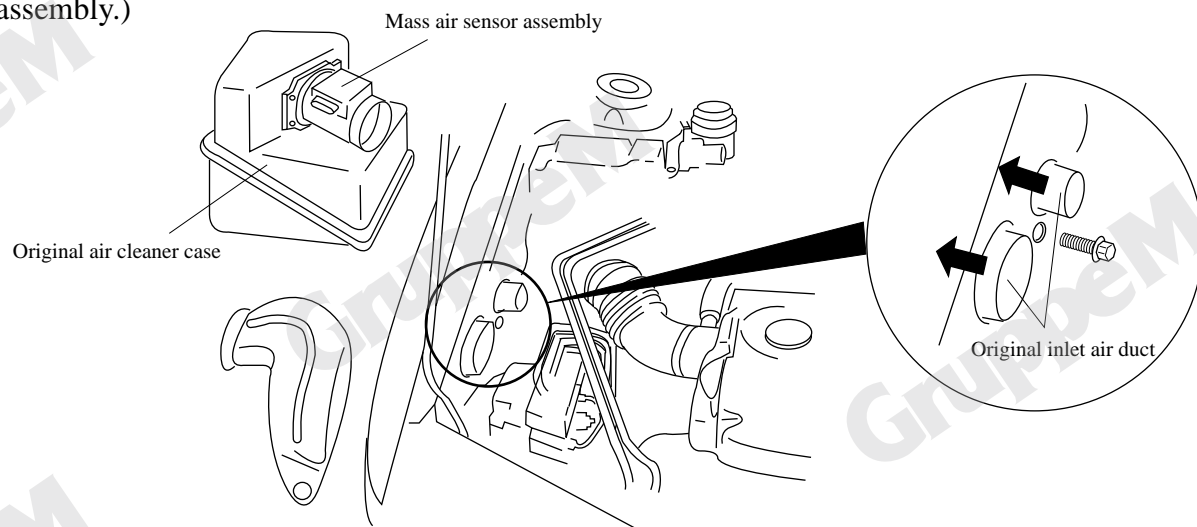

### Install Ram Air System

Note: To make each operation easier, first, assemble all parts together loosely. Only tighten after you are sure their positioning is correct.  
If the duct rubs against the part of the engine, or body, please attach the cushion tape.

1. Assemble the mass air sensor assembly, lower case, adaptor and brace.

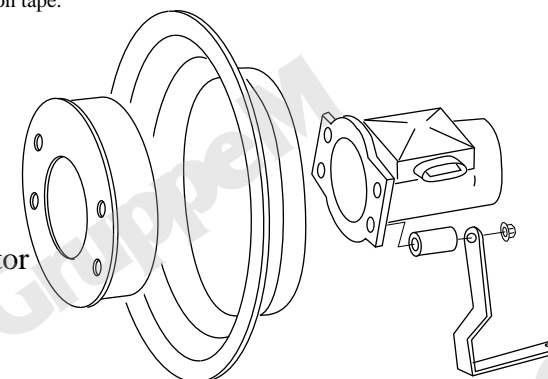

2. Return the mass air sensor assembly (with the adaptor and brace attached) to the original intake pipe.

3. Attach the brace to the body, using the bolt and bolt hole that were used to attach the original air cleaner case.

(If the car has an anti-lock braking system[ABS], pass the brace under the ABS wiring, then fasten the brace to the car body.)

4. Attach the filter and filter case to the adaptor assembly, then tighten with a clamp.

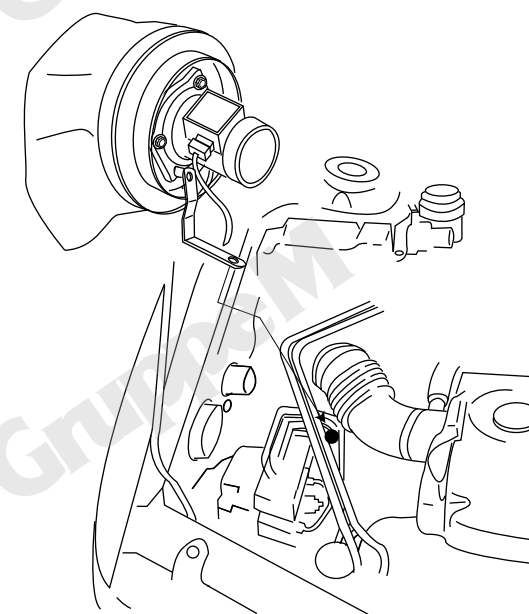

Copyright GruppeM Inc.©