

WARNING:

If used in a bathroom Mango Mirror must be plugged into a Ground-Fault Circuit-Interrupters (GFCI) outlet.

Mango Mirror should not be used in an environment with consistent high humidity.

RISK OF ELECTRIC SHOCK. DRY LOCATION USE ONLY.

Failure to follow this warning could result in serious injury and electrocution from electrical shock.

Package Contents:

- (1) Mango Mirror (Glass mirror with attached metal frame and power chord)

Wall mounting Hardware pouch containing:

- (1) Wall -Hook
 - (2) Drywall Anchors
 - (2) Screws
- (1) General Installation Instruction document

Preparation

Tools required for assembly: (Not Included)

- Pencil
- Screwdriver
- Level
- Tape measure
- Safety glasses

Important: When choosing your location, please ensure that the power adaptor cable will reach your power outlet when installed.

For online version of installation document and video please visit:

www.mangomirror.com/pages/installation



CAUTION:

Anchors are for drywall surfaces only. Use tile anchors for tile surfaces. (not included)

Two people are required to safely install this mirror. The mirror will break if dropped. Take extra precautionary measures to ensure a secure grip on the parts.

Installation Steps:

1. Once the location and height of the mirror has been determined, place the wall-hook on the wall as shown below. Position it over wall studs when possible for the most secure installation. Use a level (not included) to ensure the wall-hook is level. Mark the position for the screws holes with a pencil through the center of the two holes.

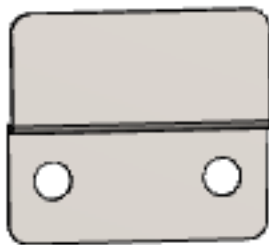

Wall-hook
Front view

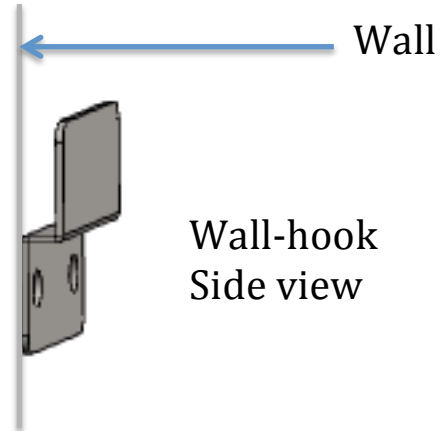

Wall-hook
Side view

2. Put aside wall-hook. If no studs are found on marked positions, use the screwdriver to install self-drilling drywall anchors on all marked positions. For your safety please ensure that anchors are installed correctly. If damaged, please replace with appropriate wall anchors rated for at least 50 lbs, before continuing.

3. Place the wall-hook against the wall; line up the holes against the anchors against the wall. Insert the screws into the wall-hook holes and the wall anchors (or directly into wall studs if applicable) and then tighten firmly with a screwdriver. For your safety please ensure that the wall-hook is firmly secured and tightened against the wall.

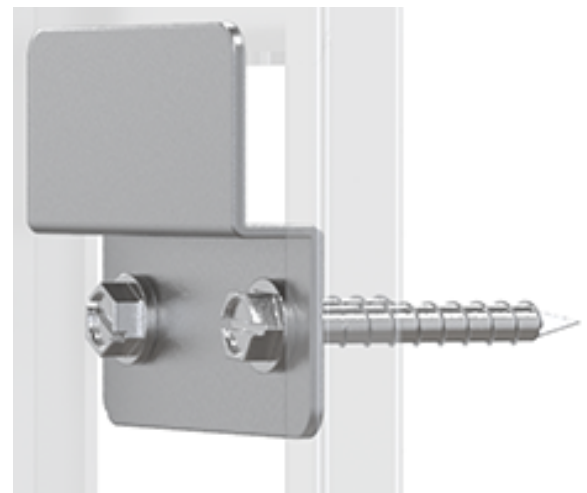

4. Mirror is heavy; two people should carry the mirror. Based on your power outlet placement, decide on which side to hold the power plug as you carry the mirror.

Ensure that the motion sensor ring is to the bottom right facing out towards you. Then place the mirror back metal brace against the wall and lift it up so that the wall-hook is inserted in the slot in the back metal brace. The back metal brace must be flush against the wall. Then gently lower the mirror so that the metal brace slot top sits into the wall hook, holding the mirror in place.

Once complete. Check to confirm that the mirror is correctly and completely flush against the wall, is hanging on the wall-hook and being held securely in place, before letting go of the mirror.

5. Plug the power adaptor into the power outlet and follow the instructions on the mirror display and use your mobile app as instructed, to setup Mango Mirror.

