

THE ART OF PRECISION

Hintergrundwissen, Konstruktion & Bedienung

ZEISS VICTORY SF



IT TOOK 160 YEARS TO DESIGN BINOCULARS THAT ARE FASTER,
BRIGHTER, WIDER AND MORE ERGONOMIC THAN ALL PREVIOUS
BINOCULARS USED FOR BIRDING AND NATURE OBSERVATION.

THIS BOOK EXPLAINS WHY **ZEISS VICTORY®SF** IS A UNIQUE
MASTERPIECE OF OPTICAL PHYSICS, ENGINEERING INGENUITY
AND SUPERB CRAFTSMANSHIP.

IT ALSO REVEALS THE BEST WAY TO CAPTURE COUNTLESS
BREATHTAKING MOMENTS IN NATURE WITH THESE BINOCULARS.

WELCOME TO THE ART OF PRECISION.



// FASCINATION
MADE BY ZEISS

Background information, design & operation
ZEISS VICTORY SF



CONTENTS

STANDARDS	7
BACKGROUND INFORMATION.....	9
DESIGN	13
SMART FOCUS CONCEPT	15
TRIPLE-LINK-BRIDGE	17
ERGOBALANCE	21
ULTRA-FL	27
T* COATING	29
PRISM SYSTEM.....	31
FIELD FLATTENER	33
MADE IN GERMANY.....	35
VICTORY SF BIRDING	39
VICTORY SF HUNTING.....	43
TECHNICAL DATA	50
ACCESSORIES	52
CONTACT.....	56

STANDARDS
Simply the best



The world's best birding and wildlife observation binoculars.

The VICTORY SF models 8 x 42 and 10 x 42 reveal images with previously unimagined brilliance and crisp, clear details. Designed in line with the new Ultra-FL concept and featuring high-transmission (HT) lenses, these binoculars impress with extra-wide fields of view, sharp focus all the way to the edges, and a close focus that makes it possible to experience every fascinating moment of objects just a short distance away.

An innovative ergonomic system was developed especially for the new ZEISS VICTORY SF – consisting of the new ErgoBalance concept, the anti-slip, shock-absorbing rubber armour, and the SMART FOCUS concept (SF). This allows for quick, precise focusing and relaxed viewing.

Optical quality

Field of view
Sharp focus to the edges
ZEISS Field Flatteners technology

PERFORMANCE

Balance
Focusing speed & grip
Space for the hand

Ergonomics

Maximum weight
less than 800 g for
42 mm binoculars

Weight

» *The SFs were an **absolute pleasure to watch birds** with, delivering that sort of ›**second-pair of eyes**‹, ›**walk-into**‹ image that only the very best binoculars can. «*

MIKE WEEDON BIRD WATCHING MAGAZINE JULY 2014

» *With its outstanding optical performance data, this new VICTORY SF impresses a lot. Once again for the last two years, ZEISS has realized a unique sport optics product. These new VICTORY SF will surely be a **winner in the field!** «*

DOMINIQUE CZERMANN FRANCE AUGUST 2014

» *Overall, the SF's are awesome. **I can easily say they are the best all-around binoculars I've used.** Congrats to the team at ZEISS.«*

JESSIE BARRY CORNELL LAB OF ORNITHOLOGY JUNE 2014

» *There is no reason why a birder looking for the best binocular available wouldn't consider and likely **fall in love with the VICTORY SF's.** «*

BEN LIZDAS EAGLE OPTICS JULY 2014

» *Optically, ergonomically and aesthetically, **a new benchmark** among its peers. «*

CHRIS PARKIN ENGLAND AUGUST 2014



SF = SMART FOCUS

- SMART FOCUS concept 1
- Triple-Link-Bridge 2
- ErgoBalance concept 3
- Anti-slip texture 4
- Magnesium housing 5

- 6 Ultra-FL lens system
- 7 Seven-lens eyepiece with ZEISS
Field Flatteners technology
- 8 SCHOTT fluoride glass
- 9 Comfort view
- 10 120 m (10 x 42) & 148 m (8 x 42) field of view over 1,000 m
- 11 1.5 m close range
- 12 ZEISS T* and ZEISS LotuTec® coatings

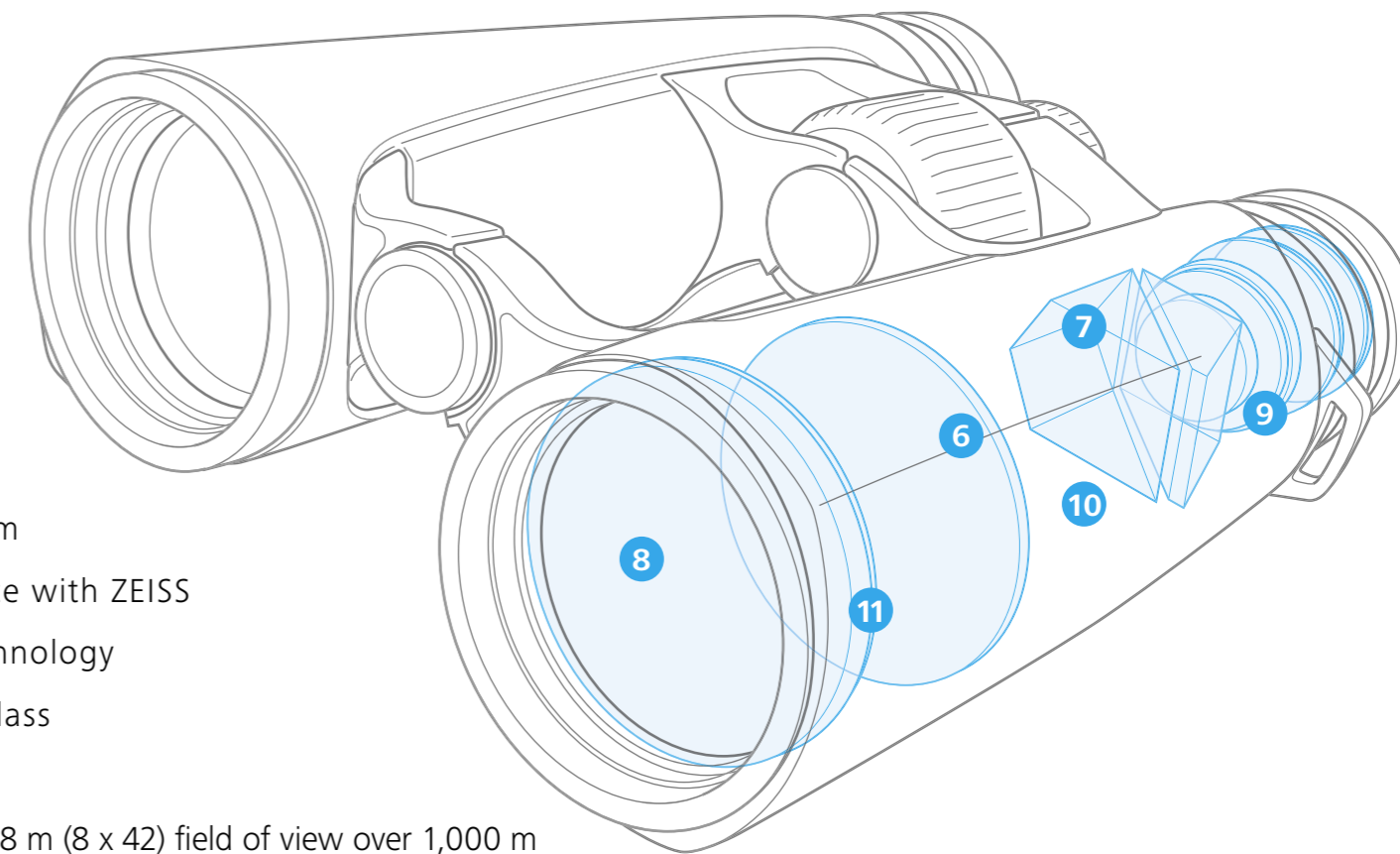





Being able to focus quickly on fast-moving objects at different distances is essential when birdwatching. The SMART FOCUS concept allows you to respond quickly and intuitively thanks to the improved focusing speed. The ErgoBalance concept guarantees a natural grip. The newly designed and innovative anti-slip texture on the focusing wheel allows for easy, precise focusing – for the greatest possible comfort and steady grip.

SMART FOCUS CONCEPT

Fast focus

More grip:
Anti-slip texture

Please touch!





TRIPLE-LINK-BRIDGE Perfectly ergonomic

The newly developed Triple-Link-Bridge design offers the best grip for relaxed, natural viewing. The anti-slip texture provides the secure grip needed when using the embedded focusing wheel, which sits directly above the hand. The outstanding ergonomics of the new VICTORY SF allows a comfortable grip without the need to overextend the fingers.

The development focused on the most important operating element of the binoculars – the focus. The precise SMART FOCUS (SF) helps the user's hand and eye find the perfect focus in a flash. Just 1 $\frac{3}{4}$ rotations cover the range of 1.5 m to infinity.

Differences in a person's vision between the left and right eyes are balanced out using the diopter adjustment up to plus/minus four diopters. The setting is lockable to avoid any unintended movement.

Focus with ease

Competitors

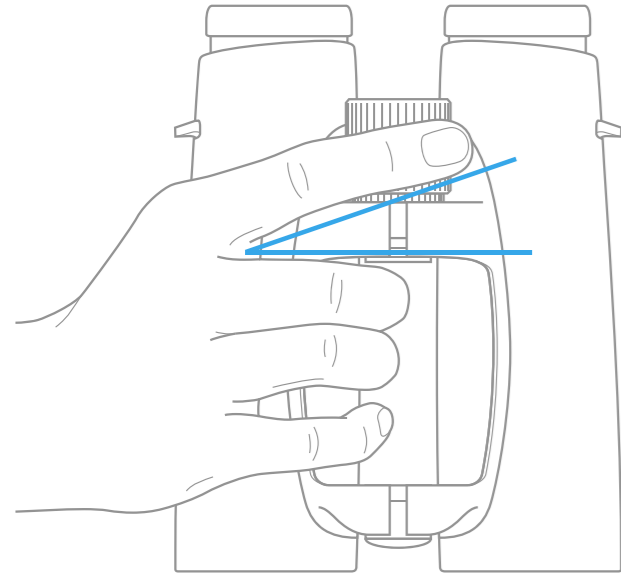

ZEISS VICTORY HT

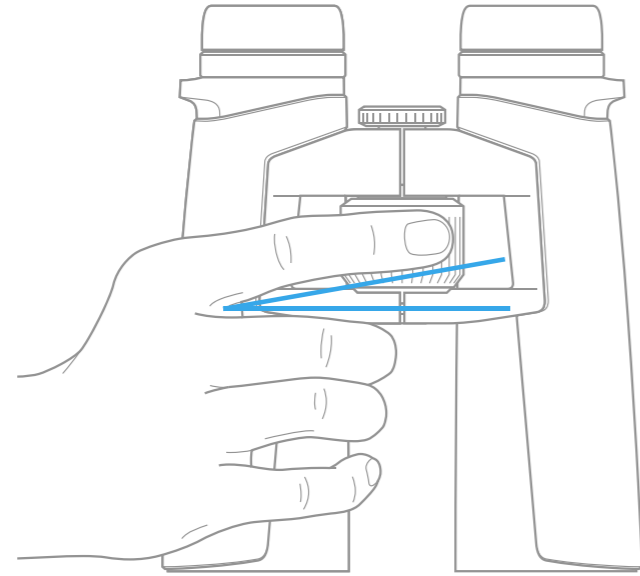

ZEISS VICTORY SF

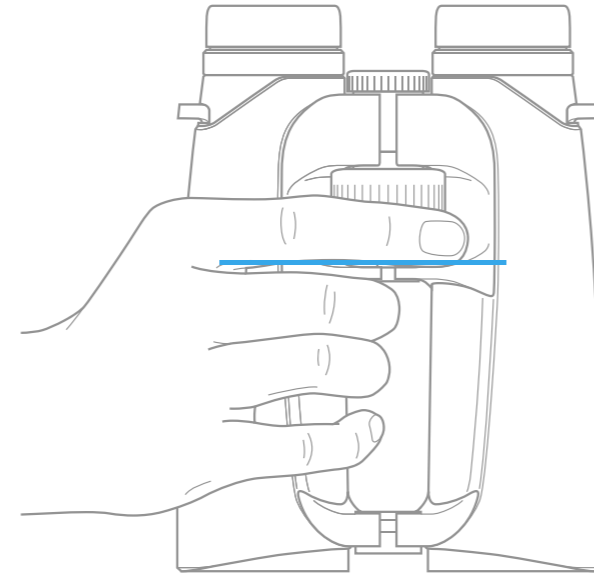

Perfect ergonomics – the spread between fingers is reduced by 65%

PERFEKTE ERGONOMIE

Comfortable handling

Competitors

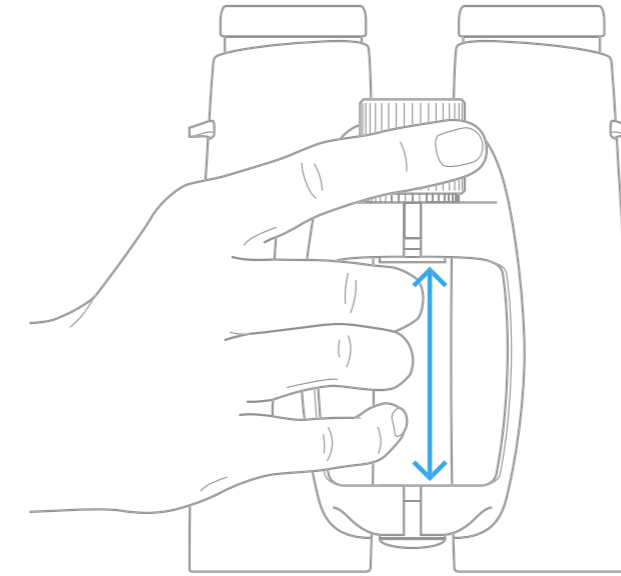

ZEISS VICTORY SF

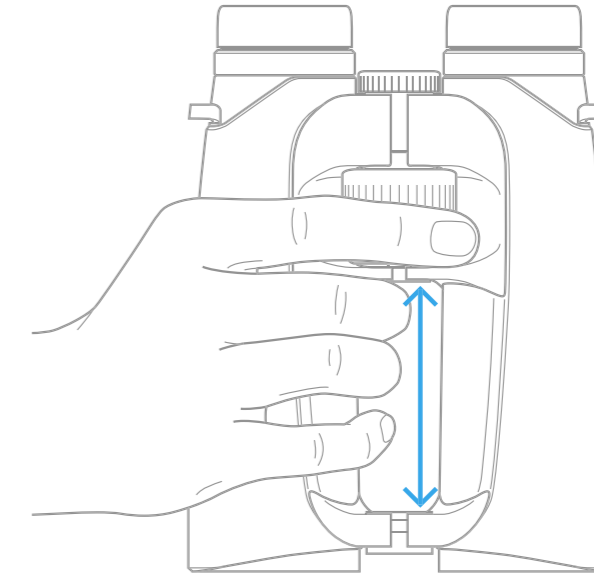

15% more space for the hand

ZEISS VICTORY HT

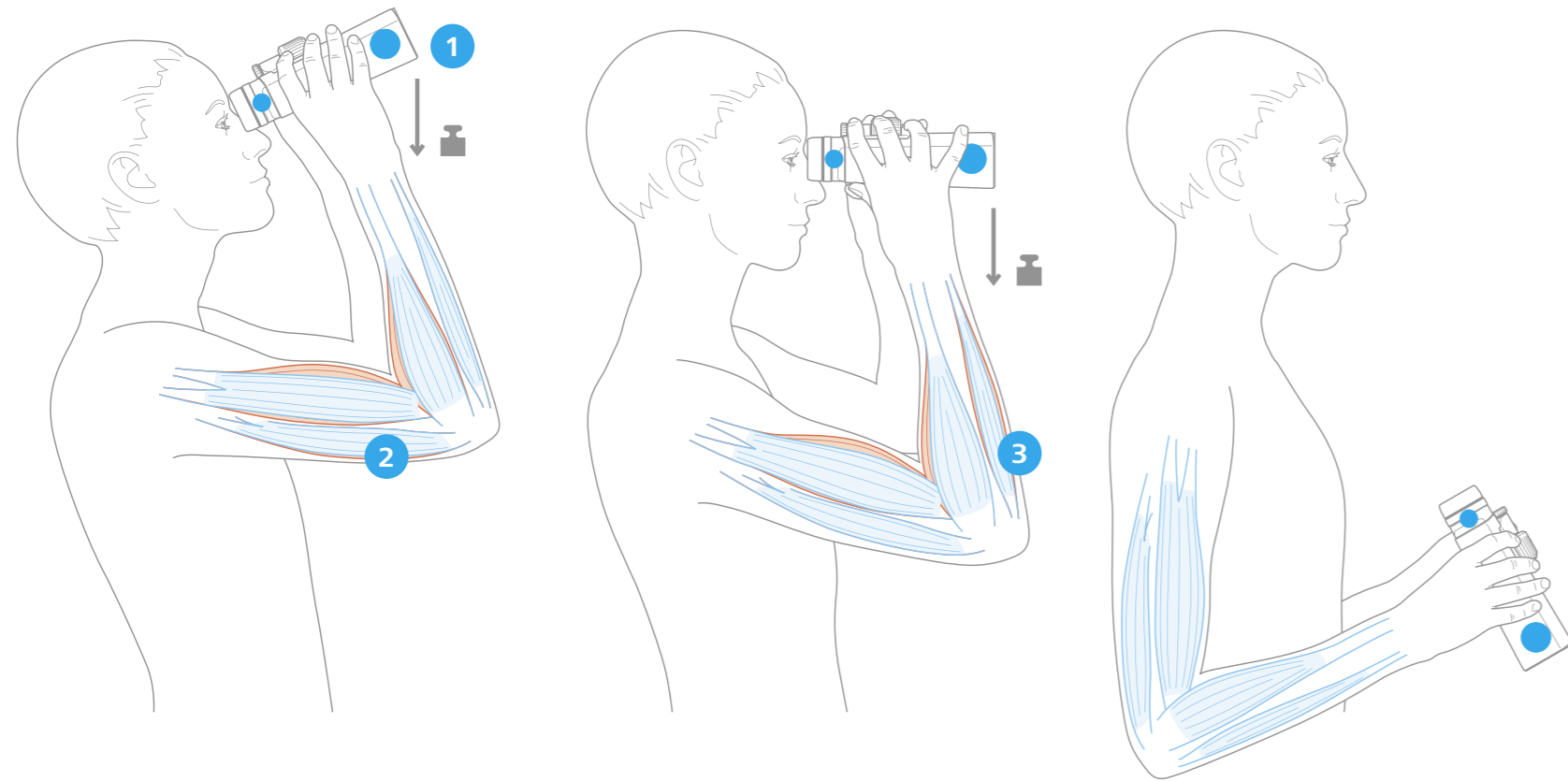

The center of gravity of the glass on the ZEISS VICTORY HT is shifted forwards to improve transmission. ① Using ideal optical components that ensure clearer, crisper images, even at dusk

(higher transmission), requires a compromise in terms of weight and ergonomics. The upper ② and lower arm ③ muscles need to work harder when viewing over long periods of time.

ERGOBALANCE CONCEPT ZEISS VICTORY SF

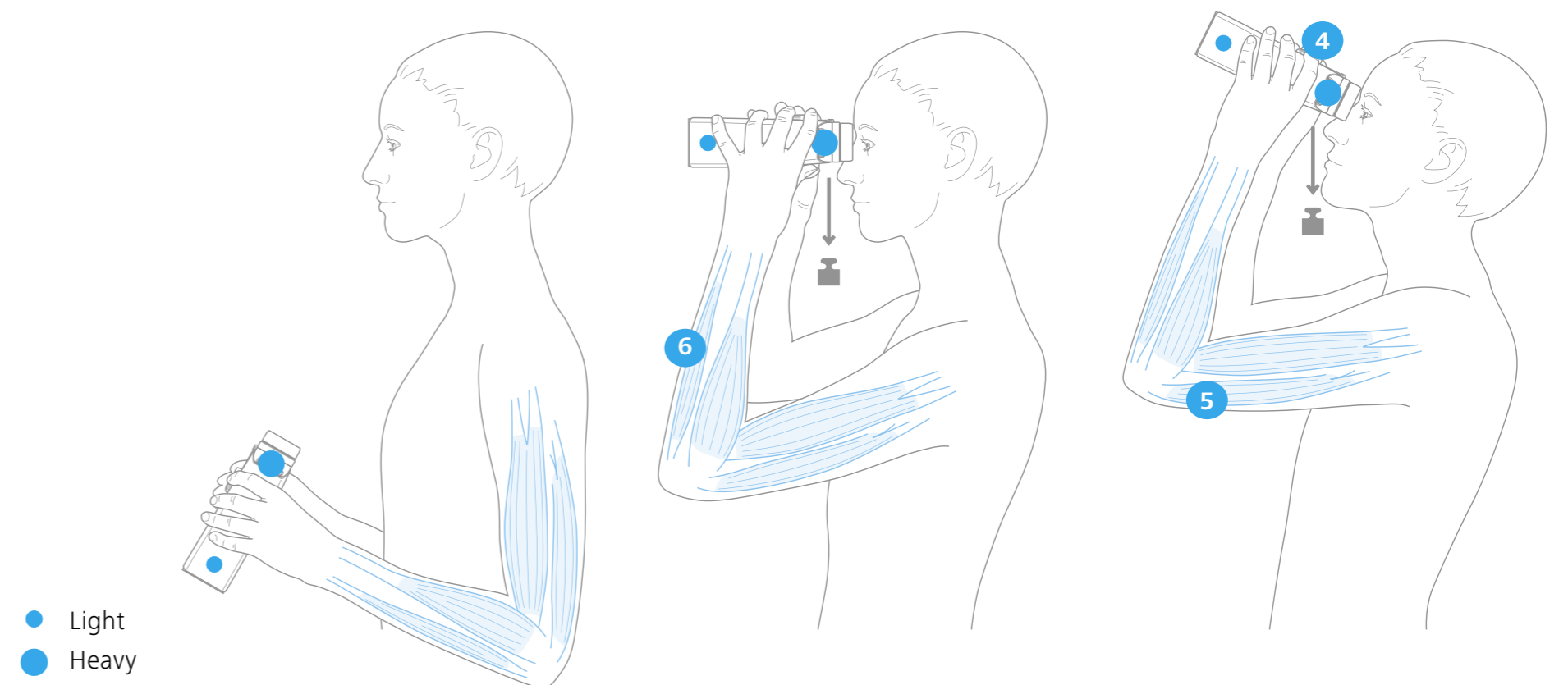

- Light
- Heavy

The center of gravity of the glass on the ZEISS VICTORY SF was consciously moved towards the eyepiece for improved ergonomics and user comfort. ④ Thanks to the ErgoBalance concept, the

binoculars have the ideal weight distribution for a perfect grip, allowing for hours of steady observation. The upper ⑤ and lower arm muscles ⑥ do not need to work as hard.

ZEISS VICTORY HT

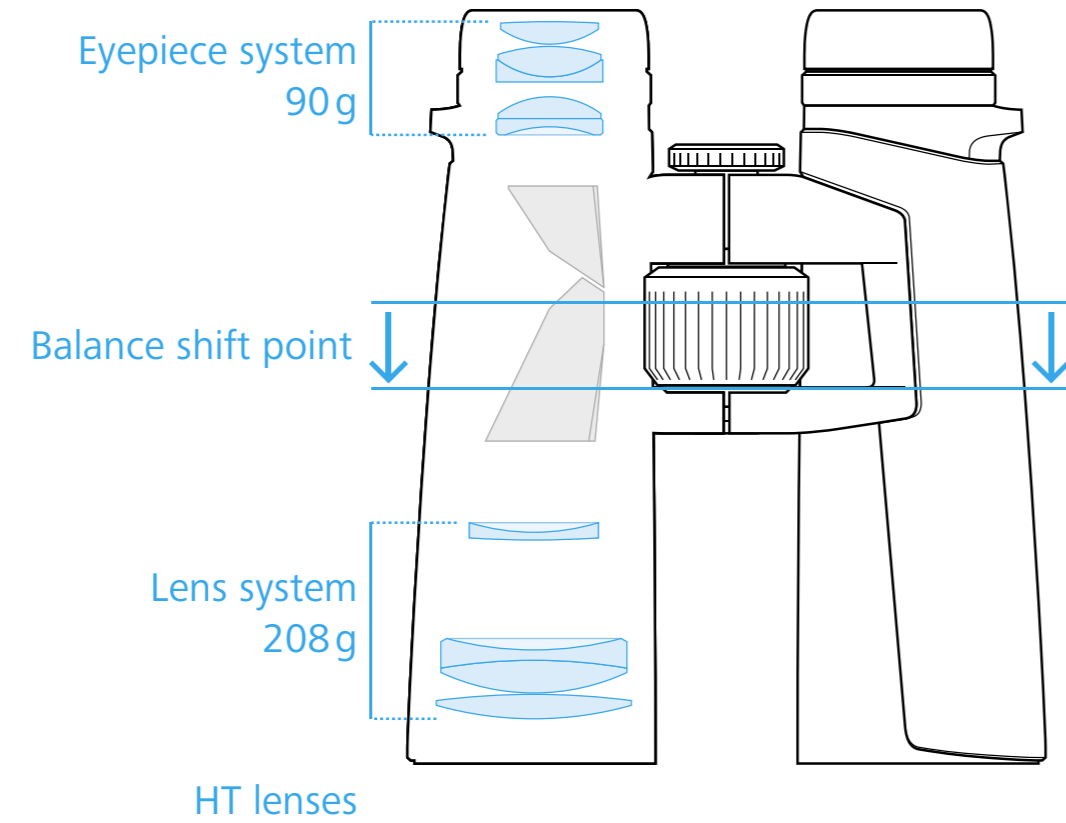

ERGOBALANCE CONCEPT ZEISS VICTORY SF

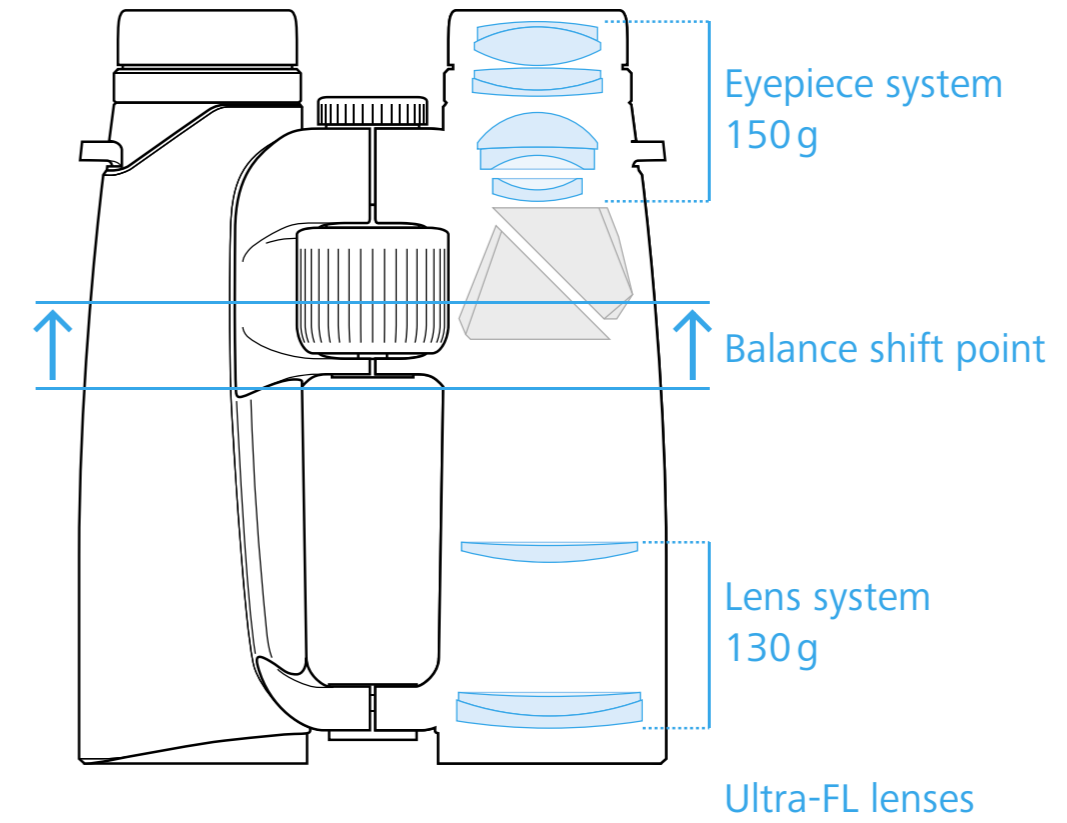



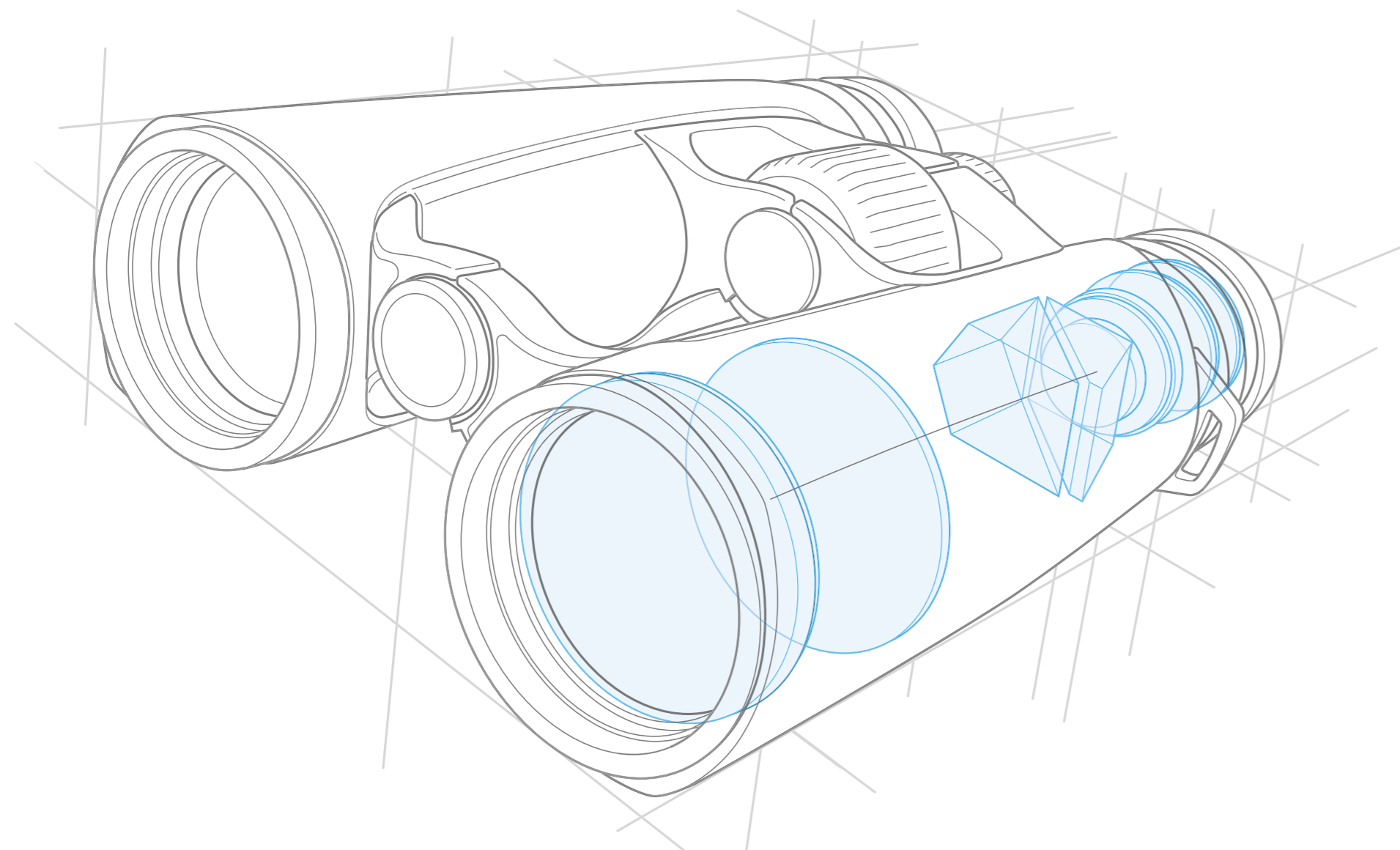

ULTRA-FL LENS SYSTEM **Integrated FL lenses**

Fluoride (FL) glasses were featured for the first time in the ZEISS Victory FL models. This particular type of glass has the special characteristic of minimizing dispersion, eliminating annoying chromatic aberrations that look blurred. The image is in sharp focus and full of rich contrast. The new VICTORY SF features the new Ultra-FL concept. An entirely new objective was developed

consisting of two lenses. This design is so special because the focusing lens is an integral part of the lens system, and also made of FL glass. The VICTORY SF offers the highest resolution, combined with extremely fine details – to enjoy stunning views like never before.



T* COATING

The details hidden in the shadows

The new VICTORY SF reveals brilliant, bright images with more details. This is especially apparent in poor lighting conditions, such as dawn, dusk or even the shadows of the rainforest.

First and foremost, the optimized T* multi-layer coating ensures that all air-to-glass surfaces of the lenses and prisms are coated in an elaborate high-vacuum process. This reduces reflections on the surfaces and ensures the greatest possible light transmission. The ZEISS LotuTec coating on the outer eyepiece and objective lenses guarantees a clean optical surface for consistent clarity – another

essential factor for high focus and contrast. Another advantage: These exclusive binoculars are quick and easy to clean as a result.

The modern high-transmission (HT) glasses from SCHOTT minimize the otherwise unavoidable loss that occurs when light passes through the glass material (inherent absorption) – allowing more light to reach the eye.

PRISM SYSTEM
High transmission

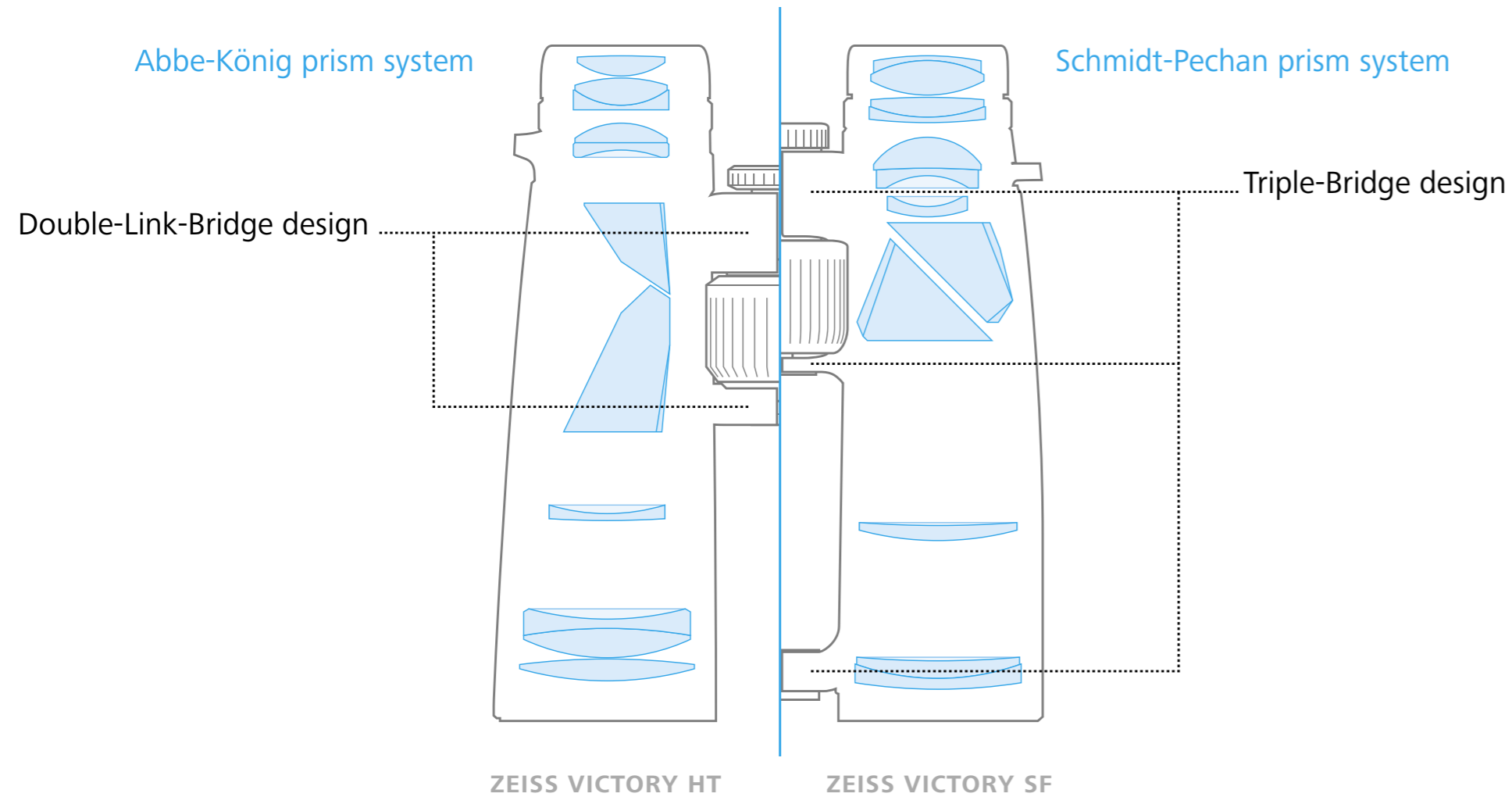

Modern binoculars are both compact and lightweight. The prism plays a decisive role here. The Schmidt-Pechan prism system offers both of these benefits simultaneously. The prism mirror is vapor deposited in a highly complex process. The dielectric mirror, which consists of over 70 layers, ensures a very high light transmission.

When combined, these technologies create detailed, brilliant images as well as a light transmission rate of at least 92%. Only the ZEISS VICTORY HT models, which are specialized for use at dusk, exceed these values at 95%.

A greater overview and closeness you can touch

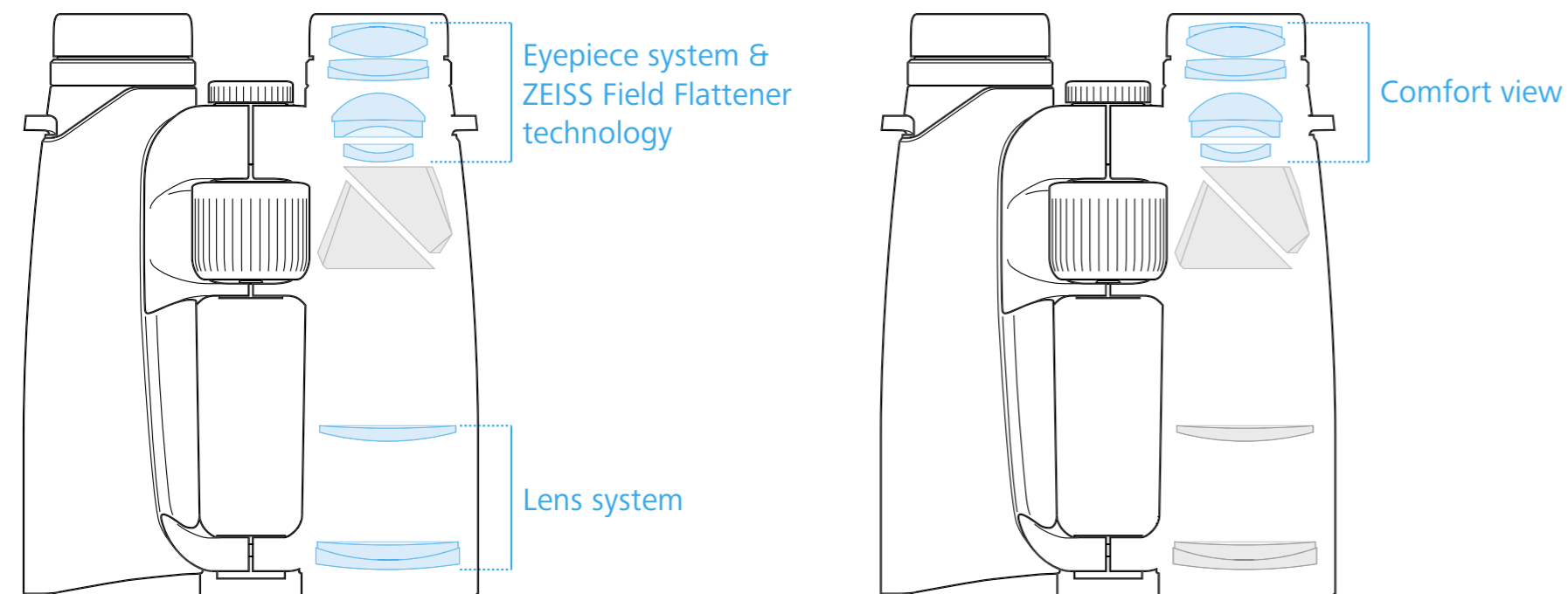

The challenge involved in developing binoculars with an extremely wide angle and large field of view is compensating for the field curvature. The VICTORY SF features a newly developed seven-lens eyepiece with “ZEISS Field Flattener technology” to deliver a level field of view and sharp focus all the way to the edges. Extremely wide fields of view provide the greatest possible overview. The 8 x 42 VICTORY SF has an unbeatable field of view of 148 m, and the 10 x 42 VICTORY SF has a maximum field of view of 120 m over 1,000 m. The absolute peak values are also reflected in the subjective viewing angle of 64° – a sign of the outstanding wide angle characteristic of the eyepiece.

Both models offer a close focusing distance of 1.5 m. This allows you to experience every detail at any distance. For the user, this means: Looking at an object with the 10 x 42 VICTORY SF from a distance of 1.5 m makes it appear as if the object is 15 cm away.



QUALITY – MADE IN GERMANY
Sturdy, long-lasting mechanics



A magnesium housing encircles the complex and surprising high-tech optics hidden inside. The new rubber armour provides additional protection, absorbs impacts and is easy to hold – in all weather conditions and temperatures.

The binoculars are resistant up to 4 m of water pressure, making it a very reliable companion – nothing gets inside, not high humidity or dust. The nitrogen filling makes it impossible for the inner

optics to fog up. The Triple-Link-Bridge stabilizes and protects the axle of the focusing wheel from external impacts as well as guaranteeing the settings for both sides of the binoculars. Even after years of intensive use and extreme situations, the VICTORY SF and its high-performance optics and mechanics are a lasting, reliable partner with a weight of 780 g.





THE WORLD'S BEST BIRDING AND WILDLIFE OBSERVATION BINOCULARS.

EXPERIENCE THE FINEST DETAILS WITH THE **BRILLIANT ULTRA-FL LENS**
OBSERVE WITH EASE THANKS TO THE **FEATHERWEIGHT CONSTRUCTION**
GREATER OVERVIEW FOR MORE SUCCESS THANKS TO WIDEST POSSIBLE FIELDS OF VIEW
REVOLUTIONARY HANDLING THANKS TO THE **ERGOBALANCE CONCEPT**
OBSERVE UNTIL THE LAST LIGHT THANKS TO BRIGHT, **HIGH-CONTRAST IMAGES**
SHARP FOCUS ALL THE WAY TO THE EDGES WITH **ZEISS FIELD FLATTENER TECHNOLOGY**
FOCUS FASTER WITH THE **SMART FOCUS CONCEPT**

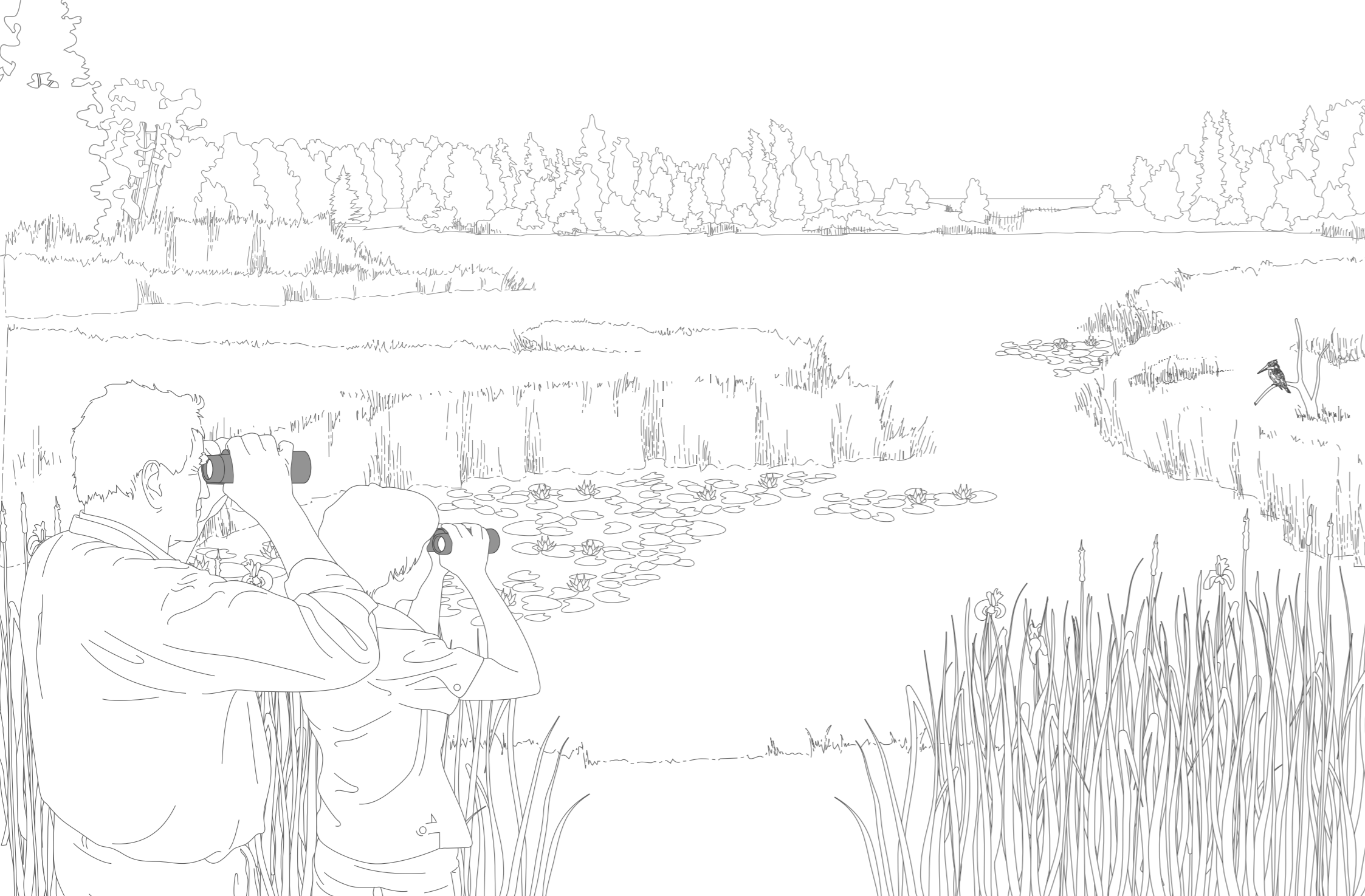

VICTORY SF – The world’s best birding and wildlife observation binoculars.

The ZEISS VICTORY SF has achieved a new level of optical performance thanks to its sharp focus, field of view, transmission and extremely light weight. The innovative ergonomics and unique weight distribution allow for professional use without fatigue. The new Triple-Link-Bridge design with the integrated SMART FOCUS concept allows for quick and dynamic focusing. It is also no longer necessary to overextend the index finger while focusing, which makes viewing more relaxing. The newly developed Ultra-FL lens system delivers crisp, sharp images and extraordinary optical performance. The ZEISS Field Flattener technology ensures a perfect

visual experience all the way to the edges. The brightness, colour purity, extreme fields of view and minimal close focus (1.5 m) are unmatched – making the VICTORY SF the ultimate binoculars for birders, entomologists and botanists.

Customer benefits

- The world’s best birding and wildlife observation binoculars
- **Experience the finest details** thanks to the brilliant Ultra-FL lens system
- **Observe with ease** thanks to the very balanced weight
- Revolutionary handling **without fatigue** for hours of observation



THE MOST VERSATILE PREMIUM BINOCULARS FOR HUNTING

EXPERIENCE THE FINEST DETAILS WITH THE BRILLIANT ULTRA-FL LENS
OBSERVE WITH EASE THANKS TO THE FEATHERWEIGHT CONSTRUCTION
GREATER OVERVIEW FOR MORE SUCCESS THANKS TO WIDEST POSSIBLE FIELDS OF VIEW
REVOLUTIONARY HANDLING THANKS TO THE ERGOBALANCE CONCEPT
HUNT UNTIL THE LAST LIGHT THANKS TO BRIGHT, HIGH-CONTRAST IMAGES
SHARP FOCUS ALL THE WAY TO THE EDGES WITH ZEISS FIELD FLATTENER TECHNOLOGY
FOCUS FASTER WITH THE SMART FOCUS CONCEPT

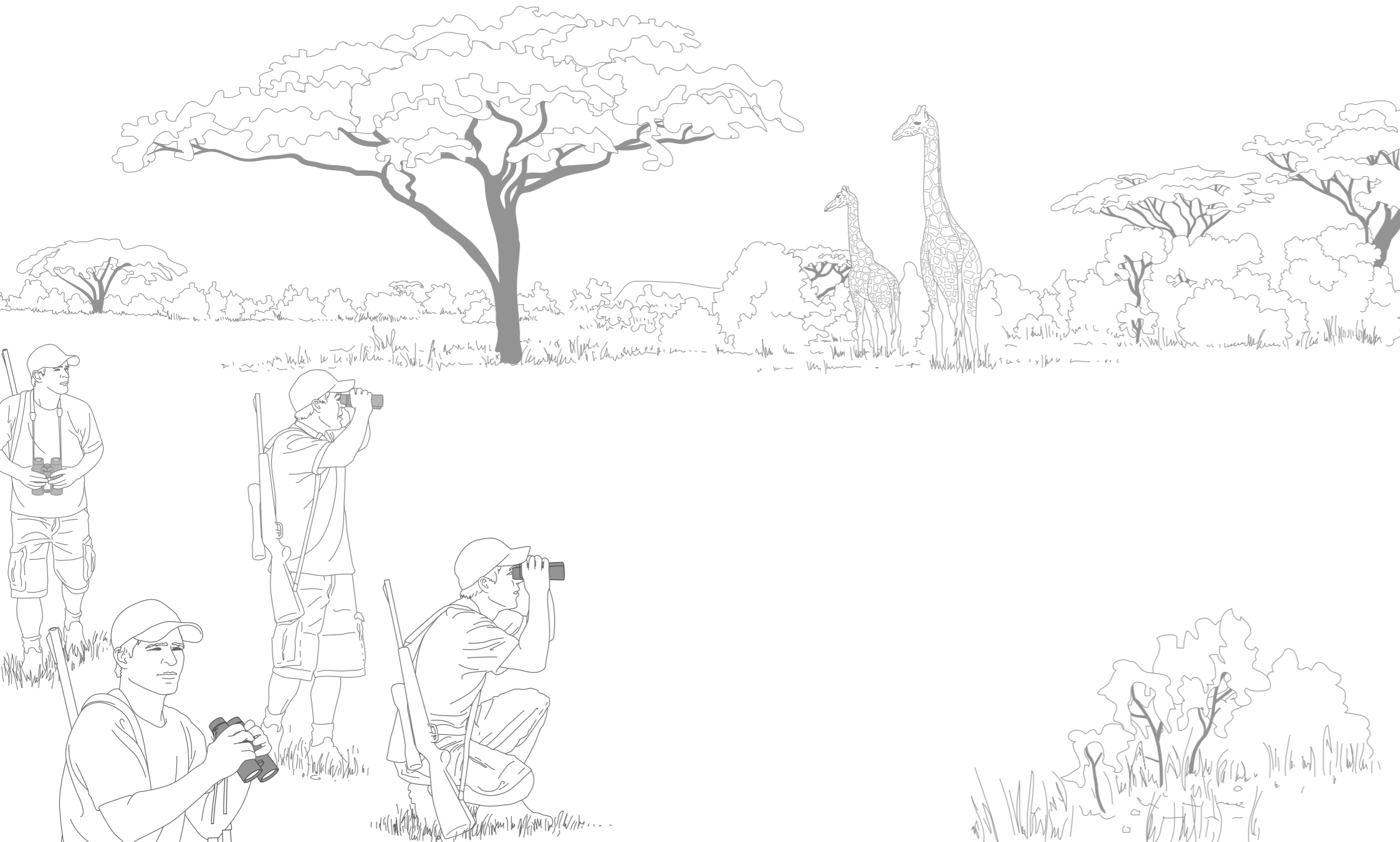

VICTORY SF – The most versatile premium binoculars for hunting

ZEISS introduces the new VICTORY SF binoculars as the perfect complement to the VICTORY line of products. Next to the VICTORY HT, specialized for dusk viewing and night hunting, the VICTORY SF is the ultimate all-round binocular. Offering the most brilliant images, a light weight construction, the widest fields of view available and perfect ergonomics, it is ideal for all types of hunting – from lengthy game stalking and stand hunting until dusk to challenging hunts abroad. Introducing an entirely new product design with a Triple-Link-Bridge and an unbeatable range of features, the ZEISS VICTORY SF is setting new standards in optical performance

and ergonomics. ZEISS and trailblazing innovations go hand and hand – just like the VICTORY SF and technologies like the Ultra-FL concept, ErgoBalance concept, SMART FOCUS concept and ZEISS Field Flattener technology.

Customer benefits

- Extremely wide fields of view **for the greatest possible overview**
- **Observe with ease** thanks to the very light weight
- **Experience the finest details** thanks to the brilliant Ultra-FL lens system
- Revolutionary handling **without fatigue** for hours of observation

VICTORY HT HUNTING

VICTORY HT – The world's brightest premium binoculars.

The ZEISSVICTORY HT is designed for reliable response and successful hunting in poor lighting conditions. The SCHOTT high-transmission (HT) lenses provide 95% light transmission – providing maximum brightness and the sharpest possible contrasts. The Comfort-Focus concept provides steady images and precise focusing – even when wearing gloves. The revolutionary 54 mm lens diameter makes them truly innovative and unique – the lightest and most compact night hunting binoculars ever. With the ultra-bright HT concept and weighing in at just 1,000 g, it is brighter than any conventional 56 mm binoculars and as light as a 50 mm

model. The VICTORY HT and VICTORY SF binoculars complement each other perfectly: VICTORY SF is ideal for game stalking, stand hunting until dusk, and while traveling. VICTORY HT is an excellent choice when hunting in the most difficult light conditions, i.e. when hunting wild boars or stand hunting in the winter.

Customer benefits

- The world's brightest premium binoculars
- **Precise focusing**, even when **wearing gloves**
- **For longer viewing** and more successful hunting at night

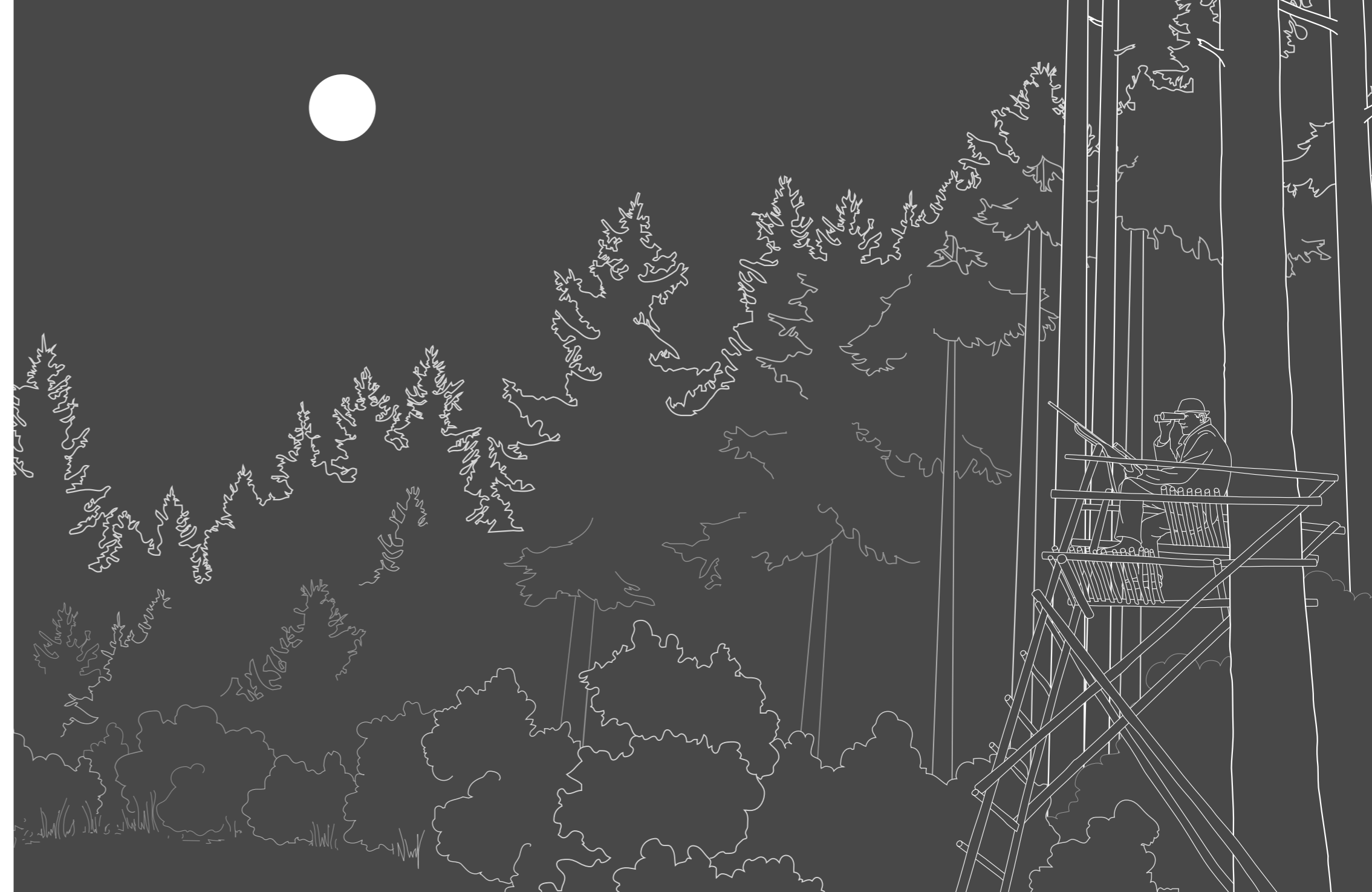



GAME STALKING. ADVANTAGES.

- **Revolutionary handling** thanks to the ErgoBalance concept
- **Extremely wide fields of view** for the greatest possible overview
- **Observe with ease** thanks to the very light weight
- **Sharp focus faster** with the SMART FOCUS concept



STAND HUNTING. ADVANTAGES.

- **Experience the finest details** with the brilliant Ultra-FL lens
- **Focus all the way to the edges** thanks to ZEISS Field Flattener technology
- **Hunt until the last light** thanks to bright, high-contrast images
- **Sharp focus faster** through the SMART FOCUS concept



MOUNTAINS. ADVANTAGES.

- **Observe with ease** thanks to the featherweight construction
- **Revolutionary handling** thanks to the ErgoBalance concept
- **Sharp focus faster** with the SMART FOCUS concept
- **Greater overview for more success** thanks to the widest possible fields of view



TRAVEL. ADVANTAGES.

- **Experience the finest details** with the brilliant Ultra-FL lens
- **Revolutionary handling** thanks to the ErgoBalance concept
- **Sharp focus faster** with the SMART FOCUS concept
- **Greater overview for more success** thanks to the widest possible fields of view

TECHNICAL DATA

Comparison table

Modell	8 x 42	10 x 42
Magnification	8 x	10 x
Lens diameter	42 mm	42 mm
Exit pupil diameter	5.3 mm	4.2 mm
Twilight factor	18.3	20.5
Field of view at 1,000m 1,000 yds	148 m 444 ft	120 m 360 ft
Subjective viewing angle	64° Ww	65° Ww
Close focus	1.5 m 5.0 ft	1.5 m 5.0 ft
Diopter adjustment range	+/- 4 dpt	+/- 4 dpt
Eye relief	18 mm	18 mm
Lens type	Ultra-FL	Ultra-FL
Prism system	Schmidt-Pechan	Schmidt-Pechan
Coating	LotuTec® / T*	LotuTec® / T*
Nitrogen filling	yes	yes
Water resistance	400 mbar	400 mbar
Functional temperature	-30 / +63°C -22 / +140°F	-30 / +63°C -22 / +140°F
Height	173 mm 6.8 in	173 mm 6.8 in
Width at an eye width of 65mm	125 mm 5.0 in	125 mm 5.0 in
Weight	780 g 27.5 oz	780 g 27.5 oz
Order number	52 42 21	52 42 22

T* = ZEISS T* multi-layer coating

Ultra-FL = newly developed lens system
(details on p. 27)

Ww = binoculars with wide-angle eyepieces

Rights to change the design and scope of delivery due to technical advancements reserved. ZEISS is not liable for any omissions or mistakes in this document.

ZEISS VICTORY SF 8x42

	ZEISS VICTORY SF	Competitor 1	Competitor 2	Competitor 3	Competitor 4
Field of view	148 m	132 m +12 %	136 m +9 %	128 m +16 %	133 m +11 %
Transmission	92 %	89 % +3 %	90 % +2 %	86 % +7 %	90 % +2 %
Close focus	1.5 m	1.5 m 0 %	1.9 m -21 %	3.1 m -52 %	2.5 m -40 %
Weight	780 g	835 g -7 %	810 g -4 %	764 g +2 %	790 g -1 %

ZEISS VICTORY SF 10x42

	ZEISS VICTORY SF	Competitor 1	Competitor 2	Competitor 3	Competitor 4
Field of view	120 m	112 m +7 %	110 m +9 %	110 m +9 %	111 m +8 %
Transmission	92 %	89 % +3 %	91 % +1 %	86 % +7 %	89 % +3 %
Close focus	1.5 m	1.5 m 0 %	1.9 m -21 %	2.9 m -48 %	2.2 m -32 %
Weight	780 g	835 g -7 %	795 g -2 %	752 g +4 %	800 g -3 %

SF compared to the competition Better Equal Poorer

Sophisticated design – down to the finest detail



1



2



3

4



5

- 1 Binoculars
- 2 Eyepiece cover
- 3 Lens cover

- 4 Strap to attach lens cover
- 5 Carrying strap

Sophisticated design – down to the finest detail



The supplied case allows quick and easy access to your binoculars. Featuring magnetic and zipper closures for twice the protection, the VICTORY SF is always securely stored and can be worn with a carrying strap or on the belt.



- 6 Carrying pouch including strap
- 7 Lens cleaning cloth
- 8 Instruction manual

- 9 Warranty card
- 10 Quality certificate

Do you have any questions
or suggestions?

Contact us – or visit us online
and become part of
the ZEISS Community

Contact

ZEISS ACADEMY Sports Optics
Maruan Al-Hammoud

Phone:
+49-6441-404-341
Fax:
+49-6441-404-162

maruan.al-hammoud@zeiss.com



BIRDING



HUNTING

CONTACT

Publisher

ZEISS ACADEMY Sports Optics

Carl Zeiss Sports Optics GmbH
Gloelstraße 3-5
35576 Wetzlar
Germany

www.zeiss.de/sports-optics

Editor

ZEISS ACADEMY Sports Optics
Marketing Manager
Related Products & Training
Maruan Al-Hammoud

Phone:
+49-6441-404-341
maruan.al-hammoud@zeiss.com

Design & concept

solldesign
Schwäbisch Gmünd
Germany

www.solldesign.de

Print

raff media group, Riederich



Printed on FSC® certified paper
from responsible forestry



www.zeiss.de/sports-optics

Schutzgebühr: 34,90 €