

EMPERVIOUS™

RIGID WATERPROOF SHOWER SYSTEM

SHOWER RAMP INSTALLATION GUIDE

Installation Tools and Materials Required

- Empervious Shower System joint sealant*
- Empervious Sausage Gun or Caulk gun for joint sealant
- Corner putty knives and standard putty knives
- Cleaning Wipes
- Utility Knife, Tape Measure, and V-notch Trowel

Step 1

Measure the length of the area where you are going to install the shower ramp.

[fig. 1]



Step 2

Dry fit the ramp and mark it where it needs to be cut to fit the width of the shower pan. Using a straight edge and utility knife, cut the shower ramp to the proper size. [fig. 2]

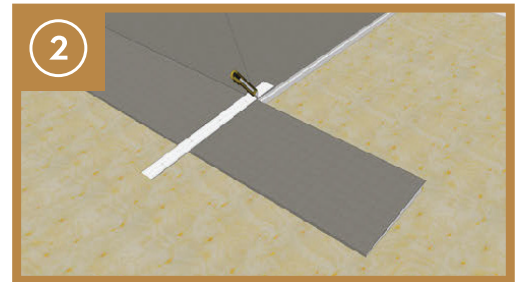

Step 3

Apply a 1/2" solid bead of joint sealant to the notch of the shower pan. [fig. 3]

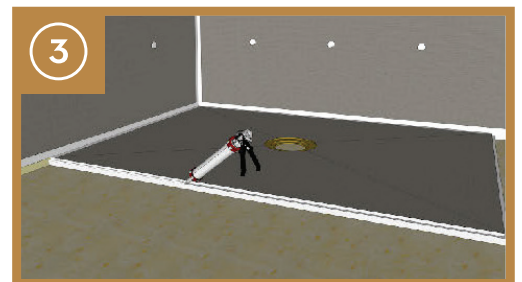

*Recommended sealant is SikaFlex 11FC.
Failure to use recommended sealant will negate warranty

Step 4

Apply modified thinset to the subfloor using a v-notch trowel.
[fig. 4a] [fig. 4b]

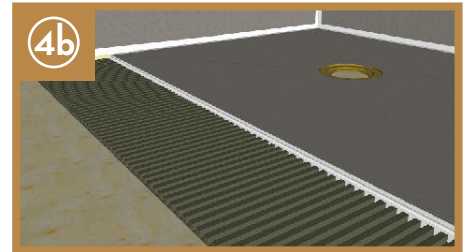
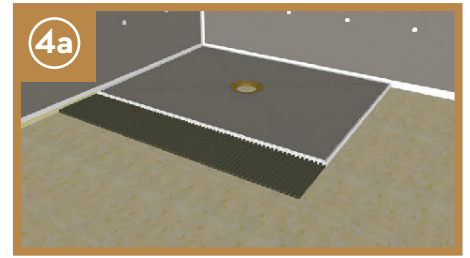

Step 5

Install the shower ramp to the floor, firmly pressing the ramp into the thinset. Apply a 1/2" solid bead of joint sealant [fig. 5a] to seal the gap between the top of the ramp and the shower pan and smooth using the putty knife. [fig. 5b] [fig. 5c]

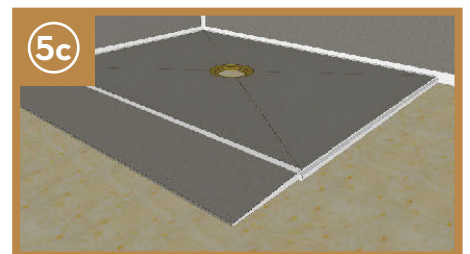
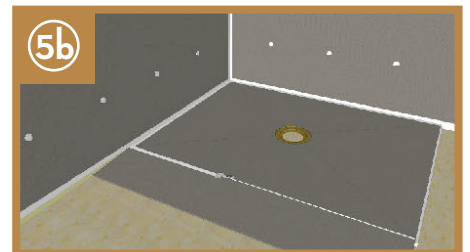
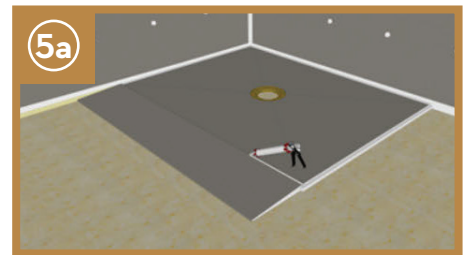

*Recommended sealant is SikaFlex 11FC.
Failure to use recommended sealant will negate warranty