

Xiamen Came Technology Co.,Ltd

For wholesale inquiries: [sale@came-tv.com](mailto:sale@came-tv.com)

Address: B03 Building, Software Park Phase III, Jimei, 361021, Xiamen, Fujian, China  
Tel:+86-592-6283638 ext 601(from outside Americas areas) / ext 602(from Americas areas)  
Hours:Monday to Friday 09:00 - 18:00 (GMT+8)

CAME-TV  
[www.came-tv.com](http://www.came-tv.com)

2021  
PRODUCT  
CATALOG

# CAME-TV INTRODUCTION

Xiamen Came Technology Co. ,Ltd. started business in 2012 and is located in Xiamen, a beautiful international city in the south of China. We are a designer and manufacturer of photography / filmmaking products. Our brand CAME-TV is well-known and trusted both at home and abroad.

We have a professional research and development team who are all well experienced in the photography and filmmaking field.

CAME-TV supplies quality products including LED Video Lights, Wireless Headsets / Communication Devices. In order to facilitate one-stop customer shopping, we also can supply other popular products for purchase.

Our products are both reputable and well received in Europe, America, Australia, Japan along with other countries and regions were our products are widely used in various photography and filmmaking fields, enjoying a good reputation.

CAME-TV is always ready to establish friendly and lasting business relations with every customer. CAME-TV commits to provide our customers with Quality Products, Competitive Price, On-time Delivery and Customer Satisfaction.

Xiamen Came Technology Co.,Ltd

For wholesale inquiries: [sale@came-tv.com](mailto:sale@came-tv.com)

Address: B03 Building, Software Park Phase III, Jimei, 361021, Xiamen, Fujian, China  
Tel:+86-592-6283638 ext 601(from outside Americas areas) / ext 602(from Americas areas)  
Hours:Monday to Friday 09:00 - 18:00 (GMT+8)

## PRODUCTS CATALOGUE

Wireless Headsets	01-06
Boltzen Series Lights	07-18
LED Panel Lights	19-20
Battery & Charger	21-22
Wireless System	23-24
Live Streaming	25-26
Tripod & Monopod	27
Video Slider	28
Video Stabilizer	29-30
Gimbal Support	31-32
Stands & Softbox	33-34
Hot Accessories	35-36

## Wireless Commucation Headset

- Wireless
- Foldable
- Portable
- Universal battery

Time Division Duplex (TDD)  
Support Group Calls Simultaneously



## CAME-WAERO



Scan & Watch Video



MUTE ON



MUTE OFF



- The hub will increase the number of headsets to 9.

### Specifications

Standard	DECT technology,GAP compatible
Range	366meters,1200ft (open space)
Talk Time	Master 10 Hours, Remote 13 Hours
Channel Bandwidth	1.728MHz
Modulation Type	GFSK
Transmission Speed	1.152Mbps
Duplex Operation	Time division duplex (TDD)
Speech Coding	ADPCM transcoder supports up to 8 duplex 32kbs channels, fully compliant with ITUG.726

# CAME-KUMINIK8



■ Dual Ear



■ Single Ear



■ Waterproof IP63



■ Foldable

Model	CAME -KUMINIK8
Standard	DECT technology, GAP compatible
Range	1500ft (450 Meters) open space
Talk Time	Master 10 Hours, Remote 13 Hours
Channel Bandwidth	1.728MHz
Modulation Type	GFSK
Transmission Speed	1.152 Mbps
Duplex Operation	Time Division Duplex (TDD)
Frequency Bands	1.78-1.93G
Battery Capacity	1000mA



■ The HUB will increase the number of headsets to 9



## CAME-NANO

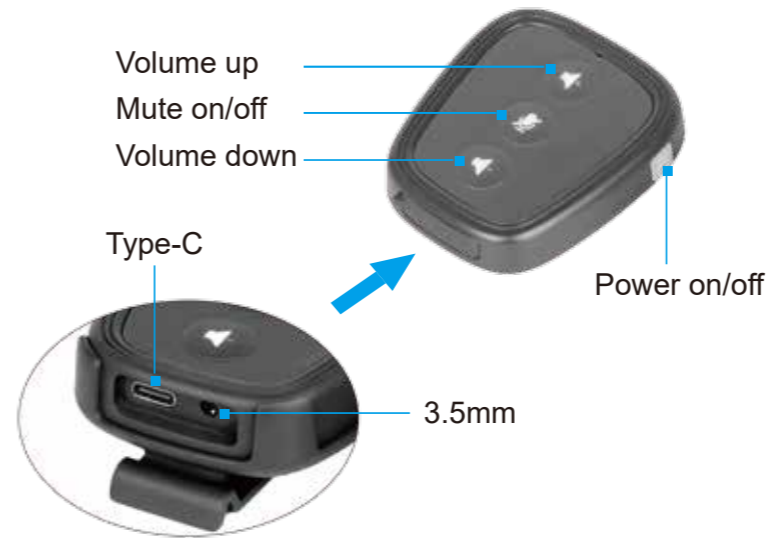

Waterproof IP65

Model	CAME-NANO
Standard	DECT technology, GAP compatible
Range	1200ft (366 Meters) open space
Talk Time	Master 11 Hours, Remote 15 Hours
Channel Bandwidth	1.728MHz
Modulation Type	GFSK
Transmission Speed	1.152 Mbps
Duplex Operation	Time Division Duplex (TDD)
Speech Coding	ADPCM transcoder supports up to 8 duplex 32kbs channels, fully compliant with ITU G.726
Frequency Bands	1.78-1.93G
Battery capacity	1500mA



Wearable with Earbud



The hub will increase the number of Nano to 9.

# Andromeda Mark II

1FT / 2FT / 3FT / 4FT

Ideal for Shape Design & Hiding Unobtrusively in Small Areas on a Set.

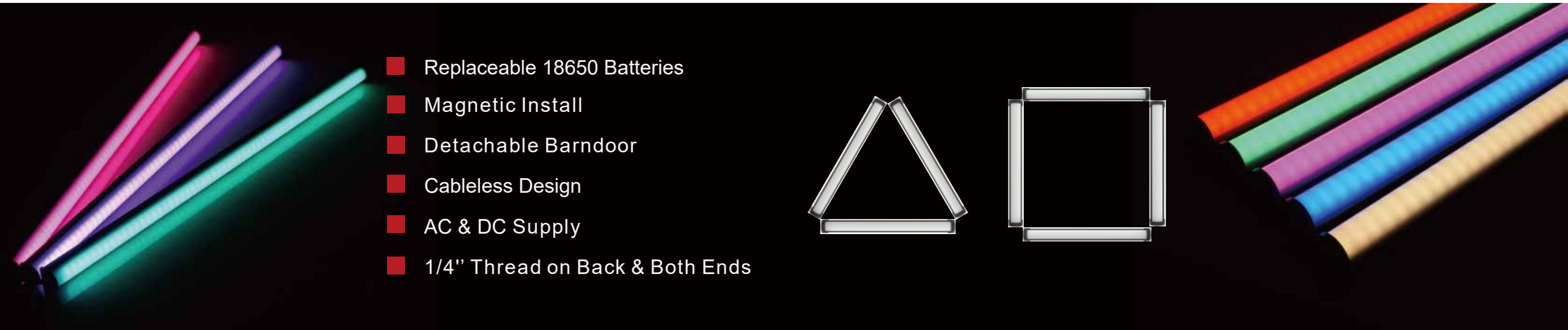

- Replaceable 18650 Batteries
- Magnetic Install
- Detachable Barndoor
- Cableless Design
- AC & DC Supply
- 1/4" Thread on Back & Both Ends



Use Like a Panel

Detachable Barndoor

Magnet

1/4" Threads on back & both ends



Commander



# Mark II

## COB 100W/150W



Scan & Watch Video

- Powerful & Portable
- Focusable
- Bowens Mount Optional
- App, Remote & DMX
- Quiet by Design
- Memory Function
- AC and DC Power Supply
- Bi-Color / Daylight
- TLCI 97+/ CRI 96+



AC and DC Power Supply



Wireless Control



DMX Control

### 2 PCS/ 3PCS Light Kits with Hardcase



■ 55W ■ 100W ■ 150W ■ Daylight & Bi-Color



AC & DC Power Supply



Battery Clamp

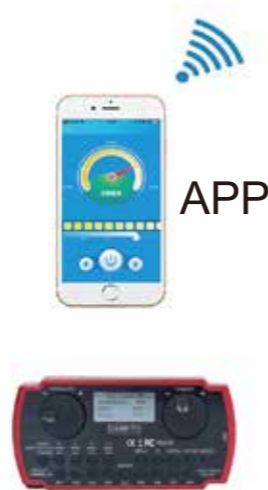

Wireless Control



Diffuser Modifier

Filter Modifier

24 Pcs Filters

Grid Modifier

Snap Kit



Support Softbox



Travel Lights Kit



# Q-Series

Q-55W

Q-55S



## What is the difference?

### Inherited features

- Portable small size
- App/Group control
- AC & DC power supply
- Memory function
- Bowen mount optional

### Add new features

- Brightness +40%
- Use 2 pcs NP battery
- Build-in Wifi
- Wireless remote controller
- Scenes mode
- Frequency setting



There are a few kits that include a foam pack that fits into the Pelican 1510 and 1535 hard cases to get you where you need to go with all of your lighting in one case.



2 Pcs COB Light Kit +  
Stands + Batteries in  
"Ready to Fly" Hard Case

Flight Ready Lighting Kit

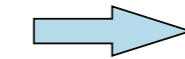
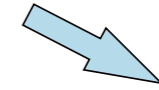

55W Lights with Batteries for Pelican Case



100W/150W Lights with Hardcase



55W Lights + Stand + Softbox + Case

- Slim, Powerful & Soft light
- Support APP & wireless remote control
- High TLCI/CRI at daylight, tungsten and RGB color
- Providing you a slim and portable carrying solution
- Group control a lot of lights



**P-20R**



**P-150R**

Model	P-20R	P-150R
Power(R/G/B/D/T)	20W+20W+20W+20W+20W	150W+150W+150W+150W+150W
Color	RGBDT	RGBDT
Scenes	36 Modes	36 Modes
Group Control	Yes	Yes
Wireless Control	Remote & APP	Remote & APP
TLCI/CRI	97+ / 96+	97+ / 96+

**P-1200R / P-1800B**  
SMD Soft Travel Light



Scan & Watch Video



**Stackable and Ready to Fly**

- Innovative folding yoke design, you can fit three of our LED panels into carry-on sized hardcases with room to spare for your compact v-mount batteries.

Model	P-1200R	P-1800B
Power(R/G/B/D/T)	55W+55W+55W+55W+55W	55W+55W
Color	RGBDT	Bi-Color
Scenes	36 Modes	6 Modes
Group Control	Yes	Yes
Wireless Control	Remote & APP	Remote & APP
TLCI/CRI	97+ / 96+	97+ / 96+



### P-20R Kit

3 Pcs Travel Light Kit + Stands  
+ Batteries in "Ready to Fly"  
Hard Case



#### FEATURES:

- RGB Light with 36 Scenes
- Compact & Powerful
- Support Remote & APP
- Support AC & DC

**Stackable & Compact Design**

### P-1200R / P-1800B Kit

READY TO FLY?

Thanks to our innovative folding Yoke design, you can fit three of our LED panels into carry-on sized hardcases with room to spare for your compact v-mount batteries.



Put In



# LED PANEL LIGHTS

## Slim DIP LED Light



576 LED Light



1092 LED Light



1806 LED Light



Softbox for 576 Light



Softbox for 1092 Light



Softbox for 1806 Light

## DIP LED Panel Light



1024 LED Light Kit



1024 LED Light

## SMD Panel Light



Model	1380D (Daylight)	1380S (Bi-Color)	
Color Temperature	5600K (±300K)	3200K - 5600K (±300K)	
LED	600 Pcs	1200 Pcs	
2 Meters Brightness	5600K	3200K	5600K
	>750 Lux	>680 Lux	>750 Lux
Power	100 Watts		
Voltage	AC 110V - AC 240V		
Net Weight	5.6 Kg (12.3 lbs)		
Angle	120 Degrees		
Size (L x H x D)	22.25 x 13.39 x 2.36 in (56.5 x 34 x 6 cm)		

## SMD LED Edge Light



MODEL: L2500S

- High CRI 96
- SMD Soft light
- DMX function
- V-mount plate



### Mini V-mount battery



Model		MINI-99
Voltage		14.4V
Capacity		99Wh, 6875mAh
Output	D-Tap 1	14.4V 15A(Max)
	D-Tap 2	14.4V 15A(Max)
	USB	5V 2.1A
Approx. Measurements		2.84"x1.89"x 3.94" (72x48x100mm)
Weight		1.21lbs (550g)

### Power Station

#### DC Invert AC & V-mount Charger

#### Output Interface:

- 2 X AC Socket 110V/220V
- 1 X Type-C 5V,2A
- 4 X USB-A
- 2 X DC 12V,3A
- 2 X D-Tap 14.4V,10A
- 1 X LED Light



### Dual charger & DC output

Model: BZ-2C

- Can charge two V Mount Li-ion batteries simultaneously.
- Convert DC output to 24-33.6V

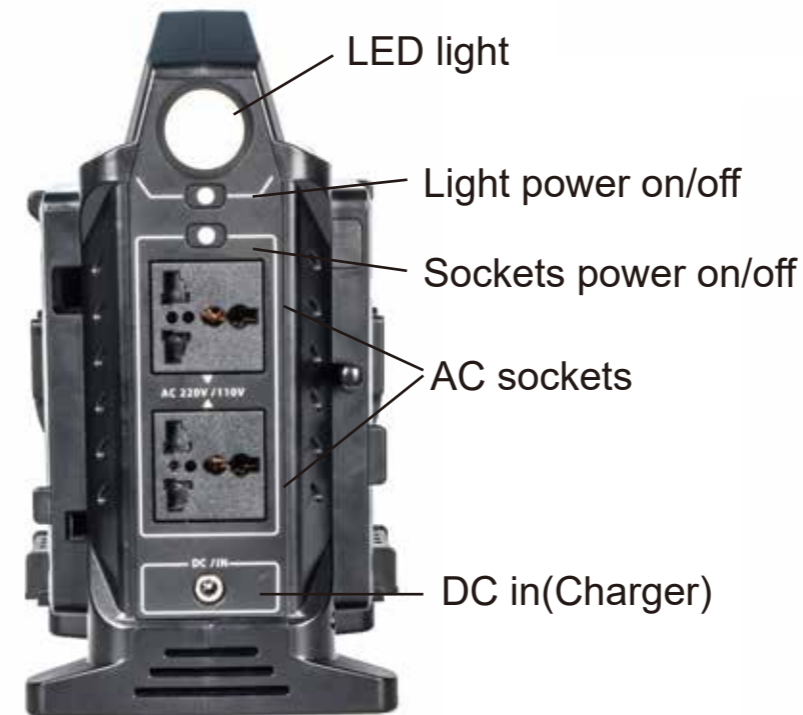

## CAME-Astral

Wireless follow focus

- High torque for cine-style lenses
- 500 meters distance in open space
- Wireless shutter and record video



## Power Track Dolly



### Key Features

- Payload 30kg (66 lbs)
- Powered by 14.4V battery
- A-B Point Loop
- Stepless speed change



### Specifications

Channel bandwidth	2.415 -2.473GHz
Transmit power	0 dBm
Working temperature	-20~55°C
<b>Motor</b>	
Max torque	0.50 Nm
Max run speed	250 rpm
Working quiescent current	70 mA (@12 V)
Locked rotor current	1.5A (@12 V)
Receiver working voltage	12-18 V
Noise	<25 dB (@100 rpm)
Number of teeth	40
<b>Controller</b>	
Battery type	LIPO
Battery voltage	3.7 V
Battery capacity	1000 mA h
Battery power	4.44 W h



Scan & Watch Video



## 4K Input & Output Video Capture

■ Model: PRIZM-4K

Model	PRIZM-4K	CAME-USB-2.0
Max Input resolution	4K (3840x2160)	4K (3840x2160)
Max Output resolution	4K (3840x2160)	1080P (1920x1080)
USB Port	USB 3.x	USB 2.0

### Features

- Supports input max resolution 4K
- Supports 8/10/12bit deep color
- Supports AWG26 HDMI standard cable: input up to 15 meters (1080P and below resolution)
- Supports most acquisition software, such as VLC, OBS, Amcap, etc
- Supports Windows, Android and MacOS
- Conforms to USB Video and UVC standard
- Conforms to USB Audio UAC standard
- Compact and portable
- No external power supply required



## 4K Input 1080P Output Video Capture

■ Model: CAME-USB-2.0





CAME-15T



CAME-18T



Scan & Watch Video



CAME-20T

	CAME-15T	CAME-18T	CAME-20T
Payload	2-12kg/4.4-26lb	6-20kg/13.2-44lb	10-30kg/22-66lb
Tripod Material	Carbon fiber	Carbon fiber	Carbon fiber
Dynamic Balance	8	8	8/16/24
Pitch Damping	4	6	8
Lateral Damping	4	6	8
Max Height	1760mm/ 69 in	1780mm/70 in	1910mm/75 in
Min Height	670mm/26 in	690mm/27 in	800mm/31 in
Bowl	100mm	100mm	100mm
Handle	450mm	460mm	410-620mm(2pcs)
Tilt Range	+83°/-72°	+90°/-75°	+87°/-63°
Temperature	-40°C/60°C	-40°C/60°C	-40°C/60°C

S05-80/ S05-100 / S05-120  
 Motorized Parallax Slider With APP Controller+NP Battery+Ballhead+Shutter Cable

Model	Length
S05-80	80cm - 31.5in
S05-100	100cm - 39.4in
S05-120	120cm - 47.2in



Model	SL04
Material	Aluminium alloy
Net Weight	24lbs (10.9 kg)
Payload	110lbs (50kg)
Bowl	75&100mm (Optional 150mm)
Size	6.56x1.23x.5 Feet (2000x375x140mm)
Package Size	2.9x1.28x.52 Feet (890x390x160mm)
Package Weight	34lbs (15.5 kg)



## CAME 2-12kg Load Pro Camera Video Carbon Stabilizer

- Height of the monitor bracket is adjustable and can be rotated in all directions
- Head of Baseplate with Power, AV and HDMI connector
- There are 3 carbon fiber layers in the center rod providing great strength
- Included is a low-shooting bracket



Watch Video



### Sled

Max. Length: 102cm (40in)  
 Mini Length: 70cm (28in)  
 Load Capacity: 2-12kg (4.4-26 lbs)

### Spring Arm

Stronger Arm Payload: 6-12kg (13-26 lbs)  
 Lightweight Arm Payload: 2-8kg (4.4-18.6 lbs)

## CAME 1.5-6kg Load Pro Video Stabilizer for Camera Gimbal

■ Model: GS13

### Vest

-- The vest height is adjustable, conforming to your back

### Dual Spring Arm

- Payload: 1.5-6Kg (3.31-13.23Lbs)
- Clamp included on the top of the arm, the direction is adjustable
- 16mm to 1/4" converter mount
- The spring arm can be installed on the left for a left-handed person
- The arm with a 12mm rod is for stabilizer and it can be converted to 16mm standard rod



### What's Included

- Adjustable Vest
- Dual spring arm
- Gimbal Clamp
- 16mm to 1/4" converter mount
- Handle for Ronin RS2/RSC2
- Carrying bag

### CAME-TV Pro Hydraulic Stabilizer + Suction Cup Mount

■ Model: GS11-SUCTION



Watch Video

Suitable for 2-22lbs (1-10kg) camera gimbals including accessories



With two dampeners, the CAME-TV 2-22 Lbs Load Pro Camera Video Stabilizer Rod Mount provides very smooth shots.

The stainless steel shock absorbing cradle head further reduces excessive shock. This kit includes a carbon fiber suction mounting system.



■ SK02



SK02 Video



■ SK04



■ CAME-RS2  
For Ronin S&RS2&RSC2



■ RS2-BASE  
For Ronin RS2



■ RONIN-HANDLE  
For Ronin RS2 & RSC2



■ RS1-BASE  
For Ronin S



■ SD1



■ SD12



■ SDC



■ Parabolic Softbox with Grid

Size:  
60CM, 90CM, 120CM

Features:  
Quick set-up, Bowens speedring, with grid



■ Square Foldable Softbox

Size:  
40cm x 40cm, 50cm x 50cm  
60cm x 60cm, 80cm x 80cm

Features:  
Compact and lightweight, Quick set-up



■ Collapsible Lantern Softbox

Size:  
65CM

Features:  
Quick set-up, Bowens speedring

Model	SD1	SD12	SDC
Maximum Operating Height	240cm (7.8')	190cm (7.48')	328cm (10.76')
Folded Height	73cm (2.4')	46cm (1.81')	130cm (4.26')
Net Weight	1.6kg	1kg	8.5kg
Max Load Capacity	5kg (11 lbs)	2kg (4.4 lbs)	20kg (44 lbs)
Features	1.Air-cushion design 2.With 1/4"-20 and 3/8-16" male threads.	1.Quick set up 2.Reverse folding light stand	1.Heavy duty & high stability 2.Detachable for portable carrying 3.Strong steel material and enhance surface plated



Travel Hard Case



Foam for Pelican Case



Diffuser Modifier



Filter Modifier



24 Pcs Filters



Grid Modifier

Snap Kit



Ronin RS2 Power Adapter



ADAPTER-CLAMP  
V-clamp for AC power adapter



V-CLAMP  
V-mount battery clamp



MINI-VMOUNT  
Mini V-mount battery plate



PHONE-CLAMP  
smart phone clamp with  
52mm adapter



AD-52LENS  
camera plate with  
52mm adapter



C-CLAMP-STAND  
Heavy duty C-Clamp stand



HDMI A-A Cable  
length:1ft/ 2ft/ 3ft/ 6ft



HDMI A-C Cable  
length:1ft/ 2ft/ 3ft/ 6ft



HDMI A-D Cable  
length:1ft/ 2ft/ 3ft/ 6ft