

# AB Thermal Printer

## 1. Functions

- \*Compatible with several AccuBANKER bill counters, counterfeit detector(s), and coin counter(s).
- \*High speed, low noise.
- \*Optional Communicating ports: RS485, RS232, UART(TTL), USB20.

## 2. Part List

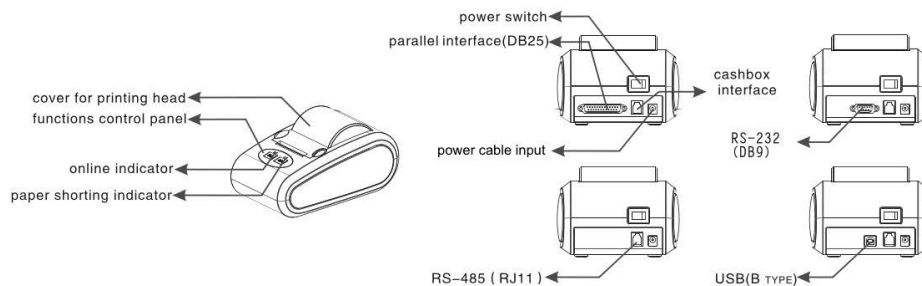

## 3. Specifications

Ambient temperature: 0°C-40°C Relative humidity: 20%-80% Noise level: 60dB(MAX)  
 Printing method: Thermal Printing Width: 58mm Printing speed: 90mm/s  
 Manual cutting paper N.W: 0.8kg (1.8 lbs) G.W: 1.4kg (3.1 lbs)  
 Power supply: DCBV 3A  
 Power Consumption: 25W

## 4. Device Connection

1. Set the printer on the desktop.
2. Insert printing paper.
3. Plug the power cord and connect it to the back of the printer.
4. Connect the printing cable with the equipment being used.
5. Turn on the power switch.

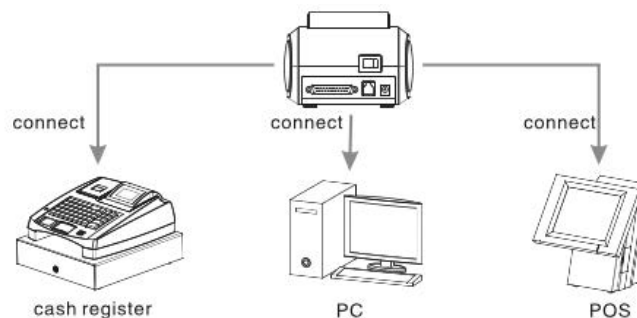

## 5. Settings

### • Testing Mode:

After inserting the paper, press and hold the "Paperfeed" key as you turn on the printer. The printer will print a test receipt.

- **Time & Date Setting:**

Press and hold the "Online" button and proceed to turn on the printer. Once the screen displays dash lines (----), release the button. Use the "Paperfeed" button to change the numbers and the "Online" button to change the field. The first set of numbers will be the year. Once the year has been set up, press the "Online" button to proceed to the month and day.

Follow the same steps to set up the time.

- **Button Functions**

"Online" key: When pressing this key, the indicator light turns on; the printer can receive and print data at this point. Press the key again to turn it off.

"Paperfeed" key: This key will release some paper through the opening on the top of the printer, making it easier to tear out a receipt.

- **Indicator light:**

The "Paperfeed" key acts as an error indicator light. When there is an issue with the printer, the light will blink; If it blinks:

2 times - The device does not recognize the printer

3 times - Printer is short on paper

5 times - The printing head is overheating

## 6. Paper Roll Installation/Replacement

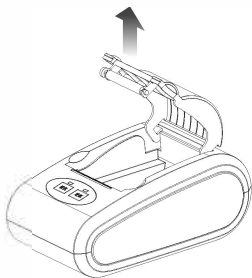

1. Lift the cover.

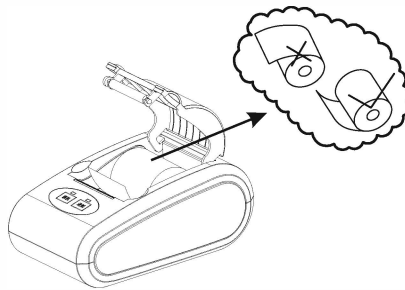

2. Insert the paper roll.

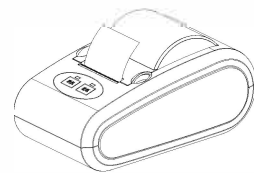

3. Leave some paper out and close the cover.

Thermal Printer Paper Dimensions:

55mm width

25mm inner core

40mm outer diameter

## 7. Troubleshooting

1. If the printer makes strange sounds or the paper feeds abnormally when printing, stop immediately and realign the paper.

2. If there is a blank space on the receipt where there should be data, the printing head may be damaged. Please replace.

3. If the receipt is blurry, the printing head is most likely dirty. Turn off the printer and clean it using some cotton with alcohol.

