

**ASSEMBLY INSTRUCTIONS**

# Uniform Panel Return Desk with Closed Hutch

Sizes (mm): 1200L/1400L/1600L x 1600D

[www.jasonl.com.au](http://www.jasonl.com.au)

**Need help!**

Call us on  
**1300 527 665**

**jason.l**  
your office furniture mate

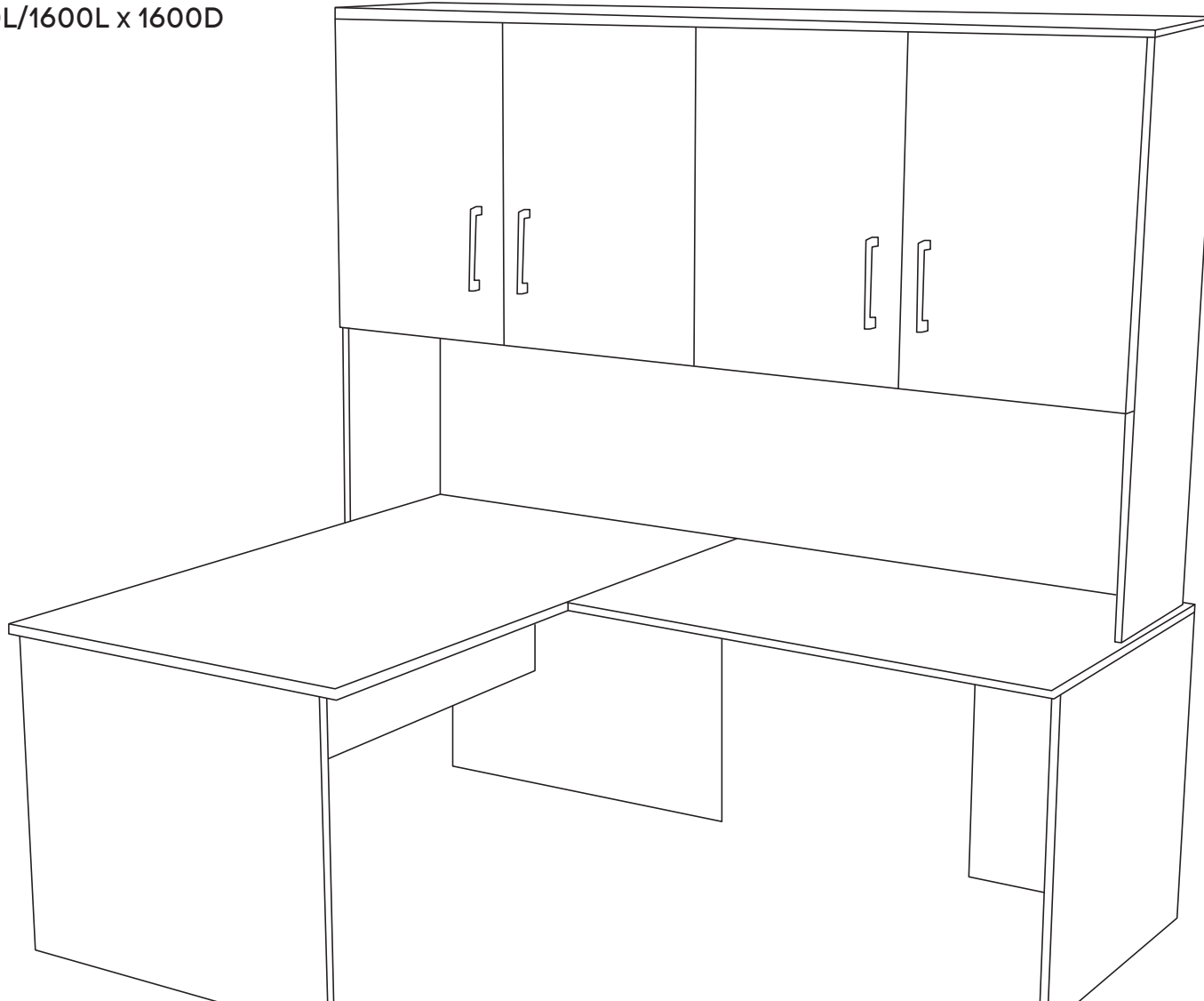

2 persons required for installation

**ASSEMBLY INSTRUCTIONS**

# Uniform Panel Return Desk with Closed Hutch

Sizes (mm): 1200L/1400L/1600L x 1600D

[www.jasonl.com.au](http://www.jasonl.com.au)

**Need help!**

Call us on  
**1300 527 665**

**jason.l**  
your office furniture mate

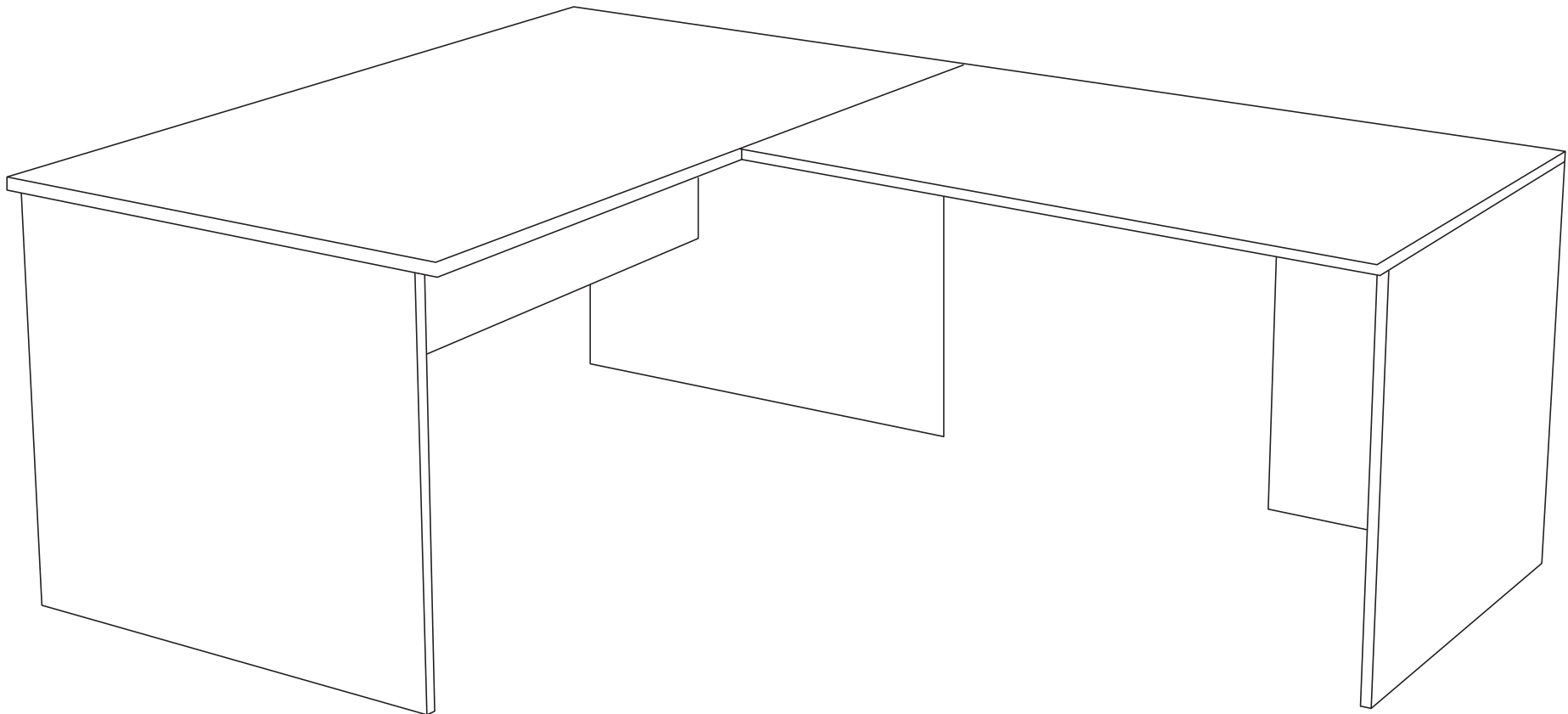

2 persons required for installation

## ASSEMBLY INSTRUCTIONS

# Uniform Panel Return Desk with Closed Hutch

Sizes (mm): 1200L/1400L/1600L x 1600D

[www.jasonl.com.au](http://www.jasonl.com.au)

**Need help!**

Call us on  
**1300 527 665**

**jason.l**  
your office furniture mate

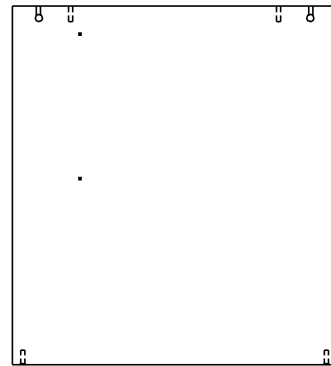
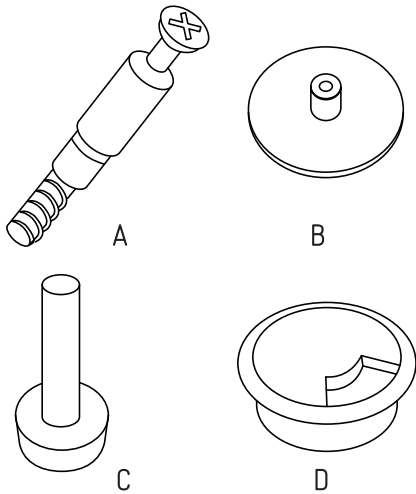

② SIDE PANEL R  
Qty: 1 pc

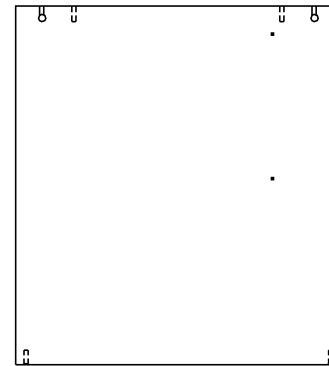

③ SIDE PANEL L  
Qty: 1 pc

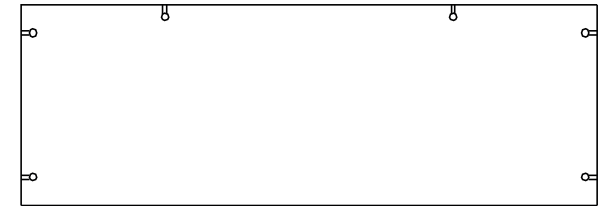

① FRONT PANEL  
Qty: 1 pc

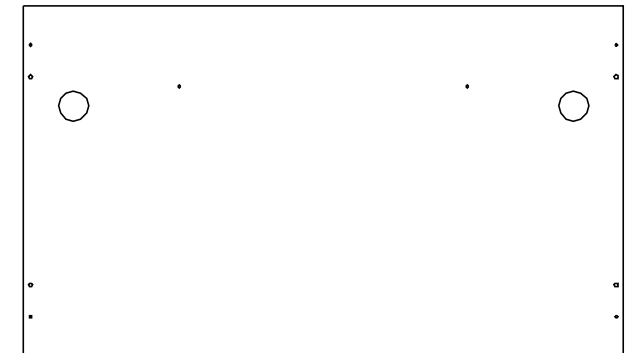

④ TOP PANEL  
Qty: 1 pc

### COMPONENTS

- A Minifix Steel Bolt 10259 (10 pcs)
- B DECO CAP 16x5mm (10 pcs)
- C Leveller M6 x 25 x 18mm (4 pcs)
- D GRO-PLC-RD59 (2 pcs)

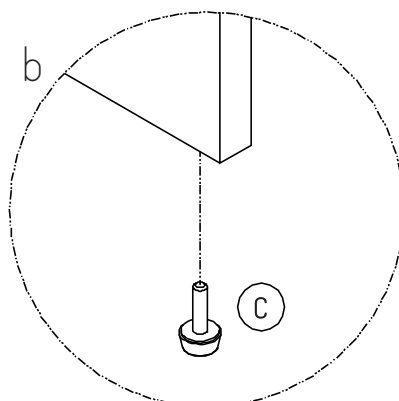
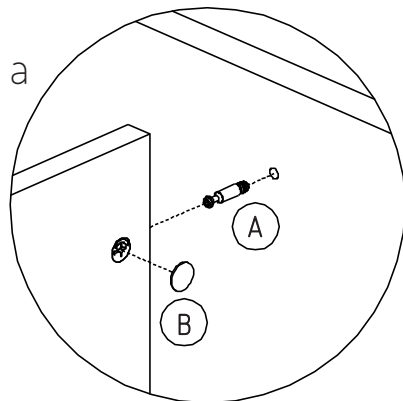

## ASSEMBLY INSTRUCTIONS

# Uniform Panel Return Desk with Closed Hutch

Sizes (mm): 1200L/1400L/1600L x 1600D

[www.jasonl.com.au](http://www.jasonl.com.au)

**Need help!**

Call us on  
**1300 527 665**

**jason.l**  
your office furniture mate

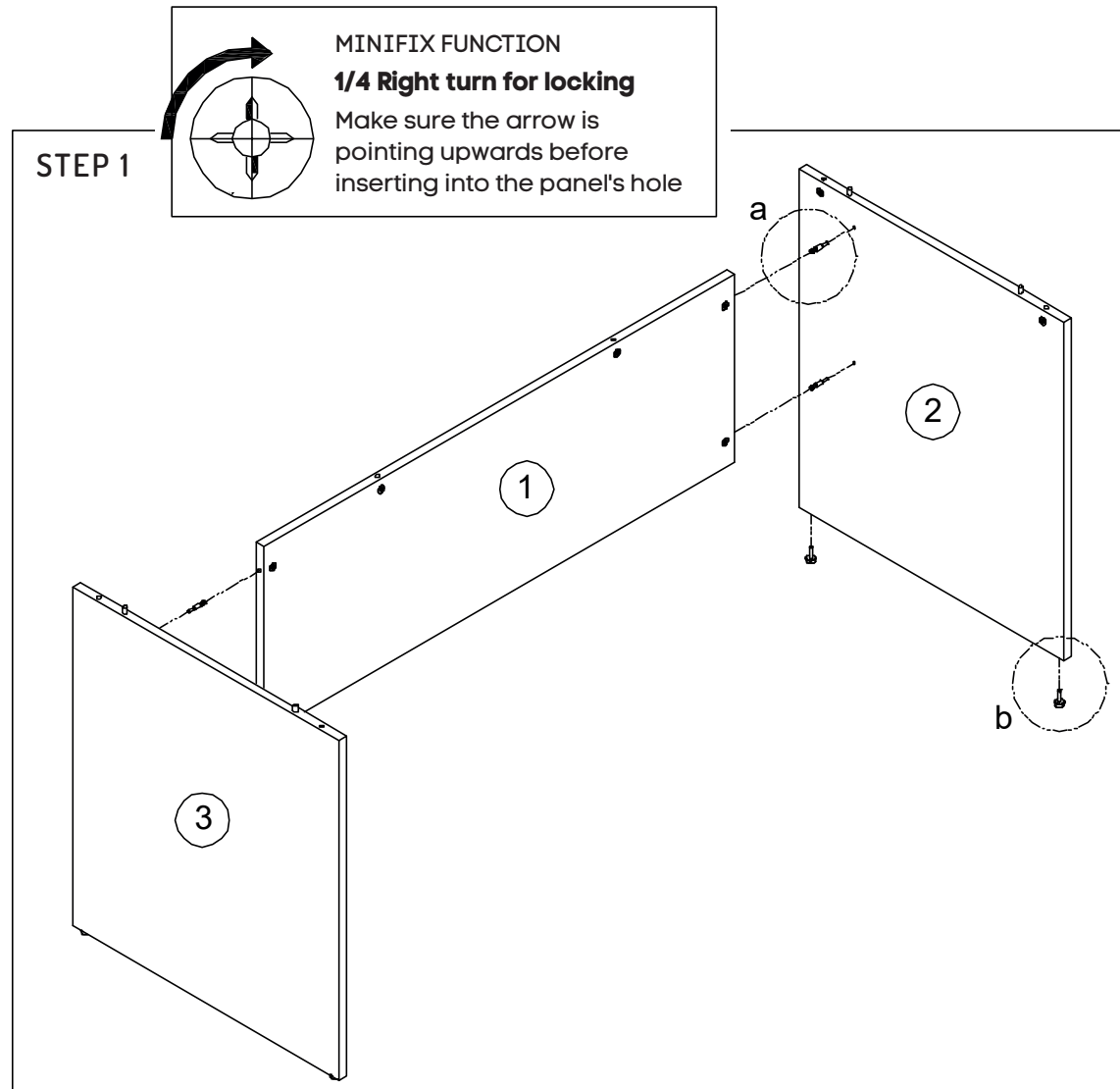

Assemble Part follow sequence number

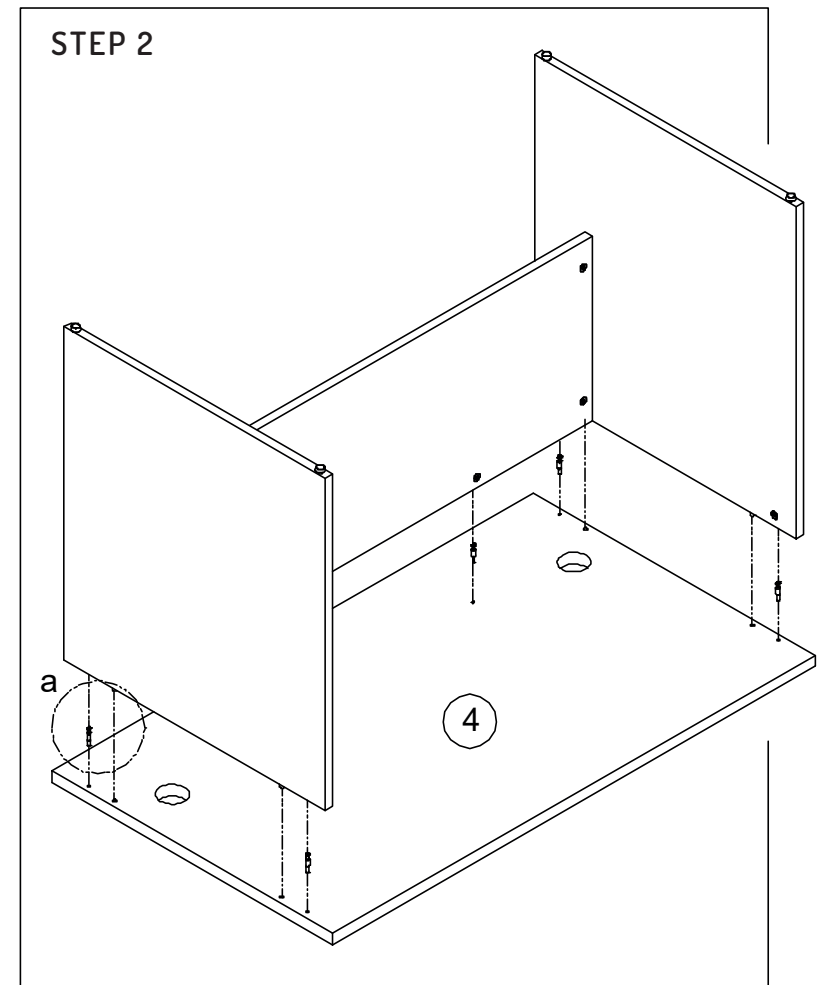

Assemble the assembly at step 1 to Top Panel

## ASSEMBLY INSTRUCTIONS

# Uniform Panel Return Desk with Closed Hutch

Sizes (mm): 1200L/1400L/1600L x 1600D

[www.jasonl.com.au](http://www.jasonl.com.au)

**Need help!**

Call us on  
**1300 527 665**

**jason.l**  
your office furniture mate



STEP 3

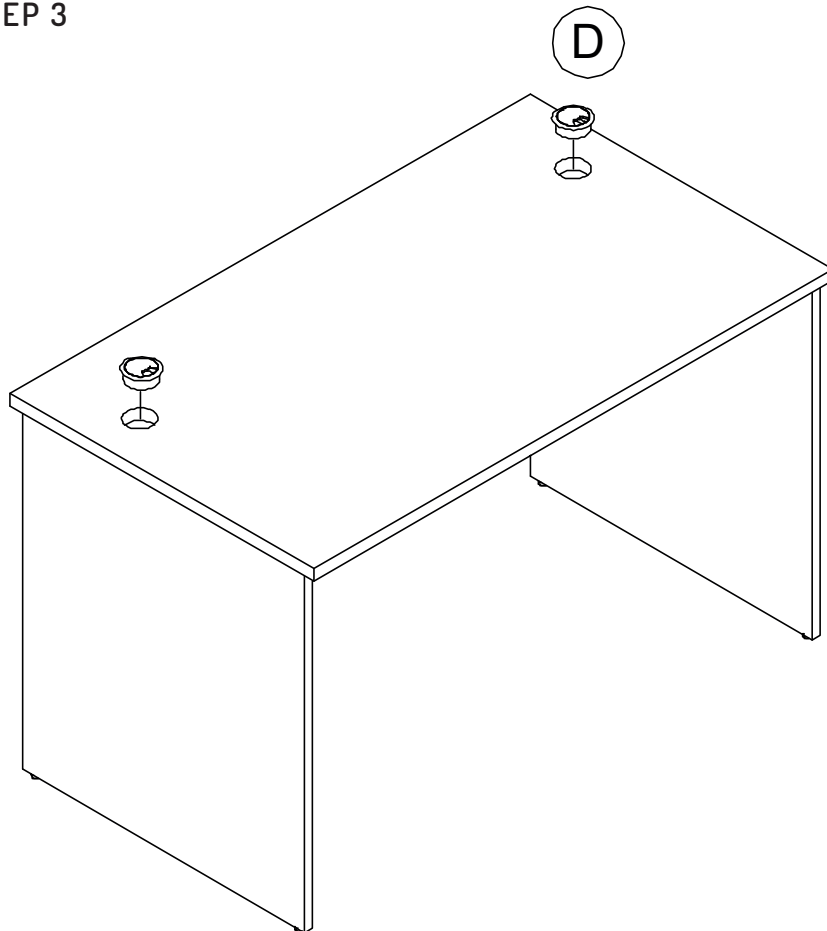

Assemble plastic grommet to table top

COMPLETE

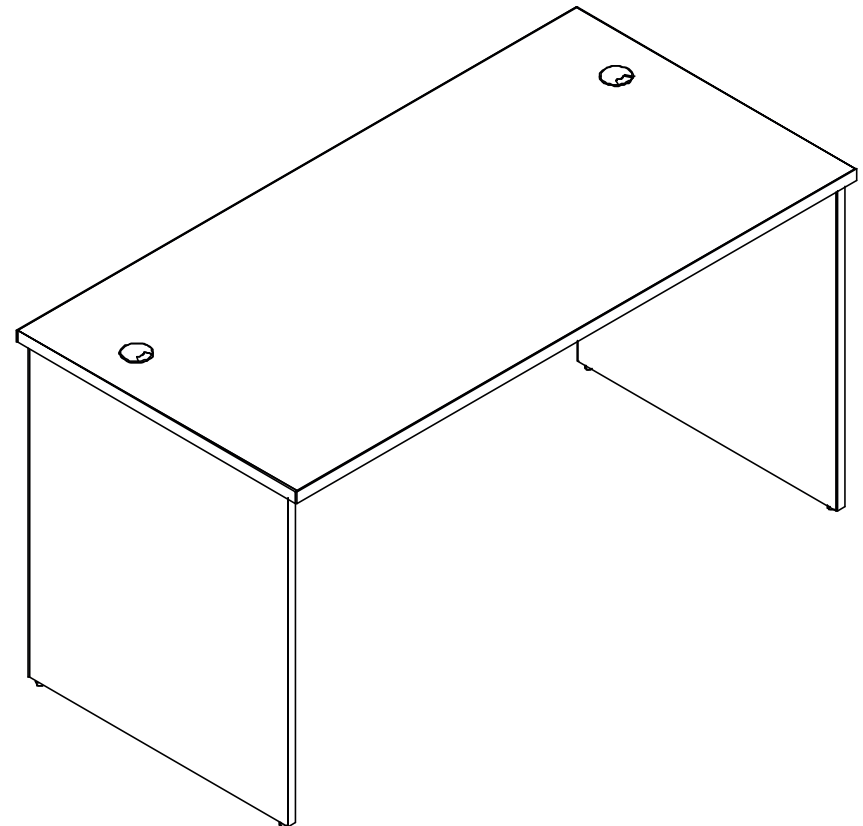

## ASSEMBLY INSTRUCTIONS

# Uniform Panel Return Desk with Closed Hutch

Sizes (mm): 1200L/1400L/1600L x 1600D

[www.jasonl.com.au](http://www.jasonl.com.au)

**Need help!**

Call us on  
**1300 527 665**

**jason.l**  
your office furniture mate



### Return assembly:

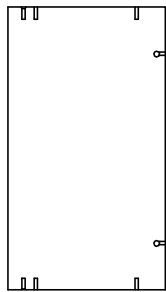

① FRONT PANEL  
Qty : 1 pc

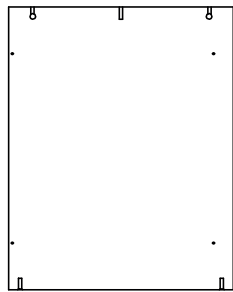

② SIDE PANEL L  
Qty : 1 pc

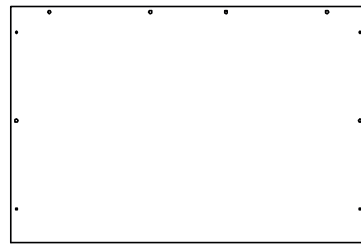

③ TOP PANEL  
Qty : 1 pc

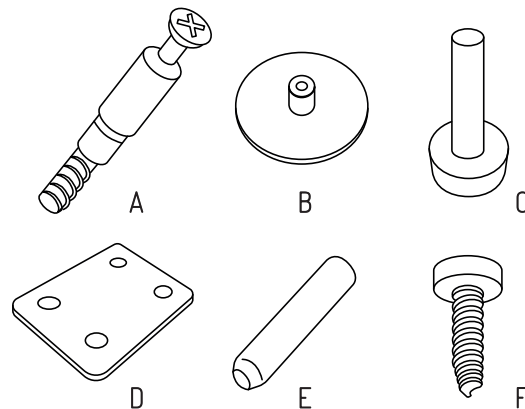
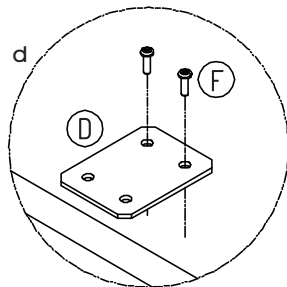
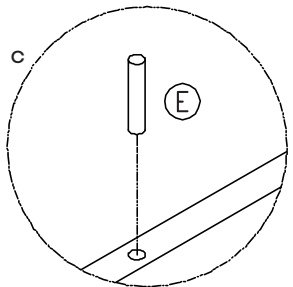
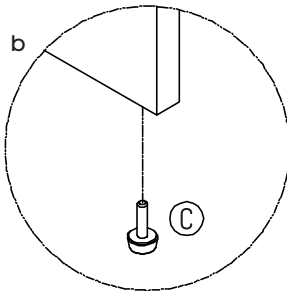
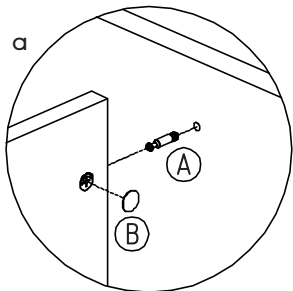

### COMPONENTS

- A Minifix Steel Bolt 10259 (4 pcs)
- B DECO CAP 16x5mm (4 pcs)
- C Leveller M6 x 25 x 18mm (3 pcs)
- D 4 Hole Bracket 80 x 60 x 3 mm (2 pcs)
- E Rubber Wood Dowel M8 x 40 (2 pcs)
- F Pan Head Self Tapping Screw #10 x 5/8" (8 pcs)

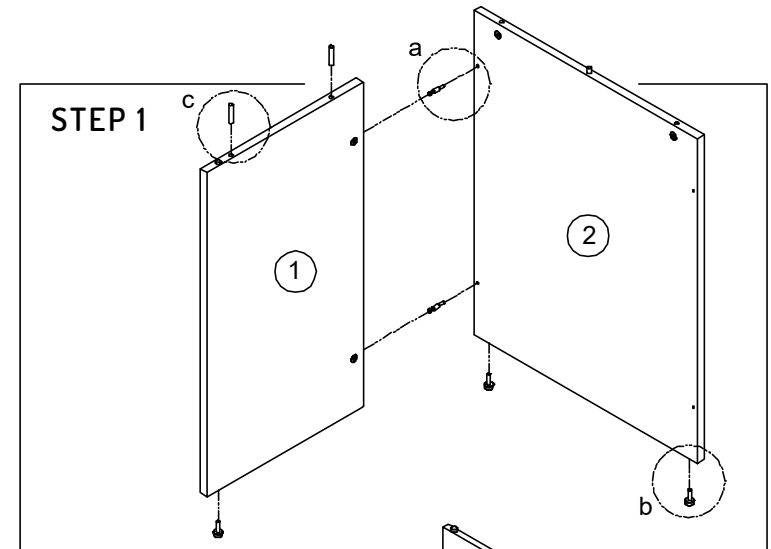

Assemble Part follow  
sequence number

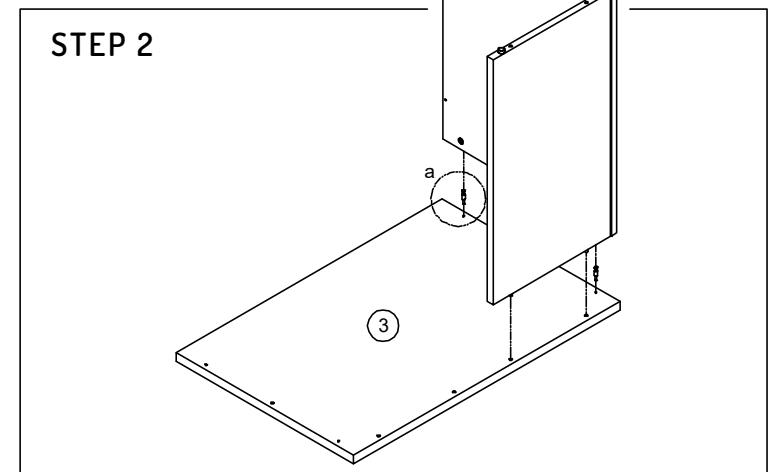

Assemble the assembly at step 1 to Top Panel

## ASSEMBLY INSTRUCTIONS

# Uniform Panel Return Desk with Closed Hutch

Sizes (mm): 1200L/1400L/1600L x 1600D

[www.jasonl.com.au](http://www.jasonl.com.au)

**Need help!**

Call us on  
**1300 527 665**

**jason.l**  
your office furniture mate



### Return assembly:

#### STEP 3

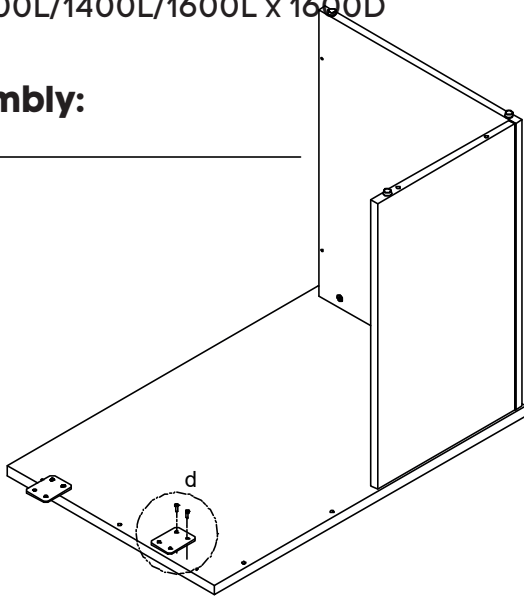

Assemble Part follow sequence number

#### COMPLETE

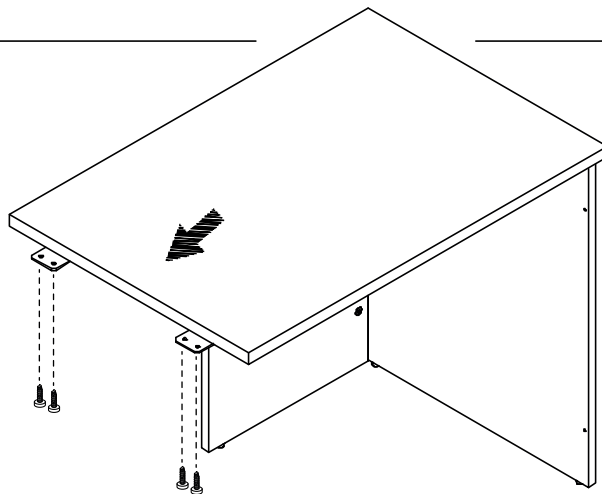

Please assemble and drill screw underneath table top

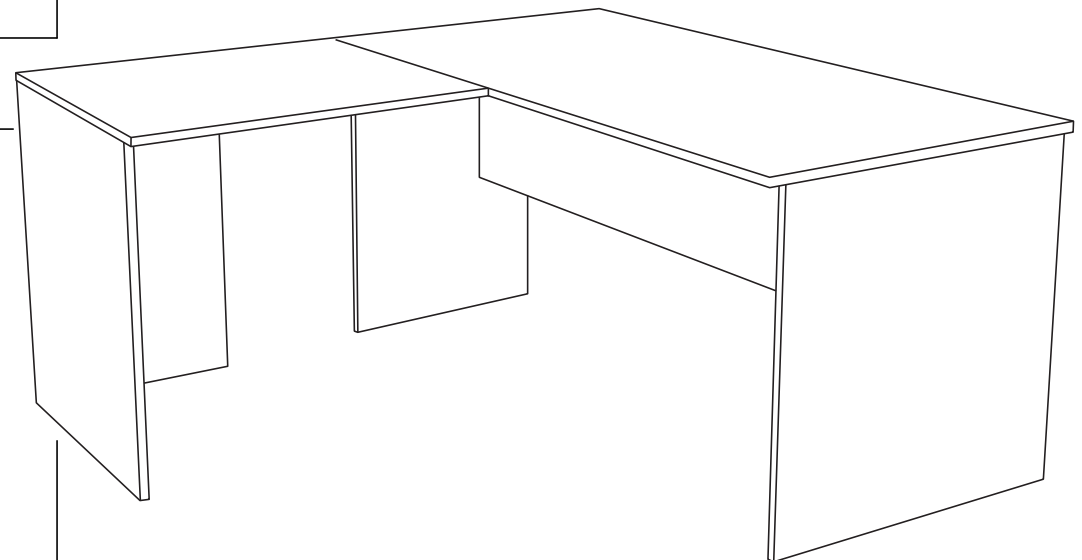

ASSEMBLY INSTRUCTIONS

# Uniform Panel Return Desk with Closed Hutch

Sizes (mm): 1200L/1400L/1600L x 1600D

[www.jasonl.com.au](http://www.jasonl.com.au)

**Need help!**

Call us on  
**1300 527 665**

**jason.l**  
your office furniture mate

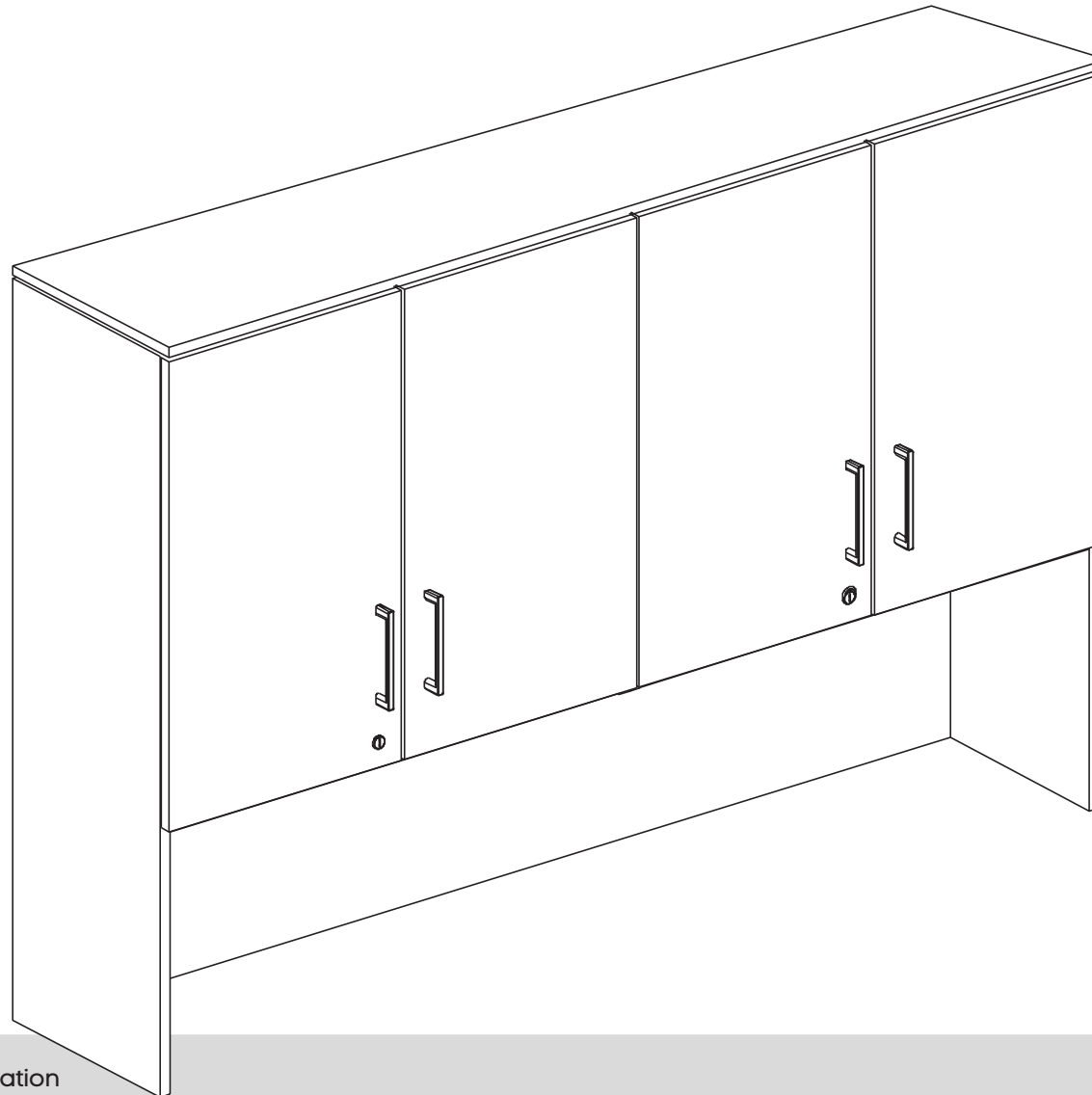

2 persons required for installation



## ASSEMBLY INSTRUCTIONS

# Uniform Panel Return Desk with Closed Hutch

Sizes (mm): 1200L/1400L/1600L x 1600D

[www.jasonl.com.au](http://www.jasonl.com.au)

**Need help!**

Call us on  
**1300 527 665**

**jason.l**  
your office furniture mate

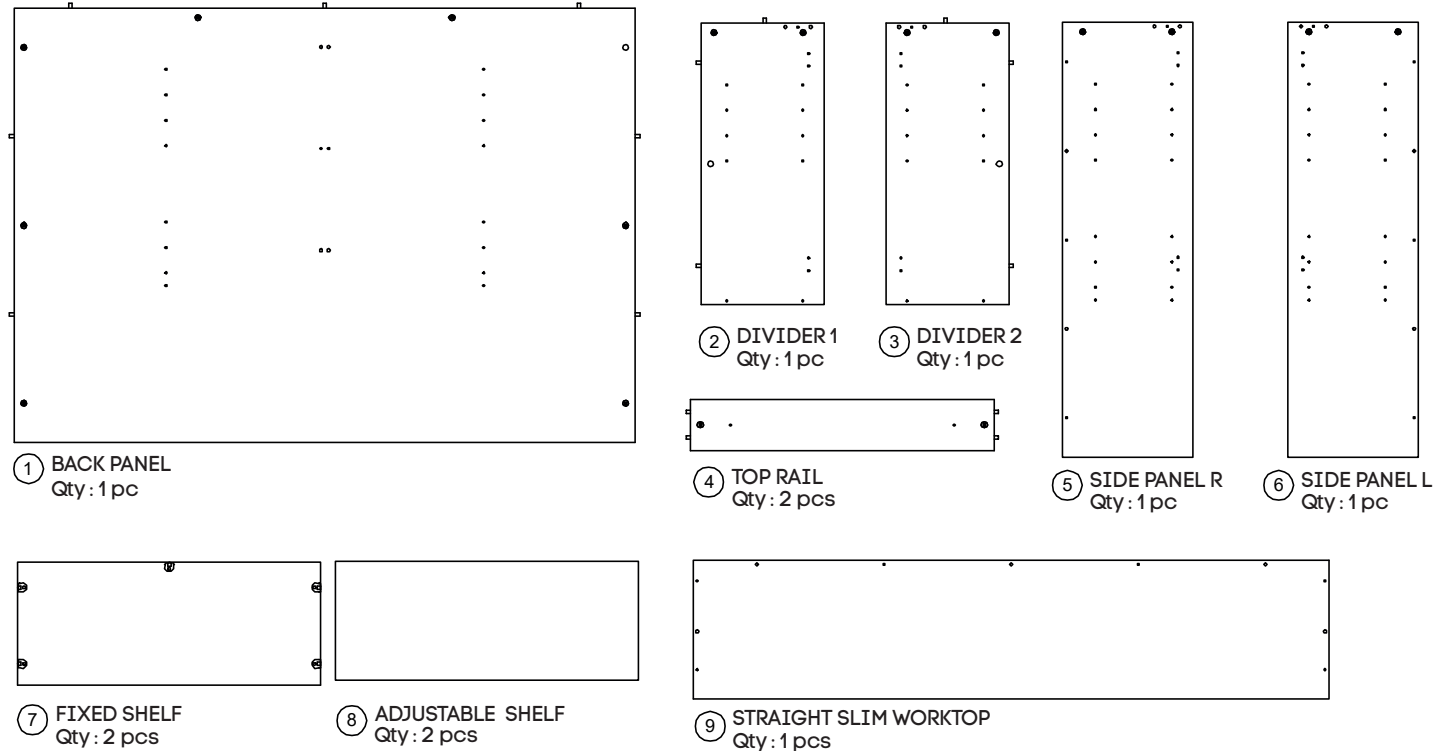
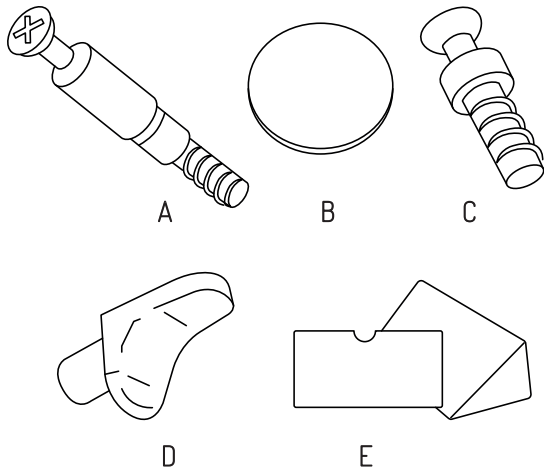
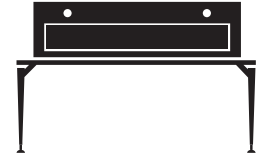

## COMPONENTS

- A Minifix Steel Bolt 10259 (22 pcs)
- B Deco Sticker 20mm Common (22 pcs)
- C Minifix Rafix Bolt 263-20-847 (10 pcs)
- D Collar Stud 284.84.710 (10 pcs)
- E Panel Angle Bracket 03 (2 Sets)

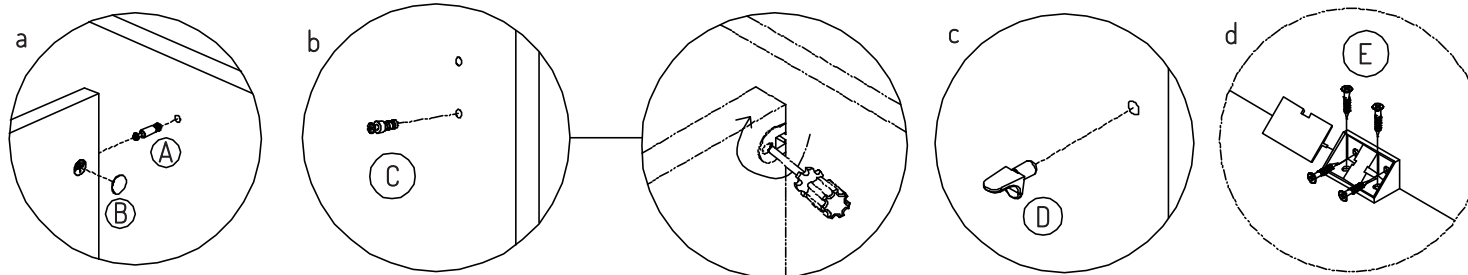

Direct screw to fix it

## ASSEMBLY INSTRUCTIONS

# Uniform Panel Return Desk with Closed Hutch

Sizes (mm): 1200L/1400L/1600L x 1600D

[www.jasonl.com.au](http://www.jasonl.com.au)

**Need help!**

Call us on  
**1300 527 665**

**jason.l**  
your office furniture mate



### STEP 1

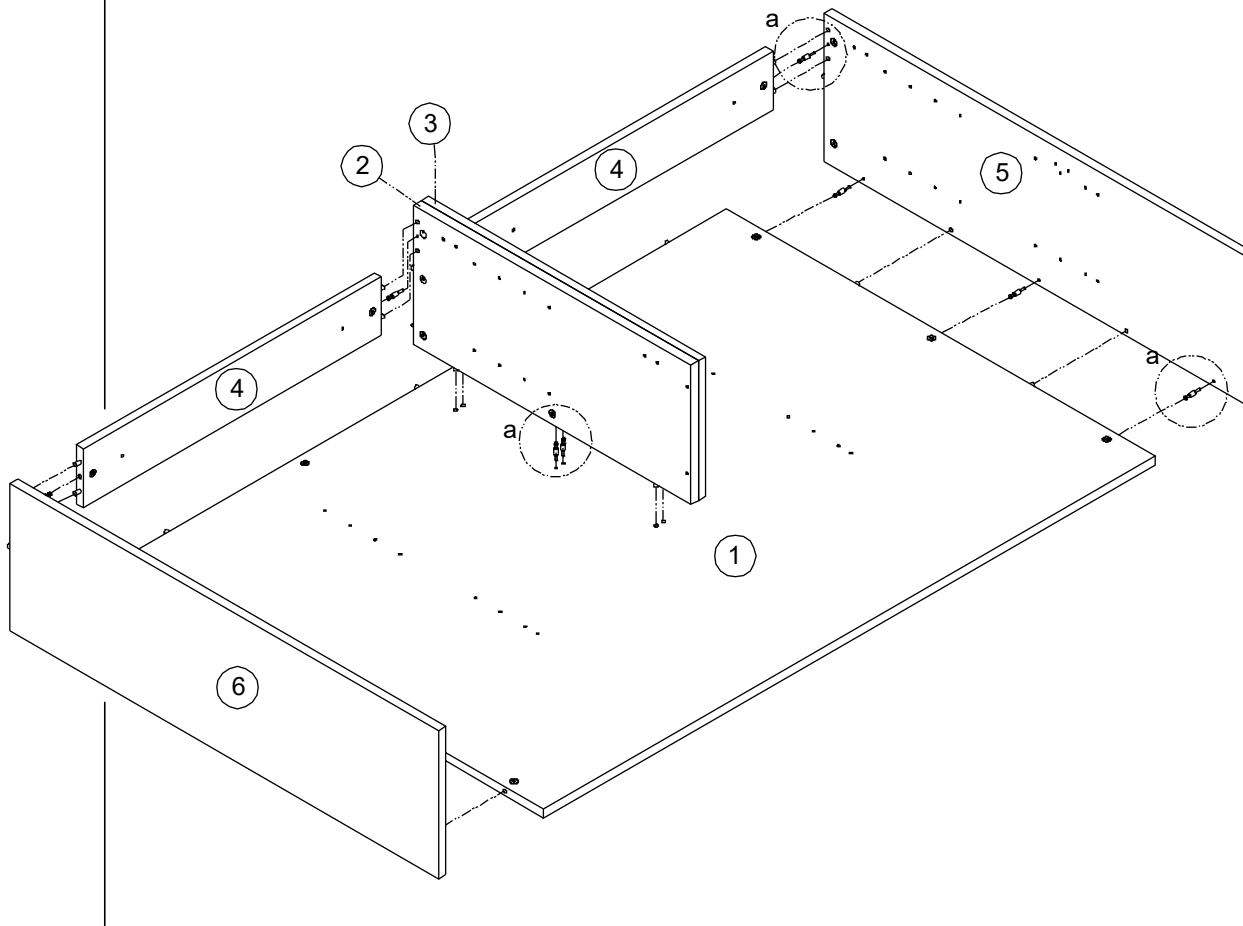

### STEP 2

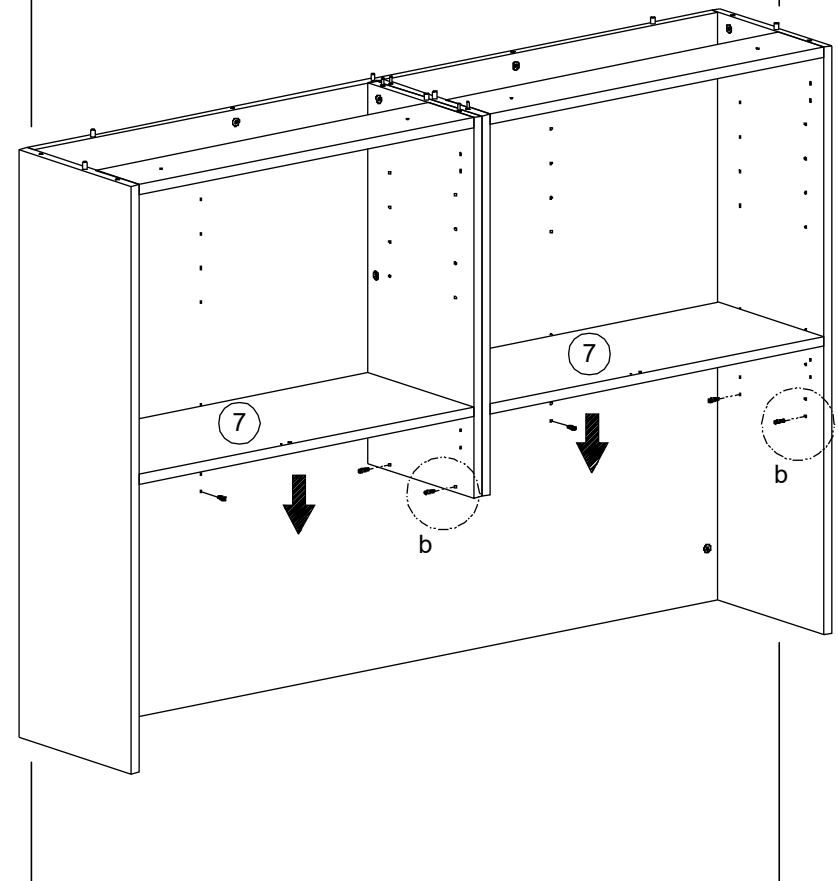

Assemble Part follow sequence number

Assemble the fixed shelf

## ASSEMBLY INSTRUCTIONS

# Uniform Panel Return Desk with Closed Hutch

Sizes (mm): 1200L/1400L/1600L x 1600D

[www.jasonl.com.au](http://www.jasonl.com.au)

**Need help!**

Call us on  
**1300 527 665**

**jason.l**  
your office furniture mate

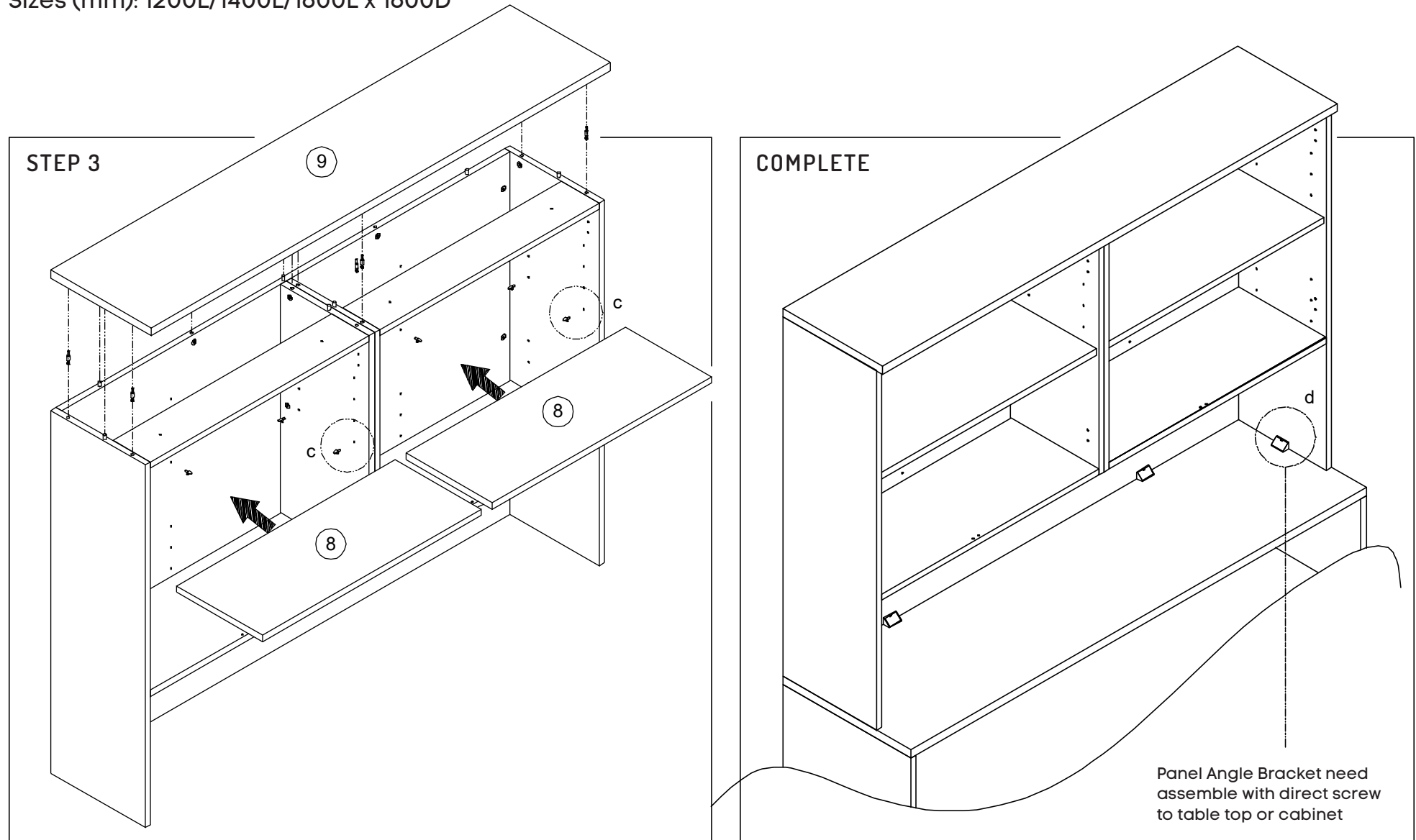

Assemble the adjustable shelf & straight slim worktop

## ASSEMBLY INSTRUCTIONS

# Uniform Panel Return Desk with Closed Hutch

Sizes (mm): 1200L/1400L/1600L x 1600D

[www.jasonl.com.au](http://www.jasonl.com.au)

**Need help!**

Call us on  
**1300 527 665**

**jason.l**  
your office furniture mate



### Assembly doors:

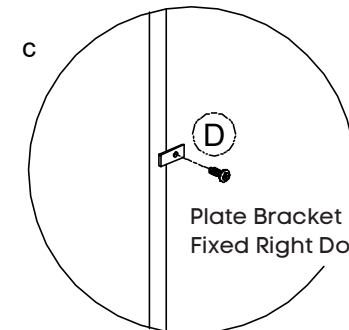
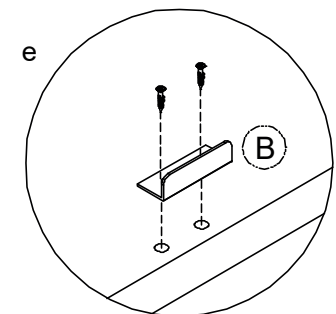
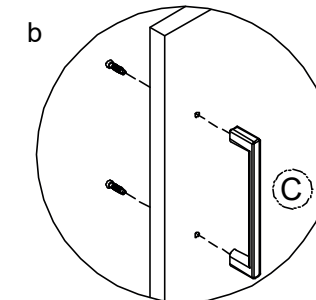
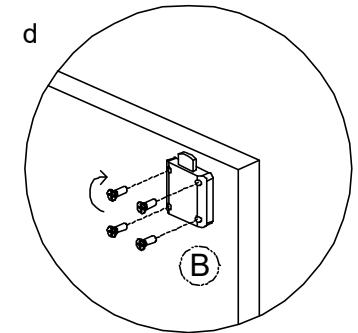
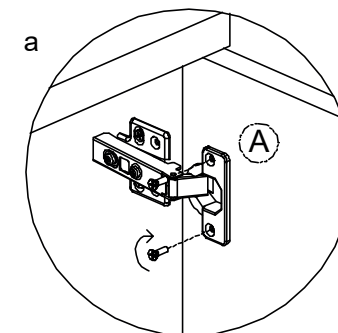
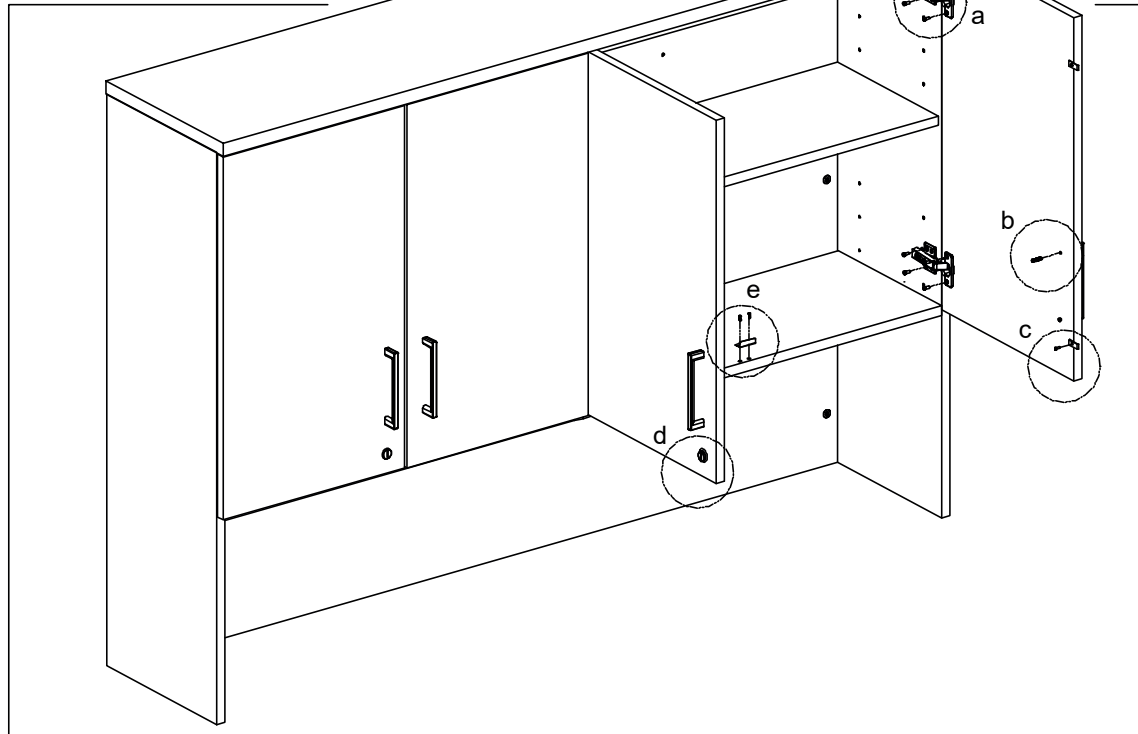

### COMPONENTS

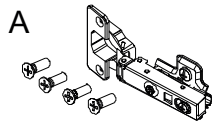

5/8 Soft Close Door  
Hinge c/w Mounting  
Plate And Screw 4 SETS

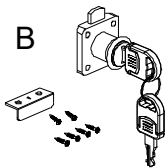

ACC-RIM-LOCK-648  
BK-L-HUWIL-34X13X10 1 SET

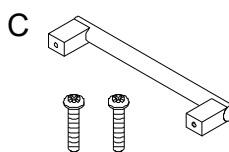

HD-SPB04-128  
2 PCS

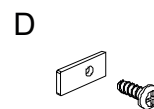

BK-25X10X2 = 2PCS  
S-PHS-#4x1/2 = 2PCS