

ASSEMBLY INSTRUCTIONS

Uniform 2 Door Medium Storage Cupboard with Planter Box

Size (mm): 800W x 450D x 1395H

www.jasonl.com.au

Need help!

Call us on
1300 527 665

jason.l
your office furniture mate

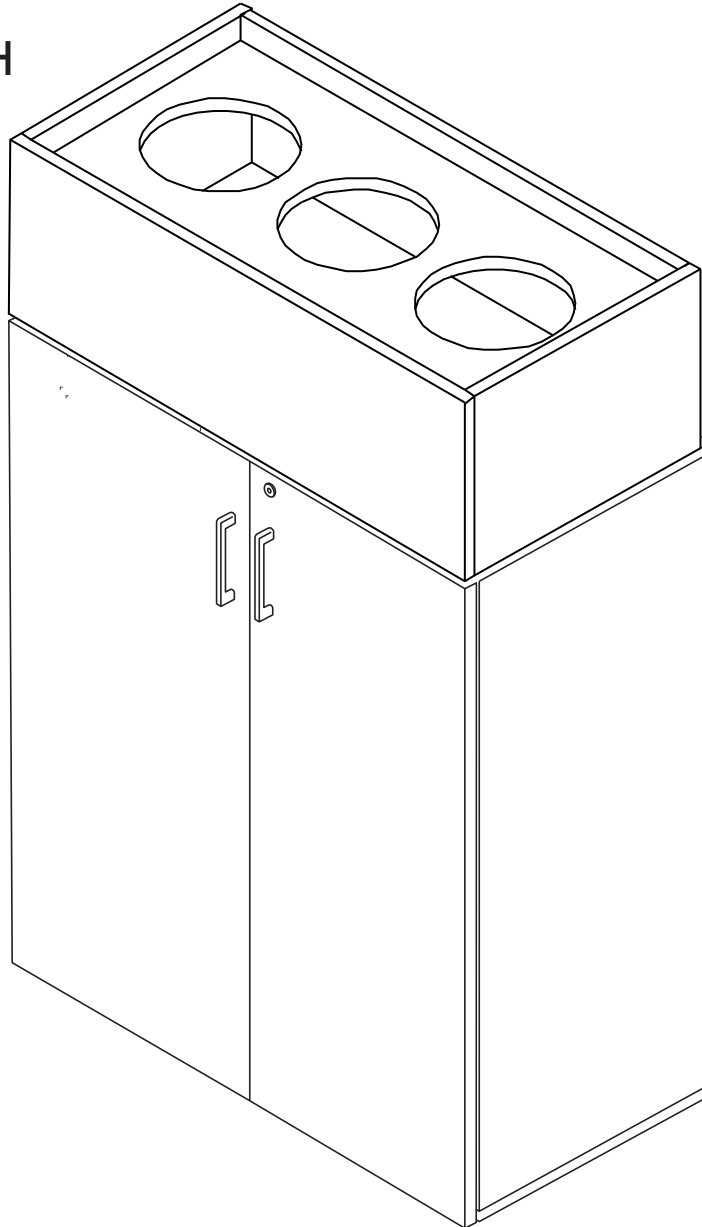

ASSEMBLY INSTRUCTIONS

Uniform 2 Door Medium Storage Cupboard with Planter Box

Size (mm): 800W x 450D x 1395H

www.jasonl.com.au

Need help!

Call us on
1300 527 665

jason.l
your office furniture mate

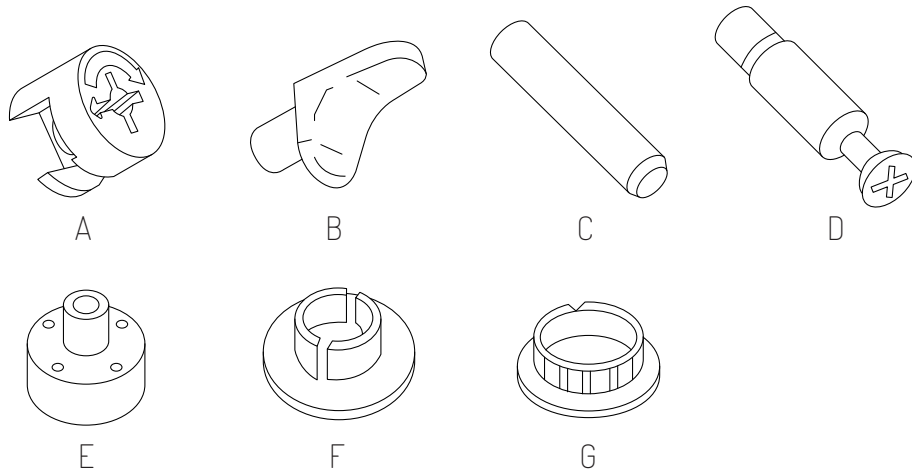

COMPONENTS

A	Minifix Housing x16	E	Adjustable Leveller N2880 x5
B	Collar Stud x10	F	Leveller N2880 Cap x5
C	Rubber Wood Dowel M8 x40mm x12	G	Deco Cap x5
D	Minifix Connecting Bolt x16	H	Safety hook *

PANELS

Back Panel x1
Side Panel x2
Base Panel x1
Shelf Panel x2
Top Rail x1 (*)
Door Panel x2

DOOR ASSEMBLY

5/8 Door Hinge c/w Mounting Plate x4
Chipboard Screw 4x16mm x24
CSK Tapping Screw #4 3/4" x4
Rim Lock CL 2/3 x1
Pan Head Self Tapping Screw x4
L Huwil Bracket x1
Plate Bracket BK x1

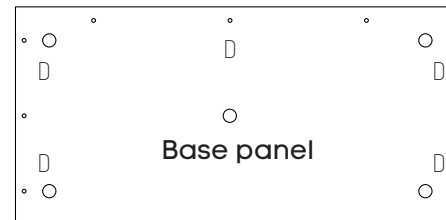
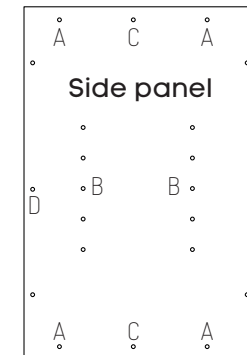
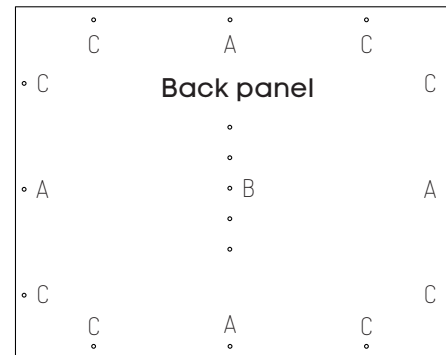

(*) The top rail is only required when assembling this unit with doors.

ASSEMBLY INSTRUCTIONS

Uniform 2 Door Medium Storage Cupboard with Planter Box

Size (mm): 800W x 450D x 1395H

www.jasonl.com.au

Need help!

Call us on
1300 527 665

jason.l
your office furniture mate



Function of Klix Cam
Turn for locking
75° Min - 195° Max

Make sure the arrow is pointing upwards before inserting into the panel's hole.

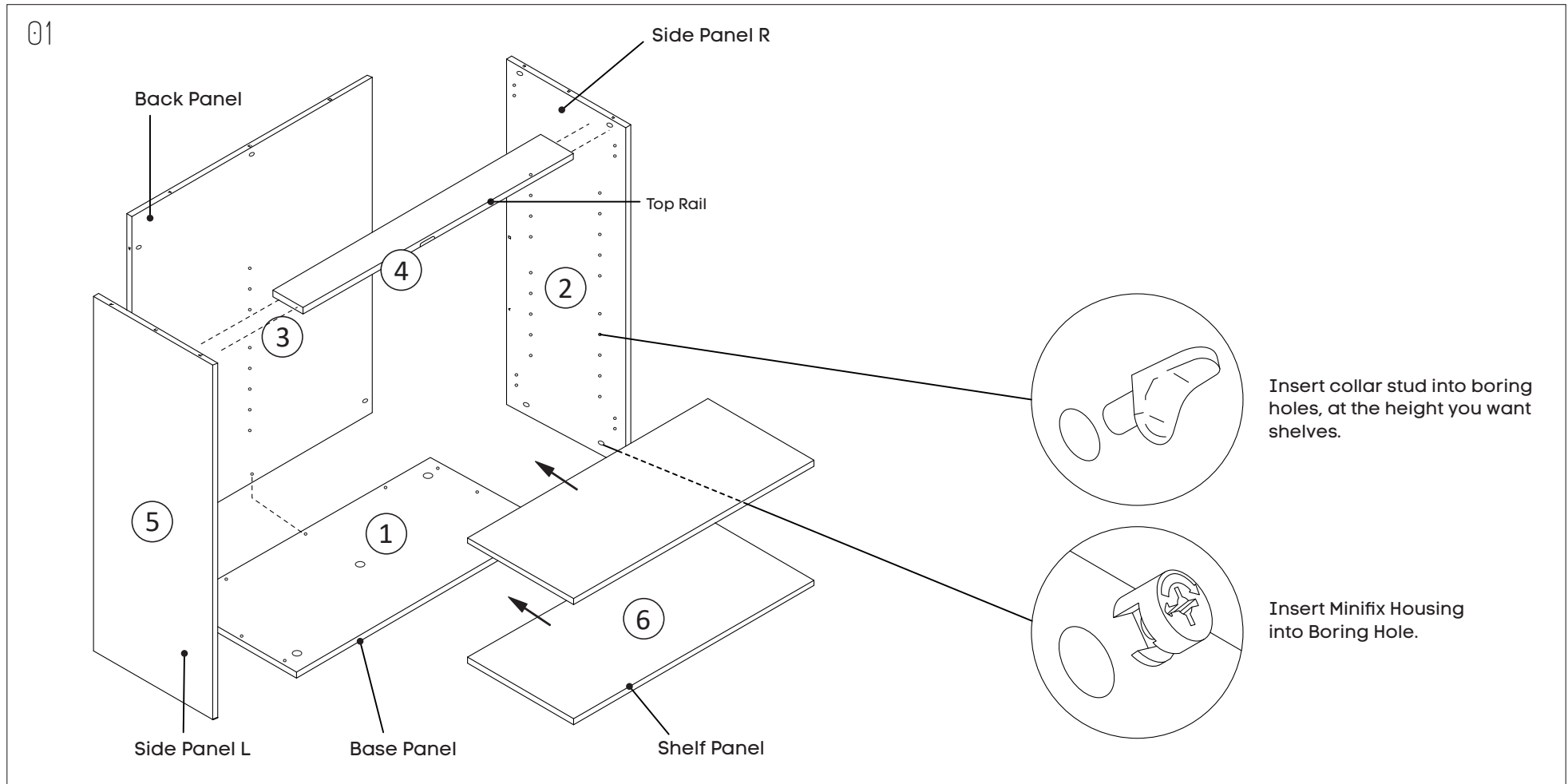

Assemble all panels in the following order.

ASSEMBLY INSTRUCTIONS

Uniform 2 Door Medium Storage Cupboard with Planter Box

Size (mm): 800W x 450D x 1395H

www.jasonl.com.au

Need help!

Call us on
1300 527 665

jason.l
your office furniture mate

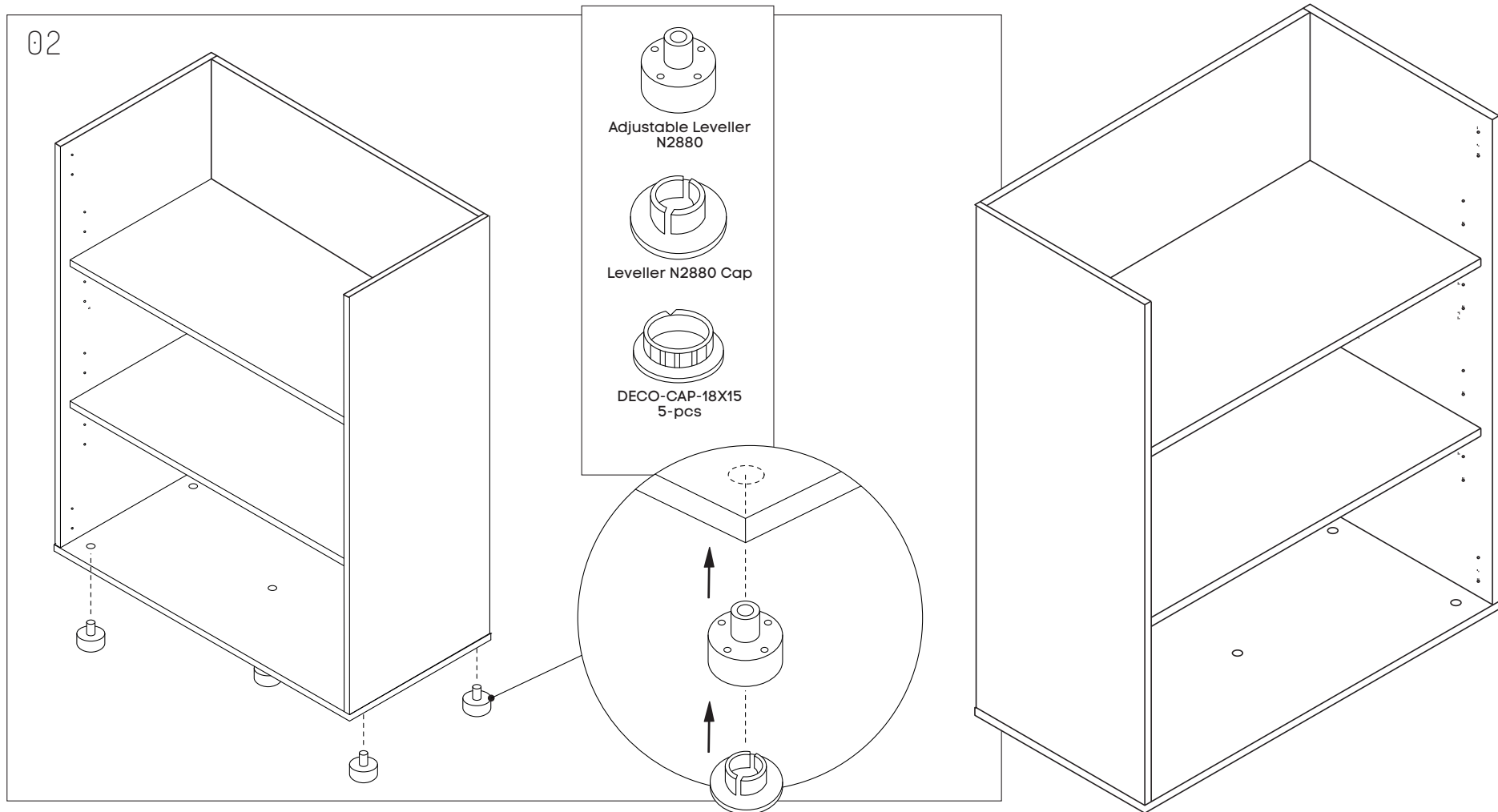

Tighten leveller into boring hole and screw the cap.
Use DECO-CAP-18X15 to seal holes on base panel.

ASSEMBLY INSTRUCTIONS

Uniform 2 Door Medium Storage Cupboard with Planter Box

Size (mm): 800W x 450D x 1395H

www.jasonl.com.au

Need help!

Call us on
1300 527 665

jason.l
your office furniture mate

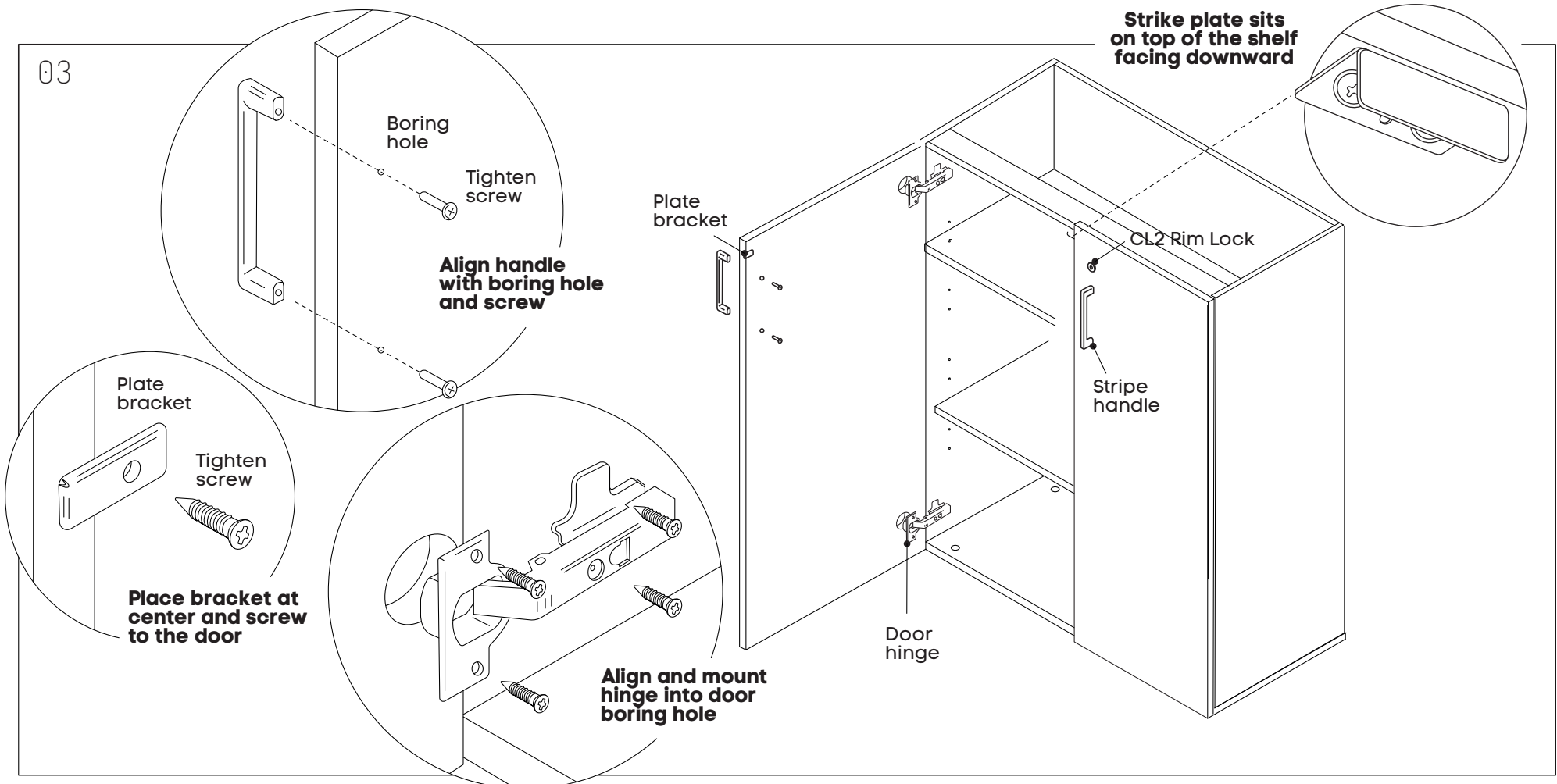

Tighten leveller into boring hole and screw the cap.
Use DECO-CAP-18X15 to seal holes on base panel.

ASSEMBLY INSTRUCTIONS

Uniform 2 Door Medium Storage Cupboard with Planter Box

Size (mm): 800W x 450D x 1395H

www.jasonl.com.au

Need help!

Call us on
1300 527 665

jason.l
your office furniture mate



Planter Box assembly

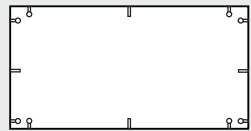

① BASE PANEL
Qty: 1 pc

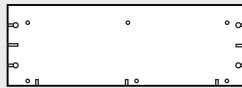

② BACK PANEL
Qty: 1 pc



③ SIDE PANEL L
Qty: 1 pc

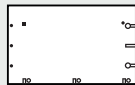

④ SIDE PANEL R
Qty: 1 pc

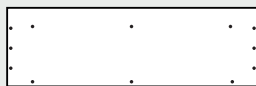

⑤ FRONT PANEL
Qty: 1 pc

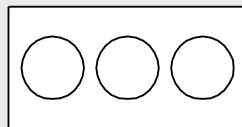

⑥ TOP PANEL
Qty: 1 pc



Collar Stud
262.24.710
4 pcs



Minifix Steel
Bolt 10259
16 pcs



DECO-CAP
16x5
16 pcs

Step 1.

Assemble component follow sequence number

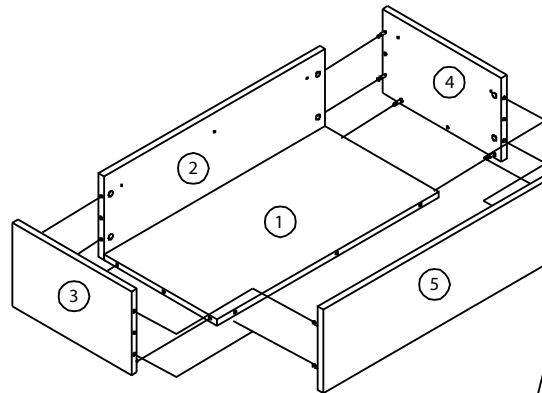

Step 2.

Insert collar stud into boring hole

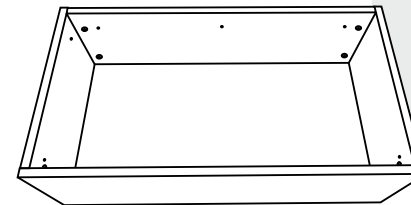
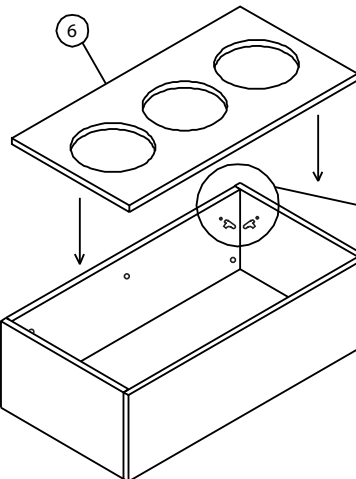

Note:

The bottom panel should be facing down. Screws holes must be seen from the outside only.

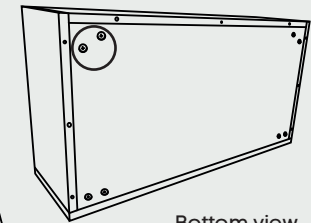

Bottom view

Note For Minifix Cam

Important Function of Klix cam



1/4 RIGHT TURN FOR

LOCKING Make Sure The Arrow Is Pointing Upwards Before Inserting Into The Panel's Hole

ASSEMBLY INSTRUCTIONS

Uniform 2 Door Medium Storage Cupboard with Planter Box

Size (mm): 800W x 450D x 1395H

www.jasonl.com.au

Need help!

Call us on
1300 527 665

jason.l
your office furniture mate



Step 3.

Assemble planter box bottom panel on top of carcass and complete assembly

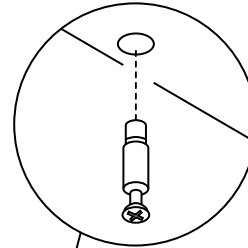
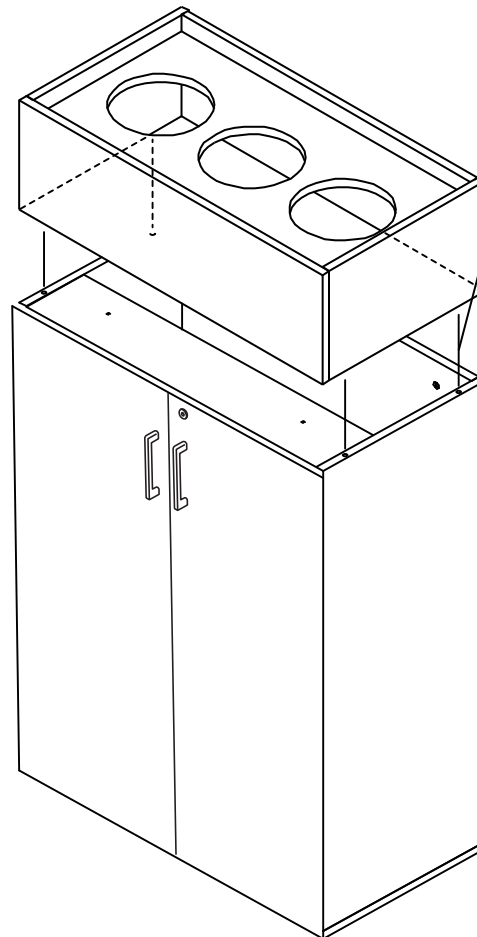

Tighten Minifix
Connecting into
Boring Hole.

**Complete
assembly**

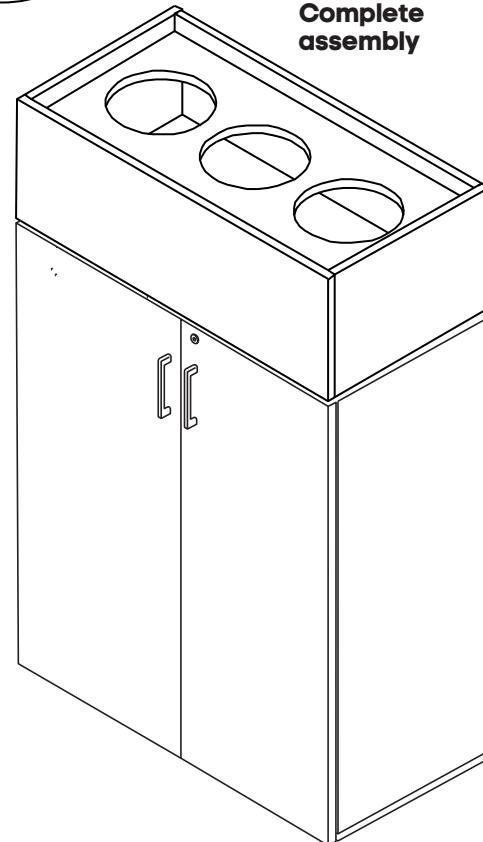

ASSEMBLY INSTRUCTIONS

Uniform 2 Door Medium Storage Cupboard with Planter Box

Size (mm): 800W x 450D x 1395H

www.jasonl.com.au

Need help!

Call us on
1300 527 665

jason.l
your office furniture mate



Safety hook *

Large furniture provides ample storage space while making your home look great. If you have kids at home, you should firmly secure your large and heavy furniture to prevent it from toppling.

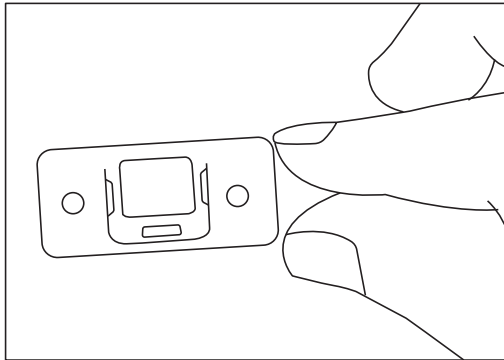

First set the location for install

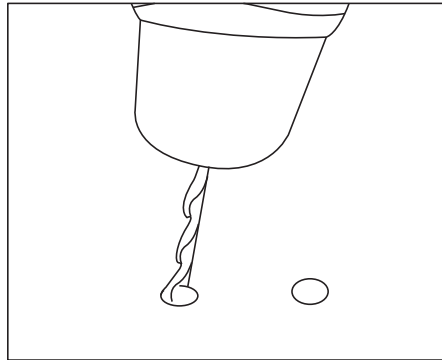

Select the location where the wall is installed and punch Ø8 mm

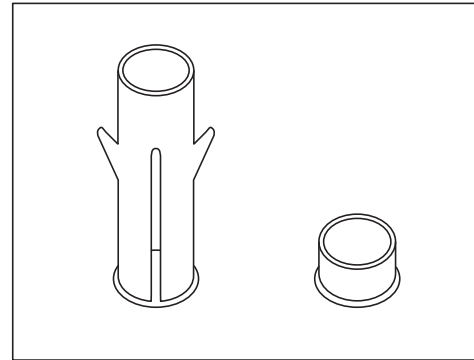

Install the screw expansion tube into the hole

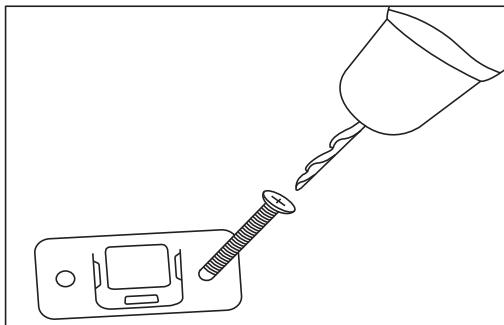

Mounting screws

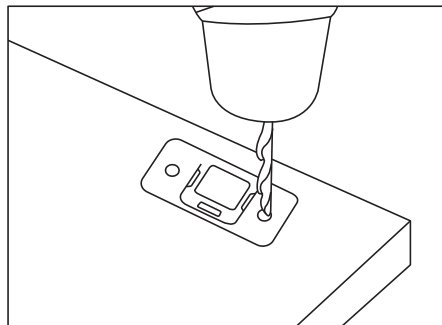

Choose a location that is fixed in the furniture

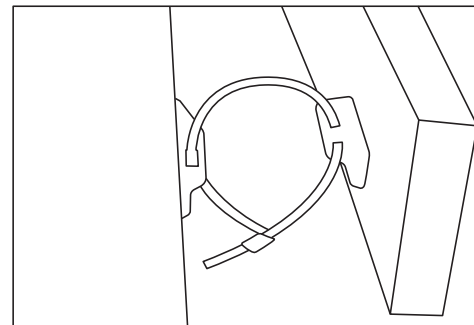

Adjust the distance of the connecting belt and complete the installation

Components included

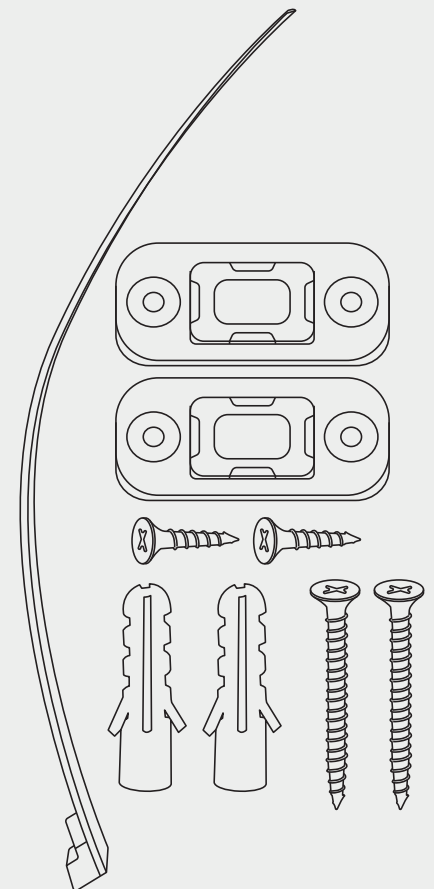

JasonL strongly recommends that the safety hook will be utilized in all circumstances to prevent falls when the bookcase is installed on uneven ground, is unevenly packed or is interfered with by pets, children, or as a result of any other household or commercial activity. We disclaim all liability for any loss occasioned in the event that the safety hook is not used or has been improperly installed