

ASSEMBLY INSTRUCTIONS

Horizon privacy screen

Sizes: 1200 / 1600 mm wide / 820 mm height

www.jasonl.com.au

Need help!

Call us on
1300 527 665

jason.l
your office furniture mate

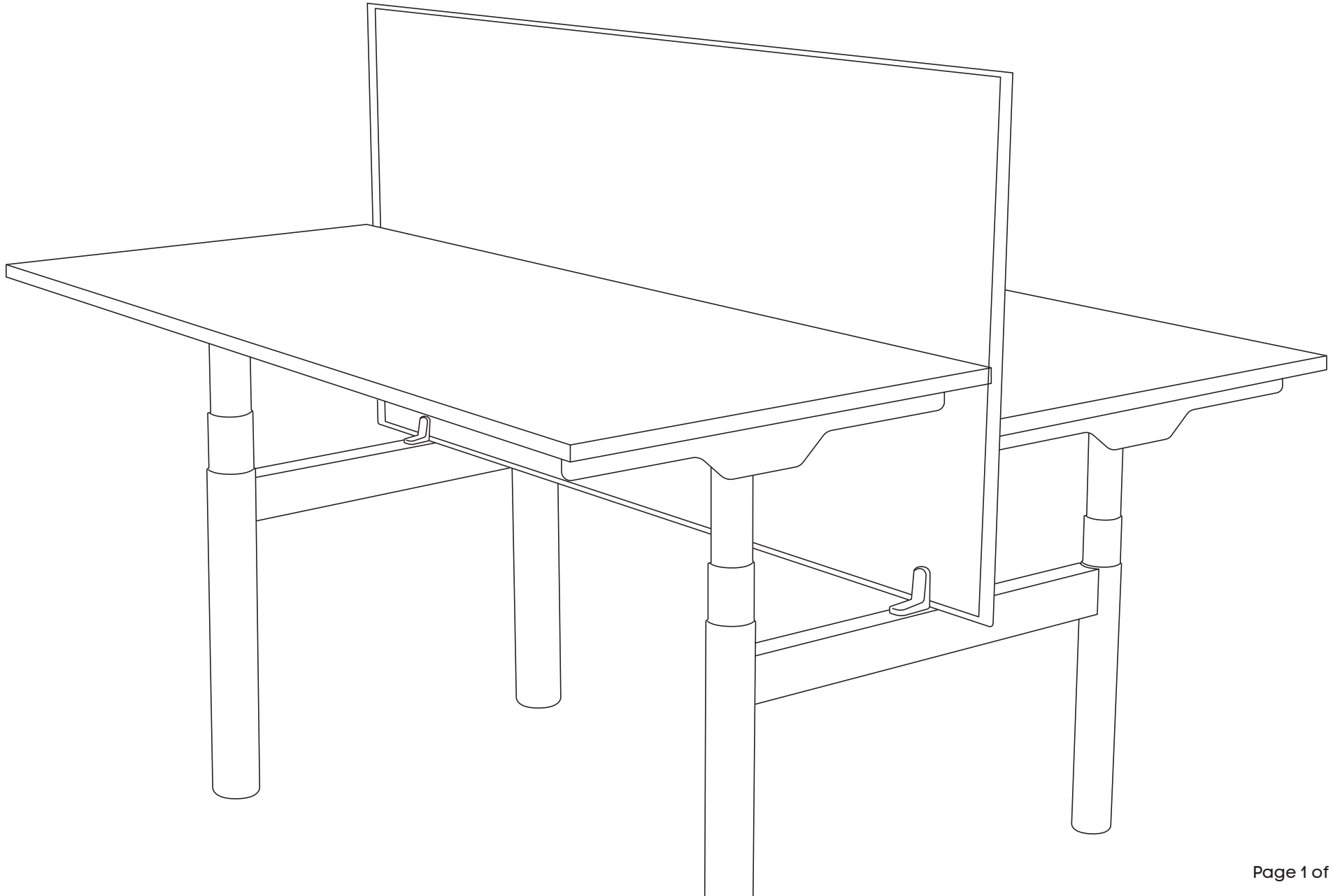

ASSEMBLY INSTRUCTIONS

Horizon privacy screen

Sizes: 1200 / 1600 mm wide / 820 mm height

www.jasonl.com.au

Need help!

Call us on
1300 527 665

jason.l
your office furniture mate

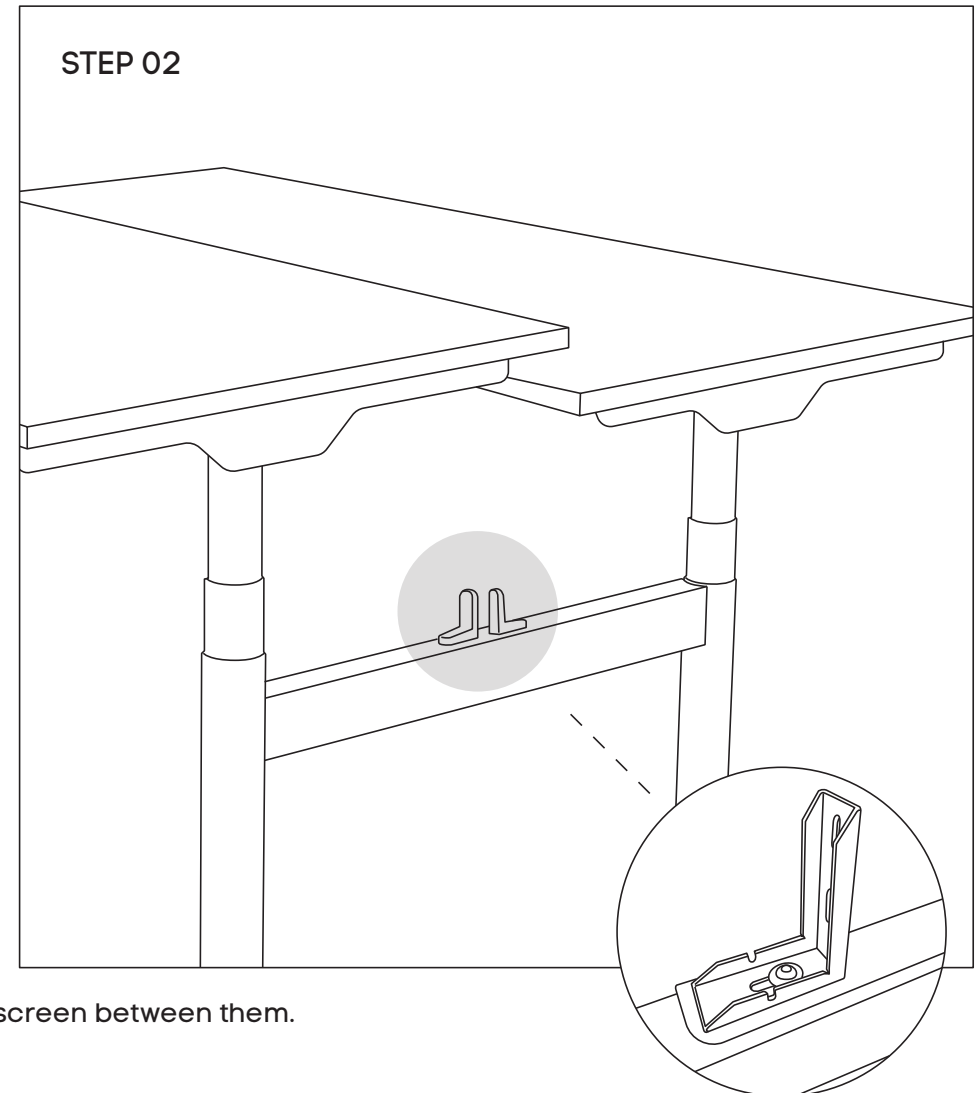
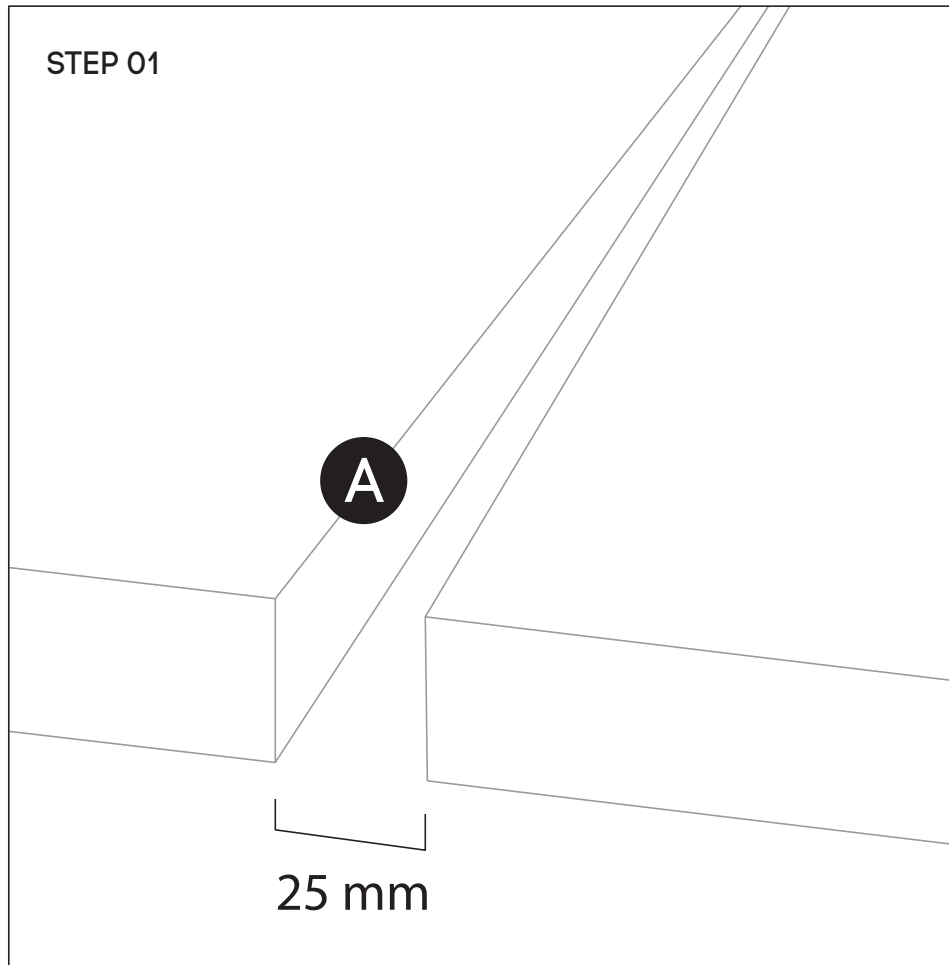

Step 1: Please leave 25mm gap between table tops (A) so we can place screen between them.

Step 2: Please assemble L-shape brackets on both sides.

ASSEMBLY INSTRUCTIONS

Horizon privacy screen

Sizes: 1200 / 1600 mm wide / 820 mm height

www.jasonl.com.au

Need help!

Call us on
1300 527 665

jason.l
your office furniture mate

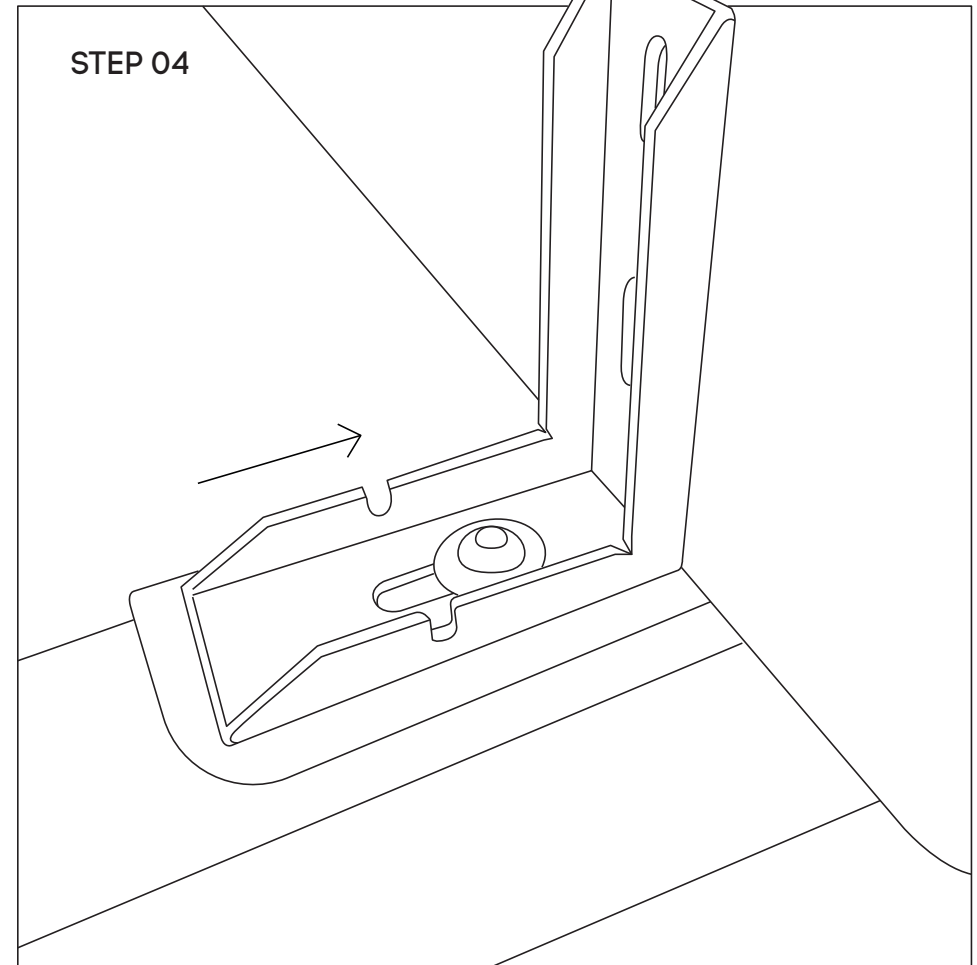
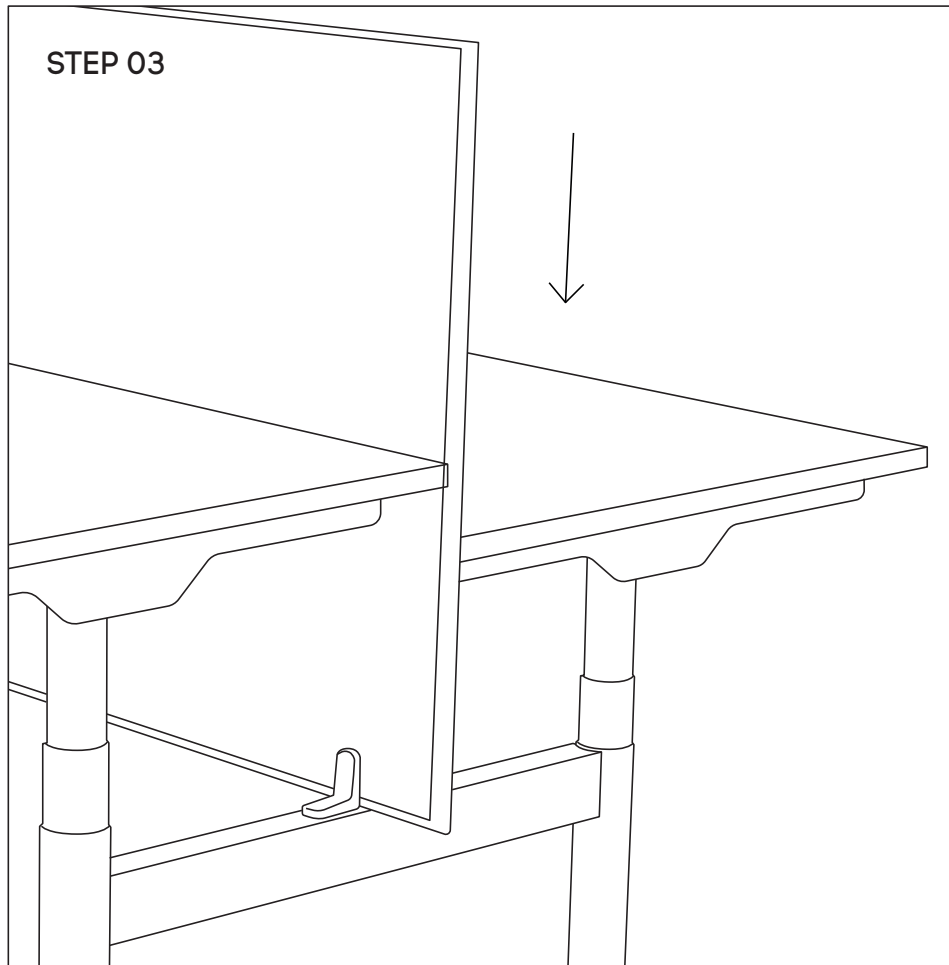

Step 3: Once the L-shape brackets are assembled, please place the screen in between the two L-Shape brackets.

Step 4: Please move forward the two L-shape brackets and tighten the screws to clamp screen from both sides. Repeat this step to assemble the second pair of L-shape brackets on the other end of the workstation.

ASSEMBLY INSTRUCTIONS

Horizon privacy screen

Sizes: 1200 / 1600 mm wide / 820 mm height

www.jasonl.com.au

Need help!

Call us on
1300 527 665

jason.l
your office furniture mate

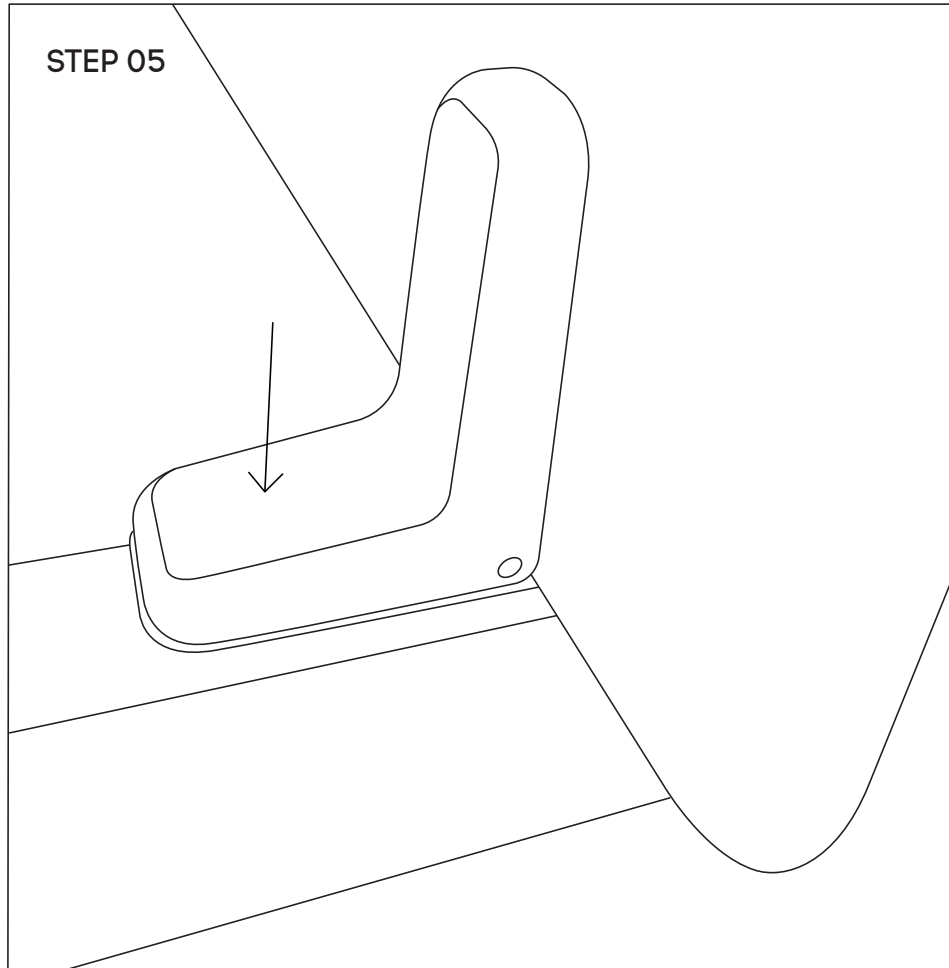

Step 5: Please put L brackets cover on both sides and each ends.

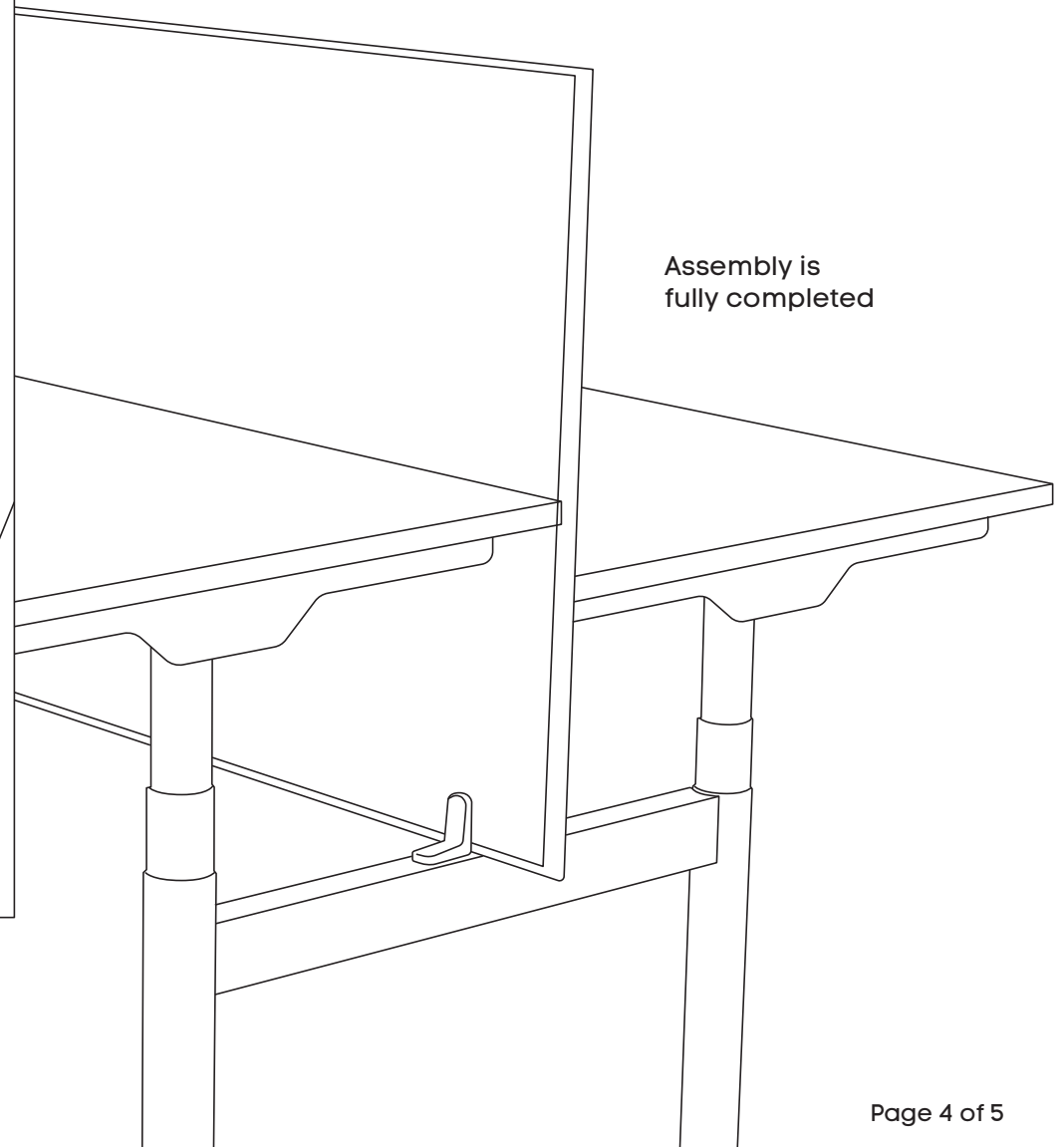

ASSEMBLY INSTRUCTIONS

Horizon privacy screen

Sizes: 1200 / 1600 mm wide / 820 mm height

www.jasonl.com.au

Need help!

Call us on
1300 527 665

jason.l
your office furniture mate



STEP 06

If you purchased a 2, 4 or 6 person bench workstations.

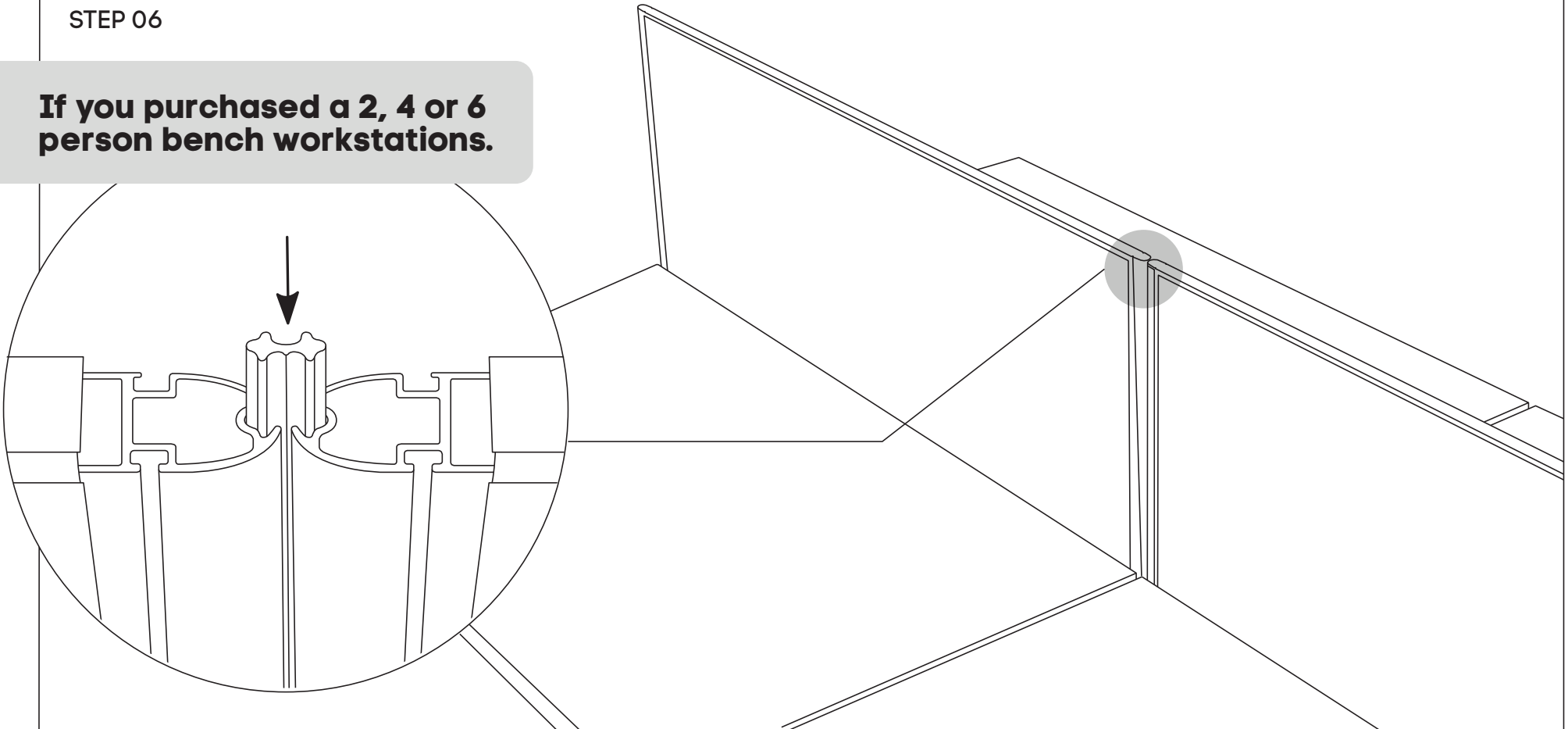

Using an Allen key remove top 2 caps from screens uprights. The two partitions should be next to each other.
Please slide the 2 way connector rod - down between the two screen uprights.