

ASSEMBLY INSTRUCTIONS

Quadro Wood A Leg Counter Frame

www.jasonl.com.au

Need help!

Call us on
1300 527 665

jason.l
your office furniture mate



Sizes:

1000x1000
1200x700
1200x1200
1400x700
1600x700
1800x700
2000x700

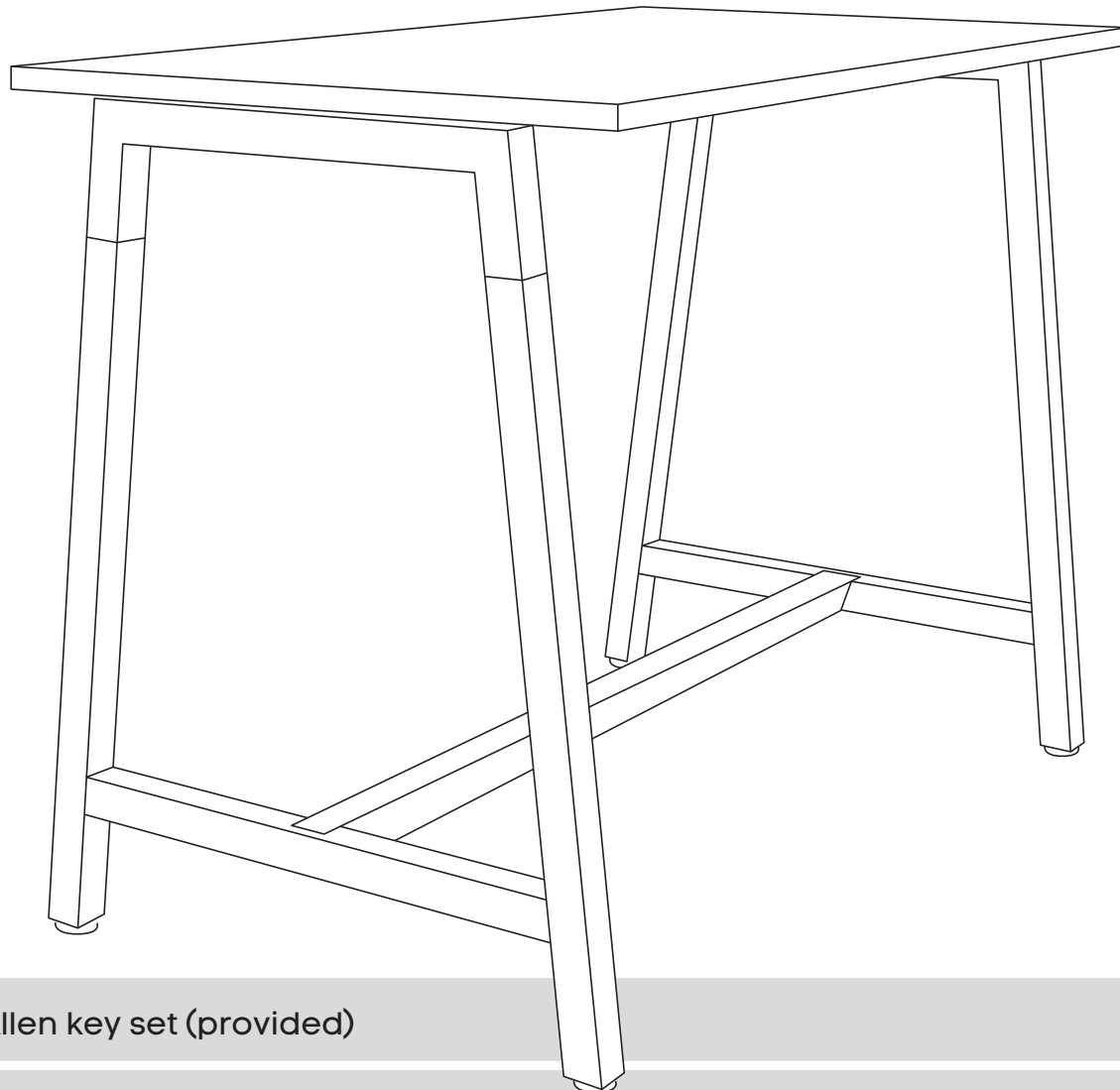

Tools Required: Power screwdriver; Allen key set (provided)

 2 persons required for installation

ASSEMBLY INSTRUCTIONS

Quadro Wood A Leg Counter Frame

www.jasonl.com.au

Need help!

Call us on
1300 527 665

jason.l
your office furniture mate



COMPONENTS

- A Table top x1
- B Leg Quadro A (Half leg) x2
- C Leg wood add on x4
- D Leg bottom beam
- E Upper beam x1 *
- F Lower beam x1
- G Plastic bracket x4
- H Feets or Wheels x4 **

SCREWS

- I M8x20MM CSK x8
- J M8x20MM socket head x2
- K M6x20MM socket head x4
- L M6x30MM socket head x4
- M Pins x2
- N Corner pads x4
- O Mushroom head M6x30 x4

- P Allen key x2

* Colour of the beam is always black, regardless desk frame colour.

** If you purchase with wheels option

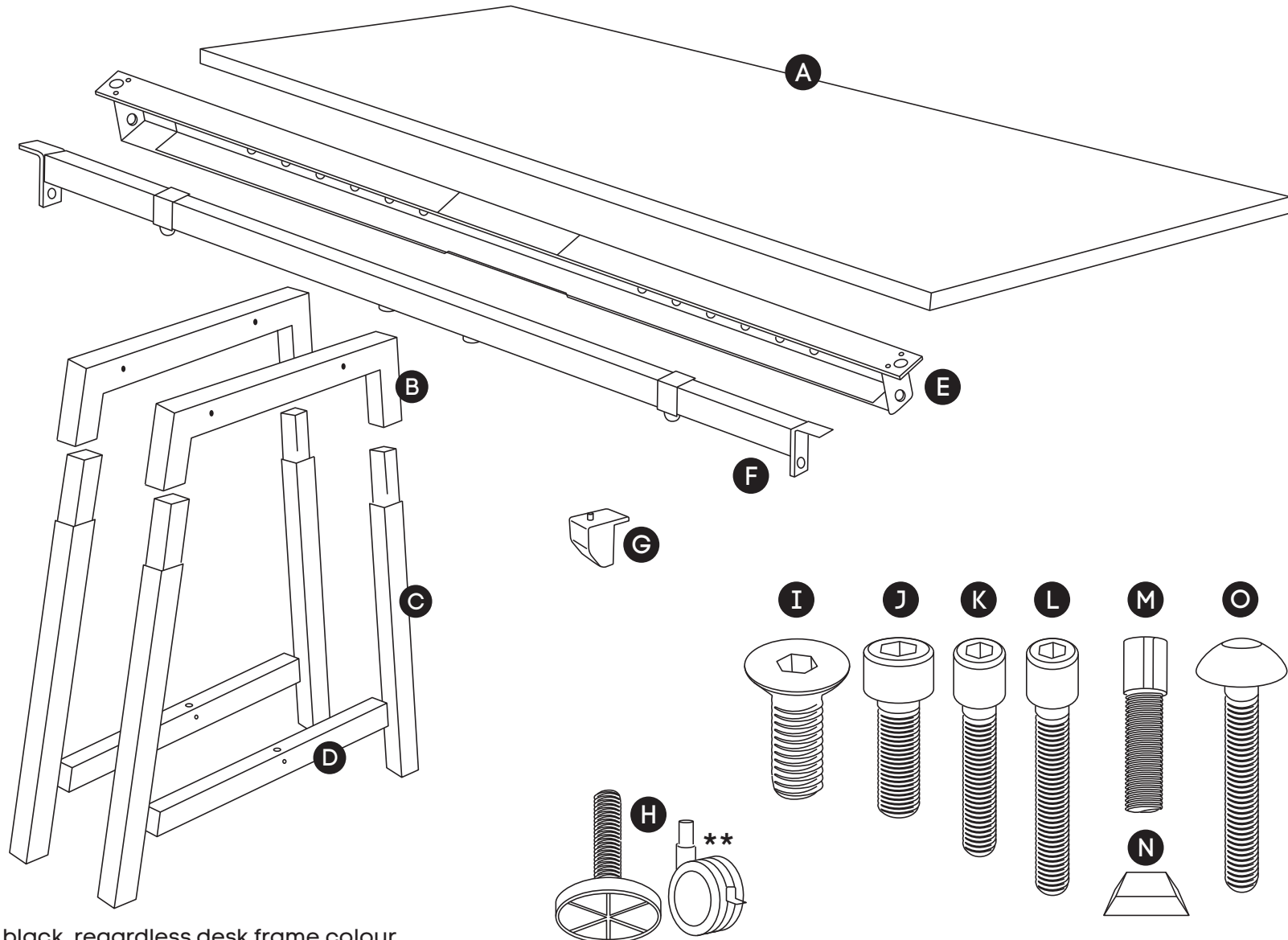

ASSEMBLY INSTRUCTIONS

Quadro Wood A Leg Counter Frame

www.jasonl.com.au

Need help!

Call us on
1300 527 665

jason.l
your office furniture mate



STEP 01

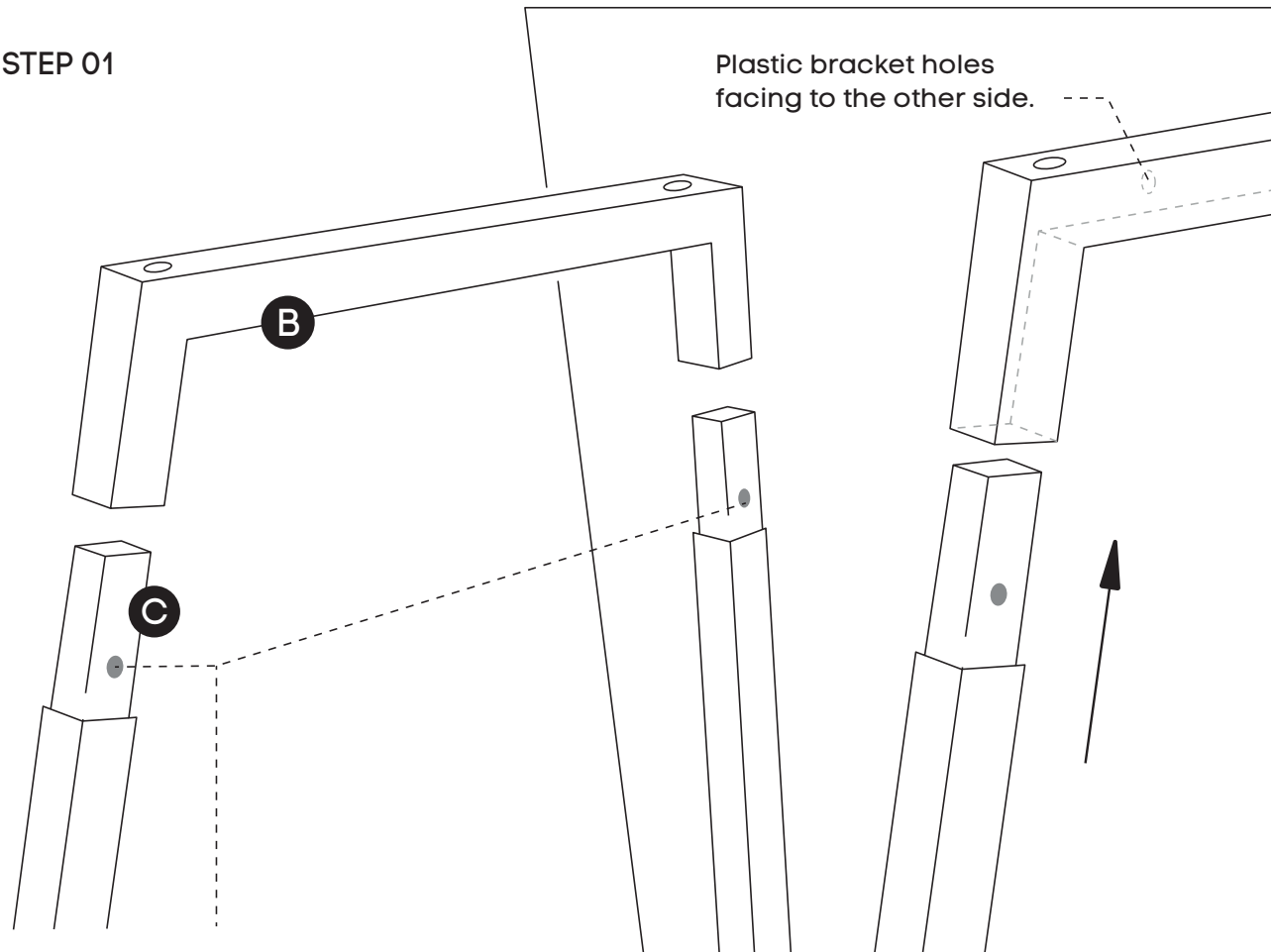

You will notice two colored stickers located on each leg.

Both legs must have the colour sticker facing away from where the plastic brackets are inserted.

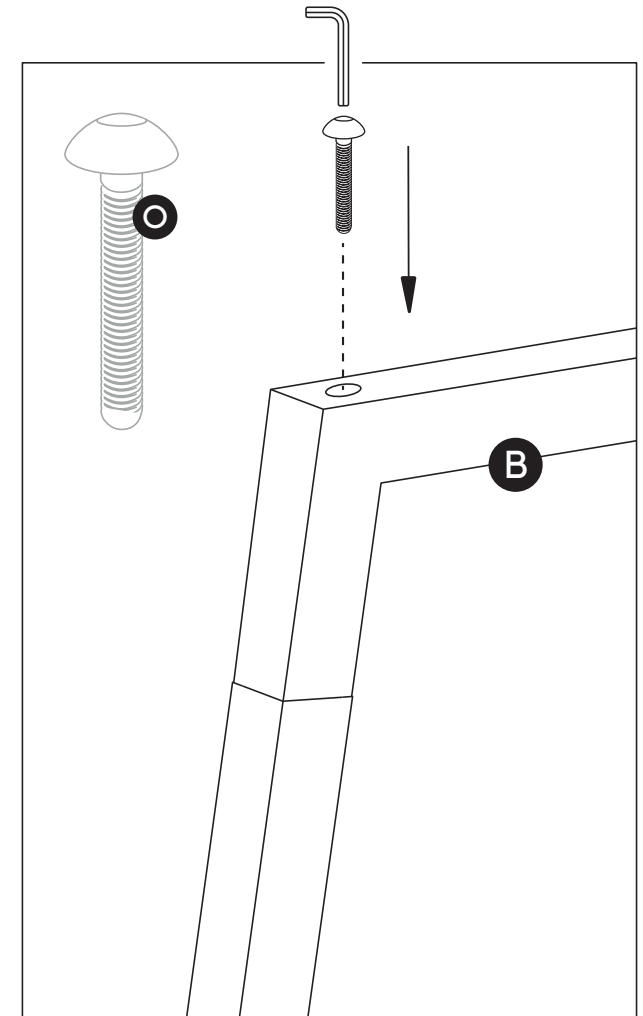

Insert the Leg wood add on (**C**) into the Leg Quadro A (Half leg) (**B**). Using Allen Key provided, attach mushroom head screw (**O**) for all legs.

ASSEMBLY INSTRUCTIONS

Quadro Wood A Leg Counter Frame

www.jasonl.com.au

Need help!

Call us on
1300 527 665

jason.l
your office furniture mate



STEP 02

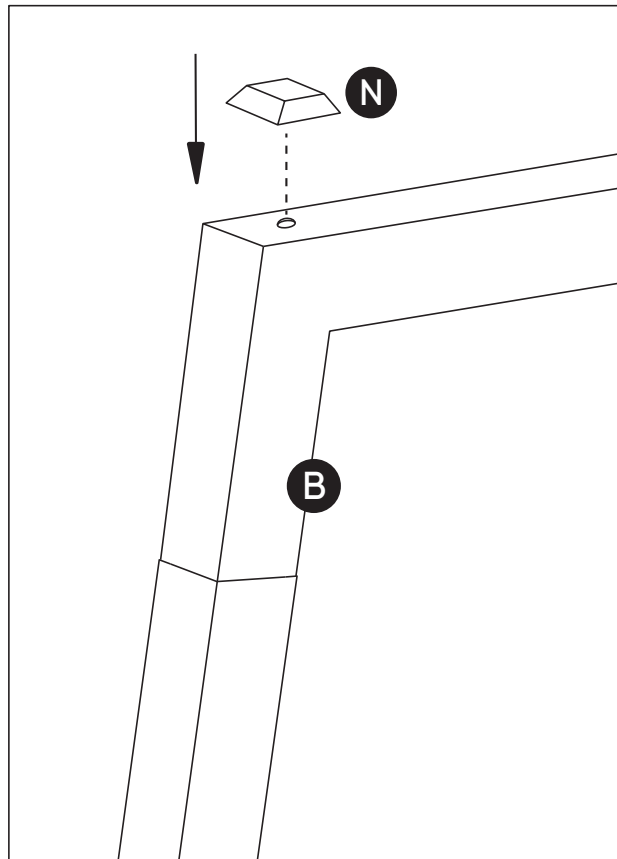

Now use corner pads **(N)** to cover the holes where just inserted the head screw sockets.

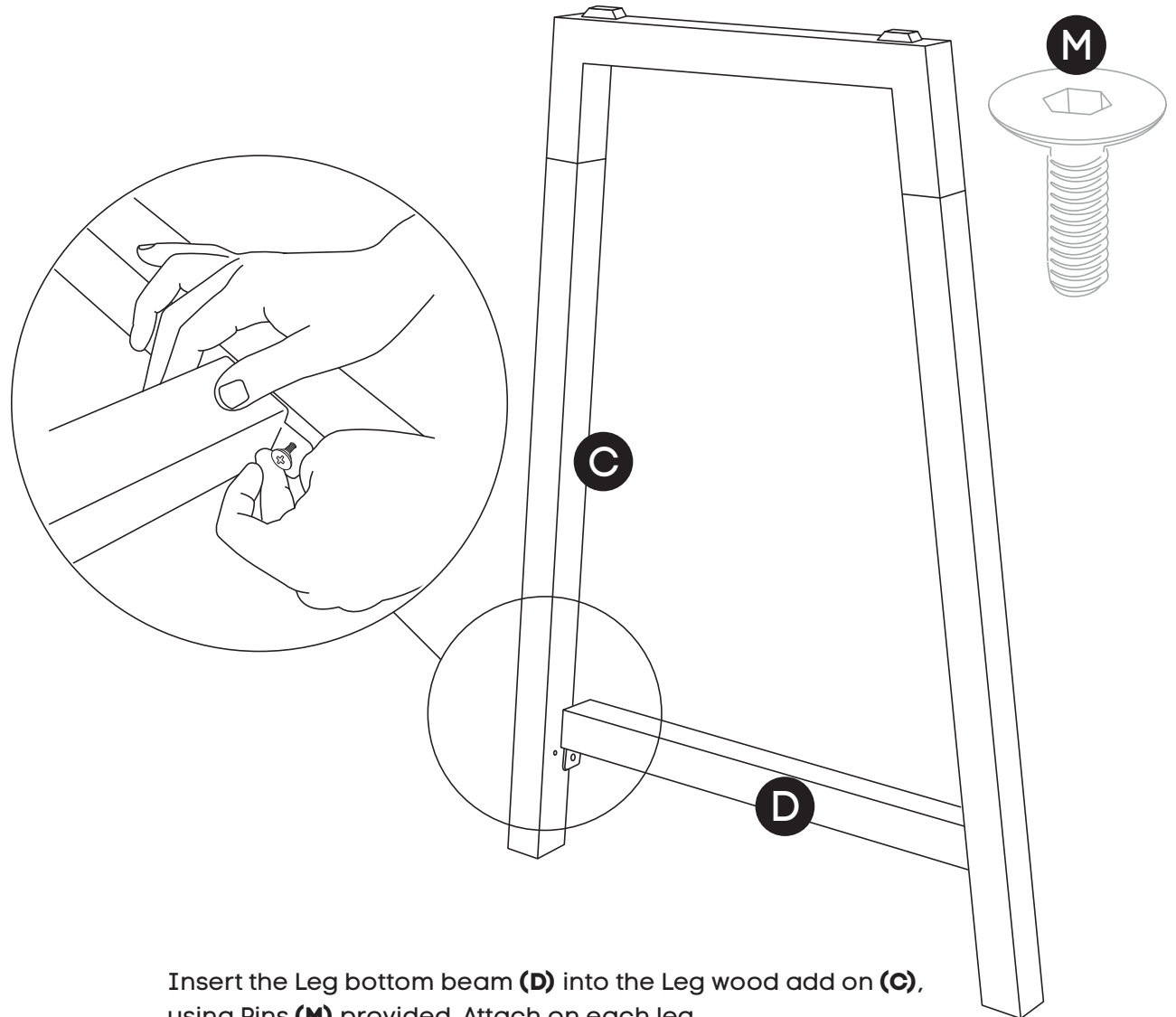

Insert the Leg bottom beam **(D)** into the Leg wood add on **(C)**, using Pins **(M)** provided. Attach on each leg.

ASSEMBLY INSTRUCTIONS

Quadro Wood A Leg Counter Frame

www.jasonl.com.au

Need help!

Call us on
1300 527 665

jason.l
your office furniture mate

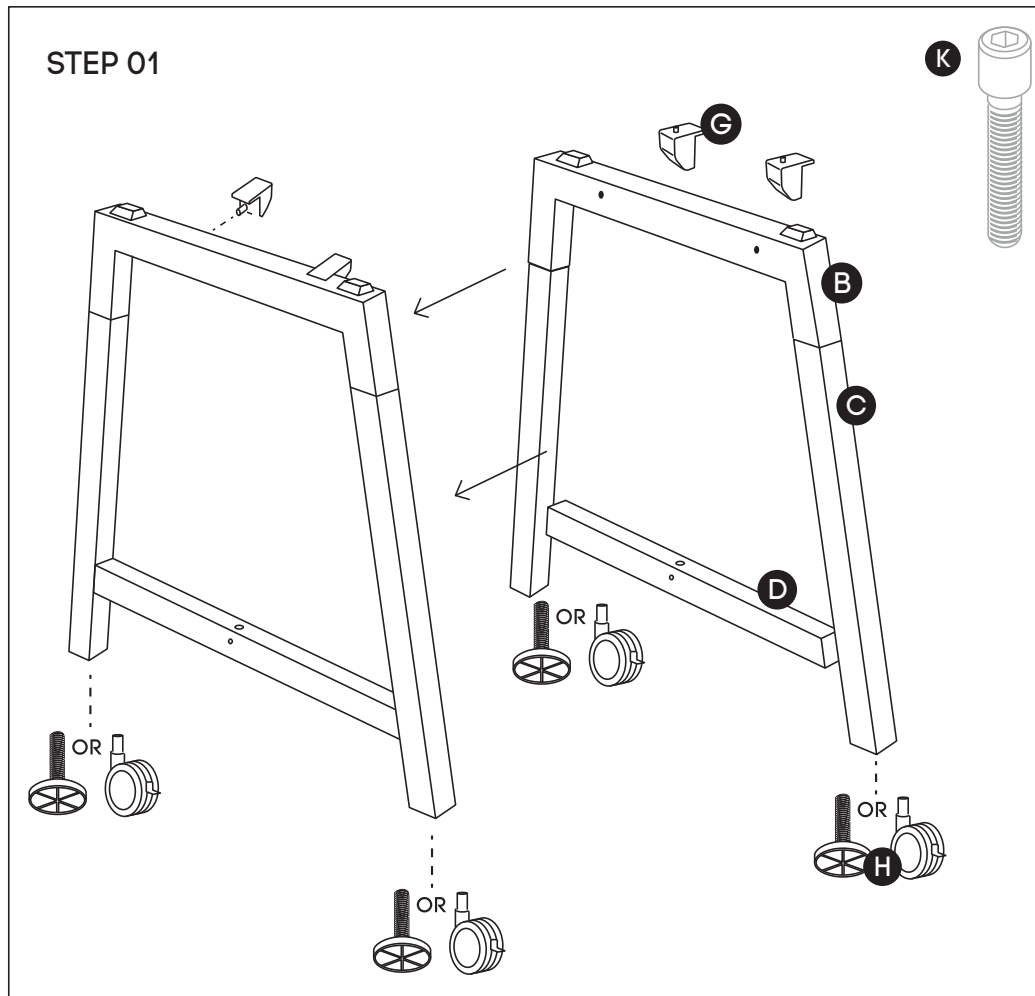

Using Allen Key provided, attach 2 plastic brackets per leg (G) (as per picture above) using M6x20MM (K) Socket head screw. Screw the feet or wheels (if you purchase with wheels option) (H) to the bottom of each Leg wood add on (C).

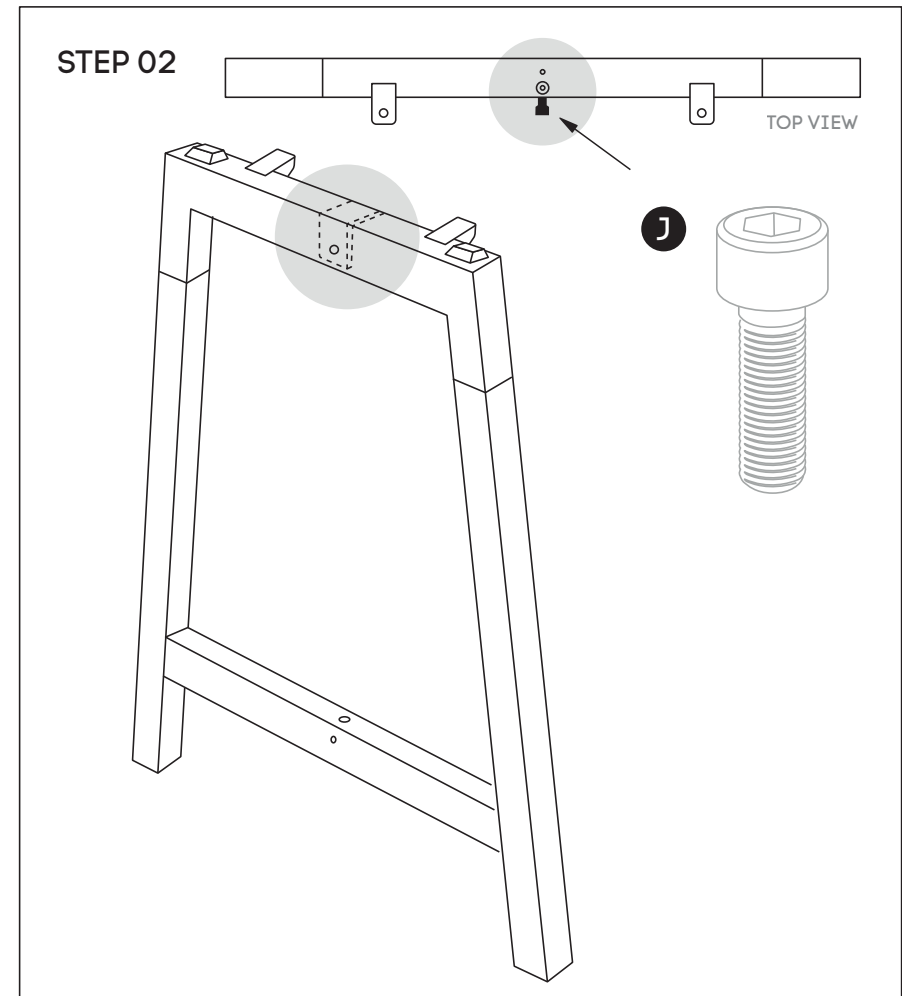

Using Allen Key provided, attach M8x20MM Socket head (J)-screw socket half way into leg for both legs

ASSEMBLY INSTRUCTIONS

Quadro Wood A Leg Counter Frame

www.jasonl.com.au

Need help!

Call us on
1300 527 665

jason.l
your office furniture mate



STEP 03

Adjust extendable beam **(E)** to desired length using markers and secure beam at that length using screws provided

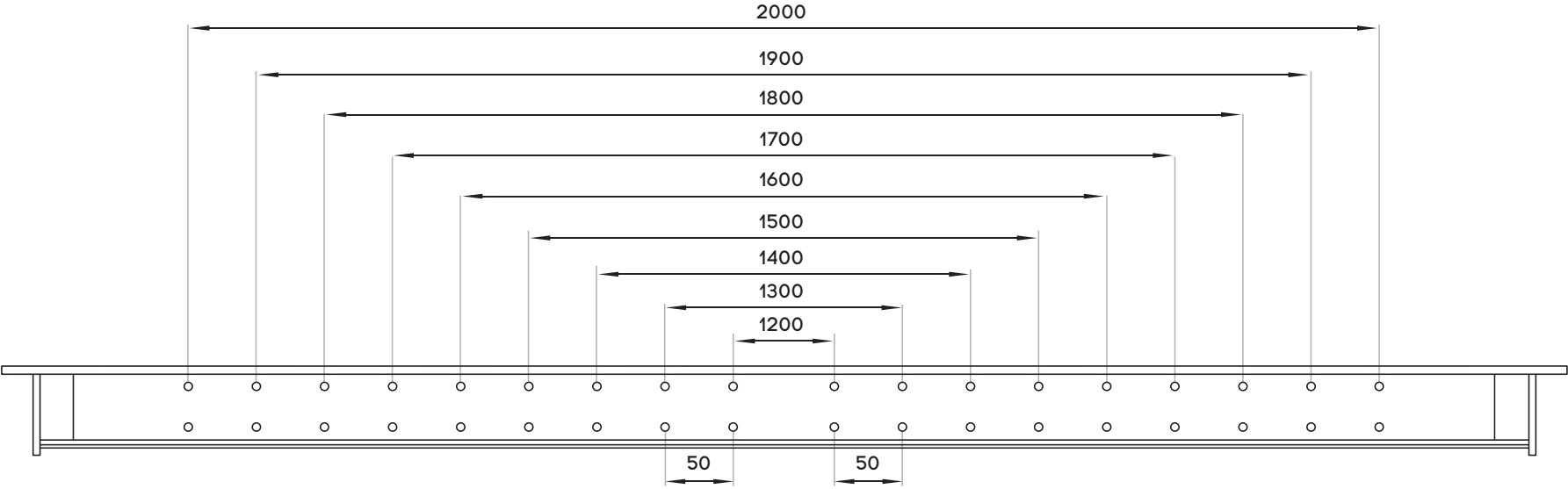
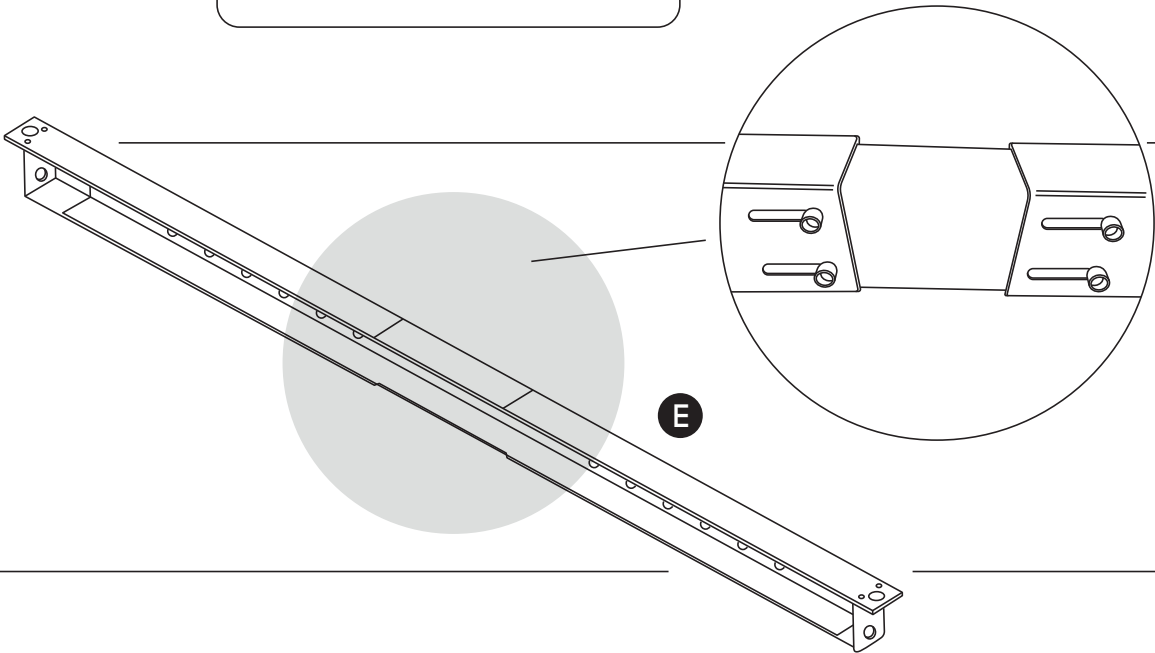

ASSEMBLY INSTRUCTIONS

Quadro Wood A Leg Counter Frame

www.jasonl.com.au

Need help!

Call us on
1300 527 665

jason.l
your office furniture mate



STEP 04

Adjust extendable beams **(F)** to desired length.

- 1 Remove plastic inserts
- 2 Loosen 2 bolts on beam using allen key
- 3 Extent lower beam to the same distance as upper beam
- 4 Insert plastic inserts back into the beam

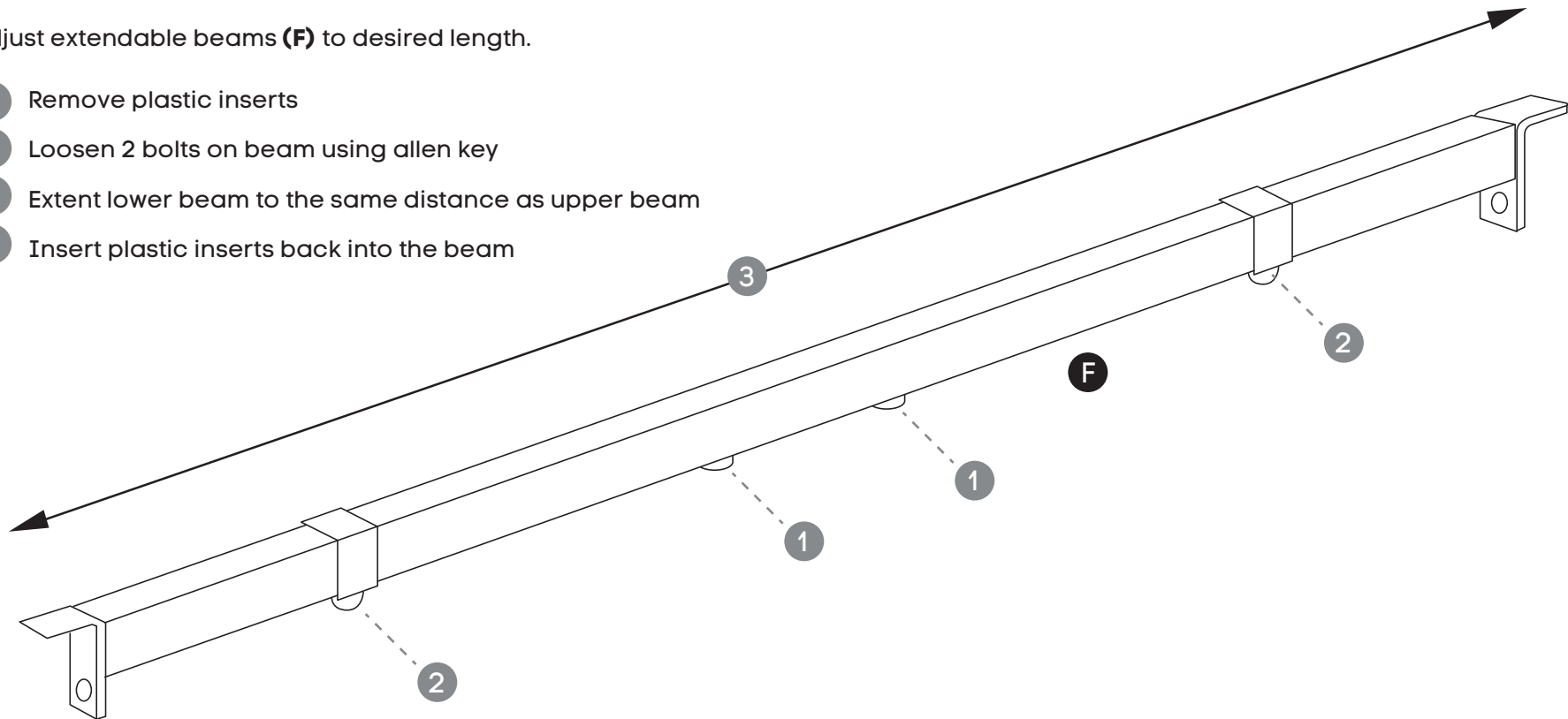

ASSEMBLY INSTRUCTIONS

Quadro Wood A Leg Counter Frame

www.jasonl.com.au

Need help!

Call us on
1300 527 665

jason.l
your office furniture mate

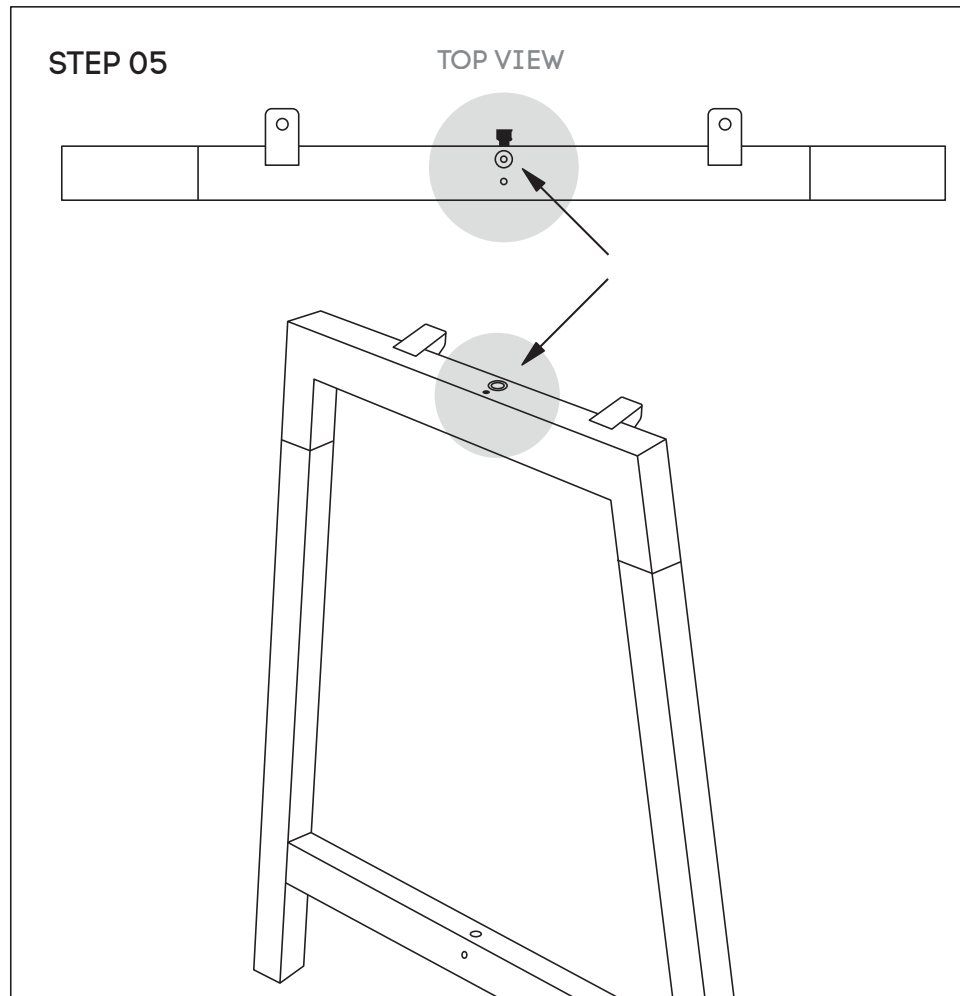

Attach Upper Beam (**E**) to legs using nut insert.
See point attached

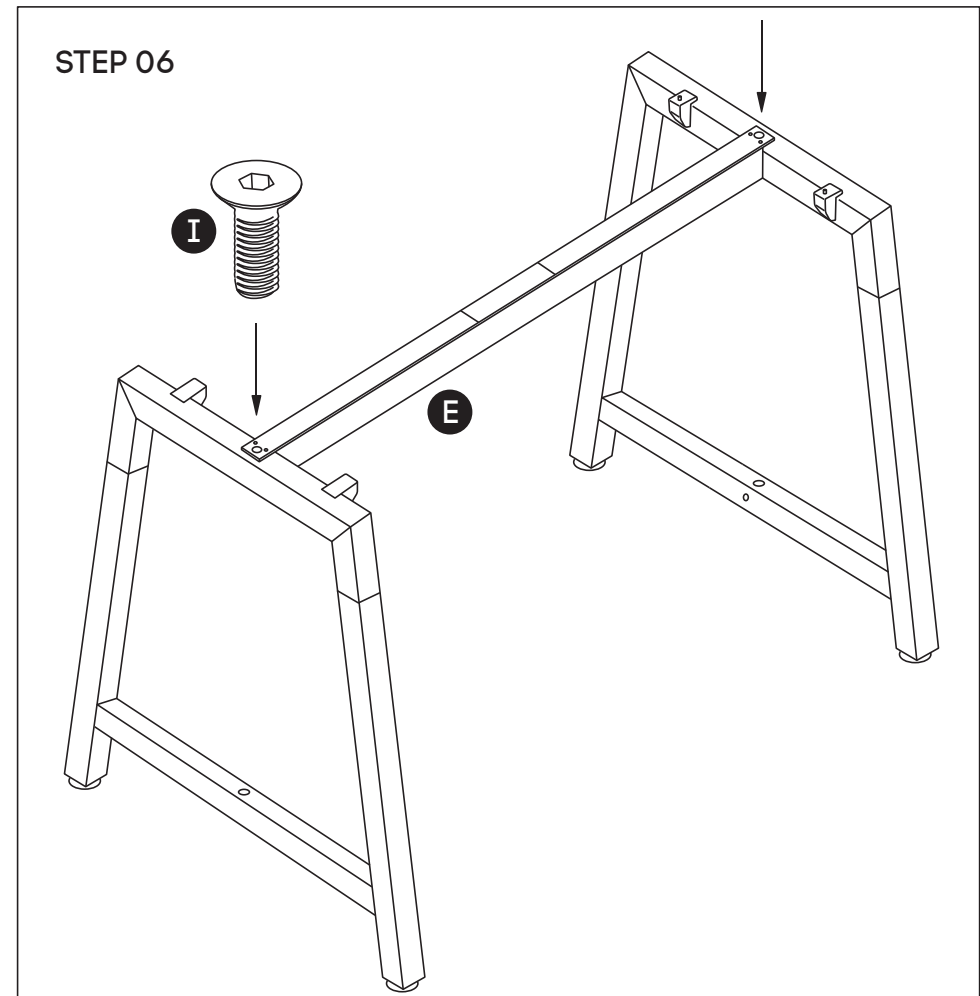

Frame looks like this. Using Allen Key, attach Upper Beam (**E**) with Sockets (**I**).

ASSEMBLY INSTRUCTIONS

Quadro Wood A Leg Counter Frame

www.jasonl.com.au

Need help!

Call us on
1300 527 665

jason.l
your office furniture mate

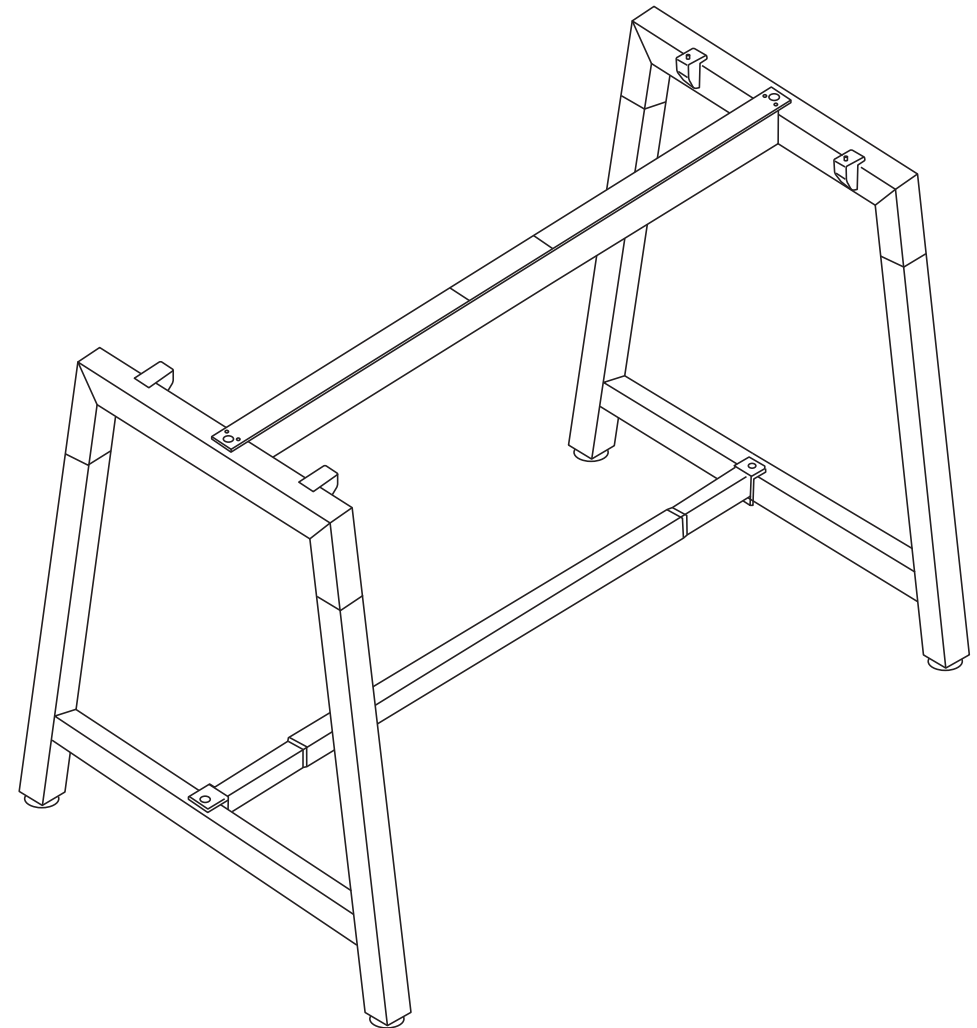
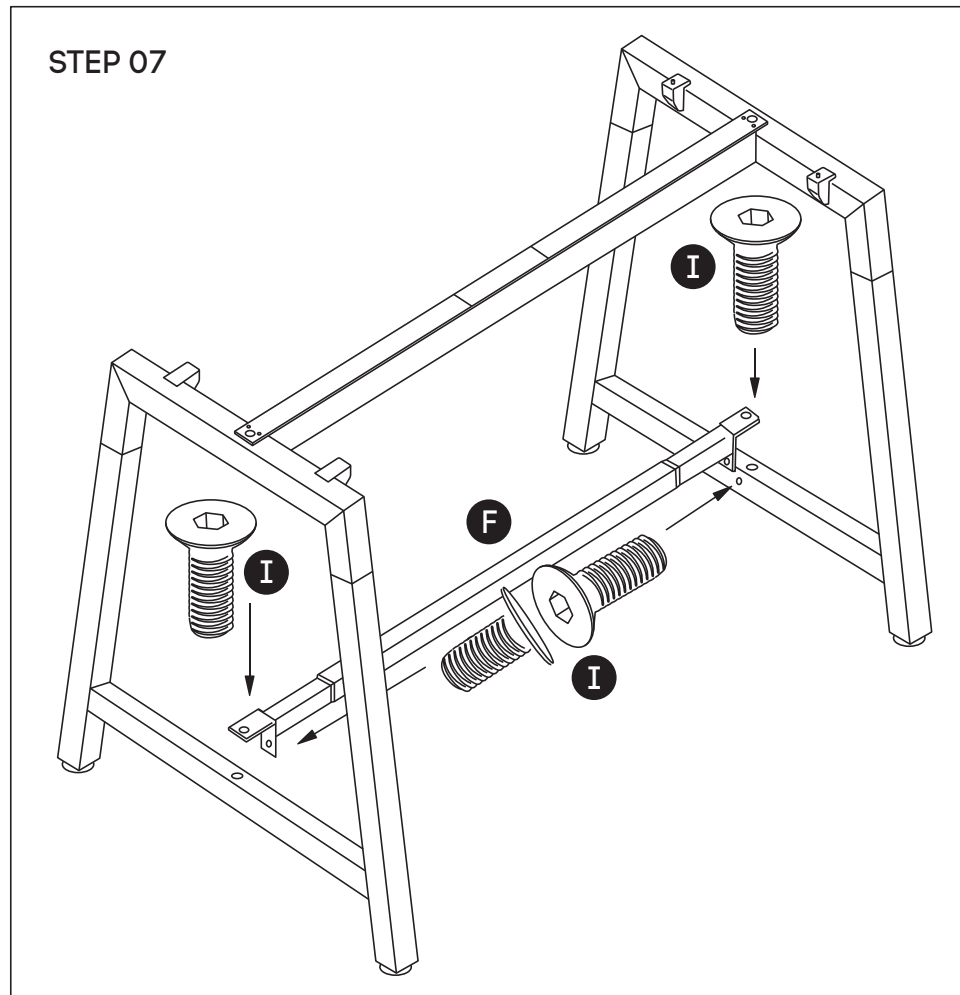

Frame looks like this. Using Allen Key. Tighen Sockets **(I)** on the Lower Beam **(F)** using Allen Key **(O)**. Insert plastic spacers to improve rigidity. Attach two Sockets **(I)** to the side of the lower side beams (as shown in the picture).

ASSEMBLY INSTRUCTIONS

Quadro Wood A Leg Counter Frame

www.jasonl.com.au

Need help!

Call us on
1300 527 665

jason.l
your office furniture mate



STEP 08

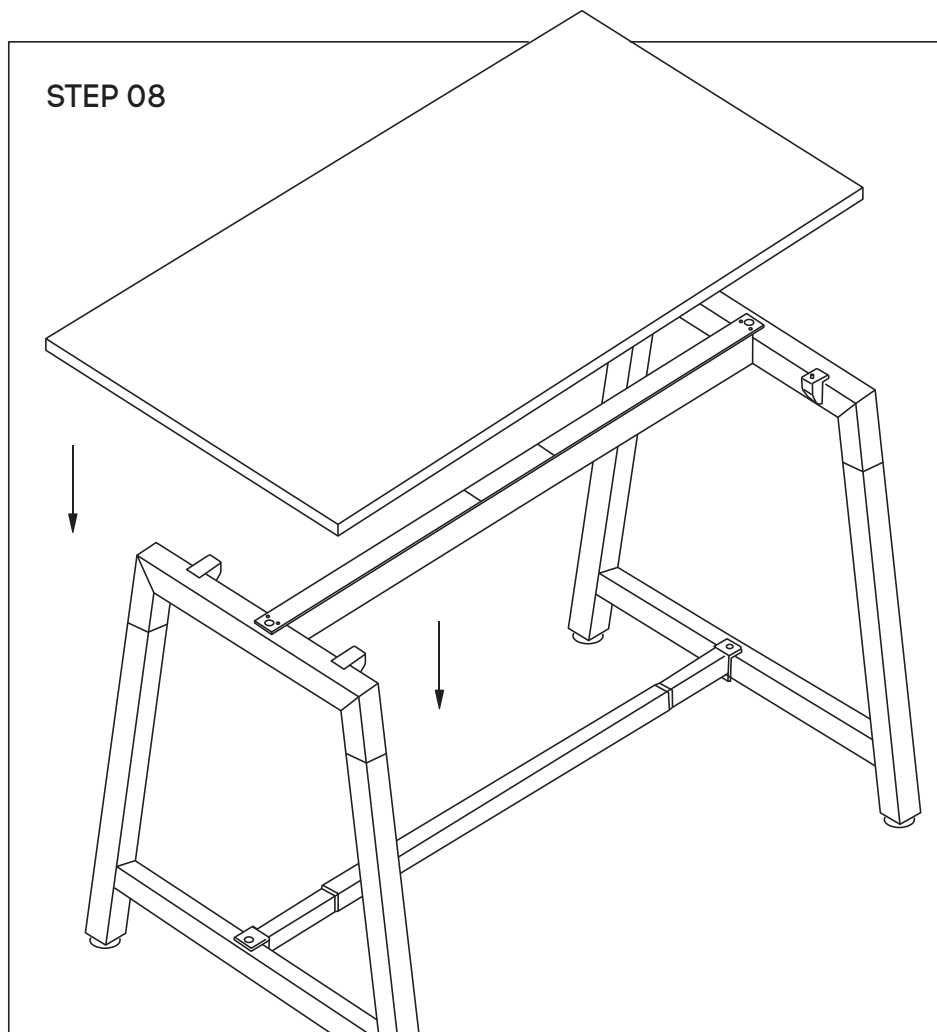

Place desktop on top of frame. Wood Screws to be drilled into the underneath Top.